

3-28-63

PERMIT

SEWAGE DISPOSAL SYSTEM

MARYLAND STATE DEPARTMENT OF HEALTH

HOWARD COUNTY

ELLICOTT CITY

DISTRICT 5

DATE ~~11-1-62~~

INDEXED

INDEXED

Joseph Merson

IS PERMITTED TO INSTALL ALTER

ADDRESS _____

PHONE _____

A SEWAGE DISPOSAL SYSTEM LOCATED AT

Greenbridge Road - on right going towards Dayton - almost to end of Greenbridge Rd.

SUBDIVISION _____

ROAD _____

LOT _____

PROPERTY OWNER

Merson, Joseph

ADDRESS _____

SPECIFICATIONS

DRAIN FIELD DEPTH _____ FEET, BOTTOM AREA 360 SQ. FT.

SEEPAGE PITS _____ ABSORBENT SIDE-WALL AREA _____ SQ. FT.

SEPTIC TANK CAPACITY 750 GALLONS

FOR GARBAGE GRINDER, INCREASE DISPOSAL AREA 22% & TANK CAPACITY 50%.

OTHER

File Field located on rear of lot behind house. Trenches to start about 125 feet from the front property line. Maintain a fall of 1/8" per foot for every 25 feet of trench.

Notes 11-8-62 Two dry wells each 10 ft. in dia. by 10 1/2 ft. deep located 65 ft. behind the rear wall of house 30 ft. from each other edge of pipe. Locate one dry well 35 ft. from rear back property line as determined when zoning lot front Greenbridge Rd. 11-10-62

PLANS APPROVED BY _____

DATE

11/14/62 - P.K. to

FILL SEPTIC TANK AND DISTRIBUTION BOX WITH WATER BEFORE CALLING FOR AN INSPECTION. COVER NO WORK UNTIL INSPECTED AND APPROVED.

Make 2 dry wells 10 1/2 deep.

NEITHER THE HOWARD COUNTY COMMISSIONERS NOR THE HEALTH DEPARTMENT IS RESPONSIBLE FOR THE SUCCESSFUL OPERATION OF ANY SYSTEM.

06046

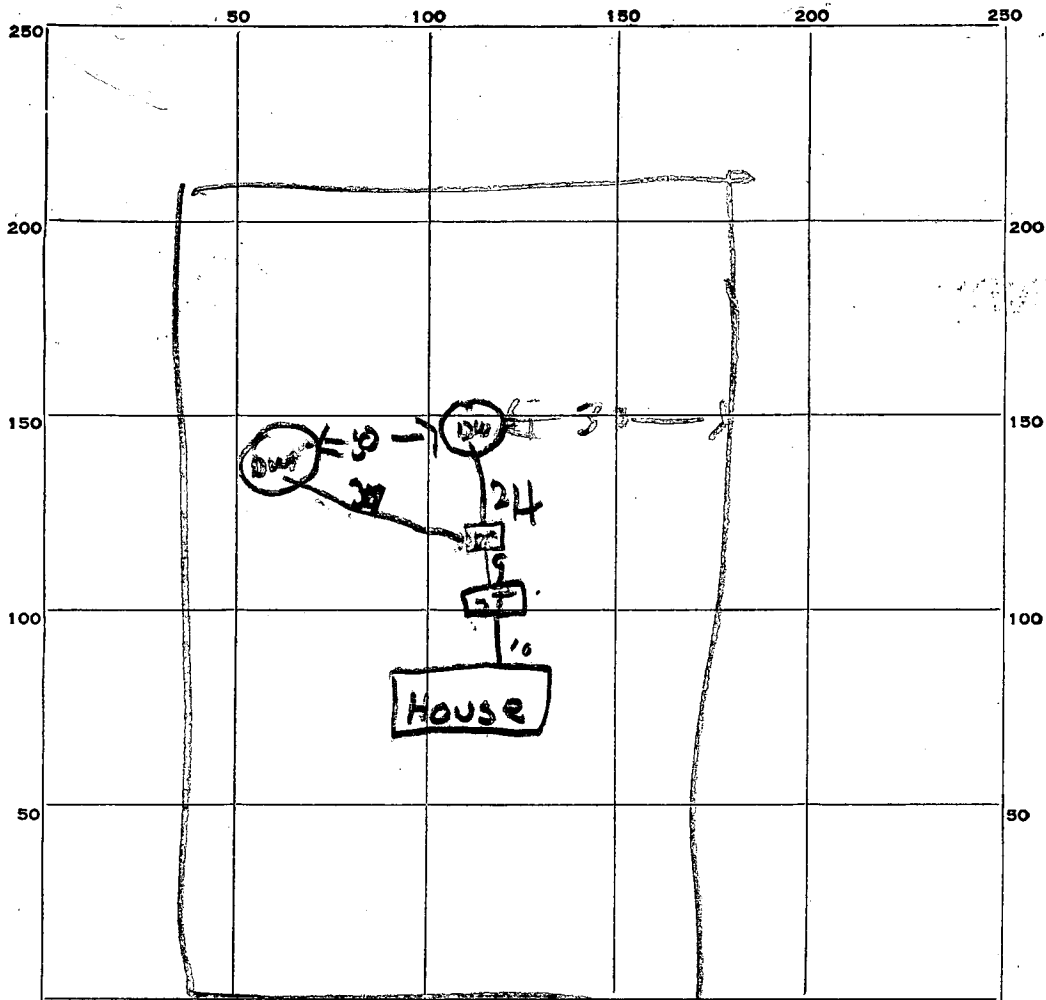

INDICATE NORTH. - NAME ADJOINING ROADWAY AS BASE LINE.

PERMIT CARD OK

SEPTIC TANK, LEVEL OK

CLEANOUTS OK

DISTRIBUTION BOX, LEVEL OK

TILE FIELD, DEPTH _____ FT. TRENCH WIDTH _____ FT.

GRAVEL DEPTH _____ IN. TOTAL LENGTH _____ FT.

NUMBER OF TRENCHES _____ TOTAL BOTTOM AREA _____

SEEPAGE PITS, INSIDE DIAMETER Two 10 FT. DEPTH BELOW INLET 10 1/2 FT.

ABSORBENT AREA _____ SQ. FT.

REMARKS Well has about 1/2 gravel around

DATE SYSTEM APPROVED 3/28/65

INSPECTOR Bill Mough