

Preliminary

APPLICATION

A 16952

P _____

SEWAGE DISPOSAL TESTING

MARYLAND STATE DEPARTMENT OF HEALTH

HOWARD COUNTY *Septic Tank { 1-3 Bedrooms 1000 gallons / 4 Bedrooms 1250 gallons }* ELLICOTT CITY

Day Well to have 125 sq. ft. effective absorbent sidewall area per bedroom below inlet. Inlet to be 4' below original grade and maximum depth 12'. Location 233' down right property line and 20' in from right property line. Use perc hole (1+2) when paving lot from unnamed road.

DISTRICT 3

DATE 4/24/72

TO: THE COUNTY HEALTH OFFICER
ELLICOTT CITY, MARYLAND

I, HEREBY, APPLY FOR THE NECESSARY TESTS IN ORDER TO CONSTRUCT (OR RECONSTRUCT) A SEWAGE DISPOSAL SYSTEM.

PROPERTY OWNER E. L. Ramsburg

ADDRESS 185 Henryton Road, Marriottsville, Md. PHONE 328-2696

PROPERTY LOCATION:

SUBDIVISION Everlea LOT NO. 9, Blk. B, Sec. 3

ROAD AND DESCRIPTION Everlea Road

OCCUPANT _____ PHONE _____

PERSON TO CONSTRUCT SYSTEM _____

ADDRESS _____ PHONE _____

SIZE OF LOT 83' x 292' x 245' x 32' x 448' TYPE BLDG. 3 or 4

NUMBER OF BEDROOMS
(Single Fmly. Dwlg.)

IF NOT SINGLE RESIDENCE DESCRIBE _____

SIGNATURE OF APPLICANT /s/ Everett Ramsburg

APPROVED BY C. V. Steaker FOR Day Well DATE 9/20/73
(KIND OF SYSTEM)

REJECTED BY _____ FOR _____ DATE _____
(KIND OF SYSTEM)

HOLD PENDING FURTHER TESTS _____ DATE _____

REASONS FOR REJECTION OR HOLDING _____

THIS IS NOT A PERMIT

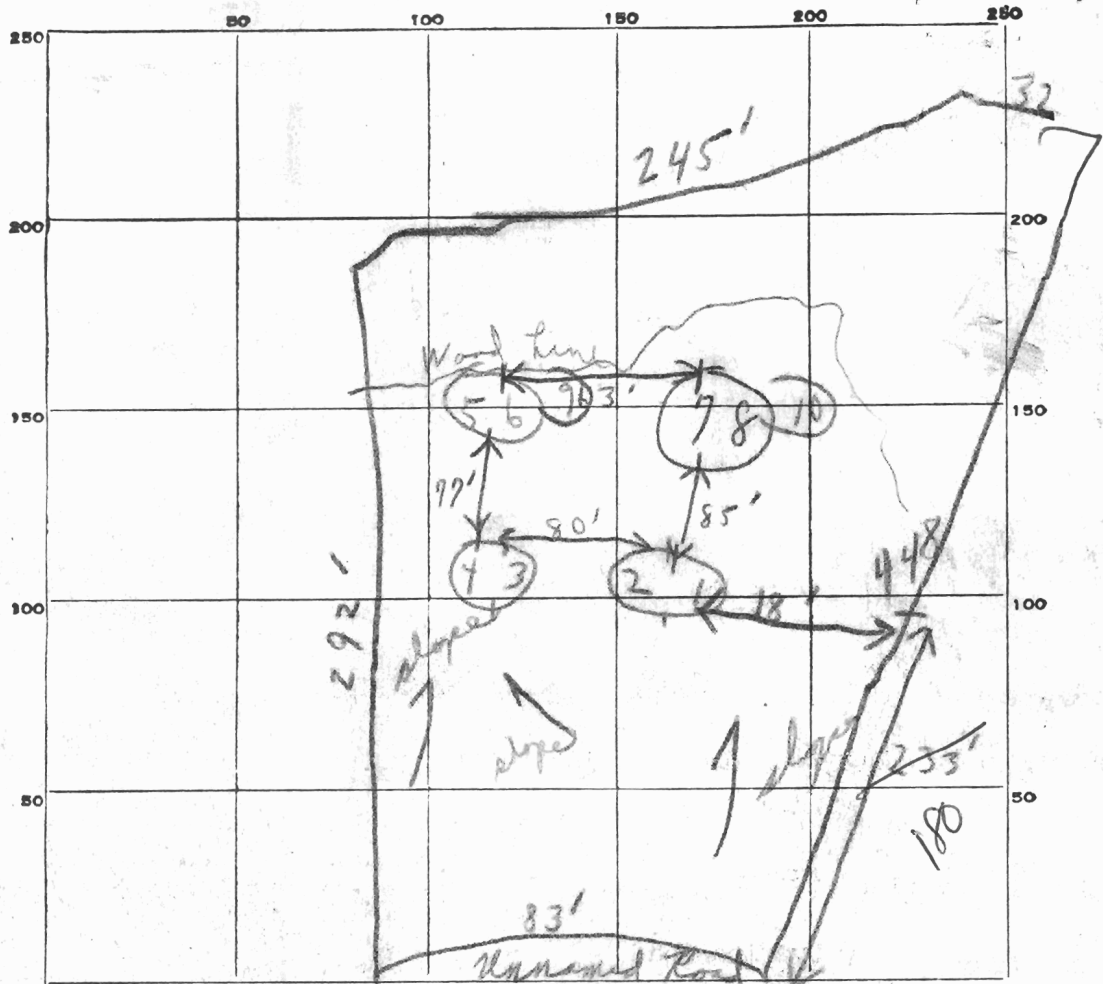

INDICATE NORTH. - NAME ADJOINING ROADWAY AS BASE LINE.

Tab 9

DATE	TEST NO.	DEPTH	PRE-WET		TEST - 1" DROP		TIME
			START	STOP	START	STOP	
5/12/72	1	4'	131	132	132	134	2 min
	2	12'	132	134	134	139	5 min
	3	4 1/2'	138	140	140	142	2 min
	4	12'	139	141	141	144	3 min
	5	5 1/2'	145	1/2" 115	Too little per		
	6	12'	146	148	148	150	2 min
	* 7	4 1/2'	156	2:08	2:08	2	Too lit
	8	4 1/2'	2:00	2:02	2:02	2:04	2 min
	9	4 1/2'	2:32	2:34	2:34	2:36	2 min
	⊗ 10	6'	2:40	2:42	2:42	2:44	2 min

SOIL AUGER FINDING _____

Max 1+2 / 100

TESTED BY _____

R.S.

REMARKS _____

APPLICATION

SEWAGE DISPOSAL TESTING

MARYLAND STATE DEPARTMENT OF HEALTH

HOWARD COUNTY

ELLICOTT CITY

DISTRICT 3

DATE 4/24/72

A 16952

P _____

TO: THE COUNTY HEALTH OFFICER
ELLICOTT CITY, MARYLAND

I, HEREBY, APPLY FOR THE NECESSARY TESTS IN ORDER TO CONSTRUCT (OR RECONSTRUCT) A SEWAGE DISPOSAL SYSTEM.

PROPERTY OWNER E. L. Ramsburg

ADDRESS 185 Henryton Road, Marriottsville, Md. PHONE 328-2696

PROPERTY LOCATION:

SUBDIVISION Everlea LOT NO. 9, Blk. B, Sec. 3

ROAD AND DESCRIPTION Everlea Road

OCCUPANT _____ PHONE _____

PERSON TO CONSTRUCT SYSTEM _____

ADDRESS _____ PHONE _____

SIZE OF LOT 83' x 292' x 245' x 32' x 448' TYPE BLDG. 3 or 4

NUMBER OF BEDROOMS

IF NOT SINGLE RESIDENCE DESCRIBE _____ (Single Fmly. Dwllg.)

SIGNATURE OF APPLICANT /s/ Everett Ramsburg

APPROVED BY _____ FOR _____ DATE _____

(KIND OF SYSTEM)

REJECTED BY _____ FOR _____ DATE _____

(KIND OF SYSTEM)

HOLD PENDING FURTHER TESTS _____ DATE _____

REASONS FOR REJECTION OR HOLDING _____

THIS IS NOT A PERMIT

Chas. Cross

837-0194

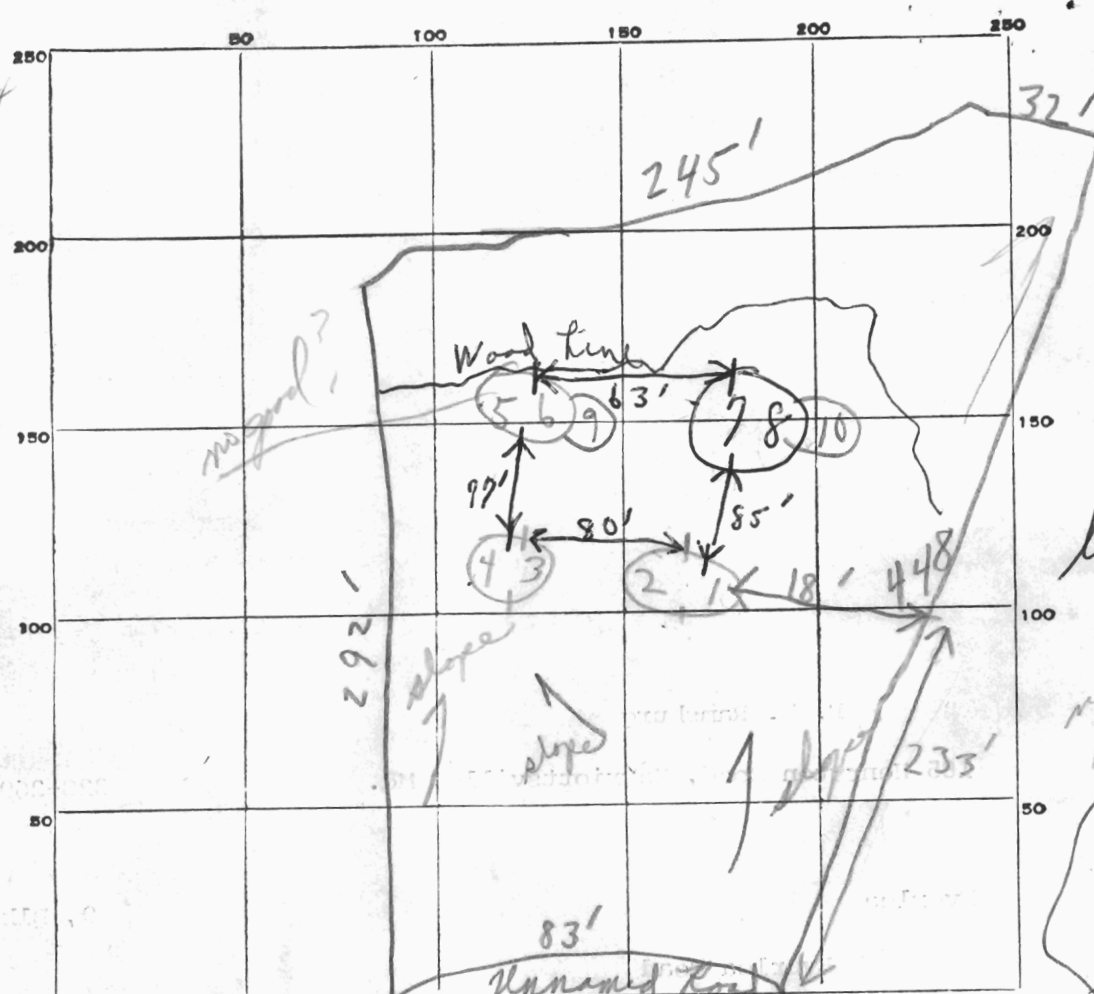

INDICATE NORTH. - NAME ADJOINING ROADWAY AS BASE LINE.

Lot 9

lot #9B
need another hole
OK
6/1/72
as discussed
by Mr. White
C.B.S. & Mr.
Rendberg
in office

DATE	TEST NO.	DEPTH	PRE-WET		TEST - 1" DROP		TIME
			START	STOP	START	STOP	
5/12/72	1	4'	131	132	132	134	2 min
	2	12'	132	134	134	139	5 min
	3	4 1/2'	138	140	140	142	2 min
	4	12'	139	141	141	144	3 min
	5	X 5 1/2'	145	1/2" 145	(Too little perc clay bank on angle)		30
	6	12'	146	148	148	150	2 min
	7	X 4 1/2'	156	2:08	2:08	2:08	Too little perc 30
	8	11'	2:00	2:02	2:02	2:04	2 min
	9	4'	2:32	2:34	2:34	2:36	2 min
	10	6'	2:40	2:42	2:42	2:44	2 min

Use 1+2 if passed 10/80

Inlet in 8 min
OK'D of
discussing
with F.F.

SOIL AUGER FINDING _____
TESTED BY B.S.
REMARKS _____