

Boundary plot signed by Reg. Engr. Wilson

Fill out in triplicate.

Make \$15.00 check payable:

Howard County Health Dept. - Sanitation

APPLICATION

Serial A 17654
Submitted P _____

SEWAGE DISPOSAL TESTING

4-12' to 100 ft. depth or 10,000 ft.
MARYLAND STATE DEPARTMENT OF HEALTH
HOWARD COUNTY

Septic - 3 bedrooms - 1000 gal
4 " 1250 gal

ELLICOTT CITY

DISTRICT 5th

One Well - 100 sq. ft. abundant
sidewall area per bedroom

DATE 11-9-72

In began below the final 3 1/2 ft. of
impervious soil. Maximum depth permitted for dry well
is 12 ft. below original grade. Some dry well 40 ft.
on back of garage here that was seen from right of way

TO: THE COUNTY HEALTH OFFICER
ELLICOTT CITY, MARYLAND

(If there is more than 3 1/2 feet of fill on
bottom tank a manhole will be required)

I, HEREBY, APPLY FOR THE NECESSARY TESTS IN ORDER TO CONSTRUCT (OR RECONSTRUCT) A SEWAGE DISPOSAL SYSTEM.

PROPERTY OWNER DR. GLENN JAMES

ADDRESS 379 MAIN ST, LAUREL, MD

PHONE 725-4115

PROPERTY LOCATION:

Plot PHAW #36 Block 18 R-40

SUBDIVISION 5th Election Dist. of Howard County

LOT NO. Dayton, Md

ROAD AND DESCRIPTION Right of Way of GREENBRIDGE Rd.

5234 GREENSBIDGE Rd. Dayton

OCCUPANT THE JAMESSES

PHONE 725-4115

PERSON TO CONSTRUCT SYSTEM _____

ADDRESS _____

PHONE _____

SIZE OF LOT 30+ AC.

TYPE BLDG. BRICK HOME (4)

IF NOT SINGLE RESIDENCE DESCRIBE

two story BRICK RESIDENCE

SIGNATURE OF APPLICANT

Dr. Glenn James

APPROVED BY Robert V. Turner

FOR One Well
(KIND OF SYSTEM)

DATE 11/8/73

REJECTED BY _____

FOR _____

(KIND OF SYSTEM)

DATE _____

HOLD PENDING FURTHER TESTS _____

DATE _____

REASONS FOR REJECTION OR HOLDING _____

THIS IS NOT A PERMIT

48371

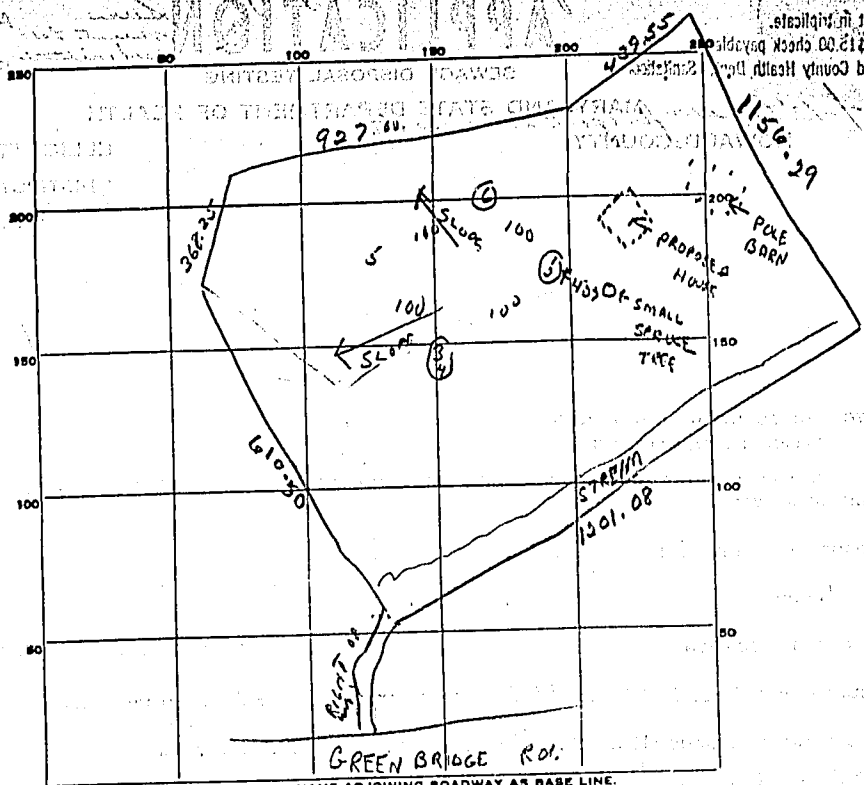

INDICATE NORTH. - NAME ADJOINING ROADWAY AS BASE LINE.

DATE	TEST NO.	DEPTH	PRE-WET		TEST - 1" DROP		TIME
			START	STOP	START	STOP	
11/10/73	1	12 ft.	10 ¹³	10 ¹⁶	10 ¹⁴	10 ²¹	5 min
	2	3 1/2 ft.	10 ¹⁵	10 ¹⁷	10 ¹⁷	10 ²¹	4 min
	3	11 1/2 ft.	10 ²⁹	10 ³¹	10 ³¹	10 ³⁵	4 min
	4	3 1/2 ft.	10 ²⁹	10 ⁴⁰	10 ⁴⁰	10 ⁵⁷	17 min
	5	11 ft.	Low	Low			
	6	"	Low	Low			
	Excellent soil in another part.						

SOIL AUGER FINDING _____
 TESTED BY R. Tove
 REMARKS _____