

5/13/02
LATE

04-315022

PUB. SEWER STATUS VERIFIED BY NA

ISSUE DATE: 5/7/2002

P 516966

APPROVAL DATE: 5/13/02

A REPAIR

PERMIT

INDEXED

ON-SITE SEWAGE DISPOSAL SYSTEM HOWARD COUNTY HEALTH DEPARTMENT BUREAU OF ENVIRONMENTAL HEALTH

Herman Sirk IS PERMITTED TO INSTALL ALTER

ADDRESS: 2555 Jennings Chaple Road PHONE NUMBER: 410-489-4724

SUBDIVISION: _____ LOT NUMBER: _____

ADDRESS: 16709 Route 144 PROPERTY OWNER: Aubrey Fleming

SEPTIC TANK CAPACITY (GALLONS): ex 1000

PUMP CHAMBER CAPACITY (GALLONS): NA

SET A D-BOX

NUMBER OF BEDROOMS: 3

SQUARE FEET PER BEDROOM: 180

LINEAR FEET OF TRENCH REQUIRED: 135' (3-45' trenches) 10' CTC

TRENCHES:	Trench to be 2 feet wide. Inlet 4-5 feet below original grade. Bottom maximum depth 8 feet below original grade. Effective ^{side} area begins at 4-5 feet below original grade. 4 feet of stone below distribution pipe.
LOCATION:	Existing septic system is failing. Call for inspection when ground is opened.
PURPOSE:	

PLANS APPROVED: ~~Mark Rifkin~~ SRK DATE: 05/07/02

- NOTE: PERMIT VOID AFTER 2 YEARS
- NOTE: CONTRACTOR RESPONSIBLE FOR SCHEDULING A PRE-CONSTRUCTION INSPECTION FOR ALL INSTALLATIONS
- NOTE: WATERTIGHT SEPTIC TANKS REQUIRED
- NOTE: ALL PARTS OF SEPTIC SYSTEM SHALL BE 100 FEET FROM ANY WATER WELL
- NOTE: MANHOLE RISERS REQUIRED ON ALL SEPTIC TANKS AND PUMP CHAMBERS

NEITHER THE HOWARD COUNTY COUNCIL NOR THE HEALTH DEPARTMENT IS RESPONSIBLE FOR THE SUCCESSFUL OPERATION OF ANY SYSTEM PERMITTEE RESPONSIBLE FOR OBTAINING FINAL APPROVAL ON THIS PERMIT CALL 410-313-2640 FOR INSPECTION OF SEPTIC SYSTEM

AS16966

NOT TO SCALE

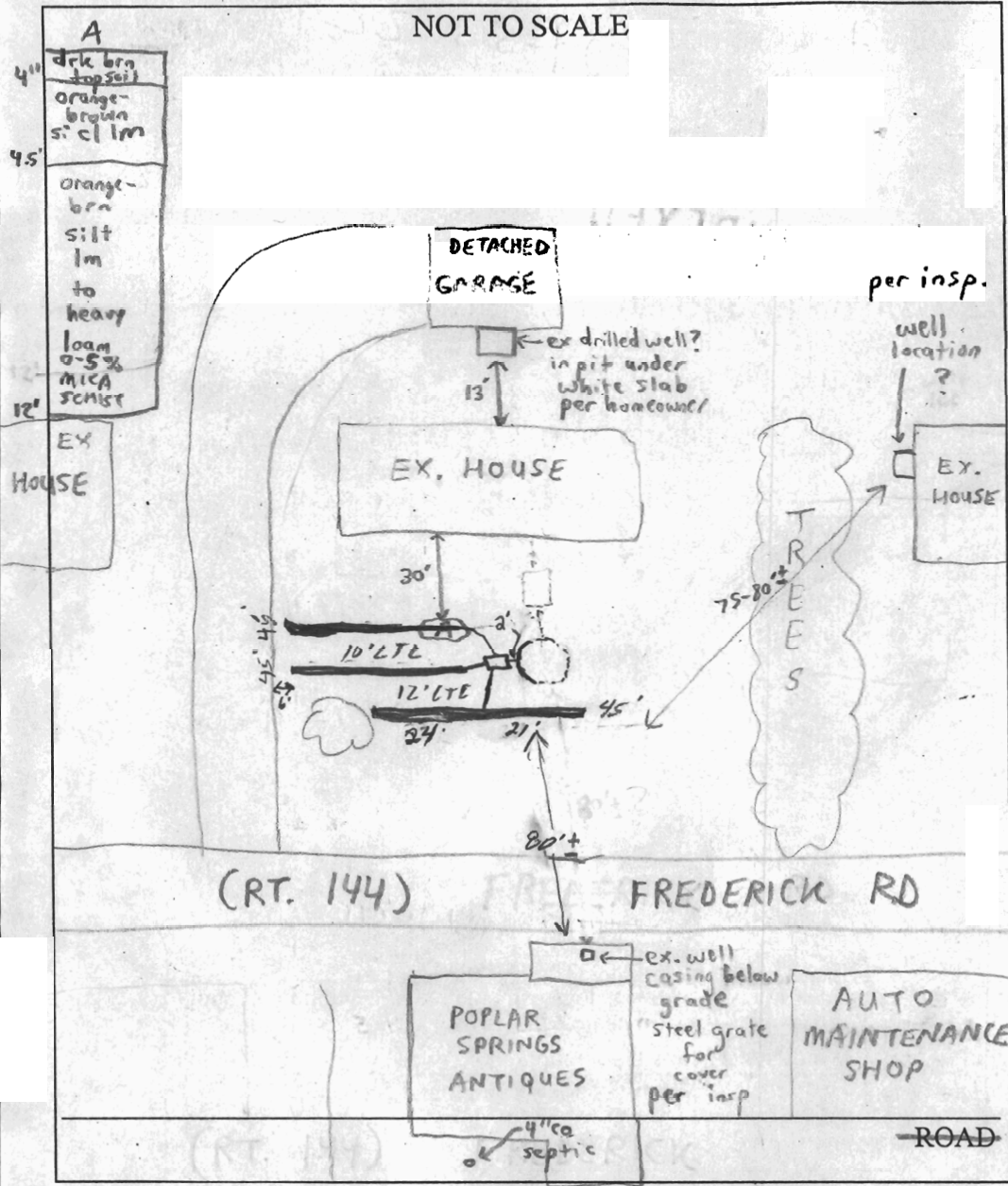

TRENCH/DRAINFIELD DATA		
WIDTH	INLET	BOTTOM
2'	4-4.5'	8'
NUMBER OF TRENCHES		3
TOTAL LENGTH		135'
ABSORPTION AREA		540-427
DISTRIBUTION BOX LEVEL		✓
DISTRIBUTION BOX BAFFLE		✓
DISTRIBUTION BOX PORT		—

SEPTIC TANK DATA		
SEPTIC TANK 1 LEVEL <u>existing</u>		
CAPACITY	1000	GAL
SEAM LOC	?	
TANK LID DEPTH	3-4'	
BAFFLES	?	
BAFFLE FILTER	NA	
MANHOLE LOC	NA	
6" PORT LOC	NA	
WATERTIGHT TEST	NA	
SEPTIC TANK 2 LEVEL <u>NA</u>		
CAPACITY	NA	GAL
SEAM LOC	NA	
TANK LID DEPTH	NA	
BAFFLES	NA	
BAFFLE FILTER	NA	
MANHOLE LOC	NA	
6" PORT LOC	NA	
WATERTIGHT TEST	NA	

PRE-CONSTRUCTION 5/1/02 - DUG PERC HOLE IN LOCATION (A), SOILS OK SEE SOIL PROFILE, RAN 3-45' TRENCHES (10' CTC) ^{w/ DBOX}, LAST TRENCH OK TO PLACE "T" & RUN

INSTALLATION BOTH DIRECTIONS - (SRK/SO)

INSTALLATION - 5/13/02 Trenches installed, shallower at ends by driveway. OK to cover all work (SO)

FINAL INSPECTOR [Signature] DATE OF APPROVAL 5/13/02

APPLICATION

SEWAGE DISPOSAL TESTING

MARYLAND STATE DEPARTMENT OF HEALTH

A 03007

P 00824

HOWARD COUNTY

ELLICOTT CITY

SEPTIC TANK - 750 gallons

DISTRICT 4

DRY WELL - 324 S.F. side-wall area below the inlet

DATE 6-2-61

TO: THE COUNTY HEALTH OFFICER
ELLICOTT CITY, MARYLAND

I, HEREBY, APPLY FOR THE NECESSARY TESTS IN ORDER TO CONSTRUCT OR RE-CONSTRUCT A SEWAGE DISPOSAL SYSTEM.

PROPERTY OWNER Dr Aubrey E. Fleming

ADDRESS Rt. 1, Ellicott City, Md. Rt. 2 PHONE Rt. 1, Ellicott City 17205

PROPERTY LOCATION

SUBDIVISION _____ LOT NO. _____

ROAD AND DESCRIPTION On job in Poplar Springs across from Farm Repair Shop

OCCUPANT _____ PHONE _____

PERSON TO CONSTRUCT SYSTEM _____

ADDRESS _____ PHONE _____

SIZE OF LOT 1 8070 TYPE BLDG. 3
NUMBER OF PERSONS _____

IF NOT SINGLE RESIDENCE DESCRIBE _____

SIGNATURE OF APPLICANT Aubrey E. Fleming

APPROVED BY Walton S. Lewis FOR DRY WELL DATE 6/2/61
(KIND OF SYSTEM)

REJECTED BY _____ FOR _____ DATE _____
(KIND OF SYSTEM)

HOLD PENDING FURTHER TESTS _____ DATE _____

REASONS FOR REJECTION OR HOLDING _____

THIS IS NOT A PERMIT

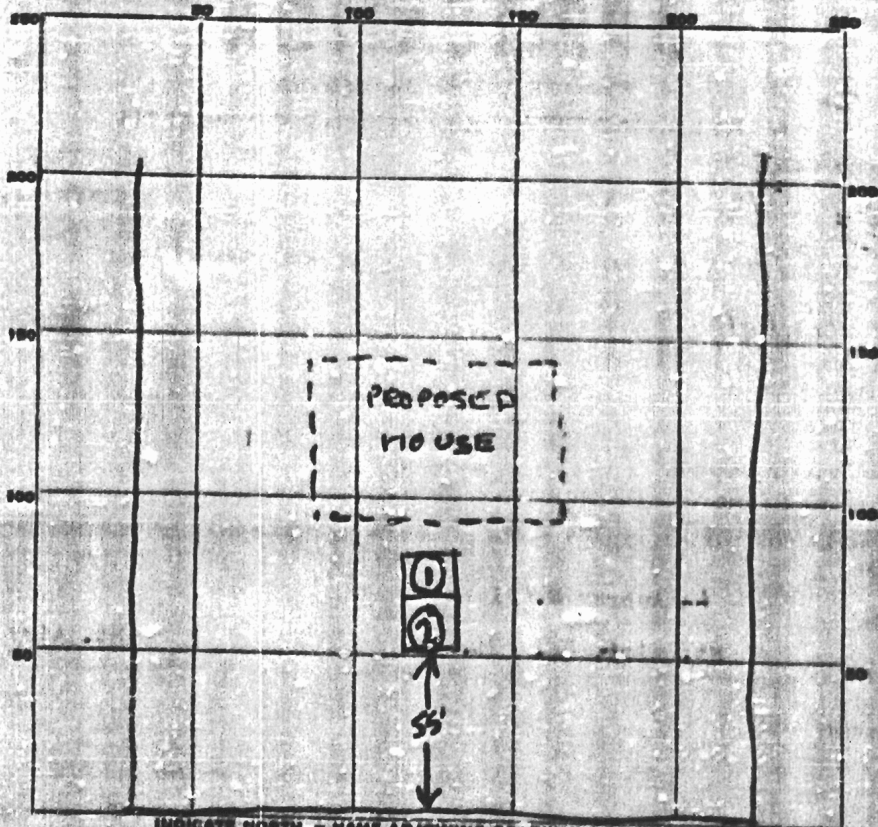

INDICATE NORTH - NAME ADJOINING ROADWAY AS BASE LINE.
 RTE. 144

DATE	TEST NO.	DEPTH	PRE-WET		TEST - 1" DROP		TIME
			START	STOP	START	STOP	
6/2/61	1	9'	211	216	216	225	9 min
6/2/61	2	4'	213	218	218	226	8 min

} 9 min average

SOIL AUGER FINDING _____
 TESTED BY Walton S. Toewy
 REMARKS _____
 ALSO PRESENT Cushrey & Fleming LOT NO. _____