

1/10/05

PUB. SEWER STATUS VERIFIED BY \_\_\_\_\_

ISSUE DATE: 1/5/2005

P 521642-B

APPROVAL DATE: 1/14/05

**PERMIT INDEXED**

A (REPAIR) 516977

04322509

**ON-SITE SEWAGE DISPOSAL SYSTEM  
HOWARD COUNTY HEALTH DEPARTMENT  
BUREAU OF ENVIRONMENTAL HEALTH**

Fyock Septic Service IS PERMITTED TO INSTALL  ALTER

ADDRESS: PO Box 89, Glenelg, MD 21737 PHONE NUMBER: 410-988-9270

SUBDIVISION: \_\_\_\_\_ LOT NUMBER: \_\_\_\_\_

ADDRESS: 14015 Castlebar Drive PROPERTY OWNER: Perry

SEPTIC TANK CAPACITY (GALLONS): Ex 1000

PUMP CHAMBER CAPACITY (GALLONS): N/A

NUMBER OF BEDROOMS: 4

SQUARE FEET PER BEDROOM: 180

LINEAR FEET OF TRENCH REQUIRED: 112

TRENCHES:	Trench to be <u>2</u> feet wide. Inlet <u>5</u> feet below original grade. Bottom maximum depth <u>10</u> feet below original grade. Effective area begins at <u>5</u> feet below original grade. <u>5</u> feet of stone below distribution pipe.
LOCATION:	<u>Start 5' inlet on low side, deeper on high side</u> <u>Bottom level</u> <u>Pump collapse, fill old P.W.</u>
PURPOSE:	Existing septic system has failed. Call for inspection when ground is opened so sanitarian can recommend repair.

PLANS APPROVED: [Signature] DATE: 1/10/05

- NOTE: PERMIT VOID AFTER 2 YEARS
- NOTE: CONTRACTOR RESPONSIBLE FOR SCHEDULING A PRE-CONSTRUCTION INSPECTION FOR ALL INSTALLATIONS
- NOTE: WATERTIGHT SEPTIC TANKS REQUIRED
- NOTE: ALL PARTS OF SEPTIC SYSTEM SHALL BE 100 FEET FROM ANY WATER WELL
- NOTE: MANHOLE RISERS REQUIRED ON ALL SEPTIC TANKS AND PUMP CHAMBERS

**NEITHER THE HOWARD COUNTY COUNCIL OR THE HEALTH DEPARTMENT IS RESPONSIBLE FOR THE SUCCESSFUL OPERATION OF ANY SYSTEM PERMITTEE RESPONSIBLE FOR OBTAINING FINAL APPROVAL ON THIS PERMIT CALL 410-313-2640 FOR INSPECTION OF SEPTIC SYSTEM**

A 516977

NOT TO SCALE

TRENCH/DRAINFIELD DATA		
WIDTH	INLET	BOTTOM
2	5-6'	10-11'
NUMBER OF TRENCHES		2
TOTAL LENGTH		114'
ABSORPTION AREA		570 <del>9</del>
DISTRIBUTION BOX LEVEL		<input checked="" type="checkbox"/>
DISTRIBUTION BOX BAFFLE		<input checked="" type="checkbox"/>
DISTRIBUTION BOX PORT		<input type="checkbox"/>

SEPTIC TANK DATA	
SEPTIC TANK 1 LEVEL	
CAPACITY	EX 1000 GAL
SEAM LOC	_____
TANK LID DEPTH	_____
BAFFLES	<input checked="" type="checkbox"/>
BAFFLE FILTER	_____
MANHOLE LOC	_____
6" PORT LOC	_____
WATERTIGHT TEST	_____
SEPTIC TANK 2 LEVEL	
CAPACITY	_____ GAL
SEAM LOC	_____
TANK LID DEPTH	_____
BAFFLES	_____
BAFFLE FILTER	_____
MANHOLE LOC	_____
6" PORT LOC	_____
WATERTIGHT TEST	_____

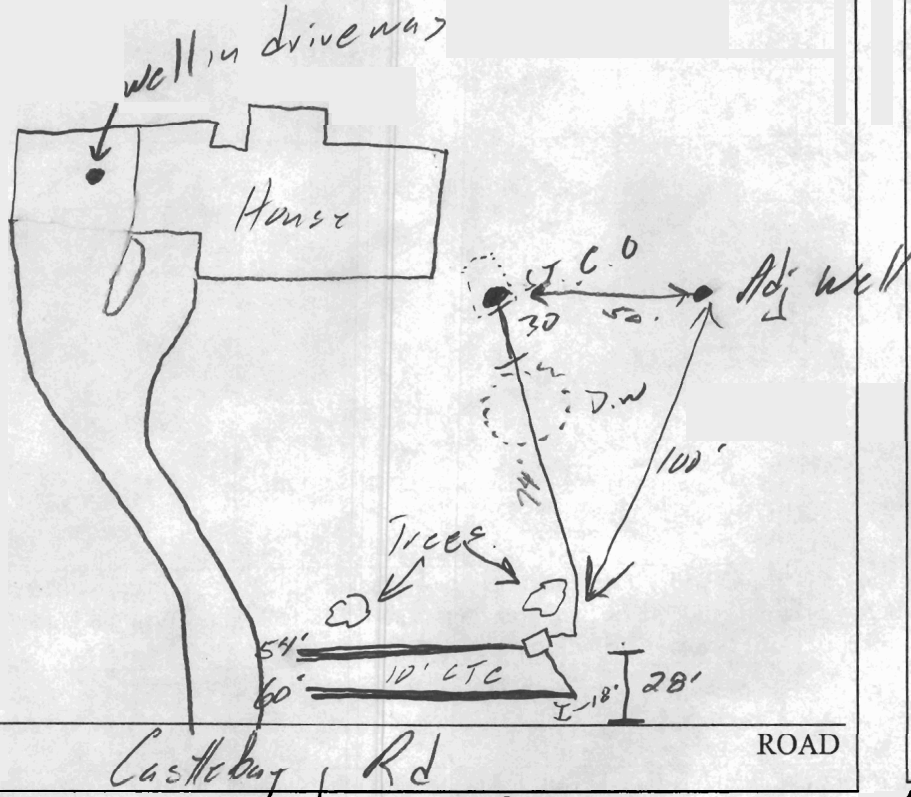

PRE-CONSTRUCTION 1/10/05 - See pre notes (SO)

INSTALLATION 1/13/05 - working on 1st trench (SO)

1/14/05 - Complete system installed OK to cover (SC)

FINAL INSPECTOR [Signature]

DATE OF APPROVAL 1/14/05

PUB. SEWER STATUS VERIFIED BY \_\_\_\_\_

ISSUE DATE: 1/26/1969

APPROVAL DATE: 2/3/1967

**PERMIT  
INDEXED**  
04 3 22509

P \_\_\_\_\_

A 516977

**ON-SITE SEWAGE DISPOSAL SYSTEM  
HOWARD COUNTY HEALTH DEPARTMENT  
BUREAU OF ENVIRONMENTAL HEALTH**

\_\_\_\_\_ IS PERMITTED TO INSTALL  ALTER

ADDRESS: \_\_\_\_\_ PHONE NUMBER: \_\_\_\_\_

SUBDIVISION: Burntwoods LOT NUMBER: 6

ADDRESS: 14015 Castlebar PROPERTY OWNER: Robert Perry

SEPTIC TANK CAPACITY (GALLONS): 1000

PUMP CHAMBER CAPACITY (GALLONS): N/A

NUMBER OF BEDROOMS: 4

SQUARE FEET PER BEDROOM: \_\_\_\_\_

LINEAR FEET OF TRENCH REQUIRED: \_\_\_\_\_

TRENCHES:	Trench to be depth original grade.	feet wide.	Inlet feet below original grade.	feet below original grade.	Bottom maximum Effective area begins at feet below
LOCATION:					
PURPOSE:					

PLANS APPROVED: \_\_\_\_\_ DATE: 5/20/2002

- NOTE: PERMIT VOID AFTER 2 YEARS
- NOTE: CONTRACTOR RESPONSIBLE FOR SCHEDULING A PRE-CONSTRUCTION INSPECTION FOR ALL INSTALLATIONS
- NOTE: WATERTIGHT SEPTIC TANKS REQUIRED
- NOTE: ALL PARTS OF SEPTIC SYSTEM SHALL BE 100 FEET FROM ANY WATER WELL
- NOTE: MANHOLE RISERS REQUIRED ON ALL SEPTIC TANKS AND PUMP CHAMBERS

**NEITHER THE HOWARD COUNTY COUNCIL NOR THE HEALTH DEPARTMENT IS  
RESPONSIBLE FOR THE SUCCESSFUL OPERATION OF ANY SYSTEM  
PERMITTEE RESPONSIBLE FOR OBTAINING FINAL APPROVAL ON THIS PERMIT  
CALL 410-313-2640 FOR INSPECTION OF SEPTIC SYSTEM**

4516977

NOT TO SCALE

**TRENCH/DRAINFIELD DATA**

WIDTH                  INLET                  BOTTOM

NUMBER OF TRENCHES \_\_\_\_\_

TOTAL LENGTH \_\_\_\_\_

ABSORPTION AREA \_\_\_\_\_

DISTRIBUTION BOX LEVEL \_\_\_\_\_

DISTRIBUTION BOX BAFFLE \_\_\_\_\_

DISTRIBUTION BOX PORT \_\_\_\_\_

**SEPTIC TANK DATA**

SEPTIC TANK 1 LEVEL \_\_\_\_\_

CAPACITY \_\_\_\_\_ GAL

SEAM LOC \_\_\_\_\_

TANK LID DEPTH \_\_\_\_\_

BAFFLES \_\_\_\_\_

BAFFLE FILTER \_\_\_\_\_

MANHOLE LOC \_\_\_\_\_

6" PORT LOC \_\_\_\_\_

WATERTIGHT TEST \_\_\_\_\_

SEPTIC TANK 2 LEVEL \_\_\_\_\_

CAPACITY \_\_\_\_\_ GAL

SEAM LOC \_\_\_\_\_

TANK LID DEPTH \_\_\_\_\_

BAFFLES \_\_\_\_\_

BAFFLE FILTER \_\_\_\_\_

MANHOLE LOC \_\_\_\_\_

6" PORT LOC \_\_\_\_\_

WATERTIGHT TEST \_\_\_\_\_

ROAD

PRE-CONSTRUCTION \_\_\_\_\_

INSTALLATION \_\_\_\_\_

FINAL INSPECTOR \_\_\_\_\_ DATE OF APPROVAL \_\_\_\_\_