

PERMIT

Approved
8/9/77
TSD.

P 26457

A _____

SEWAGE DISPOSAL SYSTEM

MARYLAND STATE DEPARTMENT OF HEALTH

HOWARD COUNTY

ELLICOTT CITY

DISTRICT 5th

INDEXED

DATE 7/20/77

Charles L. Prince and/or Sylvan Pools IS PERMITTED TO INSTALL _____ ALTER X

ADDRESS 10865 Braeburn Road, Clarksville, Columbia, Md. PHONE 531-6611

A SEWAGE DISPOSAL SYSTEM LOCATED AT _____

SUBDIVISION Braeburn ROAD 10865 Braeburn Rd. LOT 13

PROPERTY OWNER Charles L. Prince

ADDRESS 10865 Braeburn Rd., Clarksville, Columbia, Md. 21044

SPECIFICATIONS

DRAIN FIELD _____ DEPTH _____ FEET, BOTTOM AREA _____ SQ. FT.

SEEPAGE PITS _____ ABSORBENT SIDE-WALL AREA _____ SQ. FT.

SEPTIC TANK CAPACITY _____ GALLONS

FOR GARBAGE GRINDER, INCREASE DISPOSAL AREA 22% & TANK CAPACITY 50%.

OTHER REPAIR- Invert of trenches to be 3 feet below original grade. ASTM 2729 plastic pipe. in accordance with attached drawing, Total 60 foot trench and maximum depth 10 feet below original grade.

NOTE: CALL FOR INSPECTION OF TRENCH BEFORE PLACING GRAVEL IN TRENCH.

OK seepage pit 420' sidewall area inu 3' max 10' - put vertical 4" perforated pipe in center OK to back fill.

PLANS APPROVED BY David O'Neill DATE 7/20/77

FILL SEPTIC TANK AND DISTRIBUTION BOX WITH WATER BEFORE CALLING FOR AN INSPECTION. COVER NO WORK UNTIL INSPECTED AND APPROVED.

NEITHER THE HOWARD COUNTY COMMISSIONERS NOR THE HEALTH DEPARTMENT IS RESPONSIBLE FOR THE SUCCESSFUL OPERATION OF ANY SYSTEM.

P-26457

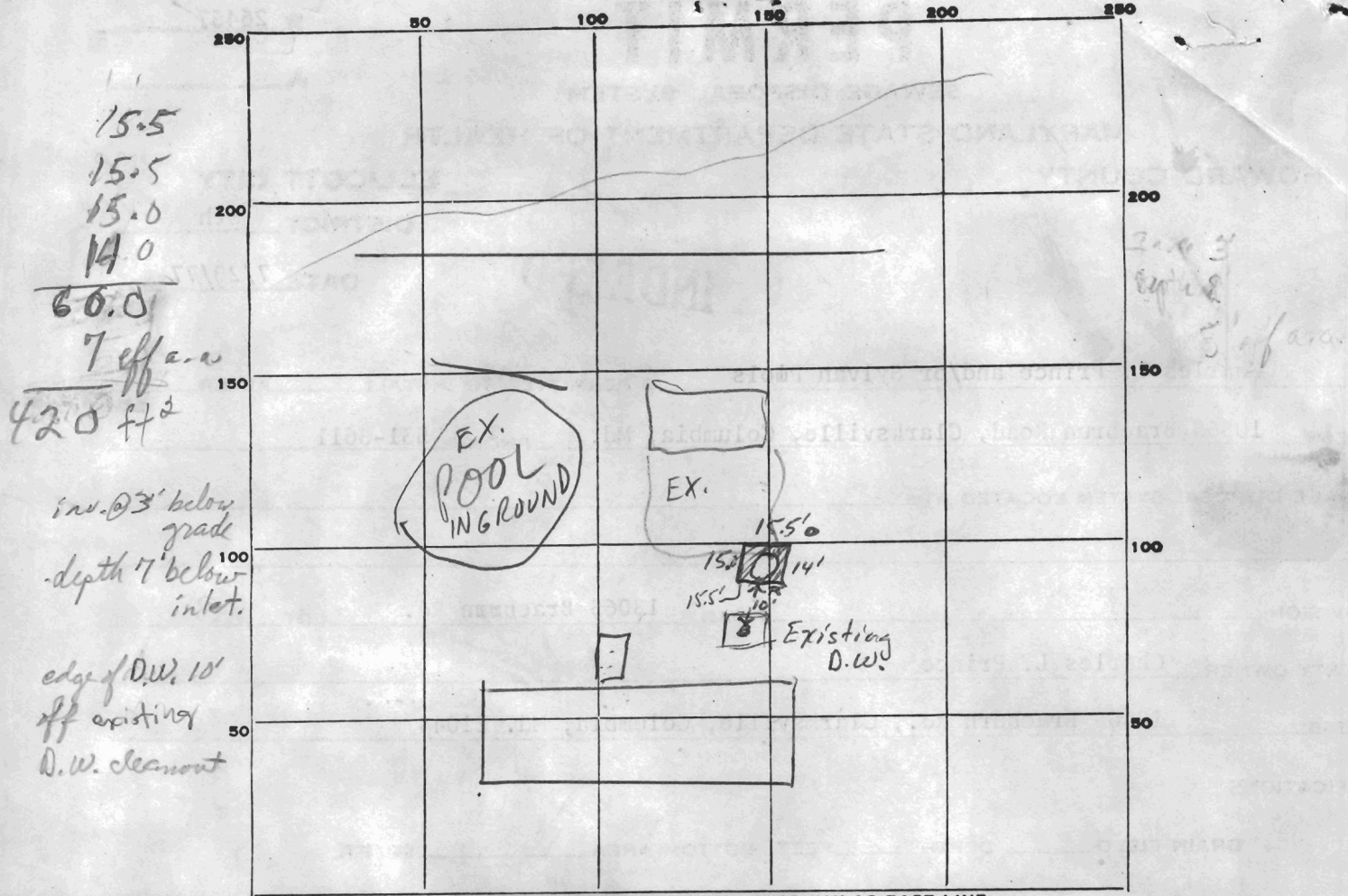

INDICATE NORTH. - NAME ADJOINING ROADWAY AS BASE LINE.

Braeburn Rd.

PERMIT CARD

SEPTIC TANK, LEVEL _____ CLEANOUTS _____

DISTRIBUTION BOX, LEVEL _____

TILE FIELD, DEPTH _____ FT. TRENCH WIDTH _____ FT.

GRAVEL DEPTH _____ IN. TOTAL LENGTH _____ FT.

NUMBER OF TRENCHES _____ TOTAL BOTTOM AREA _____

SEEPAGE PITS, INSIDE DIAMETER ^{perimeter} 60 FT. DEPTH BELOW INLET 7 FT.

ABSORBENT AREA 420 SQ. FT.

REMARKS _____

DATE SYSTEM APPROVED 8/9/77 INSPECTOR Thomas S. Ogb

1704
6/20/49

East

4' below grade

edge of pool

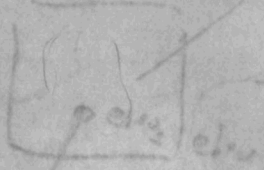

stop

0

10'

14' of trench
3' below grade
As to 2729 plastic

60' trench 14' 3'
max depth 10'

Old trapst pool 20' from edge of d/s
10' from edge of d/s

1/25/02 - 10AM
2/11/02 - Final

INDEXED PERMIT

ISSUE DATE: 01/23/02

P 516484

APPROVAL DATE: 2/11/02

A REPAIR

ON-SITE SEWAGE DISPOSAL SYSTEM HOWARD COUNTY HEALTH DEPARTMENT BUREAU OF ENVIRONMENTAL HEALTH

05-363829

Hatfields Equipment IS PERMITTED TO INSTALL ALTER

ADDRESS: 13785 Burntwoods Road, Glenelg PHONE NUMBER: 301-854-6172

SUBDIVISION: Braeburn I LOT NUMBER: 13

ADDRESS: 10865 Braeburn Road PROPERTY OWNER: Bolcy

SEPTIC TANK CAPACITY (GALLONS): 1,000 fiberglass

PUMP CHAMBER CAPACITY (GALLONS): N/A

NUMBER OF BEDROOMS: 3

SQUARE FEET PER BEDROOM: 180

LINEAR FEET OF TRENCH REQUIRED: 90-100 connected to existing 1977 pit/drywell.

TRENCHES:	Trench to be <u>3</u> feet wide. Inlet <u>4</u> feet below original grade. Bottom maximum depth <u>6</u> feet below original grade. Effective area begins at <u>4</u> feet below original grade. <u>2</u> feet of stone below distribution pipe.
LOCATION:	Install trench down hill of deck
PURPOSE:	Existing septic system has failed. Call for inspection when ground is opened so sanitarian can recommend repair.

PLANS APPROVED: MR/KG DATE: 1/25/02

- NOTE: PERMIT VOID AFTER 2 YEARS
- NOTE: CONTRACTOR RESPONSIBLE FOR SCHEDULING A PRE-CONSTRUCTION INSPECTION FOR ALL INSTALLATIONS
- NOTE: WATERTIGHT SEPTIC TANKS REQUIRED
- NOTE: ALL PARTS OF SEPTIC SYSTEM SHALL BE 100 FEET FROM ANY WATER WELL
- NOTE: MANHOLE RISERS REQUIRED ON ALL SEPTIC TANKS AND PUMP CHAMBERS

NEITHER THE HOWARD COUNTY COUNCIL NOR THE HEALTH DEPARTMENT IS RESPONSIBLE FOR THE SUCCESSFUL OPERATION OF ANY SYSTEM PERMITTEE RESPONSIBLE FOR OBTAINING FINAL APPROVAL ON THIS PERMIT CALL 410-313-2640 FOR INSPECTION OF SEPTIC SYSTEM

BUILDING PERMIT SIGNED AND RETURNED

3/25/03 B00140508 ENLARGE DECK + ENCLOSURE W/ SUNROOM

516484

Soil Profile "A"

NOT TO SCALE

VERY LARGE SWALE

- Micaceous gravelly sLLm
- MD Brn micaceous sLLm
- brn beige coarse sand 20-25% Rx
- Bottom

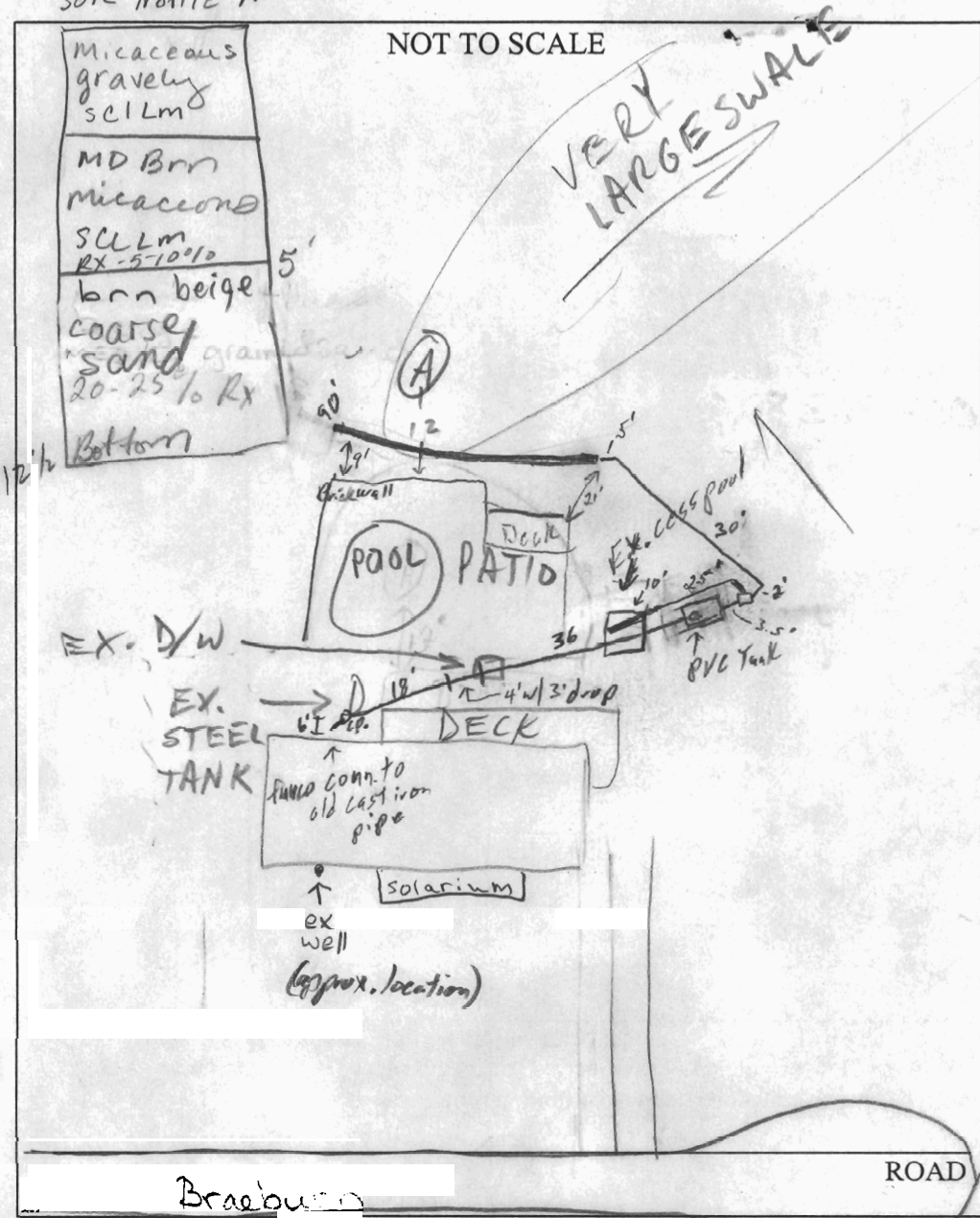

TRENCH/DRAINFIELD DATA		
WIDTH	INLET	BOTTOM
3'	4'	6'
NUMBER OF TRENCHES		1'
TOTAL LENGTH		90
ABSORPTION AREA		180
DISTRIBUTION BOX LEVEL		yes
DISTRIBUTION BOX BAFFLE		
DISTRIBUTION BOX PORT		No

SEPTIC TANK 1 LEVEL	
SEPTIC TANK 1 LEVEL	yes
CAPACITY	1500 GAL
SEAM LOC	PVC Tank
TANK LID DEPTH	1-2'
BAFFLES	yes
BAFFLE FILTER	no
MANHOLE LOC	Back-Buried
6" PORT LOC	Front
WATERTIGHT TEST	N/A

SEPTIC TANK 2 LEVEL	
CAPACITY	GAL
SEAM LOC	
TANK LID DEPTH	
BAFFLES	
BAFFLE FILTER	
MANHOLE LOC	
6" PORT LOC	
WATERTIGHT TEST	

PRE-CONSTRUCTION 1/25/02 Replace S.T. with a fiberglass septic tank. Keep one dry well, and add 1-100' trench (MARKS)

INSTALLATION 2/11/02 Ex. D/W & Steel tank abandoned. Inlet to Ex. Coss pool ∴ 1' lower than previously. OK to cover all work (S)

BUILDING PERMIT SIGNED

FINAL INSPECTOR *[Signature]*

DATE OF APPROVAL 2/11/02