

5/3/94 HSA

Final

PERMIT

SEWAGE DISPOSAL SYSTEM

DEPARTMENT OF HEALTH AND MENTAL HYGIENE

P 50049I

A REPAIR

DISTRICT 4th

HOWARD COUNTY HEALTH DEPARTMENT

BUREAU OF ENVIRONMENTAL HEALTH

~~XXXXXXX~~ 313-2640

DATE

DATE SYSTEM APPROVED 5/3/94

INSPECTOR C.F.

INDEXED

Jack Fyock Septic Service IS PERMITTED TO INSTALL _____ ALTER

ADDRESS _____ PHONE 988-9270

SUBDIVISION Forsythe Heights LOT 13C, 8A, 8B Comb ROAD 14576 Monticello Drive

PROPERTY OWNER Richard Oyster Ronald A. Kelly & Diane Kelly
14576 Monticello Drive Diane

ADDRESS _____

SEPTIC TANK CAPACITY _____ GALLONS

NUMBER OF BEDROOMS 3

25⁺ SQUARE FEET PER BEDROOM (Plus old system)

LINEAR FEET OF TRENCH REQUIRED 60⁺ Plus

REPAIR - PURPOSE - SEPTIC SYSTEM HAS FAILED

Call for inspection when ground is opened so sanitarian can recommend repair. 05/02/94

[5/3/94 (1) Trench off existing dry well as shown on back.]

(Please see back of this page and original system paperwork)

PLANS APPROVED BY CBD in field for "C.W." / CBD DATE 5/3/94

COVER NO WORK UNTIL INSPECTED AND APPROVED

NEITHER THE HOWARD COUNTY COUNCIL NOR THE HEALTH DEPARTMENT IS RESPONSIBLE FOR THE SUCCESSFUL OPERATION OF ANY SYSTEM

NOTE: CLEANOUT REQUIRED EVERY 70 FEET OF SEWER LINE AND/OR AT 90° SWEEPS IN LINES FROM HOUSE TO DRAIN FIELDS, 90° ELBOWS NOT ACCEPTABLE.

NOTE: ALL PARTS OF SEPTIC SYSTEMS (I.E. TANK, DISTRIBUTION BOX TRENCHES) TO BE 100 FEET FROM WELL (UNLESS OTHERWISE SPECIFICALLY AUTHORIZED)

NOTE: IF DEEP TRENCH(ES) ARE USED CALL FOR INSPECTION BEFORE AND AFTER PLACING GRAVEL IN TRENCH(ES)

NOTE: NO DRY WELL SHALL EXCEED 15 FOOT IN DIAMETER NO ABSORPTION TRENCH TO EXCEED 100 FEET IN LENGTH

NOTE: ALL PIPE FROM HOUSE TO SEPTIC TANK MUST BE CAST IRON OR SCHEDULE 35/40 PVC OR ABS

PERMIT VOID AFTER TWO YEARS

NOTE: INSTALL STAND PIPE ON SEPTIC TANK AND DRY WELL STAND PIPES MUST BE 6 INCHES IN DIAMETER CAST IRON. CONCRETE OR TERRA COTTA OR PVA OR ABS ACCEPTED. IF TOP OF SEPTIC TANK IS DEEPER THAN 3 FEET. MANHOLE TO GRADE REQUIRED.

NOTE: DISTRIBUTION BOXES MUST HAVE BAFFLES

***INSTALLER IS RESPONSIBLE FOR OBTAINING FINAL APPROVAL ON THIS PERMIT**

BLDG. PERMIT SIGNED
AND RETURNED 3-4-98

Smith B70110227
Gaines

P 50049I

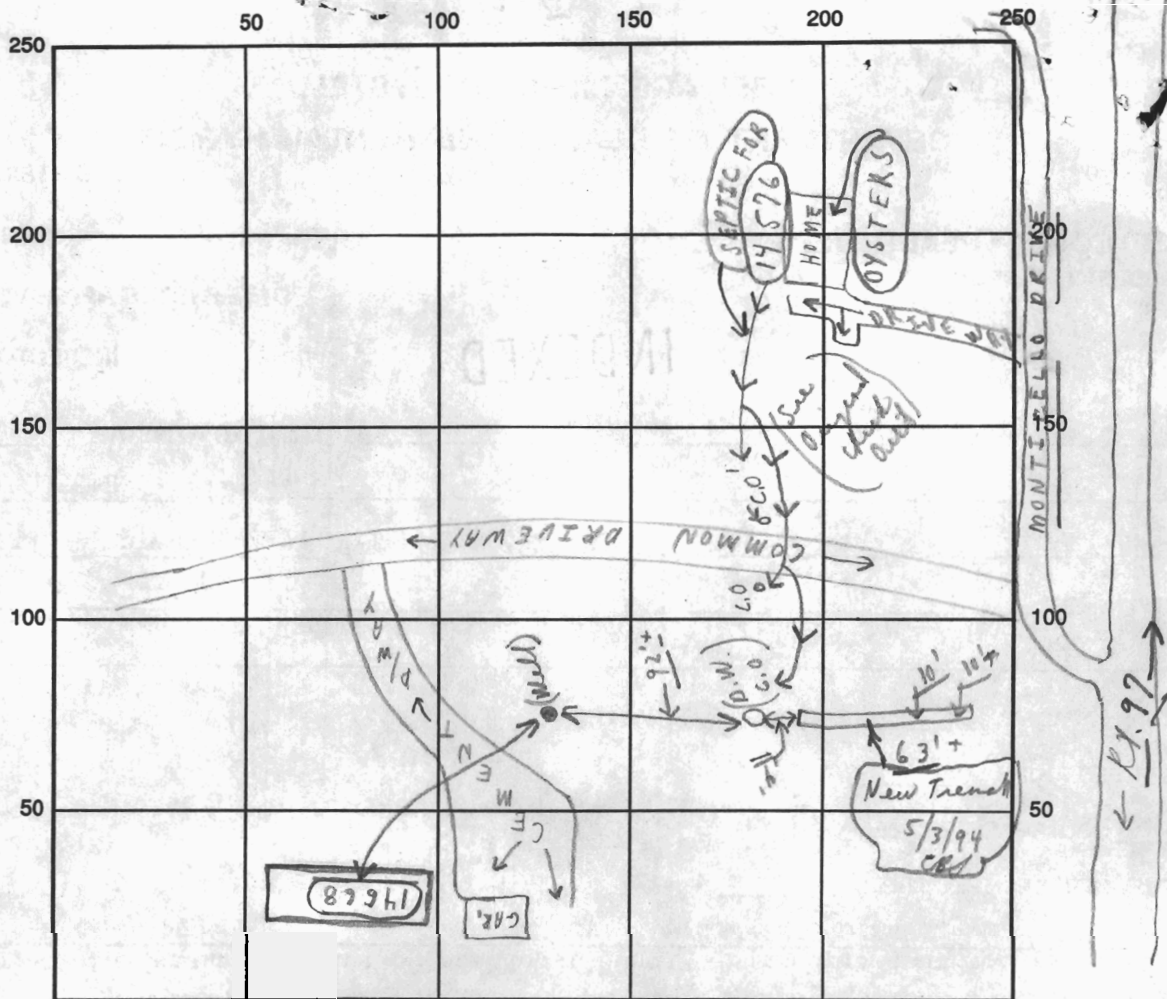

INDICATE NORTH - NAME ADJOINING ROADWAY AS BASE LINE

SEPTIC TANK LEVEL Existing CLEANOUTS Existing
 DISTRIBUTION BOX LEVEL (Very Existing Dry Well)
 DRAIN FIELD/TITLE DEPTH 10⁺ average FT. TRENCH WIDTH 2 FT. INLET DEPTH 4 FT.
 EFFECTIVE GRAVEL DEPTH 6 FT. TOTAL LENGTH 63⁺ plus FT.
 NUMBER OF TRENCHES 1 ONE SIDEWALL/BOTTOM AREA 378⁺ SQ. FT. (plus old system)
 DRYWALL INSIDE DIAMETER ~ FT. EFFECTIVE DEPTH BELOW INLET ~ FT.
 ABSORBENT AREA 378 SQ. FT. +(old system)

REMARKS: 5/3/94 1 Trench ok for stone as go!! Final -
material on site to finish - C.B.
(See original septic also of 8/30/82)

DATE SYSTEM APPROVED 5/3/94 INSPECTOR Charles Bryan Stecker