

1/22/02
NOON
Tank Only

ISSUE DATE: 1/15/02
APPROVAL DATE: 4/16/02

PERMIT INDEXED

P 516469-B
A REPAIR

ON-SITE SEWAGE DISPOSAL SYSTEM HOWARD COUNTY HEALTH DEPARTMENT BUREAU OF ENVIRONMENTAL HEALTH 04-332962

Jack Fyock Septic Service IS PERMITTED TO INSTALL ALTER

ADDRESS: PO Box 89, Glenelg, MD 21737 PHONE NUMBER: 410-988-9270

SUBDIVISION: Forsythe Heights LOT NUMBER: 13C, 8A, 8B

ADDRESS: 14576 Monticello Drive PROPERTY OWNER: Ronald Kelly

SEPTIC TANK CAPACITY (GALLONS): NEW 1250

PUMP CHAMBER CAPACITY (GALLONS): -

NUMBER OF BEDROOMS: 4 w/ADDITION PROPOSED

SQUARE FEET PER BEDROOM: 210

LINEAR FEET OF TRENCH REQUIRED: 60⁺

TRENCHES:	Trench to be 2 feet wide. Inlet 4 feet below original grade. Bottom maximum depth 9 feet below original grade. Effective area begins at 9 feet below original grade. feet of stone below distribution pipe.
LOCATION:	
PURPOSE:	In support of building permit - Call for inspection when ground is opened so sanitarian can recommend repair.

PLANS APPROVED: Mark Rifkin DATE: 1/7/01

- NOTE: PERMIT VOID AFTER 2 YEARS
- NOTE: CONTRACTOR RESPONSIBLE FOR SCHEDULING A PRE-CONSTRUCTION INSPECTION FOR ALL INSTALLATIONS
- NOTE: WATERTIGHT SEPTIC TANKS REQUIRED
- NOTE: ALL PARTS OF SEPTIC SYSTEM SHALL BE 100 FEET FROM ANY WATER WELL
- NOTE: MANHOLE RISERS REQUIRED ON ALL SEPTIC TANKS AND PUMP CHAMBERS

NEITHER THE HOWARD COUNTY COUNCIL NOR THE HEALTH DEPARTMENT IS RESPONSIBLE FOR THE SUCCESSFUL OPERATION OF ANY SYSTEM PERMITTEE RESPONSIBLE FOR OBTAINING FINAL APPROVAL ON THIS PERMIT CALL 410-313-2640 FOR INSPECTION OF SEPTIC SYSTEM

P516469-B

NOT TO SCALE

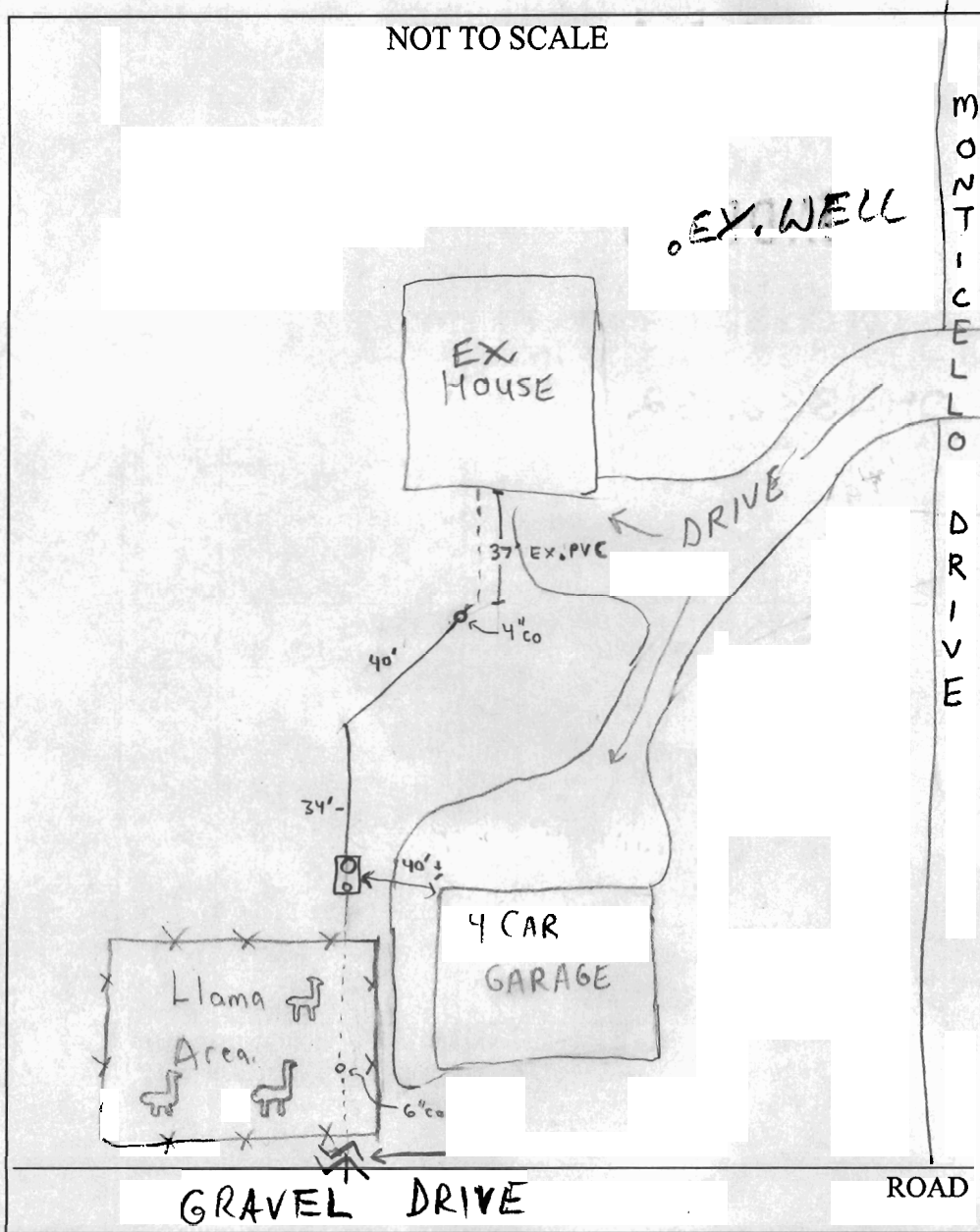

TRENCH/DRAINFIELD DATA		
WIDTH	INLET	BOTTOM
2	4	9
NUMBER OF TRENCHES		1
TOTAL LENGTH		64'
ABSORPTION AREA		320 sq
DISTRIBUTION BOX LEVEL		—
DISTRIBUTION BOX BAFFLE		—
DISTRIBUTION BOX PORT		—

SEPTIC TANK DATA	
SEPTIC TANK 1 LEVEL	<input checked="" type="checkbox"/>
CAPACITY	1500 GAL
SEAM LOC	Top
TANK LID DEPTH	4'
BAFFLES	front & rear
BAFFLE FILTER	NA
MANHOLE LOC	Front
6" PORT LOC	Rear
WATERTIGHT TEST	NA
SEPTIC TANK 2 LEVEL	NA
CAPACITY	_____ GAL
SEAM LOC	_____
TANK LID DEPTH	_____
BAFFLES	_____
BAFFLE FILTER	_____
MANHOLE LOC	_____
6" PORT LOC	_____
WATERTIGHT TEST	_____

PRE-CONSTRUCTION _____

INSTALLATION 1/22/01 - OLD TANK ABANDONED, NEW 1500 GALLON INSTALLED & MOVED,

INSTALLATION OF NEW TRENCH TO BE DONE LATER IN SPRING - (SRK/SO/UG)

4/16/02 Old trench dry, OK - OK to cover new trench (SO)

FINAL INSPECTOR S. Oster

DATE OF APPROVAL 4/16/02