

8900
 DATE RECEIVED (OWNER ONLY)
 DATE WELL COMPLETED 12-25-73
 163

WATER RESOURCES ADMINISTRATION
 TAYLOR STATE OFFICE BLDG., ANNAPOLIS, MD. 21401
WELL COMPLETION REPORT

THIS REPORT MUST BE SUBMITTED WITHIN 30 DAYS AFTER WELL COMPLETION
FILL IN THIS FORM COMPLETELY
 COUNTY NUMBER

DEPTH OF WELL
 300
 (TO NEAREST FOOT)

PERMIT NO. FROM "PERMIT TO DRILL WELL"
 40-79-0424
 DRILLER'S IDENTIFICATION NO. 42

OWNER: *Richard J. ...*
 POST OFFICE: *Clintonville, Pa.*

WELL LOG

STATE THE KIND OF FORMATIONS PENETRATED, THEIR COLOR, DEPTH, THICKNESS AND IF WATER BEARING

DESCRIPTION (SEE ADDITIONAL SHEETS IF NECESSARY)	FEET FROM	TO	WATER BEARING
<i>Light</i>	0	5	
	2	1	
	10	20	

GROUTING RECORD

WELL HAS BEEN GROUTED (CIRCLE APPROPRIATE BOX) YES NO

TYPE OF GROUTING MATERIAL (CIRCLE BOX)
 CEMENT BESTONITE CLAY

NO. OF BAGS 15 NO. OF POUNDS 1400
 GALLONS OF WATER 84

DEPTH OF GROUT SEAL (TO NEAREST FOOT)
 FROM 0 FT. TO 45 FT.
 (ENTER 0 IF FROM SURFACE)

PUMPING TEST

HOURS PUMPED (TO NEAREST HOUR) 1
 PUMPING RATE (GALLONS PER MINUTE TO NEAREST GALLON) 1
 METHOD USED TO MEASURE PUMPING RATE *bucket*

WATER LEVEL (DISTANCE FROM LAND SURFACE)
 BEFORE PUMPING 60 (NEAREST FOOT)
 DURING PUMPING 300 (NEAREST FOOT)

TYPE OF PUMPED USED (CIRCLE APPROPRIATE BOX)
 AIR PISTON TURBINE
 CENTRIFUGAL ROTARY OTHER (DESCRIBE BELOW)
 JET SUBMERSIBLE

CASING RECORD

CASING TYPES
 INSERT APPROPRIATE CODE BELOW
 ST STEEL CO CONCRETE
 PL PLASTIC OT OTHER

MAIN CASING TYPE 51
 NOMINAL DIAMETER (NEAREST INCH) 6
 TOTAL DEPTH OF MAIN CASING (NEAREST FOOT) 72

OTHER CASING (IF USED)

DIAMETER (INCH) _____ DEPTH (FEET) FROM _____ TO _____

PUMP INSTALLED

TYPE OF PUMP (WRITE APPROPRIATE LETTER IN BOX - SEE ABOVE) A, C, J, P, R, S, T, O

DRILLER WILL INSTALL PUMP (CIRCLE APPROPRIATE BOX) YES NO

CAPACITY:
 GALLONS PER MINUTE (TO NEAREST GALLON) _____
 PUMP HORSE POWER _____
 PUMP COLUMN LENGTH (NEAREST FOOT) 43

SCREEN RECORD

SCREEN TYPE (CIRCLE APPROPRIATE BOX)
 ST STEEL BR BRASS OR BRONZE HO OPEN HOLE
 PL PLASTIC OT OTHER

DEPTH (NEAREST WHOLE FOOT)

FROM _____ TO _____

DEPTH (NEAREST WHOLE FOOT)
 1 2 3 4 5 6 7 8 9 10 11 12 13 14 15 16 17 18 19 20 21 22 23 24 25 26 27 28 29 30 31 32 33 34 35 36 37 38 39 40 41 42 43 44 45 46 47 48 49 50 51

CASING HEIGHT (CIRCLE APPROPRIATE BOX AND ENTER CASING HEIGHT)
 ABOVE LAND SURFACE
 BELOW LAND SURFACE 2 (NEAREST FOOT)

CIRCLE APPROPRIATE BOXES

A WELL WAS ABANDONED AND SEALED WHEN THIS WELL WAS COMPLETED

ELECTRIC LOG OBTAINED

TEST WELL CONVERTED TO PRODUCTION WELL

I HEREBY CERTIFY THAT I HAVE COMPLIED WITH ALL PROVISIONS STATED ON THE ABOVE-CAPTIONED "PERMIT TO DRILL WELL", AND THAT INFORMATION CONTAINED HEREIN IS TRUE, ACCURATE, AND COMPLETE TO THE BEST OF MY KNOWLEDGE, INFORMATION AND BELIEF.

OWNER NAME: *Richard J. ...*
 ADDRESS: *...*
 STATE: *...*

DIAMETER OF SCREEN _____ (NEAREST INCH)
 FROM _____ TO _____

SPRINKLER PACK _____

IF WELL DRILLED WAS A FLOWING WELL (CIRCLE BOX)

OWNER USE ONLY - NOT TO BE FILLED IN BY DRILLER
 TO TELESCOPE CASING LOG INDICATOR 72 74 TO 76 TO OTHER DATA AVAILABLE

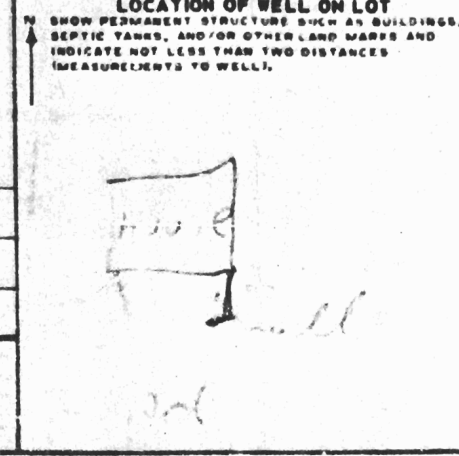

Attn: Kacie Noonan

Phone: 410-313-1771

Fax: 410-313-2648

January 15, 2004

Dear Kacie,

Please refer to our talks regarding adding a one bed room suite at our house on 7416 Cherry Tree Drive, Clarksville, MD 21029. As indicated by you that we should update the percolation test, we have scheduled the test for next Wednesday, January 21, 2004, at 9:00 AM.

If the test indicates that additional trenches are required or an effluent filter is needed, we will install the same at the time of new construction.

We have already upgraded the septic tank to 1500 gallons last summer when we expanded and remodeled the kitchen. Our house has five bed rooms and after the new bed room addition is complete, we will convert one of the existing bed room to a study. The number of bed rooms will remain at five. We therefore request that we should be permitted the new construction without increasing the capacity of the existing septic tank. If a variance is required for this, we request that we be granted the same.

Very truly yours,

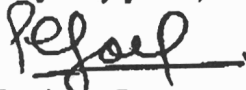

Pradeep Goel

(For Kavita and Sandor Mester)