

APPLICATION

PERCOLATION TESTING

A 38353

P _____

HOWARD COUNTY HEALTH DEPARTMENT
BUREAU OF ENVIRONMENTAL HEALTH
P.O. BOX 476 ELLICOTT CITY, MARYLAND 21043
TELEPHONE: 461-9933

*1/30/87
perc OK'd pending
approved plat*

DISTRICT _____

DATE 10-14-86

TO: THE COUNTY HEALTH OFFICER
ELLICOTT CITY, MARYLAND

I, HEREBY, APPLY FOR THE NECESSARY TEST IN ORDER TO CONSTRUCT (OR RECONSTRUCT) A SEWAGE DISPOSAL SYSTEM.

PROPERTY OWNER LANUZA, RAYMOND 384-2725

ADDRESS _____ PHONE _____

PROSPECTIVE BUYER Ronald Carter

ADDRESS 8388 Court Ave., Ellicott City, Md. 21043 461-2855

PROPERTY LOCATION:

SUBDIVISION Hakes Property LOT NO. SIX

ROAD AND DESCRIPTION Hobbs Road 2831 Glenwood Springs Dr Prelim. 4/29/87

TAX MAP 14 PARCEL # 83,87,202

SIZE OF LOT 3+ acres TYPE BLDG. SFD
(SINGLE FAMILY DWELLING OR COMMERCIAL)

THE SYSTEM INSTALLED UNDER THIS APPLICATION IS ACCEPTABLE ONLY UNTIL PUBLIC FACILITIES BECOME AVAILABLE. I FULLY UNDERSTAND THE FEE CONNECTED WITH THE FILING OF THIS PERC. TEST APPLICATION IS NON-REFUNDABLE UNDER ANY CIRCUMSTANCES. I ALSO AGREE TO COMPLY WITH ALL M.O.S.H.A. REQUIREMENTS IN TESTING THIS LOT.

Ronald J. Carter
(SIGNATURE OF APPLICANT)

APPROVED BY _____ FOR _____ DATE _____

REJECTED BY _____ FOR _____ DATE _____

HOLD PENDING FURTHER TESTS _____ DATE _____

REASONS FOR REJECTION OR HOLDING for certified hole locations & sub-plat

BLDG. PERMIT SIGNED
AND RETURNED 10-5-88

BP21720SM

THIS IS NOT A PERMIT

ROAD

$\bar{x} = 6^+ \text{ MIN}$
 WET 3 1/2
 MAX 7 1/2
 180 1/2 / 160 RM

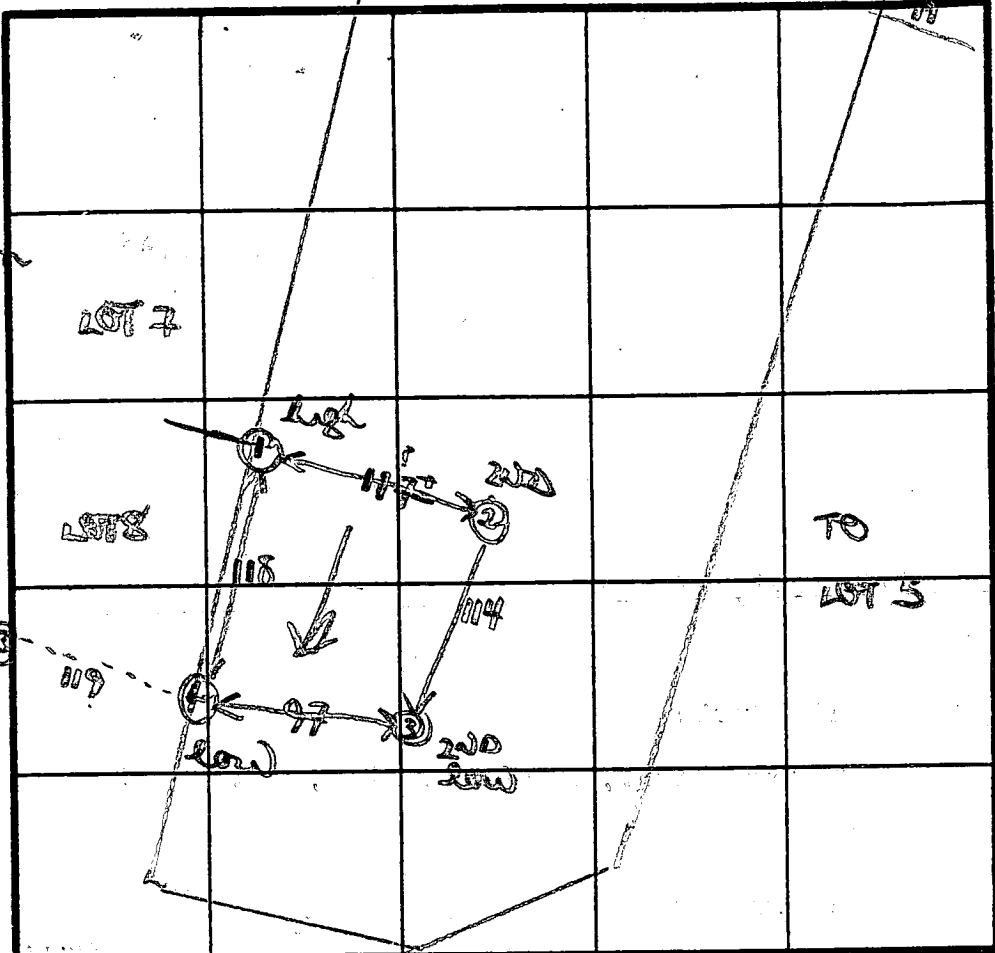

INDICATE NORTH - NAME ADJOINING ROADWAY AS BASE LINE.

SOIL PROFILE

orange/brown
 clay/silt
 loam
 3'
 to orange
 brown
 silty
 loam
 ↓
 11'D

2+3

clumpy/gritty
 orange/brown
 clay loam
 3 1/2'
 to orange/
 yellow brown
 silty loam
 w/ 5-10% small
 black rock
 frags
 11 1/2'D

clumpy/gritty
 red/orange
 brown clay
 clay loam
 3 1/2'
 to brown
 orange silty
 loam
 4-10%
 small scattered

DATE	TEST NO.	DEPTH	PRE-WET		TEST - 1" DROP		TIME	
			START	STOP	START	STOP		
1/2/84	①	3 1/2 S	958	1000	1000	1004	4 MIN	
		7 1/2 M	958	1000	1000	1002	2 MIN	
		11'D	bottom (see profile)					
	②	4'S	1004	1008	1008	1012	4 MIN	
		11 1/2'D	bottom (see profile)					
		4 1/2 S	1010	1017	1017	1023	10 MIN	
	③	11 1/2'D	bottom (see profile)					
		3 1/2 S	1020	1028	1028	1038	10 MIN	
		7 1/2 M	1020	1026	1026	1033	7 MIN	
	④	11 1/2'D	bottom (see profile)					

hole #1 triple common hole (lots 6, 7, 8)

REMARKS: _____
 TYPE OF SOIL: clumpy gritty orange clays & loams; orange/brown silty loams
 TESTED BY: B. Dylan ALSO PRESENT: Phil, Cliff, Kathy