



Building Permit Application

Howard County Maryland
Department of Inspections, Licenses and Permits
3430 Court House Drive
Permits: 410-313-2455
www.howardcountymd.gov

Date Received: _____

Permit No.: _____

Building Address: 5610 Chamblis Drive
 City: Clarksville State: MD Zip Code: 21029
 Suite/Apt. # _____ SDP/WP/BA #: _____
 Census Tract: _____ Subdivision: _____
 Section: _____ Area: _____ Lot: _____
 Tax Map: 034 Parcel: 015 Grid: 05
 Zoning: _____ Map Coordinates: _____ Lot Size: 99 Acs

Existing Use: _____
 Proposed Use: IN-GROUND SWIMMING POOL + SPA
 Estimated Construction Cost: \$ 100k
 Description of Work: 42' x 22' IN-GROUND POOL WITH AUTO COVER + VANISHING EDGE. SPA 10' - FILLED BY TRUCK. FENCE W/BOARD

Occupant or Tenant: _____
 Was tenant space previously occupied? Yes No
 Contact Name: _____
 Address: _____
 City: _____ State: _____ Zip Code: _____
 Phone: _____ Fax: _____
 Email: _____

Property Owner's Name: George Doetsch
 Address: 5610 Chamblis
 City: Clarksville State: MD Zip Code: 21029
 Phone: _____ Fax: _____
 Email: _____

Applicant's Name & Mailing Address, (If other than stated herein)
 Applicant's Name: CUSTOM HOME POOLS
 Address: _____
 City: _____ State: _____ Zip Code: _____
 Phone: _____ Fax: _____
 Email: _____

Contractor Company: CUSTOM HOME POOLS INC
 Contact Person: MIKE BEAVAN
 Address: 3020 SOBUS DR
 City: West Friendship State: MD Zip Code: 21784
 License No.: 124874
 Phone: 410 489-9890 Fax: _____
 Email: CUSTOMHOMEPOOLS@VERIZON.NET

Engineer/Architect Company: _____
 Responsible Design Prof.: _____
 Address: _____
 City: _____ State: _____ Zip Code: _____
 Phone: _____ Fax: _____
 Email: _____

Commercial Building Characteristics	Residential Building Characteristics	
Height:	<input type="checkbox"/> SF Dwelling <input type="checkbox"/> SF Townhouse	
No. of stories:	Depth	Width
Gross area, sq. ft./floor:	1 st floor:	
	2 nd floor:	
Area of construction (sq. ft.):	Basement:	
	<input type="checkbox"/> Finished Basement	
Use group:	<input type="checkbox"/> Unfinished Basement	
	<input type="checkbox"/> Crawl Space	
Construction type:	<input type="checkbox"/> Slab on Grade	
<input type="checkbox"/> Reinforced Concrete	No. of Bedrooms:	
<input type="checkbox"/> Structural Steel	Multi-family Dwelling	
<input type="checkbox"/> Masonry	No. of efficiency units:	
<input type="checkbox"/> Wood Frame	No. of 1 BR units:	
<input type="checkbox"/> State Certified Modular	No. of 2 BR units:	
	No. of 3 BR units:	
	Other Structure:	
	Dimensions:	
➤ Roadside Tree Project Permit	Footings:	
<input type="checkbox"/> Yes <input type="checkbox"/> No	Roof:	
Roadside Tree Project Permit #	<input type="checkbox"/> State Certified Modular	
	<input type="checkbox"/> Manufactured Home	

Utilities	
Water Supply	
<input type="checkbox"/> Public	
<input checked="" type="checkbox"/> Private	
Sewage Disposal	
<input type="checkbox"/> Public	
<input checked="" type="checkbox"/> Private	
Electric:	<input checked="" type="checkbox"/> Yes <input type="checkbox"/> No
Gas:	<input type="checkbox"/> Yes <input type="checkbox"/> No
Heating System	
<input type="checkbox"/> Electric	<input type="checkbox"/> Oil
<input type="checkbox"/> Natural Gas	<input checked="" type="checkbox"/> Propane Gas
<input type="checkbox"/> Other:	
Sprinkler System:	
<input type="checkbox"/> Yes	<input type="checkbox"/> No
Grading Permit Number:	
Building Shell Permit Number:	

THE UNDERSIGNED HEREBY CERTIFIES AND AGREES AS FOLLOWS: (1) THAT HE/SHE IS AUTHORIZED TO MAKE THIS APPLICATION; (2) THAT THE INFORMATION IS CORRECT; (3) THAT HE/SHE WILL COMPLY WITH ALL REGULATIONS OF HOWARD COUNTY WHICH ARE APPLICABLE THERETO; (4) THAT HE/SHE WILL PERFORM NO WORK ON THE ABOVE REFERENCED PROPERTY NOT SPECIFICALLY DESCRIBED IN THIS APPLICATION; (5) THAT HE/SHE GRANTS COUNTY OFFICIALS THE RIGHT TO ENTER ONTO THIS PROPERTY FOR THE PURPOSE OF INSPECTING THE WORK PERMITTED AND POSTING NOTICES.

Applicant's Signature: [Signature] Print Name: MIKE BEAVAN
 Email Address: MIKE@CUSTOMHOMEPOOLS.COM Date: _____
 Title/Company: OWNER CUSTOM HOME POOLS

Checks Payable to: DIRECTOR OF FINANCE OF HOWARD COUNTY
 PLEASE WRITE NEATLY & LEGIBLY
 -FOR OFFICE USE ONLY-

AGENCY	DATE	SIGNATURE OF APPROVAL	DPZ SETBACK INFORMATION	Filing Fee	\$
State Highways			Front:	Permit Fee	\$
Building Officials			Rear:	Tech Fee	\$
PSZA (Zoning)			Side:	Excise Tax	\$
PSZA (Engineering)			Side St.:	PSFS	\$
Health	<u>3/12/2014</u>	<u>[Signature]</u>	All minimum setbacks met? <input type="checkbox"/> Yes <input type="checkbox"/> No	Guaranty Fund	\$
Is Sediment Control approval required for issuance? <input type="checkbox"/> Yes <input type="checkbox"/> No			Is Entrance Permit Required? <input type="checkbox"/> Yes <input type="checkbox"/> No	Add'l per Fee	\$
<input type="checkbox"/> CONTINGENCY CONSTRUCTION START			Historic District? <input type="checkbox"/> Yes <input type="checkbox"/> No	Total Fees	\$
			Lot Coverage for New Town Zone:	Sub-Total Paid	\$
			SDP/Red-line approval date:	Balance Due	\$
				Check	#

GLEN MARY ESTATES
 LOTS 3,4,5, AND 6
 PLAT No. 12801
 LOT No. 6

FOUNDATION DETAIL
 SCALE: 1" = 30'

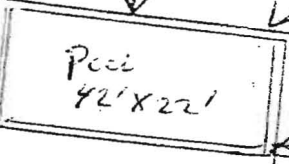
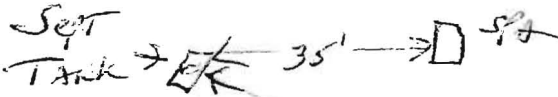
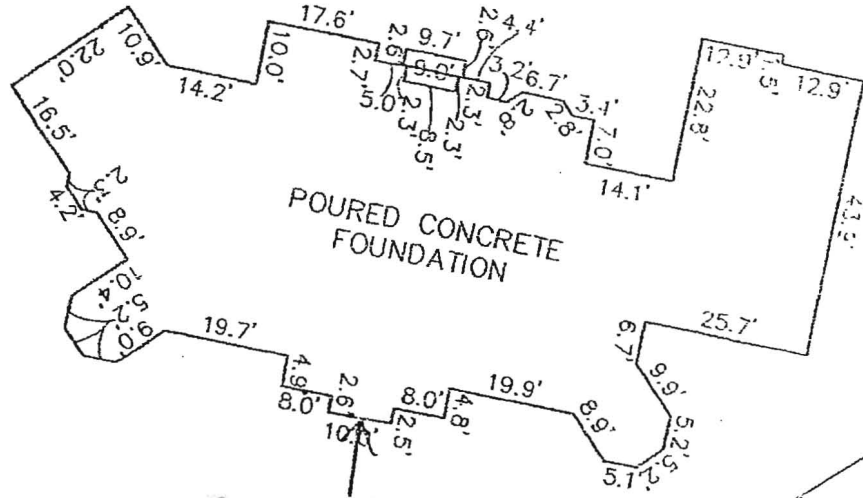

Pool Equipment etc.

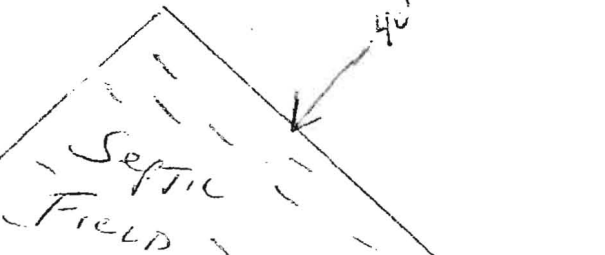

GLEN MARY ESTATES
 LOTS 3,4,5, AND 6
 PLAT No. 12801
 LOT No. 6
 5610 SE CHAMBLIS DRIVE
 5TH ELECTION DISTRICT
 HOWARD COUNTY, MARYLAND
 SCALE: 1" = 200' DATE: 3-11-14

APPROVED
 WALTON BUILDING PERMIT
 BP# _____ A# _____
 DATE: 3/12/2014
 inground pool + spa
 approved as described

Sheet 2 of 2 detail

NOTES: 99 ACRES
 property line to pool
 over 300'

CHAMBLIS DRIVE

DRIVE

N28°03'59"E

574.50'

60' BRL

LOT 13

ERIC M. FRIPSTEIN
BRADWATER EST. 43
LIBER 3509 FOLIO DEC
ZONED RC-DEC

GLEN MARY EST.
PLAT # 12801
ZONED RC-DEC

153.84'

S30°47'41"W 11.22'

N59°12'12"W

N59°12'12"W 701.40'

30' BRL

S85°03'06"E
297.58'

N42°55'37"E

195.00'

30' BRL

SEE
DETAIL

173.8'

2637'

WELL HO-81-0153

WELL HO-95-1945
Pool
Swimmers

N30°47'46"E

299.00'

30' BRL

555.0'

SEWER
TANK

LOT 2
GLEN MARY EST.
PLAT # 5471
ZONED RC

1126°43'20"1
1205.33'

60' BRL

Pool 42'x22'
spa 10'x10'

APPROVED
WALK-THRU BUILDING PERMIT
BP# _____ A# _____ DATE: 3/12/2014
APP. SAN *Builder*
DESC. OF WORK: *in ground pool + spa*
approved as described
Sheet 1 of 2

LOT 6

GLEN MARY ESTATES
LOTS 3, 4, 5, AND 6
PLAT No. 12801
LOT No. 6

5610 SE CHAMBLIS DRIVE

5TH ELECTION DISTRICT

HOWARD COUNTY, MARYLAND

SCALE: 1" = 200' DATE 3-11-14

30' BRL

N45°12'12"W

75' BRL

166.014'

74.099'