

Walk thru

Permits: 410-313-2455
 Inspections: 410-313-1810
 Automated Line: 410-313-3800

Howard County Building/Fire Permit Application
 Department of Inspections, Licenses & Permits
 3430 Court House Drive
 Ellicott City, MD 21043

Permit Number:

Building Address: 2430 Browns Bridgetd Highland 20777

Suite/Apt. # _____ SDP/WP/BA #: _____

Census Tract: _____ Subdivision: Greenwood Farms

Section: _____ Area: _____ Lot: 17

Tax Map: 40 Parcel: 158 Grid: 18

Zoning: _____ Map Coordinates: _____ Lot Size: 1.00

Existing Use: SFD

Proposed Use: Inground pool

Estimated Construction Cost: \$ 30,000.00

Description of Work: 40' x 20' inground concrete pool, depth 3' to 8', fence to code, filled by truck

Occupant or Tenant: _____

Was tenant space previously occupied? Yes No

Contact Name: _____

Address: _____

City: _____ State: _____ Zip Code: _____

Phone: _____ Fax: _____

Email: _____

Property Owner's Name: Patricia Konyne

Address: 7430 Brown Bridge Rd

City: Highland State: MD Zip Code: 20777

Home Phone: 2403386808 Work Phone: _____

Applicant's Name & Mailing Address, (If other than stated herein):
Karen Rowley
293 Southland Ct Dunkirk MD 20754

Phone: 410 507 7705 Fax: _____

Email: kkkpermits05@yahoo.com

Contractor Company: Anthony + Sylvan Pools

Contact Person: Karen Rowley

Address: 344 C Ritchie Hwy

City: Severna Park State: MD Zip Code: 21146

License No.: 95872

Phone: _____ Fax: _____

Email: _____

Engineer/Architect Company: _____

Responsible Design Prof.: _____

Address: _____

City: _____ State: _____ Zip Code: _____

Phone: _____ Fax: _____

Email: _____

BUILDING DESCRIPTION - COMMERCIAL

Building Characteristics	Utilities
Height:	<u>Water Supply</u>
No. of stories:	<input type="checkbox"/> Public
Gross area, sq. ft./floor:	<input type="checkbox"/> Private
	<u>Sewage Disposal</u>
Area of construction (sq. ft.):	<input type="checkbox"/> Public
	<input type="checkbox"/> Private
Use group:	Electric: <input type="checkbox"/> Yes <input type="checkbox"/> No
	Gas: <input type="checkbox"/> Yes <input type="checkbox"/> No
<u>Construction type:</u>	<u>Heating System</u>
<input type="checkbox"/> Reinforced Concrete	<input type="checkbox"/> Electric <input type="checkbox"/> Oil
<input type="checkbox"/> Structural Steel	<input type="checkbox"/> Natural Gas <input type="checkbox"/> Propane Gas
<input type="checkbox"/> Masonry	<u>Sprinkler System:</u>
<input type="checkbox"/> Wood Frame	<input type="checkbox"/> N/A
<input type="checkbox"/> State Certified Modular	<input type="checkbox"/> Full
<input checked="" type="checkbox"/> <u>Roadside Tree Project Permit</u>	<input type="checkbox"/> Partial
<input type="checkbox"/> Yes <input type="checkbox"/> No	<input type="checkbox"/> Other Suppression
<u>Roadside Tree Project Permit #</u>	No. of Heads:

BUILDING DESCRIPTION - RESIDENTIAL

Building Characteristics	Utilities
<input type="checkbox"/> SF Dwelling <input type="checkbox"/> SF Townhouse	<u>Water Supply</u>
<u>Depth</u> <u>Width</u>	<input type="checkbox"/> Public
1 st floor:	<input checked="" type="checkbox"/> Private
2 nd floor:	<u>Sewage Disposal</u>
Basement:	<input type="checkbox"/> Public
<input type="checkbox"/> Finished Basement	<input checked="" type="checkbox"/> Private
<input type="checkbox"/> Unfinished Basement	Electric: <input checked="" type="checkbox"/> Yes <input type="checkbox"/> No
<input type="checkbox"/> Crawl Space	Gas: <input type="checkbox"/> Yes <input checked="" type="checkbox"/> No
<input type="checkbox"/> Slab on Grade	<u>Heating System</u>
No. of Bedrooms:	<input type="checkbox"/> Electric
<u>Multi-family Dwelling</u>	<input type="checkbox"/> Oil
No. of efficiency units:	<input type="checkbox"/> Natural Gas
No. of 1 BR units:	<input type="checkbox"/> Propane Gas
No. of 2 BR units:	
No. of 3 BR units:	
Other Structure:	
Dimensions:	
Footings:	<input checked="" type="checkbox"/> <u>Roadside Tree Project Permit</u>
Roof:	<input type="checkbox"/> Yes <input checked="" type="checkbox"/> No
<input type="checkbox"/> State Certified Modular	<u>Roadside Tree Project Permit #</u>
<input type="checkbox"/> Manufactured Home	

THE UNDERSIGNED HEREBY CERTIFIES AND AGREES AS FOLLOWS: (1) THAT HE/SHE IS AUTHORIZED TO MAKE THIS APPLICATION; (2) THAT THE INFORMATION IS CORRECT; (3) THAT HE/SHE WILL COMPLY WITH ALL REGULATIONS OF HOWARD COUNTY WHICH ARE APPLICABLE THERETO; (4) THAT HE/SHE WILL PERFORM NO WORK ON THE ABOVE REFERENCED PROPERTY NOT SPECIFICALLY DESCRIBED IN THIS APPLICATION; (5) THAT HE/SHE GRANTS COUNTY OFFICIALS THE RIGHT TO ENTER ONTO THIS PROPERTY FOR THE PURPOSE OF INSPECTING THE WORK PERMITTED AND POSTING NOTICES.

Karen Rowley
 Applicant's Signature

Email Address
Anthony + Sylvan Pools

Title/Company

Karen Rowley
 Print Name

10/31/2013
 Date

Checks Payable to: DIRECTOR OF FINANCE OF HOWARD COUNTY
 PLEASE WRITE NEATLY & LEGIBLY
 -FOR OFFICE USE ONLY-

AGENCY	DATE	SIGNATURE OF APPROVAL
State Highways		
Building Officials		
PSZA (Zoning)		
PSZA (Engineering)		
Health		<u>Dana Barrett</u>
Fire Protection		

Is Sediment Control approval required for issuance? Yes No
 CONTINGENCY CONSTRUCTION START
 ONE STOP SHOP

DPZ SETBACK INFORMATION

Front: _____

Rear: _____

Side: _____

Side St.: _____

All minimum setbacks met? Yes No

Is Entrance Permit Required? Yes No

Historic District? Yes No

Lot Coverage for New Town Zone: _____

SDP/Red-line approval date: _____

Filing Fee	\$
Permit Fee	\$
Tech Fee	\$
Excise Tax	\$
PSFS	\$
Guaranty Fund	\$
Add'l per Fee	\$
Total Fees	\$
Sub- Total Paid	\$
Balance Due	\$

1845

N 9° 25' W 150.00'

5' Utilities RAW

LOT 17
BLOCK 25

APPROVED

WALK-THRU BUILDING PERMIT

BP# _____ A# _____
APPROVED BY D. Bernard DATE: 10-3-13

DESCRIPTION OF WORK 40 x 20 in-ground pool

Approved as
Shown

N 80° 35' E 291.00'

EXISTING FENCE
PER CODE

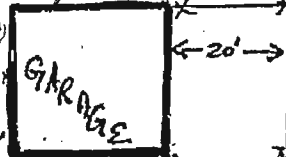
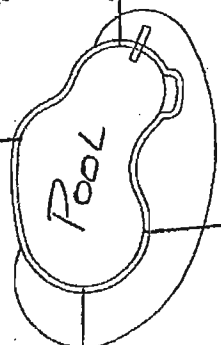

Water Supply Pipe
3' outside
24x24
concrete footing
garage
and 32" deep

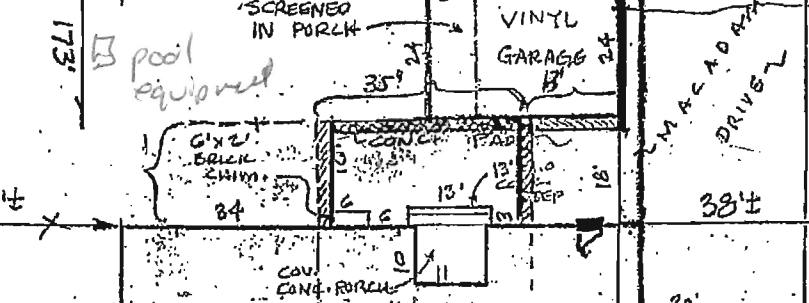

BRICK RANCHER
7430

N 80° 35' E 291.00'

80.0

60' B.R.L.

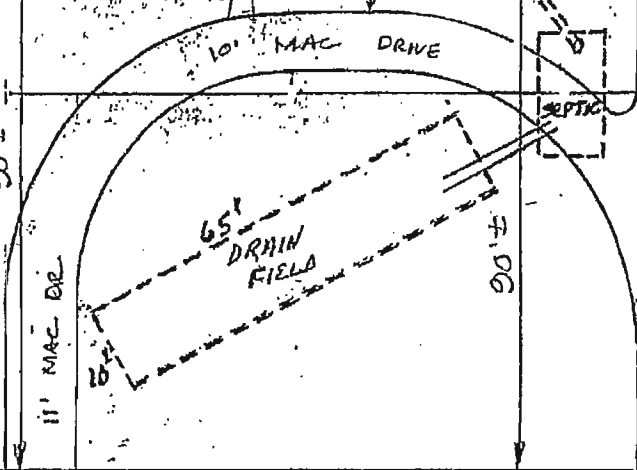

244.10' To Rt. 2
(SCAGGSVILLE)

59° 25' E 150.00'

Macadam Paving