

C1 6922

SEQUENCE NO. (MDE USE ONLY)

STATE OF MARYLAND WELL COMPLETION REPORT

THIS REPORT MUST BE SUBMITTED WITHIN 45 DAYS AFTER WELL IS COMPLETED.

1 2 3 6 (THIS NUMBER IS TO BE PUNCHED IN COLS. 3-6 ON ALL CARDS)

COUNTY NUMBER A 520414

ST/CO USE ONLY DATE Received MM DD YY

DATE WELL COMPLETED MM DD YY 7 9 2007

Depth of Well 22 260 26 (TO NEAREST FOOT)

PERMIT NO. FROM "PERMIT TO DRILL WELL" HO - 95 - 0696

OWNER Winchester Homes Inc STREET OR RFD Hunters View Rd TOWN Ellicott City SUBDIVISION Ravenwood Phase 2 SECTION LOT 51

WELL LOG Not required for driven wells

Table with columns: DESCRIPTION (Use additional sheets if needed), FEET (FROM, TO), check if water bearing. Includes entries for Sand Stone (0-90) and Gray Granite (90-260).

GROUTING RECORD

WELL HAS BEEN GROUTED (Y) (N) TYPE OF GROUTING MATERIAL (Circle one) CEMENT (CM) BENTONITE CLAY (BC) NO. OF BAGS 25 NO. OF POUNDS 2350 GALLONS OF WATER 150 DEPTH OF GROUT SEAL (to nearest foot) from 0 to 86 ft.

CASING RECORD casing types insert appropriate code below (ST) (CO) (PL) (OT) MAIN CASING TYPE (ST) Nominal diameter top (main) casing (nearest inch)! 6 Total depth of main casing (nearest foot) 94

OTHER CASING (if used) diameter inch depth (feet) from to

SCREEN RECORD screen type or open hole (insert appropriate code below) (ST) (BR) (HO) (PL) (OT)

NUMBER OF UNSUCCESSFUL WELLS: 0

WELL HYDROFRACTURED (Y) (N)

- CIRCLE APPROPRIATE LETTER A A WELL WAS ABANDONED AND SEALED WHEN THIS WELL WAS COMPLETED E ELECTRIC LOG OBTAINED P TEST WELL CONVERTED TO PRODUCTION WELL

I HEREBY CERTIFY THAT THIS WELL HAS BEEN CONSTRUCTED IN ACCORDANCE WITH COMAR 26.04.04 "WELL CONSTRUCTION" AND IN CONFORMANCE WITH ALL CONDITIONS STATED IN THE ABOVE CAPTIONED PERMIT...

DRILLERS LIC. NO. 1 M SD024 DRILLERS SIGNATURE (MUST MATCH SIGNATURE ON APPLICATION) LIC. NO. 1 D

SITE SUPERVISOR (sign. of driller or journeyman responsible for sitework if different from permittee)

C 2 DEPTH (nearest ft.)

Table with columns: 1 2 3 4 5 6 7 8 9 10 11 12 13 14 15 16 17 18 19 20 21 22 23 24 25 26 27 28 29 30 31 32 33 34 35 36 37 38 39 40 41 42 43 44 45 46 47 48 49 50 51 52 53 54 55 56 57 58 59 60 61 62 63 64 65 66 67 68 69 70 71 72 73 74 75 76 77 78 79 80 81 82 83 84 85 86 87 88 89 90 91 92 93 94 95 96 97 98 99 100. Includes depth 92 and 260.

GRAVEL PACK IF WELL DRILLED WAS FLOWING WELL INSERT F IN BOX 88

MDE USE ONLY (NOT TO BE FILLED IN BY DRILLER) T (E.R.O.S.) W Q TELESCOPE CASING LOG INDICATOR OTHER DATA

C 3 PUMPING TEST

HOURS PUMPED (nearest hour) 3 PUMPING RATE (gal. per min.) 12 METHOD USED TO MEASURE PUMPING RATE Bucket WATER LEVEL (distance from land surface) BEFORE PUMPING 24 ft. WHEN PUMPING 100 ft. TYPE OF PUMP USED (for test) (A) air (P) piston (T) turbine (C) centrifugal (R) rotary (O) other (describe below) (J) jet (S) submersible

PUMP INSTALLED DRILLER INSTALLED PUMP (CIRCLE) (YES) (NO)

IF DRILLER INSTALLS PUMP, THIS SECTION MUST BE COMPLETED FOR ALL WELLS.

TYPE OF PUMP INSTALLED PLACE (A,C,J,P,R,S,T,O) IN BOX 29 CAPACITY: GALLONS PER MINUTE (to nearest gallon) 31 35 PUMP HORSE POWER 37 41 PUMP COLUMN LENGTH (nearest ft.) 43 47

CASING HEIGHT (circle appropriate box and enter casing height) (+) above ( ) below LAND SURFACE 2 (nearest foot)

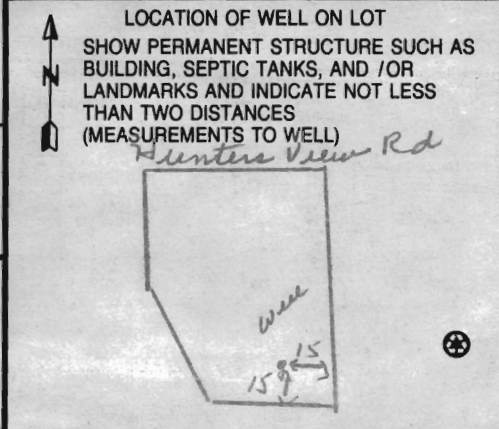

B 1 1424

SEQUENCE NO. (MDE USE ONLY)

STATE OF MARYLAND APPLICATION FOR PERMIT TO DRILL WELL 525693 please type

STATE PERMIT NUMBER

Ho-95-0696 fill in this form completely

Date Received (APA) 2/1/07

OWNER INFORMATION

Winchester Homes Inc. 6905 Rockledge Dr. Suite 800 Elliott City Md 20817

LOCATION OF WELL

Howard COUNTY Riverwood Phase 2 SECTION 44 46 LOT 51 Elliott City NEAREST TOWN 5 MI MILES FROM TOWN

DRILLER INFORMATION

Joseph & Mayne MSD024 Driller's Name License No. Joseph & Mayne Well Drilling Firm Name 5512 Ridge Rd. Mt. Airy Md 21771 Address Signature Date

DIRECTION OF WELL FROM TOWN (CIRCLE BOX)

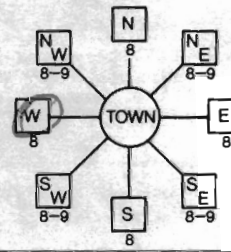

Hunters View Rd NEAR WHAT ROAD

ON WHICH SIDE OF ROAD (CIRCLE APPROPRIATE BOX) NORTH SOUTH WEST EAST DISTANCE FROM ROAD 7 250 FT ENTER FT OR MI

WELL INFORMATION APPROX. PUMPING RATE 5 (GAL. PER MIN.) AVERAGE DAILY QUANTITY NEEDED 500 (GAL. PER DAY)

USE FOR WATER (CIRCLE APPROPRIATE BOX)

- DOMESTIC POTABLE SUPPLY & RESIDENTIAL IRRIGATION FARMING (LIVESTOCK WATERING & AGRICULTURAL IRRIGATION) INDUSTRIAL, COMMERCIAL, DEWATERING PUBLIC WATER SUPPLY WELL TEST, OBSERVATION, MONITORING GEO-THERMAL

NOT TO BE FILLED IN BY DRILLER HEALTH DEPARTMENT APPROVAL

Howard COUNTY NAME 13 COUNTY NO. A520414 STATE SIGNATURE INSERT S DATE ISSUED 2/13/07 CO SIGNATURE Kim Wall EXP. DATE 2/13/08 NORTH GRID 513 000 EAST GRID 0828 000

APPROXIMATE DEPTH OF WELL 300 FEET APPROXIMATE DIAMETER OF WELL 6 INCH NEAREST TOWN

METHOD OF DRILLING (circle one)

BORED (or Augered) JETTED Jetted & DRIVEN AIR-ROTary AIR-PERCussion ROTARY (Hydraulic Rotary) CABLE REVERSE-ROTary DRIVE-POINT other

REPLACEMENT OR DEEPEMED WELLS (CIRCLE APPROPRIATE BOX)

- THIS WELL WILL NOT REPLACE AN EXISTING WELL THIS WELL WILL REPLACE A WELL THAT WILL BE ABANDONED AND SEALED THIS WELL WILL REPLACE A WELL THAT WILL BE USED AS A STANDBY-CONTACT LOCAL APPROVING AUTHORITY FOR POLICY ON STANDBY WELLS THIS WELL WILL DEEPEM AN EXISTING WELL PERMIT NUMBER OF WELL TO BE REPLACED OR DEEPEMED

SHOW MAJOR FEATURES OF BOX & LOCATE WELL WITH AN X

SOURCES OF DRILLING WATER

- will

WRITE THE BOX NUMBER FROM THE MAP HERE

E 82p8 N 51p3

DRAW A SKETCH BELOW SHOWING LOCATION OF WELL IN RELATION TO NEARBY TOWNS AND ROADS AND GIVE DISTANCE FROM WELL TO NEAREST ROAD JUNCTION

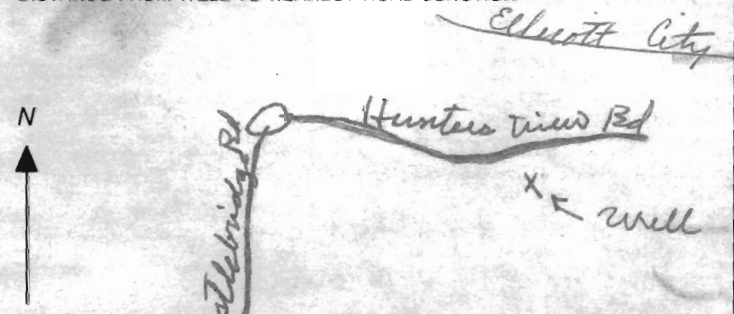

Not to be filled in by driller (MDE OR COUNTY USE ONLY)

APPROX. PERMIT NUMBER H02004G.007 PERMIT No. Ho-95-0696

SPECIAL CONDITIONS NEED RADIUM SAMPLE

**HOWARD COUNTY HEALTH DEPARTMENT  
BUREAU OF ENVIRONMENTAL HEALTH  
WATER AND SEWERAGE PROGRAM  
TEL: (410)313-2640 FAX: (410)313-2648**

**Information Form for the Installation of the Well Pump, Pitless Adapter, and Supply Piping**

**NOTE: The installer is responsible for requesting an inspection prior to 9 am on the day of the desired inspection. No work is to be covered until approved by the Health Department. All installations must comply with the National Standard Plumbing Code (NSPC, as amended locally) and COMAR 26.04.04 (MD Well Construction Regulations). Submission of a complete form is required prior to Use and Occupancy approval.**

Company Name: NATIONAL WATER SVC Telephone #: 301-854-1333  
Address: P.O. BOX 138  
ASHTON, MD 20861

(Must circle one) Licensed Plumber      Licensed Well Driller      **Licensed Well Pump Installer**  
License # and name of individual responsible for the field installation:  
Name (Print): DAVID RYCKE License# PI 0145

\*A licensed individual must perform the actual installation. Apprentices must be under the direct supervision of a licensed journeyman or master plumber, pump installer or well driller. Licenses may be subjected to field verification.

Name of Property Owner: WINCHESTER HOMES Telephone #:  
Subdivision: RIVERWOOD Lot #: 51 Well Tag #: HO-95-0626  
Site Address: 11027 HUNTERS VIEW RD  
ELLCOTT CITY, MD

<b>Submersible Pump Data</b>	<b>Pitless Adapter</b>	<b>Well Cap and Electric Conduit</b>
Make: <u>Grundfos</u>	Make: <u>Campbell</u>	Two piece watertight cap: <input checked="" type="checkbox"/>
Model #: <u>15 SQE 07450</u>	Model #: <u>PA 800</u>	Screened, vented well cap: <input checked="" type="checkbox"/>
Pump Capacity: <u>15</u> GPM	Depth: <u>48"</u> (36" min)	Cap secured to casing: <input checked="" type="checkbox"/>
Well Yield: <u>12</u> GPM	NSF approved: <u>YES</u>	Conduit min 18" B.G.: <input checked="" type="checkbox"/>
Depth of well encountered at time of pump installation: <u>260</u> (feet)		Conduit secured to well cap: <input checked="" type="checkbox"/>

If pump capacity exceeds well yield, a low water cut off switch is required by NSPC 1990 Section 17.8.4  
Torque arrestors or Cable guards are required - Must circle one N/A  
Safety rope, if used, attached to inside of well casing with eye bolt CPS

<b>Piping to house</b>	<b>House Connection</b>
Type: <u>POLY</u>	PVC sleeved to undisturbed soil at wall penetration: <u>YES</u>
PSL: <u>160</u> (160 psi min)	Approximate length of sleeve: <u>5'</u>
Depth of supply line: <u>4'</u> (36" min)	Sleeve caulked and sealed properly: <u>YES</u>

The water supply line is required to be at least ten feet from the septic tank, pump chamber, sewage piping, distribution box, drainfields, and sewage reserve area. If this cannot be accomplished, contact this office for approval prior to installation.

Signature of company representative responsible for installation

date 3/26/13

**For Health Department Use Only - Not to be completed by Installer**

Date Insp. Requested: 3/27/13 Date Insp. Approved: 3/27/13

Inspection Data: Pitless adapter and water supply line at least 36" below grade	<input checked="" type="checkbox"/>
Two piece cap installed and attached to casing securely	<input checked="" type="checkbox"/>
Elec. conduit extends at least 18" below grade/attached to cap properly	<input checked="" type="checkbox"/>
Safety rope installed inside of well casing	<input checked="" type="checkbox"/>
Correct well tag attached properly and casing 8" above finished grade	<input checked="" type="checkbox"/>
Water supply line sleeved adequately at house connection	<input checked="" type="checkbox"/>
Adequate grout observed below pitless adapter	<input checked="" type="checkbox"/>

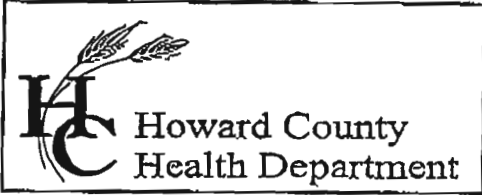

7178 Columbia Gateway Drive, Columbia, MD 21046  
 (410) 313-2640 Fax (410) 313-2648  
 TDD (410) 313-2323 Toll Free 1-866-313-6300  
 website: www.hchealth.org

Penny E. Borenstein, M.D., M.P.H., Health Officer

**TO ALL INTERESTED PARTIES**

When submitting a well permit application for a proposed well for new construction, please indicate one of the following:

Well Site Location:

Riverwood Phase II 43-77 Castlebridge Rd, Hunters View Road  
 Subdivision/Property Name Lot# Road Name s  
OPEN RUN ROAD & Whitford Way

The well site has been staked by Benchmark Eng,  
 (professional land surveyor or company employing professional land surveyors)  
 on \_\_\_\_\_ (date) and does not require a site inspection.  
*all lots will be staked by 12/29/06*

The well driller, builder or property owner will call the Health Department to schedule a time to meet in the field to verify the proposed well site location.

This sheet, along with two copies of an acceptable well site plan, must be attached to the green well permit application.

Revised 3/11/05

*Contact is:*  
*Easterday s*  
*301-829-1440*

2006 DE 18 PM 2:32

ENVIRONMENTAL HEALTH

# HUNTERS VIEW ROAD

EX. PUBLIC ACCESS STREET  
(50' R/W, 22' PAVING, F-04-82)

LOT 49  
49,925 S.F.

LOT 51  
36,421 S.F.  
COMMUNITY SEPTIC LOT

LOT 50  
42,525 S.F.  
COMMUNITY SEPTIC LOT

WELL

WELL

WELL

WELL

*staked by B.M.  
2/13/07  
015*

BENCHMARK

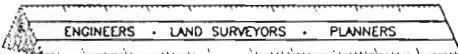

ENGINEERING, INC.

8480 BALTIMORE NATIONAL PIKE • SUITE 418 • ELLICOTT CITY, MD 21043

PHONE 410-465-6105

FAX 410-465-6644

P:\1132 Homewood\1132\1132.dwg 1/24/2007 5:33:41 PM  
tmc: Kyocera Mita KM-2530 KX.pc3

RIVERWOOD, PHASE 2

LOT 51

FORTH ELECTION DISTRICT  
HOWARD COUNTY, MARYLAND

SCALE: 1" = 50' DATE: 1/24/07

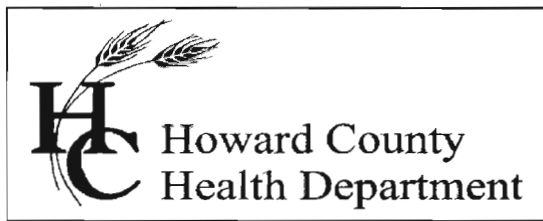

Bureau of Environmental Health  
7178 Columbia Gateway Drive, Columbia, MD 21046-2147  
Main: 410-313-6300 | Fax: 410-313-6303  
TDD 410-313-2323 | Toll Free 1-866-313-6300  
[www.hchealth.org](http://www.hchealth.org)  
Facebook: [www.facebook.com/hocohealth](http://www.facebook.com/hocohealth)  
Twitter: HowardCoHealthDep

Maura J. Rossman, M.D., Health Officer

**INTERIM CERTIFICATE OF POTABILITY**  
**PERMANENT DEVIATION FOR NITRATES**

**Expiration Date – December 14, 2013**

June 14, 2013

Homeowner  
11027 Hunters View Road  
Ellicott City, MD 21042

**RE: Riverwood II, Lot 51**  
11027 Hunters View Road  
**Building Permit: B13000404**  
**Well Permit: HO-95-0696**

Dear Homeowner:

This is to advise you that the septic system installation and water well construction for the above referenced property have been inspected and approved. Final approval of the septic system was granted on **6/3/2013**. Final approval of the well line connection to the dwelling was granted on **3/27/2013**. The well construction was completed on **7/9/2007**. Water samples were collected on **5/31/2013, 6/7/2013 & 6/13/2013**.

The water sample results indicate that the water samples submitted for testing were free of coliform and fecal coliform bacteria at the time of sampling and are bacteriologically safe for drinking.

Gross Alpha and Beta samples were also collected on **7/9/2007**. Results showed a **Gross Alpha** level of **2.0 ± 1.0 pCi/L** and **Gross Beta** level of **3.0 ± 2.0 pCi/L**. The Gross Alpha was below the maximum contaminant level (MCL) of 15 pCi/L and the Gross Beta was below the target level of 50pCi/L (roughly equivalent to the annual dose rate of 4 millirems per year). At the time of testing and with respect to these parameters, the well water is safe for all uses.

The untreated water sample collected on **5/31/2013** indicated a nitrate level of **11.0 mg/L**. **This exceeds the maximum contaminant limit of 10 mg/L set forth in COMAR 26.04.04.09**. After installation of a nitrate removal device (water softener), a post-treatment water sample was collected on **6/7/2013** and indicated a nitrate level of **<1.0 mg/L**.

This Department will grant a **permanent deviation** to the Interim Certificate of Potability on condition that the nitrate removal system effectively maintains a nitrate-nitrogen contaminant level of **10 mg/L or less**.

**Furthermore, it will be necessary for you to comply with the following conditions:**

1. The system must be properly operated and maintained continuously in accordance with the service contract for the life of the residence.
2. It is recommended that a Maryland certified water laboratory certified for nitrates analysis perform a yearly nitrate analysis.
3. If you decide to sell or rent your home in the future, you must make any potential buyer/tenant aware of this permanent deviation. **A person who fails to make this disclosure is subject to the penalties set out in COMAR 26.04.04.12F Enforcement and Environment Article 9-1311, Annotated Code of Maryland.**

This certifies that the initial sampling requirements of COMAR 26.04.04 "Well Regulations" have been met for the water supply system installed under well permit HO-95-0696. Although the submitted sample results are in compliance with COMAR standards, the Health Department does not guarantee water supplies.

This Interim Certificate of Potability will expire **six months** from the date of issuance. Submission of a second bacteriological test indicating the water is free of coliform and fecal coliform bacteria is required prior to the expiration date, after which time a Final Certificate of Potability will be issued. **Failure to submit an additional sample and obtain a Final Certificate of Potability will result in a Notice of Violation and is punishable as a misdemeanor under the *Annotated Code of Maryland, Environment Article, 9-1311*, subject to a fine of up to \$500 or imprisonment not to exceed three months.**

Please contact (410) 313-1773 to schedule a final water sample appointment or contact a Maryland certified water quality laboratory to schedule a water sample. A list of laboratories certified by the state of Maryland may be found at the following website:  
<http://www.mde.state.md.us/assets/document/WSP-Labs-2010apr16.pdf>

Approving Authority,



Heidi Scott, R.S.  
Environmental Sanitarian  
Well & Septic Program

cc: Howard County Dept. of Inspections, Licenses, and Permits  
Community Hygiene Program  
File

# FOUNTAIN VALLEY ANALYTICAL LABORATORY, INC.

1415 Old Laneytown Rd. - Westminster, MD (410) 846-1014 (410) 876-4559 FAX (410) 848-0298

## REPORT OF ANALYSIS

Laboratory ID #:	89420	Account #:	3123
Reference:	Riverwood Lot 51	Company:	National Water Servicing
Location:	11027 Hunters View Road Ellicott City, MD 21042	Requested By:	Dave Rycke
Date/ Time Collected:	5/31/2013 0914	Source:	Well Water
Date/Time Rec'd:	5/31/2013 1019	Site:	Pressure Tank
Chlorine ppm:	Free: ND Total: ND	Treatment:	None
Collected By:	J. Yeager 6176JY	pH:	5.9
		Well #:	HO-95-0696

PARAMETERS	RESULTS	UNITS	REFERENCE	METHOD	DATE/TIME/ANALYST
Bacteria, Coliform, Total, MPN	✓ 1.0	MPN/ 100 ml	<1.0	SM18 9223	6/1/2013 / 0930 / CCH
Bacteria, E. coli, MPN	✓ <1.0	MPN/ 100 ml	<1.0	SM18 9223	6/1/2013 / 0930 / CCH
Nitrate	11.0	mg/L	10	601	5/31/2013 / 1500 / CCH
Turbidity	✓ 2.66	NTU	<10	SM18 2130B	5/31/2013 / 1200 / JKW
Sand	✓ NS	mg/L	5	Visual/Gravimetric	5/31/2013 / 1215 / JKW

Nitrate -  
need retest +  
Rest OK  
6/14/13  
HS

### NOTES

- 1 mg/L = milligrams per liter (also, parts per million)
- 2 MPN/ 100 ml = Most Probable Number [of viable bacteria] per 100 ml of sample.
- 3 NS = None Seen (NS indicates less than 5 mg/L)
- 4 NTU = Nephelometric Turbidity Units
- 5 Results less than or within the reference range are considered satisfactory and within potable water limits at the time of sampling.
- 6 ND:None Detected
- 7 Visual well check: Sealed, vented cap
- 8 pH & Chlorine level tested on site

Reason for Test : Use & Occupancy  
 Building Permit # : 13000404

Date Reported: 6/10/2013

# FOUNTAIN VALLEY ANALYTICAL LABORATORY, INC.

1413 Old Taneytown Rd. Westminster, MD (410) 848-1014 (410) 876-4554 FAX (410) 848-0298

## REPORT OF ANALYSIS

Laboratory ID #: 89620 Account #: 3123  
Reference: Riverwood Lot 51 Company: National Water Servicing  
Location: 11027 Hunters View Road Requested By: Dave Rycke  
Ellicott City, MD 21042 Source: Well Water  
Date/ Time Collected: 6/13/2013 1121 Site: Pressure Tank  
Date/Time Rec'd: 6/13/2013 1228 Treatment: \*\*  
Chlorine ppm: Free: ND Total: ND pH: 6.3  
Collected By: J. Yeager 6176JY Well #: HO-95-0696

PARAMETERS	RESULTS	UNITS	REFERENCE	METHOD	DATE/TIME/ANALYST
Bacteria, Coliform, Total, MPN	<1.0	MPN/ 100 ml	<1.0	SM18 9223	6/14/2013 / 1000 / LLO
Bacteria, E. coli, MPN	<1.0	MPN/ 100 ml	<1.0	SM18 9223	6/14/2013 / 1000 / LLO

### NOTES

- 1 MPN/ 100 ml = Most Probable Number [of viable bacteria] per 100 ml of sample.
- 2 pH & chlorine tested on site
- 3 Results less than or within the reference range are considered satisfactory and within potable water limits at the time of sampling.
- 4 ND:None Detected
- 5 Visual well check: Sealed, vented cap
- 6 \*\*Sample collected prior to Softener/ Neutralizer/ Sediment Filter

Reason for Test : Use & Occupancy

Building Permit # : 13000404

Date Reported: 6/14/2013

# FOUNTAIN VALLEY ANALYTICAL LABORATORY, INC.

113 Old Piney Point Rd., Westminster, MD (410) 848-0113 FAX (410) 848-0298

## REPORT OF ANALYSIS

Laboratory ID #: 89527 Reference: Riverwood Lot 51 Location: 11027 Hunters View Road Ellicott City, MD 21042 Date/ Time Collected: 6/7/2013 1120 Date/Time Rec'd: 6/7/2013 1232 Chlorine ppm: Free: ND Total: ND Collected By: J. Yeager 6176JY	Account #: 3123 Company: National Water Servicing Requested By: Dave Rycke Source: Well Water Site: <u>Sample Port</u> Treatment: <u>Softener/ Neutralizer/ Sediment Filter</u> pH: 5.9 Well #: HO-95-0696
--	---

PARAMETERS	RESULTS	UNITS	REFERENCE	METHOD	DATE/TIME/ANALYST
Nitrate	✓ <1.0	mg/L	10	601	6/7/2013 / 1315 / CCH

Nitrate OK  
6/14/13 HS

**NOTES**

- 1 mg/L = milligrams per liter (also, parts per million)
- 2 Results less than or within the reference range are considered satisfactory and within potable water limits at the time of sampling.
- 3 ND:None Detected
- 4 Visual well check: Sealed, vented cap
- 5 pH & Chlorine level tested on site

Reason for Test : Use & Occupancy  
 Building Permit # : 13000404

Date Reported: 6/10/2013



Bureau of Environmental Health  
7178 Columbia Gateway Drive, Columbia, MD 21046-2147  
Main: 410-313-2640 | Fax: 410-313-2648  
TDD 410-313-2323 | Toll Free 1-866-313-6300  
www.hchealth.org  
Facebook: www.facebook.com/hocohealth  
Twitter: HowardCoHealthDep

Maura J. Rossman, M.D., Health Officer

**REQUEST FOR PERMANENT DEVIATION TO  
NITRATE STANDARDS FOR CERTIFICATE OF POTABILITY**

DATE: 6-7-2013 WELL PERMIT #: HO-95-0696

PROPERTY OWNER: JAMES CHEN & CHRISTINE ZHANG

SUBDIVISION & LOT #: RIVERWOOD - LOT #51

PROPERTY ADDRESS: 11027 HUNTERSVIEW RD  
ELLCOTT CITY, MD 21042

**CONDITIONS:**

- 1) The well installed under permit # HO-95-0696 has been documented to have a nitrate level of 11.0 ppm, which exceeds the MCL of 10 ppm.
- 2) After installation and operation of a nitrate filtration system, water samples collected on 6-7-13 indicated that the nitrate contamination has been reduced to 0 ppm at the primary drinking tap.

I hereby request that a Permanent Deviation to COMAR 26.04.04.09 be granted for the well installed under permit HO-95-0696. I am fully aware of the conditions under which this deviation will be granted, and of my responsibilities as the well owner, which include advising any future buyer/tenant of the installation, condition and maintenance responsibilities of the nitrate removal device.

Prospective Owner's Original Signature(s) [Person(s) that intend to live in the dwelling]

James Chen Christine Zhang

Prospective Owner's Day Time Phone Number(s)

410-562-2432 410-440-6161

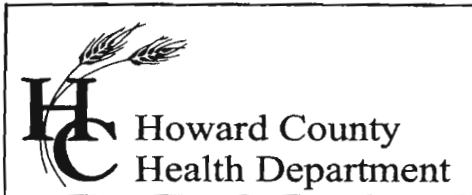

Bureau of Environmental Health  
7178 Columbia Gateway Drive, Columbia, MD 21046  
(410) 313-2640 Fax (410) 313-2648  
TDD (410) 313-2323 Toll Free 1-866-313-6300  
website: www.hchealth.org

Peter L. Beilenson, M.D., M.P.H., Health Officer

August 24, 2007

Winchester of Howard County  
6905 Rockledge Dr.  
Suite 800  
Bethesda, MD 20817

RE: Riverwood II Subdivison, Lot# 51  
Well Tag: HO-95-0696

To Whom It May Concern:

A sample was collected from a yield test July 9, 2007 and submitted to Department of Health and Mental Hygiene Laboratories to assess the possible presence of **Gross Alpha** and **Gross Beta** in the future well water supply. **Gross Alpha** and **Gross Beta** measure the total alpha and beta particle activity in a water supply. In turn, this can provide information regarding naturally occurring radiation (i.e., Radionuclides) that may exist in your area of development within the County.

Results from this screening revealed a **Gross Alpha** of  $2.0 \pm 1.0$  picocuries/liter (pCi/L); while the **Gross Beta** level was  $3.0 \pm 2.0$  pCi/L. The **Gross Alpha** result was below its **maximum contaminant level (MCL)** of 15 pCi/L, while the **Gross Beta** level was below its target value of 50 pCi/L (roughly equivalent to the **annual dose rate** of 4 millirems/year).

At the time of testing and with respect to these parameters, the future well water supply appears safe for all uses. No additional testing **for these parameters** will be required to secure the future Use & Occupancy. However, other standard (potability) testing will still be necessary.

A copy of the test results is enclosed for your information. Please call this office at 410-313-1773 if you have any further questions.

Sincerely,

Bert Nixon, Deputy Director  
Bureau of Environmental Health

cc/ Eric Dougherty, MDE Water Mgmt., Groundwater  
Well & Septic File

Send Report To:

State of Maryland

DHMH - Laboratories Administration

Division of Environmental Chemistry

**RADIATION LABORATORY**

201 W. Preston Street, Baltimore, Maryland 21201

John M. DeBoy, Dr. P.H., Director

**LABORATORY ANALYSIS REQUEST**

Sample Bottle No. A: H0-95-0696 No. B: \_\_\_\_\_ Field Blank Bottle No. A: \_\_\_\_\_ No. B: \_\_\_\_\_

Plant/Site Name: Riverwood 2 lot 51 County: Howard

Sample Source: Hunters View Rd. Location: H0-95-0696  
(well no., lab sink, sample tap, etc.)

County:   Plant No.

CHECK (one per box)

Drinking Water   
Landfill   
Stream   
Other

Community   
Non-community   
Private   
Other

Source (raw water)   
Distribution (treated)   
MCL

Emergency   
Routine   
Recheck   
Special

Collector: K. Wolf

Telephone No: 410-313-2645

Date Collected: 7/9/07

Time Collected: 10:30 a.m. \_\_\_\_\_ p.m.

Nitric Acid Preserved: Yes  No

Iced: Yes  No

Submitters Code:   Federal Project:  Field Data: \_\_\_\_\_

Remarks: sample collected @ end of yield test pH \_\_\_\_\_ Chlorine \_\_\_\_\_

✓	Test	EPA Code	Laboratory No.	Results (pCi/L)	Date Reported
✓	Gross Alpha	4000			
✓	Gross Beta	4100			
	Radon-222 Bottle A	4004			
	Radon-222 Bottle B	4004			
	Field Blank A	4004			
	Field Blank B	4004			
	Tritium				
	Ra - 226	4020			
	Ra - 228	4030			
	Total Uranium	4006			

Date Received: \_\_\_\_\_/\_\_\_\_\_/\_\_\_\_\_

Supervisor: \_\_\_\_\_

## **Baker, Brian**

---

**From:** Pickett, Tom  
**Sent:** Monday, June 03, 2013 12:51 PM  
**To:** Day, Lori; Martin, Sharhonda; Wolf, Kevin; Baker, Brian; Hart, Amy; Tuder, Matt  
**Cc:** Pickett, Tom  
**Subject:** U & O Release 11027 Hunters View Rd

Shaun observed the start-up of a Sewage Grinder Pump at the Riverwood Shared Septic System:

Riverwood, Contract 50-4287  
Whiting & Turner  
11027 Hunters View Rd, Lot #51  
Ellicott City, MD 21042

The Sewage Grinder Pump test was successful ; the Bureau of Utilities releases its hold on this property for U & O.

This is the 13th lot on the shared septic system at this location.

Matt  
410-313-4934 office  
410-978-1320 mobile