

7/24/97
11:00
7-25-97
11 or 12

PERMIT

SEWAGE DISPOSAL SYSTEM

DEPARTMENT OF HEALTH AND MENTAL HYGIENE

P 58584B

A REPAIR

DISTRICT _____

DATE 7-24-97

#0358078

HOWARD COUNTY HEALTH DEPARTMENT

BUREAU OF ENVIRONMENTAL HEALTH

~~461-9933~~ 313-2640

DATE SYSTEM APPROVED 7-25-97

INSPECTOR JA

INDEXED

Jack Fyock Septic Service

IS PERMITTED TO INSTALL _____ ALTER

ADDRESS 4105 Ten Oaks Road Glenelg, MD 21737 PHONE (410) 988-9270

SUBDIVISION _____ LOT _____ ROAD 7266 Guilford Road

PROPERTY OWNER Mr. Lorditch

7266 Guilford Road

ADDRESS _____

SEPTIC TANK CAPACITY NA GALLONS

NUMBER OF BEDROOMS 3

125 SQUARE FEET PER BEDROOM

LINEAR FEET OF TRENCH REQUIRED 154

**BUILDING PERMIT SIGNED
AND RETURNED**

Stalos 800 155 599 - ROL House

REPAIR - PURPOSE - EXISTING SEPTIC SYSTEM HAS FAILED.

Call for inspection when ground is opened so sanitarian can recommend repair. 07/23/97

PLANS APPROVED BY _____ DATE _____

COVER NO WORK UNTIL INSPECTED AND APPROVED

NEITHER THE HOWARD COUNTY COUNCIL NOR THE HEALTH DEPARTMENT IS RESPONSIBLE FOR THE SUCCESSFUL OPERATION OF ANY SYSTEM

NOTE: CLEANOUT REQUIRED EVERY 70 FEET OF SEWER LINE AND/OR AT 90° SWEEPS IN LINES FROM HOUSE TO DRAIN FIELDS, 90° ELBOWS NOT ACCEPTABLE.

NOTE: ALL PARTS OF SEPTIC SYSTEMS (I.E. TANK, DISTRIBUTION BOX TRENCHES) TO BE 100 FEET FROM WELL (UNLESS OTHERWISE SPECIFICALLY AUTHORIZED)

NOTE: IF DEEP TRENCH(ES) ARE USED CALL FOR INSPECTION BEFORE AND AFTER PLACING GRAVEL IN TRENCH(ES)

NOTE: NO DRY WELL SHALL EXCEED 15 FOOT IN DIAMETER NO ABSORPTION TRENCH TO EXCEED 100 FEET IN LENGTH

NOTE: ALL PIPE FROM HOUSE TO SEPTIC TANK MUST BE CAST IRON OR SCHEDULE 35/40 PVC OR ABS

PERMIT VOID AFTER TWO YEARS

NOTE: INSTALL STAND PIPE ON SEPTIC TANK AND DRY WELL STAND PIPES MUST BE 6 INCHES IN DIAMETER CAST IRON. CONCRETE OR TERRA COTTA OR PVA OR ABS ACCEPTED. IF TOP OF SEPTIC TANK IS DEEPER THAN 3 FEET. MANHOLE TO GRADE REQUIRED.

NOTE: DISTRIBUTION BOXES MUST HAVE BAFFLES

***INSTALLER IS RESPONSIBLE FOR OBTAINING FINAL APPROVAL ON THIS PERMIT**

P 58584B

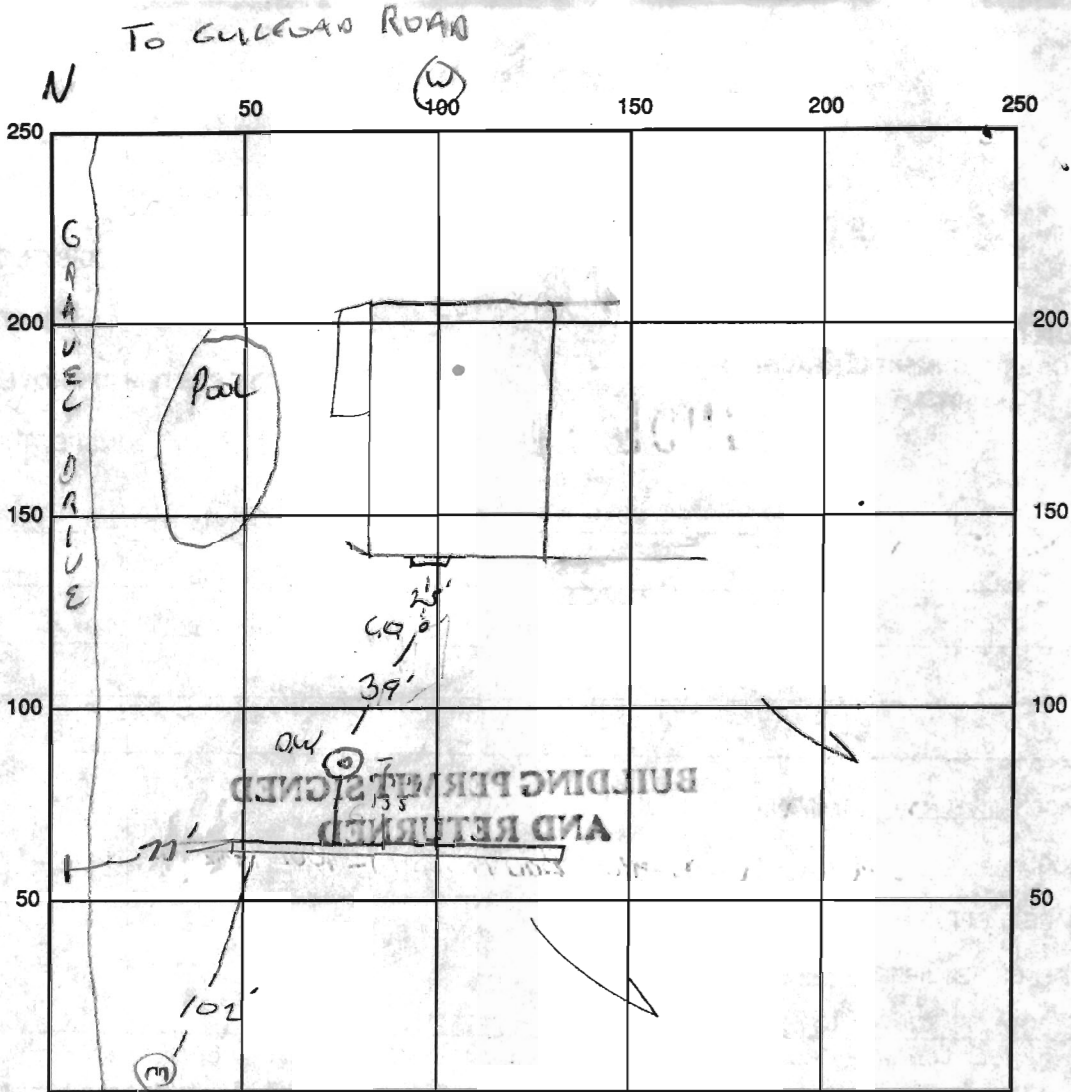

INDICATE NORTH - NAME ADJOINING ROADWAY AS BASE LINE

SEPTIC TANK LEVEL N/A CLEANOUTS NA 2 EXISTING

DISTRIBUTION BOX LEVEL _____

DRAIN FIELD/TITLE DEPTH 9.5-10 FT. TRENCH WIDTH 2 FT. INLET DEPTH 3 FT.

EFFECTIVE GRAVEL DEPTH 6.5 FT. TOTAL LENGTH 65 FT.

NUMBER OF TRENCHES 1 ONE SIDEWALL/BOTTOM AREA +422 SQ. FT.

DRYWALL INSIDE DIAMETER — FT. EFFECTIVE DEPTH BELOW INLET — FT.

ABSORBENT AREA — SQ. FT.

REMARKS: 7/25/97 OK TO COVER ALL WORK

DATE SYSTEM APPROVED 7-25-97 INSPECTOR [Signature]

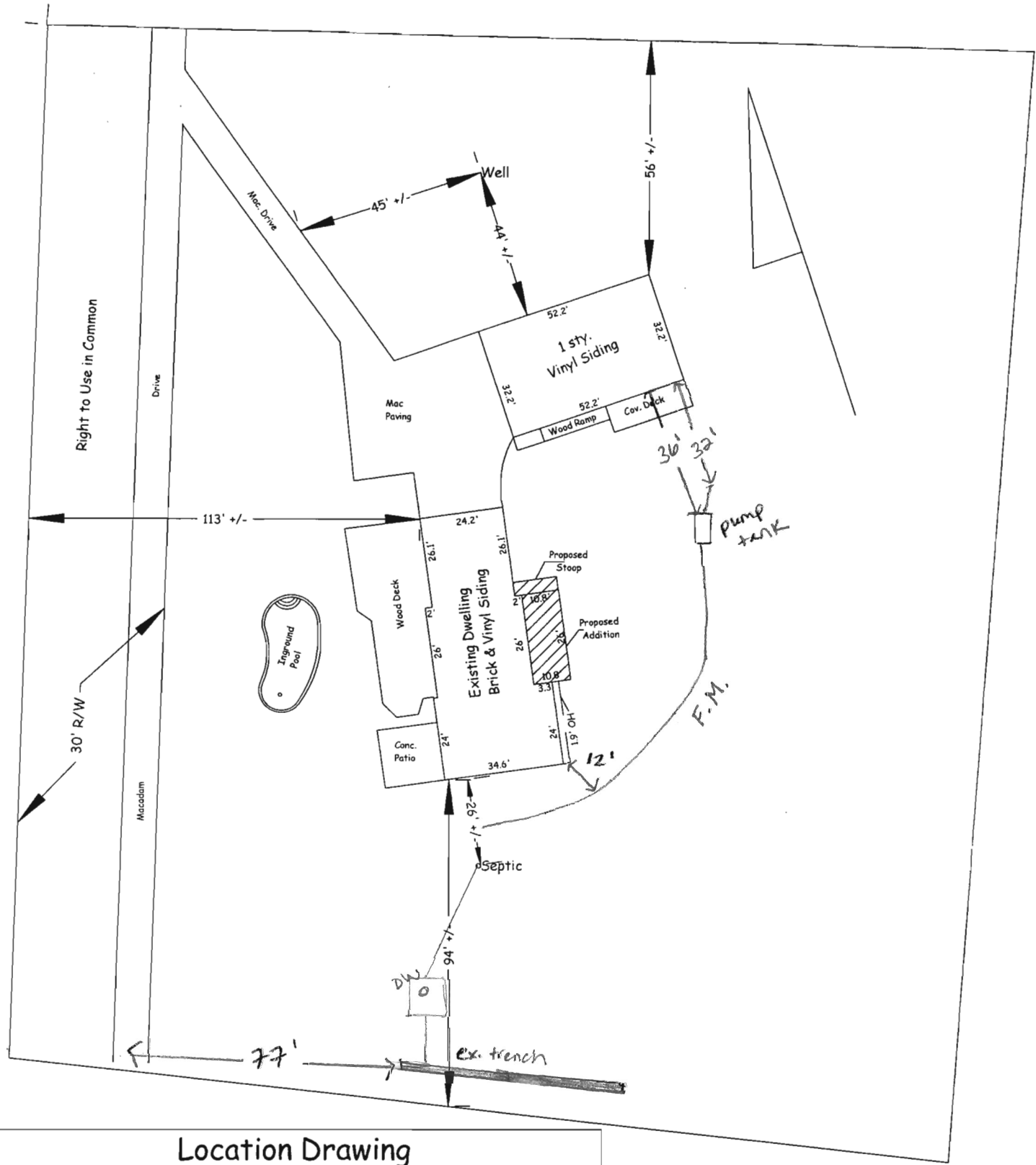

Location Drawing
7266 Guilford Road
Liber 9188, Folio 519
Howard County, MD

Date: 2/10/13	Scale: 1" = 40'
---------------	-----------------