

Bureau of Environmental Health  
 7178 Gateway Drive Columbia, MD 21046  
 (410) 313-2640 Fax (410) 313-2648  
 TDD (410) 313-2323 Toll Free 1-866-313-6300  
 website: www.hchealth.org

Maura J. Rossman, M.D., Health Officer

RECEIPT DATE: 12/17/12 **ONSITE SEWAGE DISPOSAL SYSTEM** P 544409-C

INSTALLATION APPROVAL DATE: 6/19/2013 **PERMIT** A \_\_\_\_\_

**CONSTRUCTION**

PROPERTY ADDRESS: 4015 Candle Light Drive

SUBDIVISION: Castleberry at Ten Oaks LOT: 42 TAX ID: 05-447437

CONTRACTOR: Trinity Quality Homes EMAIL: \_\_\_\_\_

CONTRACTOR ADDRESS: 3675 Park Avenue Ste 301, Ellicott City, MD 21043 PHONE: 410-480-0023

PROPERTY OWNER: Trinity Quality Homes EMAIL: \_\_\_\_\_

OWNER ADDRESS: 3675 Park Avenue Ste 301, Ellicott City, MD 21043 PHONE: 443-324-9806

SEPTIC TANK SIZE (GALLONS): 2000

PUMP CHAMBER CAPACITY (GALLONS): \_\_\_\_\_ PUMP SIZE: \_\_\_\_\_

NUMBER OF BEDROOMS: 4 HOUSE SQ. FT. 4,980 APPLICATION RATE: 0.8

DISTRIBUTION SYSTEM: GRAVITY FED  LOW PRESSURE DOSED

TRENCHES:	LINEAR FEET REQUIRED: <u>103 150'</u>	INLET DEPTH: <u>4 5.0'</u>
	TRENCH WIDTH: <u>2'</u>	MAXIMUM BOTTOM DEPTH: <u>8.5'</u>
	MINIMUM SPACE BETWEEN TRENCHES: <u>9</u>	EFFECTIVE AREA BEGINNING DEPTH: <u>5±'</u>
LOCATION:	PER APPROVED SITE PLAN. SEWAGE DISPOSAL AREA AND BAT UNIT LOCATION MUST BE STAKED BY LICENSED SURVEYOR PRIOR TO PRE-CONSTRUCTION INSPECTION.	
NOTES:	Set septic tank per plan. Set distribution box at top center of SDA. Install 2 X 52' trenches on contour split at top of SDA. Basement will not sewer by gravity. <u>64'+86'</u>	

ISSUED BY: Heidi Scott ISSUE DATE: 1/23/13 EXPIRATION DATE: 12/17/13

- NOTE: CONTRACTOR MUST SCHEDULE A PRE-CONSTRUCTION INSPECTION PRIOR TO BEGINNING ANY INSTALLATION
- NOTE: CONTRACTOR MUST SCHEDULE AN INSPECTION AND GAIN APPROVAL OF ALL COMPONENTS PRIOR TO COVERING
- NOTE: STONE MUST BE APPROVED BY HEALTH DEPARTMENT AND GRAVEL TICKET MUST BE AVAILABLE FOR REVIEW.
- NOTE: WATERTIGHT SEPTIC TANKS REQUIRED
- NOTE: ALL PARTS OF SEPTIC SYSTEM SHALL BE AT LEAST 100 FEET DOWNGRADIENT FROM ANY WATER WELL
- NOTE: MANHOLE RISERS REQUIRED ON ALL SEPTIC TANKS AND PUMP CHAMBERS
- NOTE: AN ELECTRICAL PERMIT IS REQUIRED FOR INSTALLATION OF ANY ELECTRICAL COMPONENTS OF THE SYSTEM

**NEITHER THE HOWARD COUNTY COUNCIL NOR THE HEALTH DEPARTMENT IS RESPONSIBLE FOR THE SUCCESSFUL OPERATION OF ANY SYSTEM.**

**PERMITTEE RESPONSIBLE FOR OBTAINING FINAL APPROVAL ON THIS PERMIT.  
 CALL 410-313-1771 TO SCHEDULE INSPECTIONS.**

NOT TO SCALE

See As-Built Drawing  
On Separate Sheet

ROAD NAME

**TRENCH/DRAINFIELD DATA**

WIDTH	INLET	BOTTOM
<u>2'</u>	<u>5'</u>	<u>8.5'</u>
NUMBER OF TRENCHES <u>2</u>		
TOTAL LENGTH <u>152'</u>		
ABSORPTION AREA <u>532</u>		
DISTRIBUTION BOX LEVEL <u>Levelers</u>		
DISTRIBUTION BOX BAFFLE <u>Yes</u>		
DISTRIBUTION BOX PORT <u>Yes</u>		

**SEPTIC TANK DATA**

SEPTIC TANK 1 LEVEL	<u>Yes</u>
MANUFACTURER	<u>Babylon</u>
CAPACITY	<u>2000</u> GAL
SEAM LOC	<u>Top</u>
TANK LID DEPTH	<u>1.5'-2'</u>
BAFFLES	<u>Yes</u>
BAFFLE FILTER	<u>No</u>
MANHOLE LOC	<u>Front</u>
6" PORT LOC	<u>Rear</u>
WATERTIGHT TEST	<u>No</u>
SLOTTED	<u>Yes</u>
DATE ON LID	<u>4/23/2013</u>

~~RUMP/SEPTIC TANK LEVEL N/A~~

<del>MANUFACTURER</del>	<del>_____</del>
<del>CAPACITY</del>	<del>_____</del> GAL
<del>SEAM LOC</del>	<del>_____</del>
<del>TANK LID DEPTH</del>	<del>_____</del>
<del>BAFFLES</del>	<del>_____</del>
<del>BAFFLE FILTER</del>	<del>_____</del>
<del>MANHOLE LOC</del>	<del>_____</del>
<del>6" PORT LOC</del>	<del>_____</del>
<del>WATERTIGHT TEST</del>	<del>_____</del>
<del>SLOTTED</del>	<del>_____</del>
<del>DATE ON LID</del>	<del>_____</del>

PRE-CONSTRUCTION:

6/17/2013 Layout done. Install an upper 64' and lower 86' trench on contour across the top of the septic easement. Set the tank near where shown on the B.P. plan. (BB)

INSTALLATION:

6/18/2013 Tank set. (BB)  
6/19/2013 System finished. O.K. to backfill. (BB)

FINAL INSPECTOR

B. Baker

DATE OF APPROVAL

6/19/2013

HO-95-0470

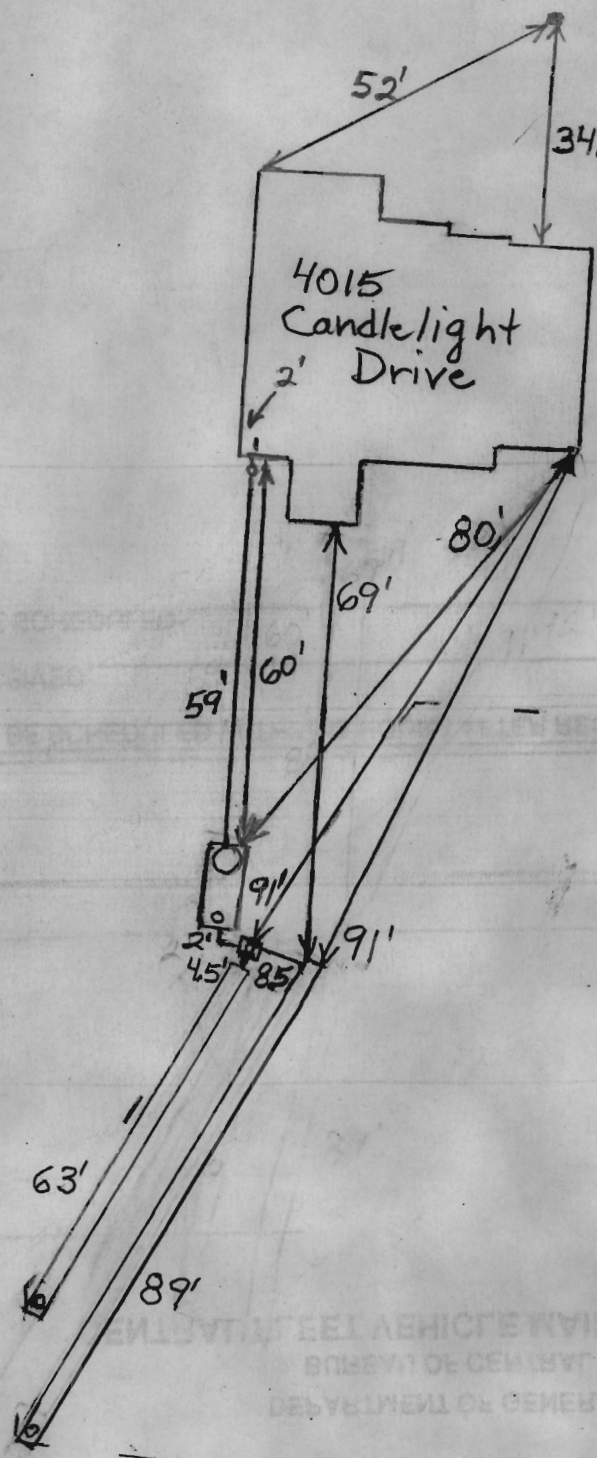

THIS WALL CHECK DRAWING CONTAINS A HORIZONTAL TOLERANCE IN ACCURACY OF 0.1' AND A VERTICAL TOLERANCE IN ACCURACY OF 0.2'

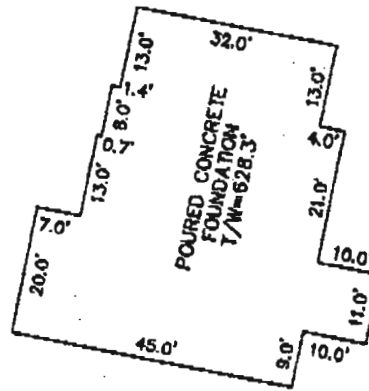

DETAIL SCALE: 1"=30'

MARYLAND STATE GRID MERIDIAN (NAD83/91)

CANDLE LIGHT DRIVE  
50' RIGHT-OF-WAY  
N15°04'01"E 147.23'

EX. WELL  
HO-950470



SEE DETAIL

S79°22'59"E 269.46'  
10' BRL

PRIVATE SEWAGE EASEMENT

LOT 42  
40,130 SQ. FT.

N14°55'23"E 151.30'

LOT 44

N78°30'49"W 269.55'  
10' BRL

LOT 40

10' PUBLIC TREE MAINTENANCE EASEMENT

LOT 39

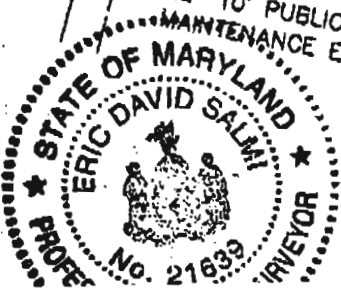

I HEREBY CERTIFY TO THE BEST OF MY KNOWLEDGE, INFORMATION AND BELIEF THAT THE IMPROVEMENTS ARE LOCATED AS SHOWN AND THERE ARE NO ENCROACHMENTS EXCEPT AS SHOWN.

PROFESSIONAL CERTIFICATION; I HEREBY CERTIFY THAT THESE DOCUMENTS WERE PREPARED BY ME OR UNDER MY RESPONSIBLE CHARGE, AND THAT I AM A DULY LICENSED PROFESSIONAL LAND SURVEYOR UNDER THE LAWS OF THE STATE OF MARYLAND, LICENSE NO. 21639, EXPIRATION DATE JANUARY 3, 2014.

3/1/2013

ERIC D. SALMI, PROFESSIONAL LAND SURVEYOR, NO. 21639 DATE

BUILDING PERMIT # B12002313

SCALE 1" = 50'	DATE 02/26/13	<b>ROBERT H. VOGEL ENGINEERING, INC.</b> ENGINEERS - SURVEYORS - PLANNERS 8407 MAIN STREET ELLICOTT CITY, MARYLAND 21043 TEL: 410-461-7666 FAX: 410-461-8961	<b>WALL CHECK DRAWING</b> 4015 CANDLE LIGHT DRIVE LOT 42 <b>CASTLEBERRY AT TEN OAKS</b> PLAT No. 19099 5th ELECTION DISTRICT HOWARD COUNTY, MARYLAND
DRAWN BY B.D.A.	CHECKED BY E.D.S.		
PLAT NUMBER 19096-19109	JOB NUMBER 00-85.00		

OK TO SCAN  
 Permit/Lic # B12002313  
 Title APPROV'D WALL ✓  
 By T. [Signature]  
 Date 3-4-13  
 Scanned by \_\_\_\_\_