

LAYOUT 5/2, 6/6 + 6/10 INSP 4 _____
 INSP 2 5/14/2013 INSP 5 _____
 INSP 3 5/17/2013 AM+PM INSP 6 _____

ISSUE DATE: 12-11-12
 APPROVAL DATE: 5/18/2013

PERMIT

P 544426
 A _____

**ON-SITE SEWAGE DISPOSAL SYSTEM
 HOWARD COUNTY HEALTH DEPARTMENT
 BUREAU OF ENVIRONMENTAL HEALTH**

Brandon Smith IS PERMITTED TO INSTALL ALTER

ADDRESS: _____ PHONE NUMBER: (410) 984-8512

SUBDIVISION: Shipley's Choice LOT NUMBER: 4

ADDRESS: 12121 Old Frederick Rd. PROPERTY OWNER: _____

SEPTIC TANK CAPACITY (GALLONS): _____ OUTLET BAFFLE FILTER REQUIRED

PUMP CHAMBER CAPACITY (GALLONS): _____ COMPARTMENTED TANK REQUIRED

NUMBER OF BEDROOMS: 4 Trenches 3' Wide

SQUARE FEET PER BEDROOM: _____ Inlet 4.5'
 Bottom 7'

LINEAR FEET OF TRENCH REQUIRED: 165' Upper 70' and Lower 95' Trench

TRENCHES:	Trench to be _____ feet wide. Inlet _____ feet below original grade. Bottom maximum depth _____ feet below original grade. Effective area begins at _____ feet below original grade. _____ feet of stone below distribution pipe.
LOCATION:	_____
NOTES:	_____

PLANS APPROVED: B. Baker DATE: 5/2/2013

- NOTE: PERMIT VOID AFTER 2 YEARS
- NOTE: CONTRACTOR RESPONSIBLE FOR SCHEDULING A PRE-CONSTRUCTION INSPECTION FOR ALL INSTALLATIONS
- NOTE: WATERTIGHT SEPTIC TANKS REQUIRED
- NOTE: ALL PARTS OF SEPTIC SYSTEM SHALL BE 100 FEET FROM ANY WATER WELL
- NOTE: MANHOLE RISERS REQUIRED ON ALL SEPTIC TANKS AND PUMP CHAMBERS UNLESS SPECIFICALLY AUTHORIZED

NEITHER THE HOWARD COUNTY COUNCIL NOR THE HEALTH DEPARTMENT IS RESPONSIBLE FOR THE SUCCESSFUL OPERATION OF ANY SYSTEM PERMITTEE RESPONSIBLE FOR OBTAINING FINAL APPROVAL ON THIS PERMIT CALL 410-313-2640 FOR INSPECTION OF SEPTIC SYSTEM

NOT TO SCALE

(30)

Public Water

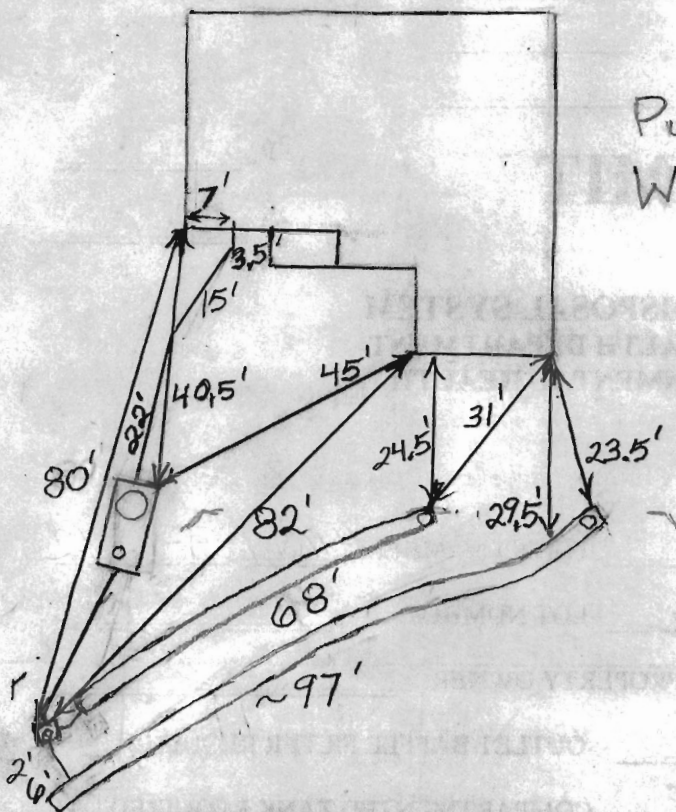

ROAD

TRENCH/DRAINFIELD DATA

WIDTH	INLET	BOTTOM
3'	4.5'	7'
NUMBER OF TRENCHES		2
TOTAL LENGTH		165'
ABSORPTION AREA		495 + Sidewall
DISTRIBUTION BOX LEVEL		Levelers
DISTRIBUTION BOX BAFFLE		Yes
DISTRIBUTION BOX PORT		Yes

SEPTIC TANK DATA

SEPTIC TANK 1 LEVEL	Yes
CAPACITY	2000 GAL
SEAM LOC	Top
TANK LID DEPTH	1.5'-2'
BAFFLES	Yes
BAFFLE FILTER	No
MANHOLE LOC	Front
6" PORT LOC	Rear
WATERTIGHT TEST	No
SEPTIC TANK 2 LEVEL	N/A
CAPACITY	_____ GAL
SEAM LOC	_____
TANK LID DEPTH	_____
BAFFLES	_____
BAFFLE FILTER	_____
MANHOLE LOC	_____
6" PORT LOC	_____
WATERTIGHT TEST	_____

PRE-CONSTRUCTION 5/2/2013 I install an upper 70' and lower 95' trench on contour across the highest part of the easement.

INSTALLATION Set the tank near where shown on the B.P. plan (BB)

6/6/2013 No one on site. Called contractor but got no response (BB)

6/10/2013 Did layout for 2nd time. (BB)

6/14/2013 Tank set. House connection made Top trench finished (BB)

6/17/2013 I installed levelers. Most of bottom trench done (AM). (BB)

6/17/2013 Gravel still hasn't arrived. (BB)

6/18/2013 Bottom trench finally done. O.K. to backfill (BB)

FINAL INSPECTOR B. Baker

DATE OF APPROVAL 6/18/2013

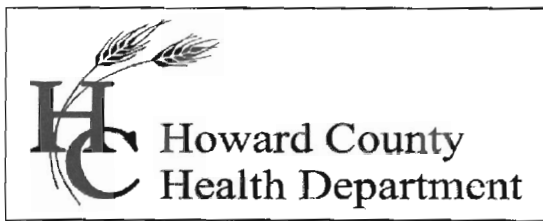

Bureau of Environmental Health
7178 Columbia Gateway Drive, Columbia, MD 21046-2147
Main: 410-313-6300 | Fax: 410-313-6303
TDD 410-313-2323 | Toll Free 1-866-313-6300
www.hchealth.org
Facebook: www.facebook.com/hocohealth
Twitter: HowardCoHealthDep

Maura J. Rossman, M.D., Health Officer

August 6, 2013

Sayed and Amina Bokhari
12121 Old Frederick Road
Marriottsville, MD 21104

RE: Shipley's Choice, Lot 4
12121 Old Frederick Road
Marriottsville, MD 21104
Building Permit #: B12003816
PUBLIC WATER

Dear Sir/Madam:

This is to advise you that the septic system for the above referenced property has been installed and inspected. **Final approval of the septic system was granted on 6/18/2013.**

The property is served by public water and is therefore exempt from the Health Department water sampling requirements.

By issuance of this letter, this office recommends release of the Use and Occupancy permit for the referenced property.

Approving Authority,

Robert Bricker, REHS/R.S.
Environmental Health Specialist
Well & Septic Program

RB
cc: Building Inspector's Office
File

We are an Equal Opportunity Employer

SAVAGE STONE, LLC

SAVAGE, MARYLAND

Mailing Address: P.O. Box 850, Laurel, Maryland 20725

DISPATCH / SALES

301-953-8973

410-792-3753

TRUCKER'S COPY

BILLING INQUIRIES

301-953-7650

410-792-7234

TICKET #00689948

STATION SS

DATE 06/10/13 TIME 08:32:01

CUSTOMER SMIBRA
BRANDON SMITH CONTRACTORS INC
6604 CARLETON COURT
LAUREL, MD 20707

JOB PICKUP : PICKUP

P.O. # PROJECT #:

TRUCK BS1379 LICENSE @ AXLES
DRIVER: BRANDON SMITH

GROSS	SCALE B	67620 lb
TARE IN	(STORED)	28540 lb
NET		39080 lb
NET		19.54 t

	Loads	Tons
DAILY	1	19.54
TOTAL	45	877.74
TIME IN 08:32:01		TIME OUT 08:32:01

MAT'L 0029 : WASHED #2 STONE
HAUL ZONE 0000

WEIGHMASTER _____

Gail Harrison

RECEIVED BY _____

SAFETY FIRST! HAVE A GREAT DAY! PLEASE CHECK YOUR TICKET!

We are an Equal Opportunity Employer

SAVAGE STONE, LLC

SAVAGE, MARYLAND

Mailing Address: P.O. Box 850, Laurel, Maryland 20725

DISPATCH / SALES
301-953-8973
410-792-3753

TRUCKER'S COPY

BILLING INQUIRIES
301-953-7650
410-792-7234

TICKET #00689984

STATION 55

DATE 06/10/13 TIME 09:51:55

CUSTOMER SMIBRA

BRANDON SMITH CONTRACTORS INC
6604 CARLETON COURT
LAUREL, MD 20707

JOB PICKUP : PICKUP

P.O. # PROJECT #:

TRUCK BS1379 LICENSE
DRIVER: BRANDON SMITH

0 AXLES

GROSS		SCALE B	68740 lb
TARE	IN	(STORED)	28540 lb
NET			40200 lb
NET			20.10 t

	Loads	Tons
DAILY	2	39.64
TOTAL	46	897.84
TIME IN 09:51:55		TIME OUT 09:51:55

MAT'L 0029 : WASHED #2 STONE
HAUL ZONE 0000

WEIGHMASTER _____

Gail Harrison

RECEIVED BY _____

SAFETY FIRST! HAVE A GREAT DAY! PLEASE CHECK YOUR TICKET!

We are an Equal Opportunity Employer

SAVAGE STONE, LLC

SAVAGE, MARYLAND

Mailing Address: P.O. Box 850, Laurel, Maryland 20725

TRUCKER'S COPY

BILLING INQUIRIES

301-953-7650

410-792-7234

TICKET #00690028

STATION SS

DATE 06/10/13 TIME 11:21:36

DISPATCH / SALES

301-953-8973

410-792-3753

CUSTOMER SMIBRA

BRANDON SMITH CONTRACTORS INC
6604 CARLETON COURT
LAUREL, MD 20707

JOB PICKUP : PICKUP

P.O. # PROJECT #:

TRUCK BS1379 LICENSE
DRIVER: BRANDON SMITH

0 AXLES

GROSS	SCALE A	68300 lb
TARE	IN (STORED)	28540 lb
NET		39760 lb
NET		19.88 t

	Loads	Tons
DAILY	3	59.52
TOTAL	47	917.72
TIME IN 11:21:36		TIME OUT 11:21:36

MAT'L 0029 : WASHED #2 STONE.
HAUL ZONE 0000

WEIGHMASTER _____

Stacey Hawke

RECEIVED BY _____



SAFETY FIRST! HAVE A GREAT DAY! PLEASE CHECK YOUR TICKET!

We are an Equal Opportunity Employer

SAVAGE STONE, LLC

SAVAGE, MARYLAND

Mailing Address: P.O. Box 850, Laurel, Maryland 20725

DISPATCH / SALES
301-953-8973
410-792-3753

TRUCKER'S COPY

BILLING INQUIRIES
301-953-7650
410-792-7234

TICKET #00690082

STATION SS

DATE 06/10/13 TIME 13:22:36

CUSTOMER SMIBRA
BRANDON SMITH CONTRACTORS INC
6604 CARLETON COURT
LAUREL, MD 20707

JOB PICKUP : PICKUP
P.O. # PROJECT #:

2E

TRUCK BS1379 LICENSE 0 AXLES
DRIVER: BRANDON SMITH

GROSS	SCALE A	67400 lb
TARE IN	(STORED)	28540 lb
NET		38860 lb
NET		19.43 t

	Loads	Tons
DAILY	4	78.95
TOTAL	48	937.15
TIME IN 13:22:36		TIME OUT 13:22:36

MAT'L 0029 : WASHED #2 STONE
HAUL ZONE 0000

WEIGHMASTER _____
Gail Harrison

RECEIVED BY _____

SAFETY FIRST! HAVE A GREAT DAY! PLEASE CHECK YOUR TICKET!