

LAYOUT 8/21/13 INSP 4 \_\_\_\_\_  
INSP 2 \_\_\_\_\_ INSP 5 \_\_\_\_\_  
INSP 3 \_\_\_\_\_ INSP 6 \_\_\_\_\_

ISSUE DATE:

12/20/12

# PERMIT

P 544484

APPROVAL DATE:

9/5/13

A 524028

Tax ID # 05-452651

**ON-SITE SEWAGE DISPOSAL SYSTEM  
HOWARD COUNTY HEALTH DEPARTMENT  
BUREAU OF ENVIRONMENTAL HEALTH**

T & R Plumbing & Heating

IS PERMITTED TO INSTALL  ALTER

ADDRESS: \_\_\_\_\_ PHONE NUMBER: 443-277-4188

SUBDIVISION: Holly House Meadows LOT NUMBER: 8

ADDRESS: 8108 Holly Manor Way PROPERTY OWNER: Cornerstone Homes Inc.

SEPTIC TANK CAPACITY (GALLONS): 2000 OUTLET BAFFLE FILTER REQUIRED

PUMP CHAMBER CAPACITY (GALLONS): \_\_\_\_\_ COMPARTMENTED TANK REQUIRED

NUMBER OF BEDROOMS: 4 APPLICATION RATE: 0.8

SQUARE FOOTAGE OF HOUSE: 4,809

LINEAR FEET OF TRENCH REQUIRED: 155'

3x52

TRENCHES:	Trenches to be 3.0 feet wide. Inlet is at 3.0 feet below original grade with 2.0 feet of stone below the distribution pipe. Bottom maximum depth is 5.0 feet below original grade. Effective sidewall begins at 4.0 feet below original grade. Maintain at least 9.0 feet of spacing between trenches.
LOCATION:	Set septic tank per layout inspection. Set distribution box at the highest point of the easement per layout inspection. Install 155 feet of trench on contour per layout inspection.
NOTES:	<b>Do not</b> order the septic tank until after layout inspection and Sanitarian approval. Stake easement corners. Call for layout inspection. Mark utilities. Gravel tickets must be available for Environmental Sanitarians. Stone must be approved by the Howard County Health Department. A written variance request is required for tanks deeper than 3 feet. A traffic bearing lid is required for tanks deeper than 4 feet.

PLANS APPROVED: Dana Bernard DATE: 8/23/12

- NOTE: PERMIT VOID AFTER 2 YEARS
- NOTE: CONTRACTOR RESPONSIBLE FOR SCHEDULING A PRE-CONSTRUCTION INSPECTION FOR ALL INSTALLATIONS
- NOTE: WATERTIGHT SEPTIC TANKS REQUIRED
- NOTE: ALL PARTS OF SEPTIC SYSTEM SHALL BE 100 FEET FROM ANY WATER WELL
- NOTE: MANHOLE RISERS REQUIRED ON ALL SEPTIC TANKS AND PUMP CHAMBERS

**NEITHER THE HOWARD COUNTY COUNCIL OR THE HEALTH DEPARTMENT IS RESPONSIBLE FOR  
THE SUCCESSFUL OPERATION OF ANY SYSTEM  
PERMITTEE RESPONSIBLE FOR OBTAINING FINAL APPROVAL ON THIS PERMIT  
CALL 410-313-1771 FOR INSPECTION OF SEPTIC SYSTEM**

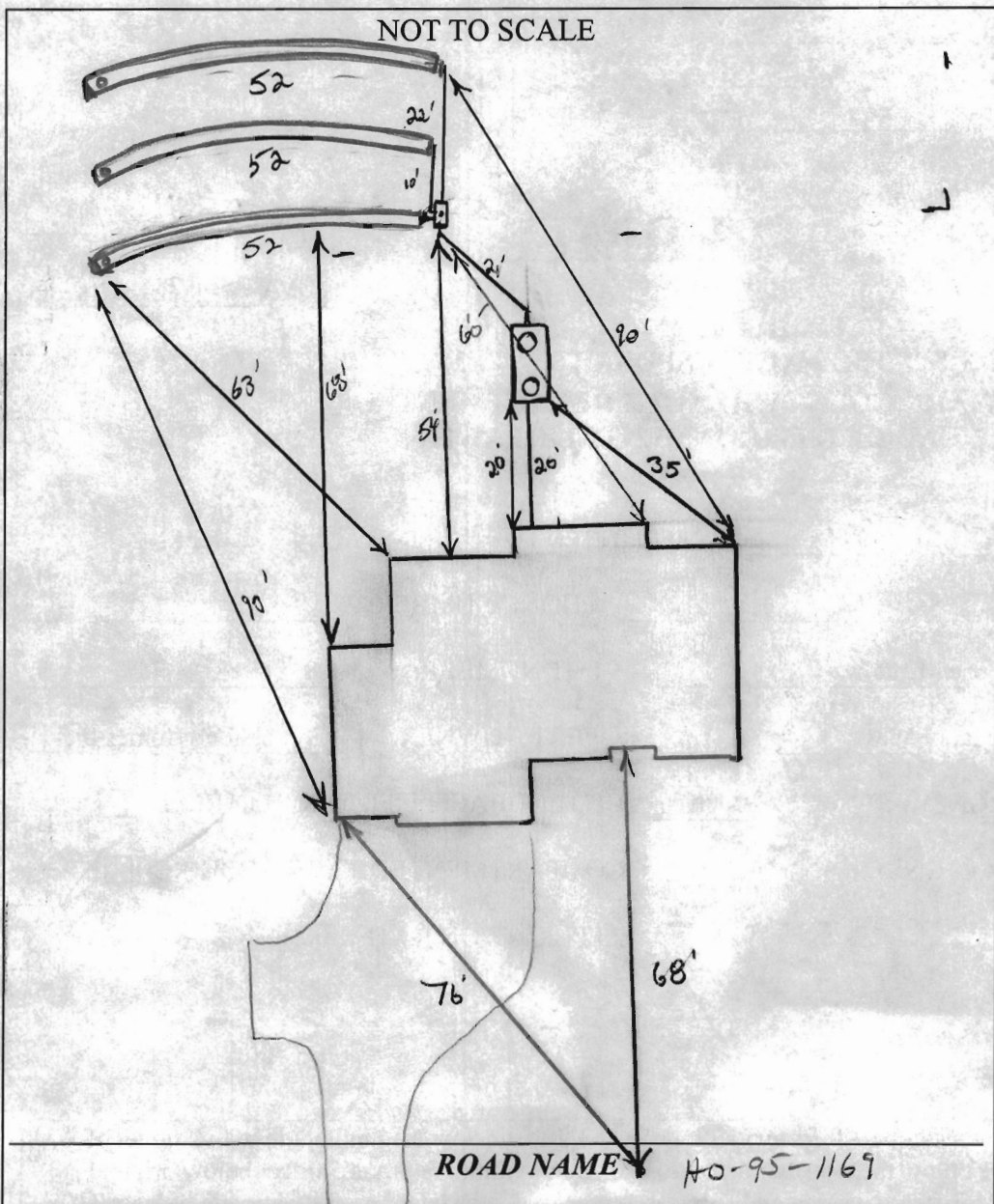

TRENCH/DRAINFIELD DATA		
WIDTH	INLET	BOTTOM
<u>3</u>	<u>3</u>	<u>5</u>
NUMBER OF TRENCHES		<u>3</u>
TOTAL LENGTH		<u>156</u>
ABSORPTION AREA		<u>468'±sw</u>
DISTRIBUTION BOX LEVEL		<u>levelers</u>
DISTRIBUTION BOX BAFFLE		<u>Yes</u>
DISTRIBUTION BOX PORT		<u>Yes</u>

SEPTIC TANK DATA	
SEPTIC TANK I LEVEL	<u>Yes</u>
MANUFACTURER	<u>Babylon</u>
CAPACITY	<u>2000</u> GAL
SEAM LOC	<u>Top</u>
TANK LID DEPTH	<u>3'-4'</u>
BAFFLES	<u>Yes</u>
BAFFLE FILTER	<u>—</u>
MANHOLE LOC	<u>Front/Rear</u>
6" PORT LOC	<u>none</u>
WATERTIGHT TEST	<u>—</u>
SLOTTED	<u>Yes</u>
DATE ON LID	<u>7-15-13</u>
PUMP/SEPTIC TANK LEVEL	<u>N/A</u>
MANUFACTURER	_____
CAPACITY	_____ GAL
SEAM LOC	_____
TANK LID DEPTH	_____
BAFFLES	_____
BAFFLE FILTER	_____
MANHOLE LOC	_____
6" PORT LOC	_____
WATERTIGHT TEST	_____
SLOTTED	_____
DATE ON LID	_____

**PRE-CONSTRUCTION:**

8/21/13 stakes missing to SRA. Trees/shrubs/bamboo needs to be cut down w/in septic reserve area prior to any layout. OK to set tank 20' from house. sewer under footer! shot elev. @ sewer in/out of house, grade @ tank. should be OK. 2.5' cover, w/ 1% fall. Call when SRA is staked and area cleared. (PW)

**INSTALLATION:**

8/29/13 Septic area cleared, SRA re-staked, confirmed corners w/ house. S.T. set per layout. Had to cut outlet pipe to 3' max. SHC plumbing ran. 9/3/13 Dbox set. Nesting done completely. 9/5/13 septic complete. D box installed. OK to cover all work. (PW)

FINAL INSPECTOR [Signature] DATE OF APPROVAL 9/5/13