

**HOWARD COUNTY
PERMIT APPLICATION**

PERMIT NUMBER
800159779

Building Address 479 E Gaithers Road
Sykesville MD 21784
Suite/Apt. #: _____ SDP/WP/Petition #: _____
Census Tract _____ Subdivision Gaithers
Section _____ Area _____ Lot _____
Tax Map H Parcel 03 Grid 13
Zoning _____ Map Coordinates _____ Lot size \$1,130 sq ft

Property Owner's Name Wm + Anna Long
Address 479 E Gaithers Rd
City Sykesville State MD Zip Code 21784
Home Phone _____ Work Phone _____
Applicant's Name & Mailing Address, (if other than stated hereon): _____
Phone _____ Fax _____

Existing Use Residential
Proposed Use Residential
Estimated Construction Cost \$ 30,000
Description of Work Adding 3 DOORMS +
Front Porch.

Contractor Company Lehmeyer Contracting
Contact Person Andy Lehmeyer
Address 124 Pleasant Hill Road
City Owings Mills State MD Zip Code 21117
License No. MHC# 45819
Phone 410-351-7300 Fax 410-343-0917

Occupant or Tenant _____
Contact Name _____
Address _____
City _____ State _____ Zip Code _____
Phone _____ Fax _____

Engineer or Architect Company YBL Custom Home
Contact Person Greg Little Designer Inc
Address PO Box 337
City Finisburg State MD Zip Code 21048
Phone 410-633-8720 Fax _____

BUILDING DESCRIPTION - COMMERCIAL

BUILDING DESCRIPTION - RESIDENTIAL

Building Characteristics	Utilities
Height: _____	Water Supply: <input type="checkbox"/> Public <input type="checkbox"/> Private
No. of stories: _____	Sewage Disposal: <input type="checkbox"/> Public <input type="checkbox"/> Private
Gross area, sq. ft. per floor: _____	Electric Yes <input type="checkbox"/> No <input type="checkbox"/> Gas Yes <input type="checkbox"/> No <input type="checkbox"/>
Use group: _____	Heating System: Electric <input type="checkbox"/> Oil <input type="checkbox"/> Natural Gas <input type="checkbox"/> Propane Gas <input type="checkbox"/>
Construction type: <input type="checkbox"/> Reinforced Concrete <input type="checkbox"/> Structural Steel <input type="checkbox"/> Masonry <input type="checkbox"/> Wood Frame	Sprinkler system: N/A <input type="checkbox"/> <input type="checkbox"/> Full <input type="checkbox"/> Partial <input type="checkbox"/> Other Suppression # of Heads _____
<input type="checkbox"/> State Certified Modular	

Building Characteristics	Utilities
SF Dwelling <input type="checkbox"/> SF Townhouse <input type="checkbox"/> <u>Depth</u> _____ <u>Width</u> _____	Water Supply: <input type="checkbox"/> Public <input type="checkbox"/> Private
1st floor: _____	Sewage Disposal: <input type="checkbox"/> Public <input type="checkbox"/> Private
2nd floor: _____	Electric Yes <input type="checkbox"/> No <input type="checkbox"/> Gas Yes <input type="checkbox"/> No <input type="checkbox"/>
Basement: _____	Heating System: Electric <input type="checkbox"/> Oil <input type="checkbox"/> Natural Gas <input type="checkbox"/> Propane Gas <input type="checkbox"/>
Finished Basement <input type="checkbox"/> Unfinished Basement <input type="checkbox"/> Crawl space <input type="checkbox"/> Slab on Grade <input type="checkbox"/> No. of Bedrooms _____	Sprinkler system: N/A <input type="checkbox"/> <input type="checkbox"/> NFPA #13D <input type="checkbox"/> NFPA #13R <input type="checkbox"/> Other: _____
Multi-family dwellings: No. of efficiency units: _____ No. of 1 BR units: _____ No. of 2 BR units: _____ No. of 3 BR units: _____	
Other Structure: _____ Dimensions: _____ Footings: _____ Roof: _____	
<input type="checkbox"/> State Certified Modular <input type="checkbox"/> Manufactured Home	

THE UNDERSIGNED HEREBY CERTIFIES AND AGREES AS FOLLOWS: (1) THAT HE/SHE IS AUTHORIZED TO MAKE THIS APPLICATION; (2) THAT THE INFORMATION IS CORRECT; (3) THAT HE/SHE WILL COMPLY WITH ALL REGULATIONS OF HOWARD COUNTY WHICH ARE APPLICABLE THERETO; (4) THAT HE/SHE WILL PERFORM NO WORK ON THE ABOVE REFERENCED PROPERTY NOT SPECIFICALLY DESCRIBED IN THIS APPLICATION; (5) THAT HE/SHE GRANTS COUNTY OFFICIALS THE RIGHT TO ENTER ONTO THIS PROPERTY FOR THE PURPOSE OF INSPECTING THE WORK PERMITTED AND POSTING NOTICES

Applicant's Signature _____

Print Name _____

Title/Company _____

Date _____

Checks payable to: **DIRECTOR OF FINANCE OF HOWARD COUNTY**

** PLEASE WRITE NEATLY AND LEGIBLY. **

- FOR OFFICE USE ONLY -

AGENCY	DATE	SIGNATURE APPROVAL	DPZ SETBACK INFORMATION	PROPERTY ID#:
Land Development, DPZ			Front: _____	Filing fee \$ _____
State Highways			Rear: _____	Permit fee \$ _____
Building Official			Side: _____	Excise tax \$ _____
Dev. Engineering, DPZ			Side St.: _____	Add'l per. fee \$ _____
Health		<u>Gabriel A. Giff</u> <u>5/24/06</u>	All minimum setbacks met?	TOTAL FEES \$ _____
Fire Protection			YES <input type="checkbox"/> NO <input type="checkbox"/>	Sub-total paid \$ _____
Is Sediment Control approval required prior to issuance?			Is Entrance Permit required?	Balance due \$ _____
YES <input type="checkbox"/> NO <input type="checkbox"/>			YES <input type="checkbox"/> NO <input type="checkbox"/>	Check # _____
CONTINGENCY CONSTRUCTION START: <input type="checkbox"/>			Historic District?	Validation # _____
ONE STOP SHOP: <input type="checkbox"/>			YES <input type="checkbox"/> NO <input type="checkbox"/>	
			Lot Coverage for NewTown Zone _____	
			SDP/Red-line approval date _____	Accepted by _____

Distribution of Copies- White: Building Official Green: LDD, DPZ Yellow: DED, DPZ Pink: Health Gold: SHA

S 18-01-00 E 150.00 S 04-00-00 W 125.00

WALKTHRU BUILDING PERMIT
BP# WALKTHRU A# 28107
APP. SAN GAC DATE: _____
DESC. OF WORK: Deck over Front Porch

APPROVED

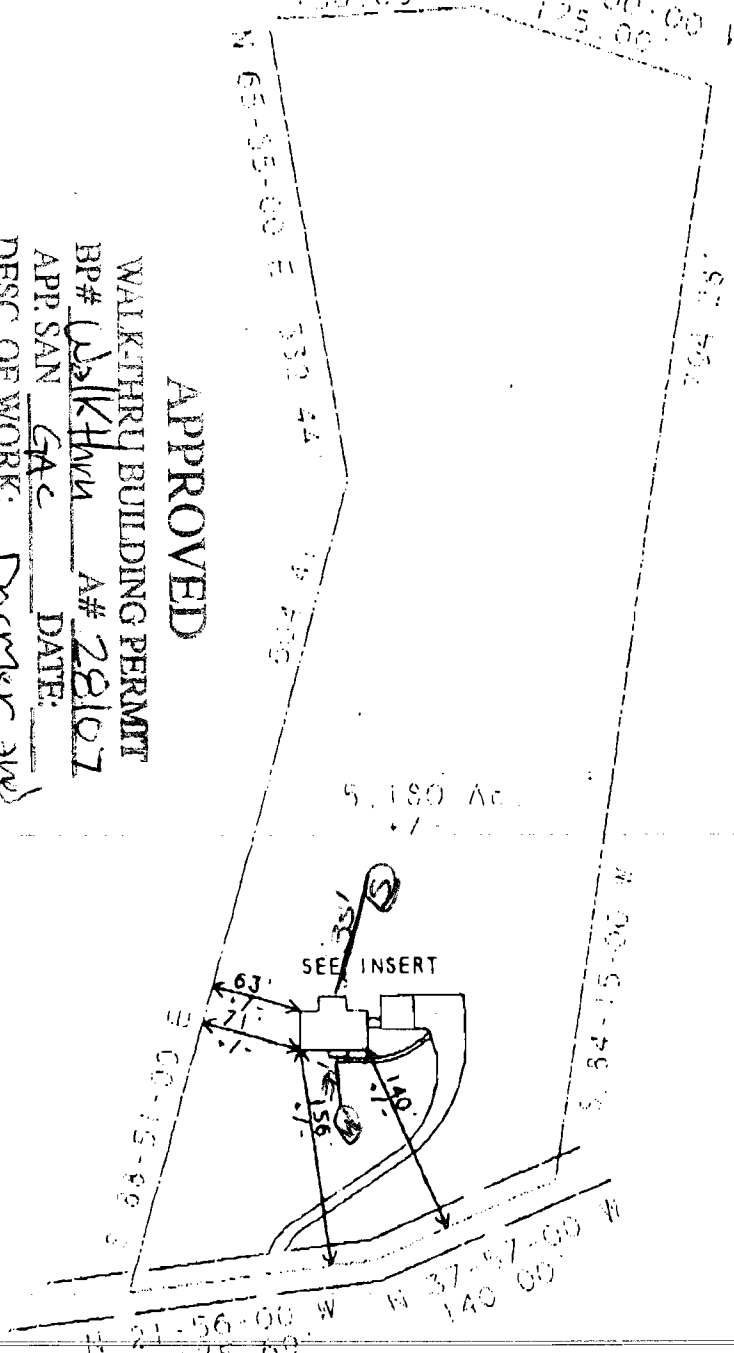

5.180 Ac.

GAITHER ROAD
(30' R/W)

THIS PLAT IS NOT INTENDED TO BE
USED FOR THE PURPOSE OF

AFFORDABLE
Site Data