

3/31/78

Approved 3/31/78 *gullie*
P 27310

PERMIT

SEWAGE DISPOSAL SYSTEM

A 20609

MARYLAND STATE DEPARTMENT OF HEALTH

HOWARD COUNTY

ELLICOTT CITY

DISTRICT 2nd

DATE 11/18/77

INDEXED

Emerson Feaga IS PERMITTED TO INSTALL ALTER

ADDRESS Old Frederick Rd. Woodstock, Md. 21163 PHONE 328-2481

A SEWAGE DISPOSAL SYSTEM LOCATED AT _____

SUBDIVISION Mt. Hebron ROAD 9406 Furrow Ave Unnamed road LOT 23, Sec. 15

PROPERTY OWNER Mt. Hebron, Inc

ADDRESS 2417 Mt. Hebron Drive Ellicott City, Md.

SPECIFICATIONS 3 bedrooms

DRAIN FIELD _____ DEPTH _____ FEET, BOTTOM AREA _____ SQ. FT.

SEEPAGE PITS _____ ABSORBENT SIDE-WALL AREA _____ SQ. FT.

SEPTIC TANK CAPACITY 1000 GALLONS

FOR GARBAGE GRINDER, INCREASE DISPOSAL AREA 22% & TANK CAPACITY 50%.

OTHER DRY WELL to have 125 sq. ft. effective sidewall absorption area per bedroom to begin below the first 3 1/2 ft. of non-porous soil. Maximum depth permitted for drywell is 11 1/2 ft. below original grade. Place the drywell 100 ft. from the rear lot line and 10 ft. from the right side line, as seen when facing the property from Furrow Court.

NOTE: ALL PIPE FROM HOUSE TO DISPOSAL AREA MUST BE CAST IRON. PERMIT VOID AFTER 3 YEARS.

NOTE: INSTALL STAND PIPES ON SEPTIC TANK AND DRY WELL. STAND PIPES MUST BE 6 INCHES IN DIAMETER. CAST IRON, CONCRETE OR TERRA COTTA ACCEPTED.

PLANS APPROVED BY Frank Skinner DATE 9/8/76

FILL SEPTIC TANK AND DISTRIBUTION BOX WITH WATER BEFORE CALLING FOR AN INSPECTION. COVER NO WORK UNTIL INSPECTED AND APPROVED.

NEITHER THE HOWARD COUNTY COMMISSIONERS NOR THE HEALTH DEPARTMENT IS RESPONSIBLE FOR THE SUCCESSFUL OPERATION OF ANY SYSTEM.

A 20609

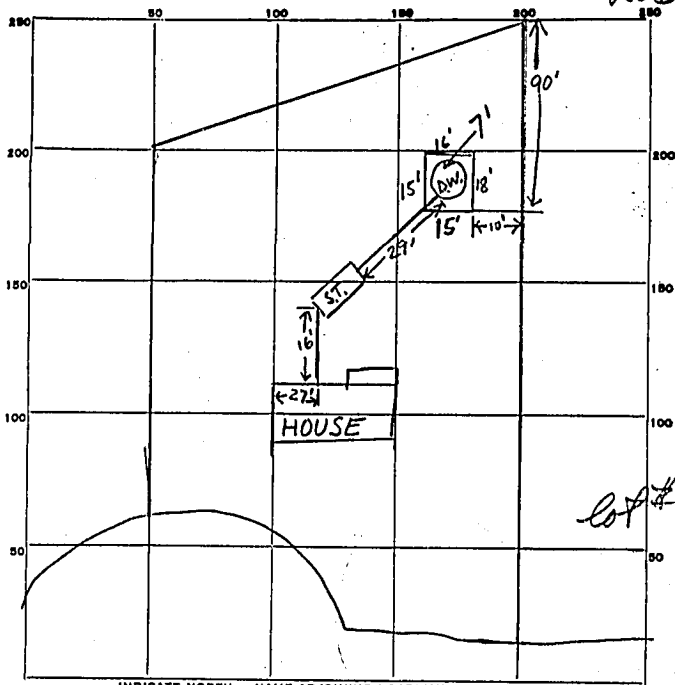

PERMIT CARD OK posted Furrow

SEPTIC TANK, LEVEL OK CLEANOUTS OK

DISTRIBUTION BOX, LEVEL —

TILE FIELD, DEPTH — FT. TRENCH WIDTH — FT.

GRAVEL DEPTH — IN. TOTAL LENGTH — FT.

NUMBER OF TRENCHES — TOTAL BOTTOM AREA —

SEEPAGE PITS, INSIDE DIAMETER Perimeter 64 FT. DEPTH BELOW INLET 7 FT.

ABSORBENT AREA 448 SQ. FT.

REMARKS _____

DATE SYSTEM APPROVED 3/31/78 INSPECTOR Frank Sella