

C1 8612

SEQUENCE NO. (MDE USE ONLY)

STATE OF MARYLAND WELL COMPLETION REPORT

THIS REPORT MUST BE SUBMITTED WITHIN 45 DAYS AFTER WELL IS COMPLETED.

1 2 3 6 (THIS NUMBER IS TO BE PUNCHED IN COLS. 3-6 ON ALL CARDS)

COUNTY NUMBER 1516 057

ST/CO USE ONLY

DATE WELL COMPLETED

Depth of Well

PERMIT NO.

DATE Received MM DD YY

04 08 2007

22 300 26 (TO NEAREST FOOT)

FROM "PERMIT TO DRILL WELL" HO-95-0666

OWNER

STREET OR RFD BELLE HEAVEN FSB. TOWN Woodbine

WELL LOG

Not required for driven wells

STATE THE KIND OF FORMATIONS PENETRATED, THEIR COLOR, DEPTH, THICKNESS AND IF WATER BEARING

Table with columns: DESCRIPTION, FEET (FROM, TO), check if water bearing. Rows: Soil (0-8), Soft Shale (8-21), Gray Rock (21-300). Includes handwritten note 'water at 248'' and calculation '7 ÷ 26 = 2.7'.

GROUTING RECORD

WELL HAS BEEN GROUTED (Y/N). TYPE OF GROUTING MATERIAL (CM, BC). NO. OF BAGS, NO. OF POUNDS, GALLONS OF WATER, DEPTH OF GROUT SEAL.

CASING RECORD

Diagram showing casing types (ST, CO, PL, OT) and MAIN CASING TYPE (PL) with dimensions (Nominal diameter, Total depth).

OTHER CASING (if used)

Table for OTHER CASING with columns: diameter, depth (feet).

SCREEN RECORD

Diagram showing screen types (ST, BR, HO, PL, OT) and screen dimensions (SLOT SIZE, DIAMETER OF SCREEN).

C 2

Table for C 2 with columns: DEPTH (nearest ft.), 1-51.

C 3

PUMPING TEST

HOURS PUMPED (3), PUMPING RATE (17.64), METHOD USED TO MEASURE PUMPING RATE (Submersible), WATER LEVEL (32 ft. before, 67 ft. when pumping), TYPE OF PUMP USED (S submersible).

PUMP INSTALLED

DRILLER INSTALLED PUMP (YES/NO), TYPE OF PUMP INSTALLED (S), CAPACITY: GALLONS PER MINUTE (31), PUMP HORSE POWER (37), PUMP COLUMN LENGTH (43), CASING HEIGHT (above/below).

LOCATION OF WELL ON LOT

SHOW PERMANENT STRUCTURE SUCH AS BUILDING, SEPTIC TANKS, AND /OR LANDMARKS AND INDICATE NOT LESS THAN TWO DISTANCES (MEASUREMENTS TO WELL). Includes diagram showing well location relative to property line.

NUMBER OF UNSUCCESSFUL WELLS: 0

WELL HYDROFRACTURED (Y/N)

CIRCLE APPROPRIATE LETTER A, E, P

I HEREBY CERTIFY THAT THIS WELL HAS BEEN CONSTRUCTED IN ACCORDANCE WITH COMAR 26.04.04 "WELL CONSTRUCTION" AND IN CONFORMANCE WITH ALL CONDITIONS STATED IN THE ABOVE CAPTIONED PERMIT...

DRILLERS LIC. NO. M S D 162

DRILLERS SIGNATURE (MUST MATCH SIGNATURE ON APPLICATION) LIC. NO. AW 766

SITE SUPERVISOR (sign. of driller or journeyman responsible for sitework if different from permittee)

GRAVEL PACK IF WELL DRILLED WAS FLOWING WELL INSERT F IN BOX 68

MDE USE ONLY (NOT TO BE FILLED IN BY DRILLER) T (E.R.O.S.) W Q

TELESCOPE CASING LOG INDICATOR OTHER DATA

SEQUENCE NO. (MDE USE ONLY)

STATE OF MARYLAND APPLICATION FOR PERMIT TO DRILL WELL

STATE PERMIT NUMBER

1 2 3 6 9162

526193 please type

Ho 95 0666 fill in this form completely

Date Received (APA)

11/19/07

OWNER INFORMATION

Grayson Homes 15 Last Name Owner 34 First Name

9025 Chevrolet Drive 36 Street or RFD 55

Ellicott City MD 21043 57 Town 70 State 72 Zip 76

DRILLER INFORMATION

Michael D. Isom MS D 162 76 Driller's Name License No. 81

G. Edgar Hart Sons' Corp. Firm Name

12047 Falls Road, Cockeysville 21030 Address

Signature Date 12/26/06

B 3

LOCATION OF WELL

Howard 8 COUNTY 21

Belle Haven Est 23 SUBDIVISION 42

SECTION 44 46 LOT 13 48 50

Woodbine 52 NEAREST TOWN 71

MILES FROM TOWN (enter 0 if in town) 2 M I 73 76 77 78

B 4

DIRECTION OF WELL FROM TOWN (CIRCLE BOX)

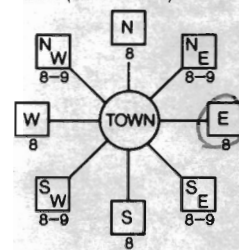

Union Chapel Road 11 NEAR WHAT ROAD 30

ON WHICH SIDE OF ROAD (CIRCLE APPROPRIATE BOX)



34 30 37 DISTANCE FROM ROAD ENTER FT OR MI 38 39

TAX MAP: 14 BLK: 20 PARCEL 66

B 2 1 2

WELL INFORMATION

APPROX. PUMPING RATE (GAL. PER MIN.) 5 8 12

AVERAGE DAILY QUANTITY NEEDED (GAL. PER DAY) 14 750 20

USE FOR WATER (CIRCLE APPROPRIATE BOX)

- Domestic Potable Supply & Residential Irrigation (circled)
Farming (Livestock Watering & Agricultural Irrigation)
Industrial, Commercial, Dewatering
Public Water Supply Well
Test, Observation, Monitoring
Geo-Thermal

NOT TO BE FILLED IN BY DRILLER HEALTH DEPARTMENT APPROVAL

Howard 13 4516057 COUNTY NAME COUNTY NO.

STATE SIGNATURE INSERT S

DATE ISSUED 2/23/07 Kim Wall 2/23/08 43 MM DD YY 48 CO SIGNATURE EXP. DATE

NORTH GRID 530 000 EAST GRID 0785 000 50 55 57 63

APPROXIMATE DEPTH OF WELL 300 24 28 FEET

APPROXIMATE DIAMETER OF WELL 6 NEAREST INCH

METHOD OF DRILLING (circle one)

- Bored (or Augered) Jetted Jetted & Driven
Air-Rotary Air-PerCussion Rotary (Hydraulic Rotary)
Cable Reverse-Rotary Drive-Point
other

REPLACEMENT OR DEEPEMED WELLS (CIRCLE APPROPRIATE BOX)

- This well will not replace an existing well (circled)
This well will replace a well that will be abandoned and sealed
This well will replace a well that will be used as a standby-contact local approving authority for policy on standby wells
This well will deepen an existing well

PERMIT NUMBER OF WELL TO BE REPLACED OR DEEPEMED (IF AVAILABLE) 41 52

Not to be filled in by driller (MDE OR COUNTY USE ONLY)

APPROP. PERMIT NUMBER Ho 2007 G002 PERMIT No. Ho 95 0666

SHOW MAJOR FEATURES OF BOX & LOCATE WELL WITH AN X

- SOURCES OF DRILLING WATER
1. Well
2.
3.

WRITE THE BOX NUMBER FROM THE MAP HERE

E 7805 N 530

DRAW A SKETCH BELOW SHOWING LOCATION OF WELL IN RELATION TO NEARBY TOWNS AND ROADS AND GIVE DISTANCE FROM WELL TO NEAREST ROAD JUNCTION



SPECIAL CONDITIONS Drill wells Per Preliminary Plan P-06-03 signed 8/21/06

HOWARD COUNTY HEALTH DEPARTMENT
 BUREAU OF ENVIRONMENTAL HEALTH
 WELL & SEPTIC PROGRAM
 TEL: (410)313-1771 FAX: (410)313-2648

Information Form for the Installation of the Well Pump, Pitless Adapter, and Supply Piping

NOTE: The installer is responsible for requesting an inspection prior to 9 am on the day of the desired inspection. No work is to be covered until approved by the Health Department. All installations must comply with the National Standard Plumbing Code (NSPC, as amended locally) and COMAR 26.04.04 (MD Well Construction Regulations). Submission of a complete form is required prior to Use and Occupancy approval.

Company Name: _____ Telephone #: _____
 Address: _____

(**Must circle one**) Licensed Plumber Licensed Well Driller Licensed Well Pump Installer
 License # and name of individual responsible for the field installation:
 Name (Print): _____ License# _____

***A licensed individual must perform the actual installation. Apprentices must be under the supervision of a licensed journeyman or master plumber, pump installer or well driller. Licenses may be subjected to field verification. Unlicensed individuals may be reported to the appropriate licensing agency.**

Name of Property Owner: _____ Telephone #: _____
 Subdivision: _____ Lot #: _____ Well Tag #: HO-15-0666
 Site Address: _____

<u>Submersible Pump Data</u>	<u>Pitless Adapter</u>	<u>Well Cap and Electric Conduit</u>
Make: _____	Make: _____	Two piece watertight cap: _____
Model #: _____	Model#: _____	Screened, vented well cap: _____
Pump Capacity _____ GPM	Depth: _____ (36" min)	Cap secured to casing: _____
Well Yield: _____ GPM	NSF/WSC approved: _____	Conduit min 18" B.G.: _____
Depth of well encountered at time of pump installation: _____ (feet)		
Conduit secured to well cap: _____		
If pump capacity exceeds well yield, a low water cut off switch is required by NSPC 1990 Section 17.8.4		
Torque arrestors, Cable guards, or other acceptable method used- Must circle one		
Safety rope, if used, attached to brass rope adapter or other acceptable method <u>inside of well casing</u>		

<u>Piping to house</u>	<u>House Connection</u>
Type: _____	PVC sleeve to undisturbed soil at wall penetration: _____
PSI: _____ (160 psi min)	Length of sleeve(5' minimum from foundation): _____
Depth of supply line: _____ (36" min)	Sleeve sealed properly: _____

The water supply line is required to be at least ten feet from the septic tank, pump chamber, sewage piping, distribution box, drainfields, and sewage reserve area. If this cannot be accomplished, contact this office for approval prior to installation.

Signature of company representative responsible for installation _____ date _____

For Health Department Use Only – Not to be completed by Installer

Date Insp. Requested: 5/14/13 Date Insp. Approved: 5/14/13 Inspector: (KWD)
 Inspection Data: Pitless adapter watertight & water supply line at least 36" below grade
 Two piece cap installed and attached to casing securely
 Elec. conduit extends at least 18" below grade/attached to cap properly
 Safety rope not outside of well cap/casing
 Correct well tag attached properly and casing 8" above finished grade
 Water supply line sleeved adequately at house connection
 Adequate grout observed below pitless adapter

**HOWARD COUNTY HEALTH DEPARTMENT
BUREAU OF ENVIRONMENTAL HEALTH
WELL & SEPTIC PROGRAM
TEL: (410)313-1771 FAX: (410)313-2648**

Information Form for the Installation of the Well Pump, Pitless Adapter, and Supply Piping

NOTE: The installer is responsible for requesting an inspection prior to 9 am on the day of the desired inspection. No work is to be covered until approved by the Health Department. All installations must comply with the National Standard Plumbing Code (NSPC, as amended locally) and COMAR 26.04.04 (MD Well Construction Regulations). Submission of a complete form is required prior to Use and Occupancy approval.

Company Name: Northern Virginia Drilling Telephone #: 703-361-6859
Address: 11356 Industrial Rd.
MANASSAS VA 20109

(Must circle one) Licensed Plumber Licensed Well Driller Licensed Well Pump Installer
License # and name of individual responsible for the field installation:
Name (Print): SHAWN MILLER License# MSD216

*A licensed individual must perform the actual installation. Apprentices must be under the supervision of a licensed journeyman or master plumber, pump installer or well driller. Licenses may be subjected to field verification. Unlicensed individuals may be reported to the appropriate licensing agency.

Name of Property Owner: K. HUNJANIAN Telephone #: 703-885-7193
Subdivision: BELLE HAVEN Lot #: 13 Well Tag #: HO-95-06060
Site Address: 2810 BRIDLEHEATH CT
WOODBINE MD 21797

Submersible Pump Data	Pitless Adapter	Well Cap and Electric Conduit
Make: <u>Flow and Walling</u>	Make: <u>BOSMART</u>	Two piece watertight cap: <u>yes</u>
Model #: <u>4F10507</u>	Model#: <u>D10055</u>	Screened, vented well cap: <u>yes</u>
Pump Capacity: <u>10</u> GPM	Depth: <u>36" +</u> (36" min)	Cap secured to casing: <u>yes</u>
Well Yield: <u>17.6</u> GPM	NSF/WSC approved: _____	Conduit min 18" B.G.: <u>yes</u>
Depth of well encountered at time of pump installation: <u>300</u> (feet)		Conduit secured to well cap: <u>yes</u>

If pump capacity exceeds well yield, a low water cut off switch is required by NSPC 1990 Section 17.8.4

Torque arrestors Cable guards, or other acceptable method used- Must circle one

Safety rope, if used, attached to brass rope adapter or other acceptable method inside of well casing yes

Piping to house

Type: polyethylene
PSI: 300 (160 psi min)
Depth of supply line: 36" + (36" min)

House Connection

PVC sleeve to undisturbed soil at wall penetration: yes
Length of sleeve (5' minimum from foundation): 10'
Sleeve sealed properly: yes

The water supply line is required to be at least ten feet from the septic tank, pump chamber, sewage piping, distribution box, drainfields, and sewage reserve area. If this cannot be accomplished, contact this office for approval prior to installation.

Signature of company representative responsible for installation: Shawn Miller date 5-10-13

For Health Department Use Only - Not to be completed by Installer

Date Insp. Requested: _____ Date Insp. Approved: _____ Inspector: _____
Inspection Data: Pitless adapter watertight & water supply line at least 36" below grade _____
Two piece cap installed and attached to casing securely _____
Elec. conduit extends at least 18" below grade/attached to cap properly _____
Safety rope not outside of well cap/casing _____
Correct well tag attached properly and casing 8" above finished grade _____
Water supply line sleeved adequately at house connection _____
Adequate grout observed below pitless adapter _____

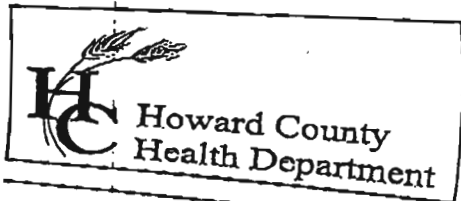

7178 Columbia Gateway Drive, Columbia, MD 21046
(410) 313-2640 Fax (410) 313-2640
TDD (410) 313-2323 Toll Free 1-866-313-2640
website: www.hchealth.org

Penny E. Borenstein, M.D., M.P.H., Health Officer

TO ALL INTERESTED PARTIES

When submitting a well permit application for a proposed well for new construction, please indicate one of the following:

Well Site Location:	Lots	
Belle Haven Estates	1-46	Union Chapel Road
Subdivision/Property Name	Lot#	Road Name

The well site has been staked by DMW, Inc 410-296-3333
(professional land surveyor or company employing professional land surveyors)
on 12/29/06 (date) and does not require a site inspection.

The well driller, builder or property owner will call the Health Department to schedule a time to meet in the field to verify the proposed well site location.

This sheet, along with two copies of an acceptable well site plan, must be attached to the green well permit application.

Revised 3/11/05

BRIDAL WREATH CT.

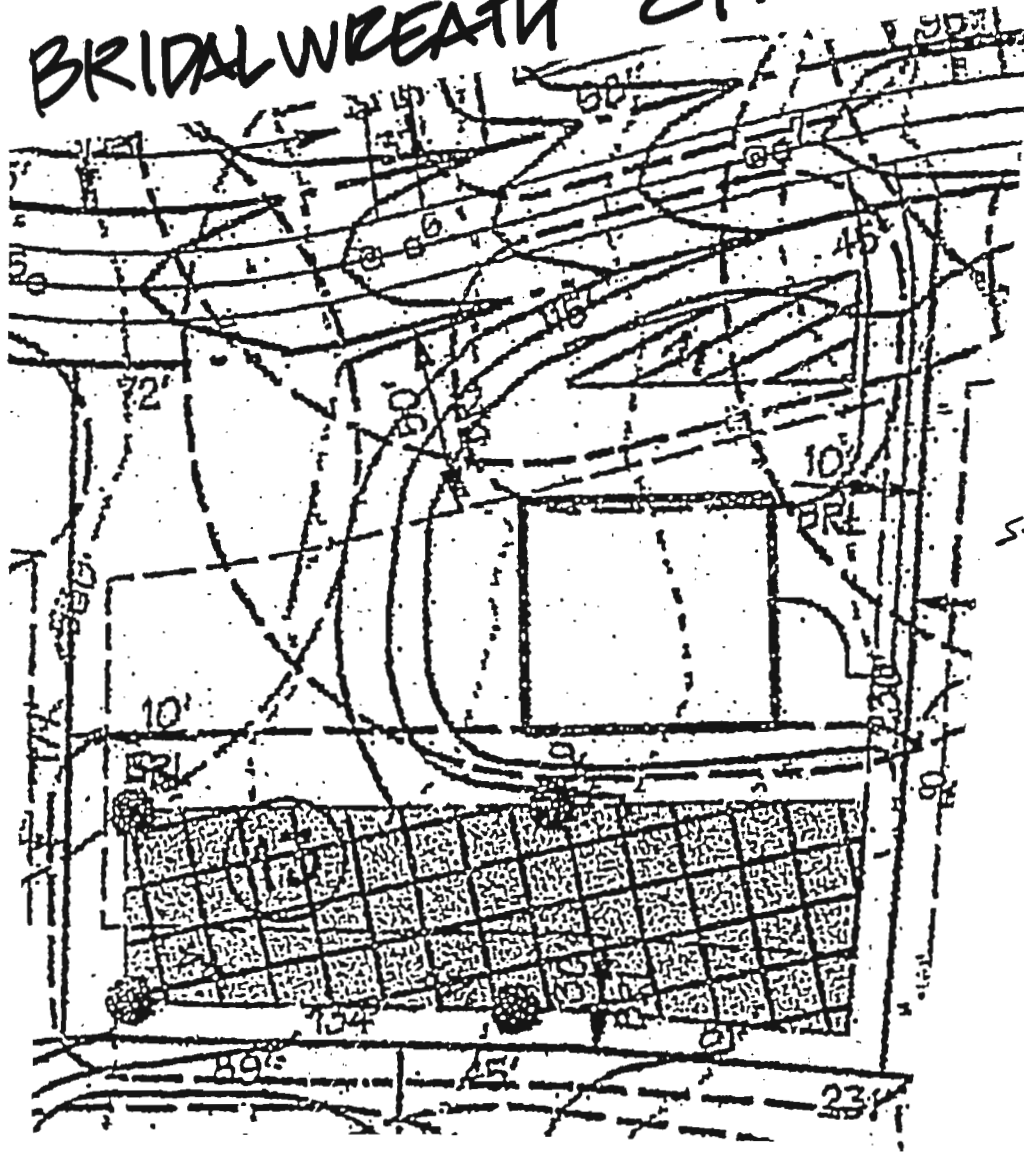

2/21/07
 wells & de
 or me
 staked by
 DMW

BELLE HAVEN ESTATES

LOT 13

DMW

Daft-McCune-Walker, Inc.

200 East Pennsylvania Avenue
 Towson, Maryland 21286
 (410) 296-3333
 Fax 296-4705

A Team of Land Planners,
 Landscape Architects,
 Engineers, Surveyors &
 Environmental Professionals

Job No. 01067 | Scale: 1"=50' | Date: 12/26/06 | Drawn By: MDT

N:\01067\01067\Final\Lot Wells\FINAL\Lot13.dgn

Tue Feb 13 10:33:31 2007

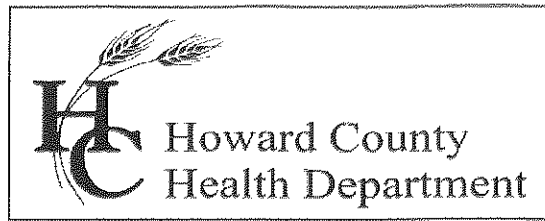

Bureau of Environmental Health
7178 Columbia Gateway Drive, Columbia, MD 21046-2147
Main: 410-313-6300 | Fax: 410-313-6303
TDD 410-313-2323 | Toll Free 1-866-313-6300
www.hchealth.org
Facebook: www.facebook.com/hocohealth
Twitter: HowardCoHealthDep

Maura J. Rossman, M.D., Health Officer

INTERIM CERTIFICATE OF POTABILITY
PERMANENT DEVIATION FOR NITRATES

Expiration Date – February 27, 2014

August 27, 2013

Homeowner
2810 Bridalwreath Ct.
Woodbine, MD 21797

RE: Belle Haven Estates, Lot 13
2810 Bridalwreath Ct.
Building Permit: B13000087
Well Permit: HO-95-0666

Dear Homeowner:

This is to advise you that the septic system installation and water well construction for the above referenced property have been inspected and approved. Final approval of the septic system was granted on **7/9/2013**. Final approval of the well line connection to the dwelling was granted on **5/14/2013**. The well construction was completed on **4/6/2007**. Water samples were collected on **7/19/2013 & 7/26/2013**.

The water sample results indicate that the water samples submitted for testing were free of coliform and fecal coliform bacteria at the time of sampling and are bacteriologically safe for drinking.

The untreated water sample collected on **7/19/2013** indicated a nitrate level of **12.4 mg/L**. **This exceeds the maximum contaminant limit of 10 mg/L set forth in COMAR 26.04.04.09**. After installation of a nitrate removal device (kitchen tap reverse osmosis system), a post-treatment water sample was collected on **7/26/2013** and indicated a nitrate level of **<1.0 mg/L**.

This Department will grant a **permanent deviation** to the Interim Certificate of Potability on condition that the nitrate removal system effectively maintains a nitrate-nitrogen contaminant level of **10 mg/L or less**.

Furthermore, it will be necessary for you to comply with the following conditions:

1. The system must be properly operated and maintained continuously in accordance with the service contract for the life of the residence.
2. It is recommended that a Maryland certified water laboratory certified for nitrates analysis perform a yearly nitrate analysis.

3. If you decide to sell or rent your home in the future, you must make any potential buyer/tenant aware of this permanent deviation. **A person who fails to make this disclosure is subject to the penalties set out in COMAR 26.04.04.12F Enforcement and Environment Article 9-1311, Annotated Code of Maryland.**

This certifies that the initial sampling requirements of COMAR 26.04.04 "Well Regulations" have been met for the water supply system installed under well permit HO-95-0666. Although the submitted sample results are in compliance with COMAR standards, the Health Department does not guarantee water supplies.

This Interim Certificate of Potability will expire **six months** from the date of issuance. Submission of a second bacteriological test indicating the water is free of coliform and fecal coliform bacteria is required prior to the expiration date, after which time a Final Certificate of Potability will be issued. **Failure to submit an additional sample and obtain a Final Certificate of Potability will result in a Notice of Violation and is punishable as a misdemeanor under the *Annotated Code of Maryland, Environment Article, 9-1311*, subject to a fine of up to \$500 or imprisonment not to exceed three months.**

Please contact (410) 313-1773 to schedule a final water sample appointment or contact a Maryland certified water quality laboratory to schedule a water sample. A list of laboratories certified by the state of Maryland may be found at the following website:
<http://www.mde.state.md.us/assets/document/WSP-Labs-2010apr16.pdf>

Approving Authority,

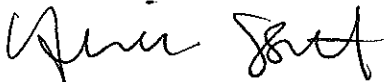

Heidi Scott, R.S.
Environmental Sanitarian
Well & Septic Program

cc: Howard County Dept. of Inspections, Licenses, and Permits
Community Hygiene Program
File

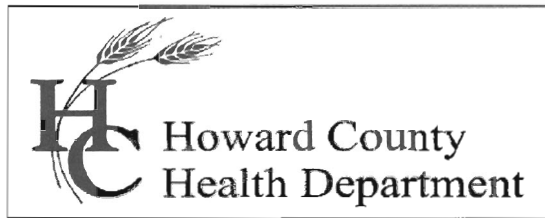

Bureau of Environmental Health
7178 Columbia Gateway Drive, Columbia, MD 21046-2147
Main: 410-313-6300 | Fax: 410-313-6303
TDD 410-313-2323 | Toll Free 1-866-313-6300
www.hchealth.org
Facebook: www.facebook.com/hocohealth
Twitter: HowardCoHealthDep

Maura J. Rossman, M.D., Health Officer

TEMPORARY INTERIM CERTIFICATE OF POTABILITY
TEMPORARY DEVIATION FOR NITRATES

Expiration Date – August 10, 2013

July 26, 2013

Homeowner
2810 Bridalwreath Ct.
Woodbine, MD 21797

**RE: Belle Haven Estates, Lot 13
2810 Bridalwreath Ct.
Building Permit: B13000087
Well Permit: HO-95-0666**

Dear Homeowner:

This is to advise you that the septic system installation and water well construction for the above referenced property have been inspected and approved. Final approval of the septic system was granted on **7/9/2013**. Final approval of the well line connection to the dwelling was granted on **5/14/2013**. The well construction was completed on **4/6/2007**. Water samples were collected on **7/19/2013**.

The water sample results indicate that the water samples submitted for testing were free of coliform and fecal coliform bacteria at the time of sampling and are bacteriologically safe for drinking.

The untreated water sample collected on **7/19/2013** indicated a nitrate level of **12.4 mg/L**. **This exceeds the maximum contaminant limit of 10 mg/L set forth in COMAR 26.04.04.09.**

This is a **temporary deviation** to allow additional time for installation of a nitrate removal system and submission of water sample results indicating that the treated water meets COMAR requirements.

This Department will grant a **temporary deviation** to the Interim Certificate of Potability on condition that a nitrate removal system is installed and a water sample result for post-treatment nitrate level at the primary drinking tap is submitted to this Department **within 15 days**. Those results must indicate that the nitrate removal system is effectively maintaining a nitrate level of less than **10 mg/L**.

Furthermore, it will be necessary for you to comply with the following conditions:

1. The system must be properly operated and maintained continuously in accordance with the service contract for the life of the residence.

2. It is recommended that a Maryland certified water laboratory certified for nitrates analysis perform a yearly nitrate analysis.
3. If you decide to sell or rent your home in the future, you must make any potential buyer/tenant aware of the above condition. **A person who fails to make this disclosure is subject to the penalties set out in COMAR 26.04.04.12F *Enforcement and Environment Article 9-1311, Annotated Code of Maryland.***

This Temporary Interim Certificate of Potability will expire **15 days** from the date of issuance. **Failure to submit the required nitrate sample results and obtain an Interim Certificate of Potability before the expiration date will result in a Notice of Violation and is punishable as a misdemeanor under the *Annotated Code of Maryland, Environment Article, 9-1311*, subject to a fine of up to \$500 or imprisonment not to exceed three months.**

Please contact (410) 313-1773 to schedule a water sample appointment or contact a Maryland certified water quality laboratory to schedule a water sample. A list of laboratories certified by the state of Maryland may be found at the following website:

<http://www.mde.state.md.us/assets/document/WSP-Labs-2010apr16.pdf>

Approving Authority,

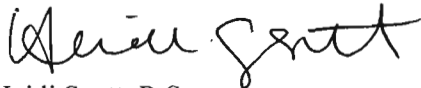

Heidi Scott, R.S.
Environmental Sanitarian
Well & Septic Program

cc: Howard County Dept. of Inspections, Licenses, and Permits
Community Hygiene Program
File

FOUNTAIN VALLEY ANALYTICAL LABORATORY, INC.

1413 Old Taneytown Rd. Westminster, MD (410) 848-1014 (410) 876-4554 FAX (410) 848-0298

REPORT OF ANALYSIS

Laboratory ID #: 90337 Account #: 3192
Reference: Belle Haven Lot 13 Company: Northern Virginia Drilling
Location: 2810 Bridalwreath Court Requested By: Dick Trelease
Woodbine, MD 21797 Source: Well Water
Date/ Time Collected: 7/26/2013 1145 Site: R/O Tap
Date/Time Rec'd: 7/26/2013 1445 Treatment: Reverse Osmosis
Chlorine ppm: Free: ND Total: ND pH: 5.4
Collected By: C. Mooshian 7268CM Well #: HO-95-0666

PARAMETERS	RESULTS	UNITS	REFERENCE	METHOD	DATE/TIME/ANALYST
Nitrate	<1.0	mg/L	10	601	7/26/2013 / 1630 / CCH

Nitrate OK
8/26/13 H9

NOTES

- 1 mg/L = milligrams per liter (also, parts per million)
- 2 Results less than or within the reference range are considered satisfactory and within potable water limits at the time of sampling.
- 3 ND:None Detected
- 4 Visual well check: Sealed, vented cap
- 5 pH & Chlorine level tested on site

Reason for Test : Use & Occupancy
Building Permit # : 13-000087

Date Reported: 7/29/2013



Bureau of Environmental Health
 7178 Columbia Gateway Drive, Columbia, MD 21046-2147
 Main: 410-313-2640 | Fax: 410-313-2648
 TDD 410-313-2323 | Toll Free 1-866-313-6300
 www.hchealth.org
 Facebook: www.facebook.com/hocohealth
 Twitter: HowardCoHealthDep

Maura J. Rossman, M.D., Health Officer

REQUEST FOR TEMPORARY DEVIATION TO
 NITRATE STANDARDS FOR CERTIFICATE OF POTABILITY

DATE: 7/26/13 WELL PERMIT #: HO - 95 - 0666

PROPERTY OWNER: Kent & Irene Qualls

SUBDIVISION & LOT #: Belle Haven Lot 13

PROPERTY ADDRESS: 2810 Brilalworth Ct.
Woodbine, MD 21797

TESTIMONIAL: (Steps to be taken by the well owner or agent to bring the well into compliance with COMAR 26.04.04.09 (B) within fifteen (15) days)

Installing of Reverse osmosis system by builder
@ kitchen sink and fridge/ice maker

CONDITIONS:

- 1) Within fifteen (15) days, the well installed under permit # HO - 95 - 0666 will be documented to have a nitrate level of 10 ppm or less at the primary drinking tap as a result of installation of a nitrate filtration system.
- 2) If the nitrate condition cannot be remediated to a level of 10 ppm or less via installation of a filtration system, then drilling a replacement well would likely be necessary. Issuance of a Final Certificate of Potability will be delayed until the issue is resolved.

I hereby request that a Fifteen-Day Temporary Deviation to COMAR 26.04.04.09 be granted for the well installed under permit # HO - 95 - 0666. I am fully aware of the conditions under which this deviation will be granted, and of my responsibilities as the well owner which include advising any future buyer/tenant of the installation, condition and maintenance responsibilities of the nitrate removal device.

Prospective Owner's Original Signature(s) (Person(s) that intend to live in the dwelling)

[Signature]

Prospective Owner's Day Time Phone Number(s)

617-645-1257

REPORT OF ANALYSIS

Laboratory ID #:	90168	Account #:	3192
Reference:	Belle Haven Lot 13	Company:	Northern Virginia Drilling
Location:	2810 Bridalwreath Court Woodbine, MD 21797	Requested By:	Dick Trelease
Date/ Time Collected:	7/19/2013 1240	Source:	Well Water
Date/Time Rec'd:	7/19/2013 1330	Site:	Kitchen Sink Tap
Chlorine ppm:	Free: ND Total: ND	Treatment:	None
Collected By:	J. Yeager 6176JY	pH:	6.2
		Well #:	HO-95-0666

PARAMETERS	RESULTS	UNITS	REFERENCE	METHOD	DATE/TIME/ANALYST
✓ Bacteria, Coliform, Total, MPN	<1.0	MPN/ 100 ml	<1.0	SM18 9223	7/20/2013 / 1000 / LLO
✓ Bacteria, E. coli, MPN	<1.0	MPN/ 100 ml	<1.0	SM18 9223	7/20/2013 / 1000 / LLO
Nitrate	12.4	mg/L	10	601	7/19/2013 / 1730 / CCH
✓ Turbidity	0.84	NTU	<10	SM18 2130B	7/19/2013 / 1440 / CRS
✓ Sand	NS	mg/L	5	Visual/Gravimetric	7/19/2013 / 1440 / CRS

*Need nitrate
retest 7/26/13 HS*

NOTES

- 1 mg/L = milligrams per liter (also, parts per million)
- 2 MPN/ 100 ml = Most Probable Number [of viable bacteria] per 100 ml of sample.
- 3 NS = None Seen (NS indicates less than 5 mg/L)
- 4 NTU = Nephelometric Turbidity Units
- 5 Results less than or within the reference range are considered satisfactory and within potable water limits at the time of sampling.
- 6 ND:None Detected
- 7 Visual well check: Sealed, vented cap
- 8 pH & Chlorine level tested on site

Reason for Test : Use & Occupancy
 Building Permit # : 13-000087

Date Reported: 7/22/2013