

PUB. SEWER STATUS VERIFIED BY _____

ISSUE DATE: _____

PERMIT

P 532457

APPROVAL DATE: 11/20/09

Tax ID # 03-306747

A REPAIR

TANK REPLACEMENT
ON-SITE SEWAGE DISPOSAL SYSTEM
HOWARD COUNTY HEALTH DEPARTMENT
BUREAU OF ENVIRONMENTAL HEALTH

Fogles Septic Clean, Inc IS PERMITTED TO INSTALL ALTER

ADDRESS: 580 Obrecht Rd, Sykesville MD 21784 PHONE NUMBER: 410-795-5670

SUBDIVISION: Farside LOT NUMBER: 2

ADDRESS: 11661 Farside Road PROPERTY OWNER: Donald Patrick

SEPTIC TANK CAPACITY (GALLONS): 2000

PUMP CHAMBER CAPACITY (GALLONS): NA

NUMBER OF BEDROOMS: NA

SQUARE FOOTAGE (OF HOUSE): <3500

LINEAR FEET OF TRENCH REQUIRED: NA

TRENCHES:	Install new 2,000 gallon septic tank for increase in square footage due to addition. Collapse and fill old tank.
LOCATION:	
ADDITIONAL NOTES:	1. Tank layout inspection must be completed prior to tank installation 2. Existing septic tank must be pumped and properly abandoned

PLANS APPROVED: Heidi Scott DATE: 11/2/2009

NOTE: PERMIT VOID AFTER 2 YEARS

NOTE: CONTRACTOR RESPONSIBLE FOR SCHEDULING A PRE-CONSTRUCTION INSPECTION FOR ALL INSTALLATIONS

NOTE: WATERTIGHT SEPTIC TANKS REQUIRED

NOTE: ALL PARTS OF SEPTIC SYSTEM SHALL BE 100 FEET FROM ANY WATER WELL

NOTE: MANHOLE RISERS REQUIRED ON ALL SEPTIC TANKS AND PUMP CHAMBERS

NEITHER THE HOWARD COUNTY COUNCIL OR THE HEALTH DEPARTMENT IS RESPONSIBLE FOR THE SUCCESSFUL OPERATION OF ANY SYSTEM PERMITTEE RESPONSIBLE FOR OBTAINING FINAL APPROVAL ON THIS PERMIT CALL 410-313-2640 FOR INSPECTION OF SEPTIC SYSTEM

NOT TO SCALE

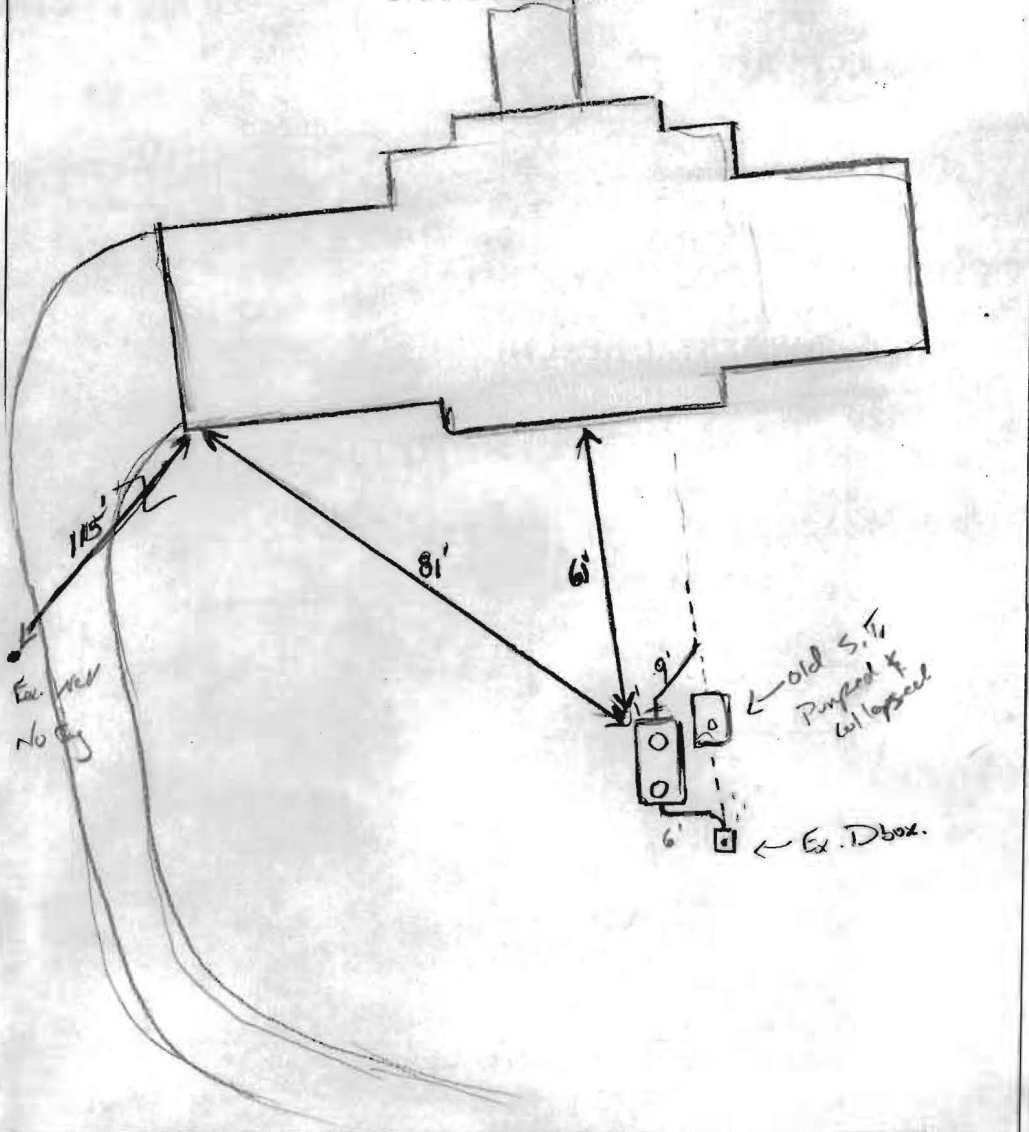

ROAD NAME

Ferside Drive.

TRENCH/DRAINFIELD DATA

WIDTH _____ INLET _____ BOTTOM _____

NUMBER OF TRENCHES _____

TOTAL LENGTH _____

ABSORPTION AREA _____

DISTRIBUTION BOX LEVEL _____

DISTRIBUTION BOX BAFFLE _____

DISTRIBUTION BOX PORT _____

SEPTIC TANK DATA

SEPTIC TANK 1 LEVEL Yes

MANUFACTURER Babylon

CAPACITY 2000 GAL

SEAM LOC Top

TANK LID DEPTH 2-4'

BAFFLES Yes

BAFFLE FILTER _____

MANHOLE LOC Front/Rear

6" PORT LOC none

WATERTIGHT TEST _____

SLOTTED Yes

DATE ON LID 10/16/09

PUMP/SEPTIC TANK LEVEL

MANUFACTURER _____

CAPACITY _____ GAL

SEAM LOC _____

TANK LID DEPTH _____

BAFFLES _____

BAFFLE FILTER _____

MANHOLE LOC _____

6" PORT LOC _____

WATERTIGHT TEST _____

SLOTTED _____

DATE ON LID _____

PRE-CONSTRUCTION:

11/20/09 ^(10:45 am) upon arrival, contractor had ^{Prior to Permit release} already exposed Ex tank and had hole dug for new tank right next to ex. tank. Depths of ex tank and plumbing not verified. Tank to remain next to ex. tank. Any further up hill, will be too deep for new tank.

INSTALLATION: (11:30 am) Tank being set, plumbing connected, Baffles installed, old tank pumped and collapsed. OK to cover all work (10/16/09)

FINAL INSPECTOR

J.K. Wally

DATE OF APPROVAL

11/20/09

