

LAYOUT 1/7/13 INSP 4 1/11/2013
 INSP 2 1/10/13 INSP 5 _____
 INSP 3 1/11/2013 INSP 6 _____

ISSUE DATE: 12/5/12 **PERMIT** P 544413
 APPROVAL DATE: 1/24/2013 A 524028

Tax ID # 05-452678
ON-SITE SEWAGE DISPOSAL SYSTEM
HOWARD COUNTY HEALTH DEPARTMENT
BUREAU OF ENVIRONMENTAL HEALTH

T & R Plumbing & Heating IS PERMITTED TO INSTALL ALTER

ADDRESS: 8421 Foundry St Savage 20763 PHONE NUMBER: 301-725-0031

SUBDIVISION: Holly House Meadows LOT NUMBER: 9

ADDRESS: 8104 Holly Manor Way PROPERTY OWNER: Cornerstone Homes

SEPTIC TANK CAPACITY (GALLONS): 2000 OUTLET BAFFLE FILTER REQUIRED

PUMP CHAMBER CAPACITY (GALLONS): _____ COMPARTMENTED TANK REQUIRED

NUMBER OF BEDROOMS: 4 APPLICATION RATE: 1.2

SQUARE FOOTAGE OF HOUSE: 1909

LINEAR FEET OF TRENCH REQUIRED: 103' 120 2x60'

TRENCHES:	Trenches to be 3.0 feet wide. Inlet is at 3.0 feet below original grade with 2.0 feet of stone below the distribution pipe. Bottom maximum depth is 5.0 feet below original grade. Effective sidewall begins at 3.0 feet below original grade. Maintain at least 9.0 feet of spacing between trenches.
LOCATION:	Set septic tank per layout inspection. Set distribution box at the highest point of the easement per layout inspection. Install 103 feet of trench on contour per layout inspection.
NOTES:	Do not order the septic tank until after layout inspection and Sanitarian approval. Stake easement corners. Call for layout inspection. Mark utilities. Gravel tickets must be available for Environmental Sanitarians. Stone must be approved by the Howard County Health Department. A written variance request is required for tanks deeper than 3 feet. A traffic bearing lid is required for tanks deeper than 4 feet.

PLANS APPROVED: Dana Bernard DATE: 7/19/12

- NOTE: PERMIT VOID AFTER 2 YEARS
- NOTE: CONTRACTOR RESPONSIBLE FOR SCHEDULING A PRE-CONSTRUCTION INSPECTION FOR ALL INSTALLATIONS
- NOTE: WATERTIGHT SEPTIC TANKS REQUIRED
- NOTE: ALL PARTS OF SEPTIC SYSTEM SHALL BE 100 FEET FROM ANY WATER WELL
- NOTE: MANHOLE RISERS REQUIRED ON ALL SEPTIC TANKS AND PUMP CHAMBERS

NEITHER THE HOWARD COUNTY COUNCIL OR THE HEALTH DEPARTMENT IS RESPONSIBLE FOR THE SUCCESSFUL OPERATION OF ANY SYSTEM
PERMITTEE RESPONSIBLE FOR OBTAINING FINAL APPROVAL ON THIS PERMIT
CALL 410-313-1771 FOR INSPECTION OF SEPTIC SYSTEM

HO-95-0743

NOT TO SCALE

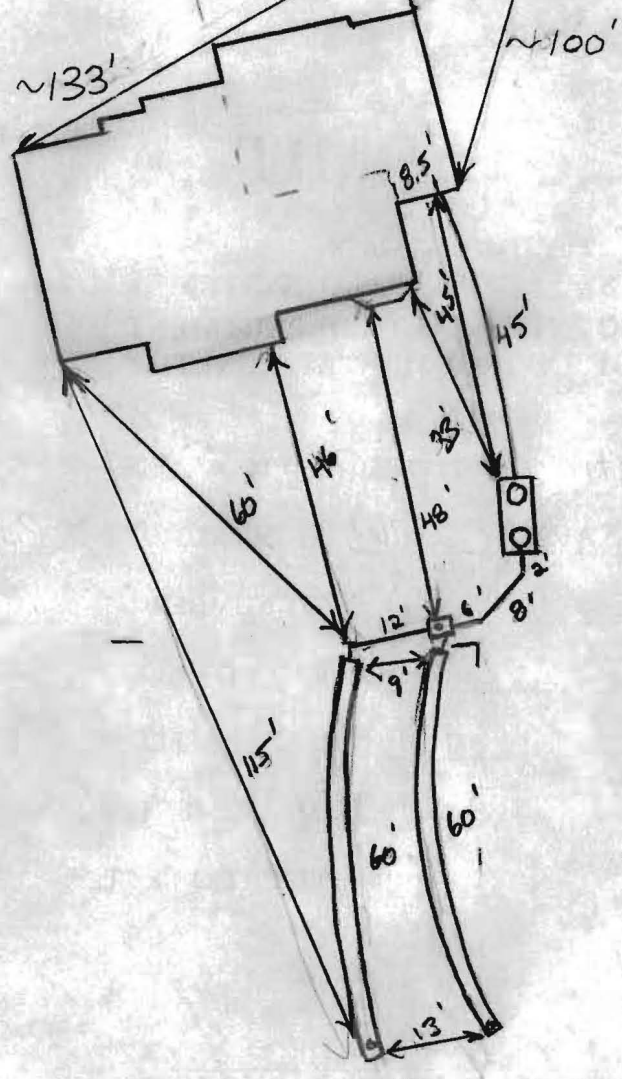

TRENCH/DRAINFIELD DATA		
WIDTH	INLET	BOTTOM
3'	3'	5'
NUMBER OF TRENCHES		2
TOTAL LENGTH		120'
ABSORPTION AREA		360 + Sidewall
DISTRIBUTION BOX LEVEL		Levelers
DISTRIBUTION BOX BAFFLE		Yes
DISTRIBUTION BOX PORT		Yes

SEPTIC TANK DATA	
SEPTIC TANK 1 LEVEL	Yes
MANUFACTURER	Mayer Bro's
CAPACITY	2000 GAL
SEAM LOC	Top
TANK LID DEPTH	1.5'
BAFFLES	Yes
BAFFLE FILTER	—
MANHOLE LOC	Front/Rear
6" PORT LOC	None
WATERTIGHT TEST	—
SLOTTED	Yes
DATE ON LID	N/A
PUMP/SEPTIC TANK LEVEL N/A	
MANUFACTURER	—
CAPACITY	— GAL
SEAM LOC	—
TANK LID DEPTH	—
BAFFLES	—
BAFFLE FILTER	—
MANHOLE LOC	—
6" PORT LOC	—
WATERTIGHT TEST	—
SLOTTED	—
DATE ON LID	—

ROAD NAME

PRE-CONSTRUCTION:

1/7/13 Contractor did not have laser on-site. Gave tank placement but no trenches. Well line inspected. OK. (KW)

INSTALLATION:

1/10/13 Septic tank set. Contractor short in field. Install 2x 60' trenches across top part of SRA. Keep trenches open for inspection. (KW) 1/11/13 System complete. Need to level Dbox. No filter cloth on-site. Contractor went to get some. Will stop back later for inspect. OK to start backfilling. 1/11/13 (pm) No leveler on site. Filter cloth on trenches OK to clear. exempt for Pbox. (KW)

1/24/2013 Levelers installed and adjusted. (BB)

FINAL INSPECTOR B. Baker DATE OF APPROVAL 1/24/2013

HOLLY MANOR WAY
50' R/W

L=245.47'
R=875.00

10' PUBLIC TREE MAINTENANCE EASEMENT

73.15'
S83°35'40"W

LOT 8

EX. WELL
HO-95-0743

S75°07'26"E
248.79'

44.0'

10' BRL

69.9'

SEE DETAIL

LOT 9

104.4'

117.2'

30' BRL

217.52'
S15°23'57"W

122.72'
N72°22'11"W

10' BRL

PARCEL 'D' TO BE CONVEYED TO OWNER OF PARCEL 23 FOR FUTURE USE-IN-COMMON ACCESS

Wall check
OK 12/5/12
HS

GRID NORTH

BIORDI RUDDLPH V
BIORDI SUSAN GAY T/E
MAP 45, GRID 6, PARCEL 23
12202 LIME KILN RD
L.F. 4584/261
ZONE: RR

FIRST FLOOR ELEVATION = 424.5'
OFFSET DIMENSIONS TO PROPERTY LINES ARE ± 0.1'

SURVEYOR'S CERTIFICATE

I HEREBY CERTIFY THAT THESE DOCUMENTS, WERE PREPARED BY ME OR UNDER MY RESPONSIBLE CHARGE, AND THAT I AM A DULY LICENSED PROFESSIONAL LAND SURVEYOR UNDER THE LAWS OF THE STATE OF MARYLAND, LICENSE NO. 21320, EXPIRATION DATE 1-7-2013 AND TO THE BEST OF MY PROFESSIONAL KNOWLEDGE, INFORMATION AND BELIEF, THAT THE DIMENSIONS OF THE BUILDING WALLS SHOWN HEREON ARE CORRECT; THAT THEY ARE BASED ON A FIELD RUN SURVEY PERFORMED BY BENCHMARK ENGINEERING, INC. ON 11/16/12.

Donald A. Mason
DONALD A. MASON
PROFESSIONAL LAND SURVEYOR
MD REG. No. 21320
FOR BENCHMARK ENGINEERING, INC.
MD REG. No. 351
FEMA FIRM No. 240044 0041 B
ZONE: C
DATED: 12/04/86

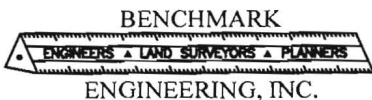

8480 BALTIMORE NATIONAL PIKE • SUITE 418
ELLCOTT CITY, MARYLAND 21043
phone: 410-465-6105 • fax: 410-465-6644
www.bei-civilengineering.com

FIELD OBS. BY DAM&ML
COMP. BY EWF
DRAWN BY EWF

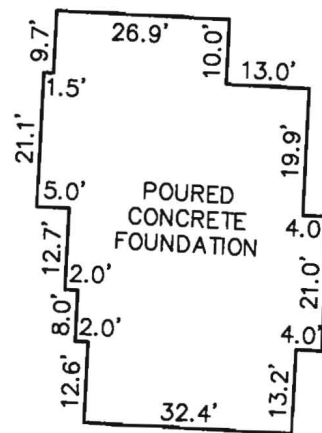

FOUNDATION DETAIL
SCALE: 1" = 30'

WALL CHECK
HOLLY HOUSE MEADOWS
PHASE TWO
PLAT No. 20378
LOT No. 9

8104 HOLLY MANOR WAY

5TH ELECTION DISTRICT
HOWARD COUNTY, MARYLAND

SCALE: 1" = 50' DATE: 11/16/12