

Permits: 410-313-2455  
 Inspections: 410-313-1810  
 Automated Line: 410-313-3800

Howard County Building/Fire Permit Application  
 Department of Inspections, Licenses & Permits  
 3430 Court House Drive  
 Ellicott City, MD 21043

Permit Number:  
**B12003916**

G12000338

Building Address: 13530 MITCHELLS WAY  
WEST FRIENDSHIP MD 21794

Suite/Apt. # \_\_\_\_\_ SDP/WP/BA #: \_\_\_\_\_

Census Tract: \_\_\_\_\_ Subdivision: CLOVER FIELD

Section: \_\_\_\_\_ Area: \_\_\_\_\_ Lot: 5

Tax Map: 15 Parcel: 4 Grid: B

Zoning: RC-DED Map Coordinates: \_\_\_\_\_ Lot Size: 54,103 sq ft

Existing Use: VACANT LOT

Proposed Use: SFD

Estimated Construction Cost: \$ 300,000

Description of Work: CONSTRUCT NEW SFD  
4 BDRM 3 1/2 BATH

Occupant or Tenant: N/A

Was tenant space previously occupied?  Yes  No

Contact Name: \_\_\_\_\_

Address: \_\_\_\_\_

City: \_\_\_\_\_ State: \_\_\_\_\_ Zip Code: \_\_\_\_\_

Phone: \_\_\_\_\_ Fax: \_\_\_\_\_

Email: \_\_\_\_\_

Property Owner's Name: CLOVER FIELD PFEFFERKOH  
LLC

Address: 11175 STRATFIELD CT.

City: MARLIOTTVILLE State: MD Zip Code: 21104

Home Phone: \_\_\_\_\_ Work Phone: 410 442-2211

Applicant's Name & Mailing Address, (if other than stated herein):  
FRANK POTEPAN  
SAME AS ABOVE

Phone: 410-442-2211 Fax: 410 442 2215

Email: F.POTEPAN@CATONSVILLEHOMES.COM

Contractor Company: CATONSVILLE HOMES

Contact Person: FRANK POTEPAN

Address: 11175 STRATFIELD CT.

City: MARLIOTTVILLE State: MD Zip Code: 21104

License No.: 990

Phone: 410-442-2211 Fax: 410 442 2215

Email: F.POTEPAN@CATONSVILLEHOMES.COM

Engineer/Architect Company: REC PLYMOUTH ROAD ARCH.

Responsible Design Prof.: LISA WINRICK

Address: 640 PLYMOUTH RD.

City: CATONSVILLE State: MD Zip Code: 21229

Phone: 410-788-0281 Fax: \_\_\_\_\_

Email: \_\_\_\_\_

BUILDING DESCRIPTION - COMMERCIAL	
Building Characteristics	Utilities
Height:	<u>Water Supply</u>
No. of stories:	<input type="checkbox"/> Public
Gross area, sq. ft./floor:	<input type="checkbox"/> Private
Area of construction (sq. ft.):	<u>Sewage Disposal</u>
Use group:	<input type="checkbox"/> Public
	<input type="checkbox"/> Private
	Electric: <input type="checkbox"/> Yes <input type="checkbox"/> No
	Gas: <input type="checkbox"/> Yes <input type="checkbox"/> No
<u>Construction type:</u>	<u>Heating System</u>
<input type="checkbox"/> Reinforced Concrete	<input type="checkbox"/> Electric <input type="checkbox"/> Oil
<input type="checkbox"/> Structural Steel	<input type="checkbox"/> Natural Gas <input type="checkbox"/> Propane Gas
<input type="checkbox"/> Masonry	<u>Sprinkler System:</u>
<input type="checkbox"/> Wood Frame	<input type="checkbox"/> N/A
<input type="checkbox"/> State Certified Modular	<input type="checkbox"/> Full
<input type="checkbox"/> Roadside Tree Project Permit	<input type="checkbox"/> Partial
<input type="checkbox"/> Yes <input type="checkbox"/> No	<input type="checkbox"/> Other Suppression
<input type="checkbox"/> Roadside Tree Project Permit #	No. of Heads:

BUILDING DESCRIPTION - RESIDENTIAL	
Building Characteristics	Utilities
<input checked="" type="checkbox"/> SF Dwelling <input type="checkbox"/> SF Townhouse	<u>Water Supply</u>
<u>620414</u> Depth	<input type="checkbox"/> Public
1 <sup>st</sup> floor: <u>54'</u> Width	<input checked="" type="checkbox"/> Private
2 <sup>nd</sup> floor: <u>46'</u> <u>58'</u>	<u>Sewage Disposal</u>
Basement:	<input type="checkbox"/> Public
<input type="checkbox"/> Finished Basement	<input checked="" type="checkbox"/> Private
<input checked="" type="checkbox"/> Unfinished Basement	Electric: <input checked="" type="checkbox"/> Yes <input type="checkbox"/> No
<input type="checkbox"/> Crawl Space	Gas: <input checked="" type="checkbox"/> Yes <input type="checkbox"/> No
<input type="checkbox"/> Slab on Grade	<u>Heating System</u>
No. of Bedrooms: <u>4</u>	<input type="checkbox"/> Electric
<u>Multi-family Dwelling</u>	<input type="checkbox"/> Oil
No. of efficiency units:	<input checked="" type="checkbox"/> Natural Gas
No. of 1 BR units:	<input type="checkbox"/> Propane Gas
No. of 2 BR units:	
No. of 3 BR units:	
Other Structure:	
Dimensions:	
Footings:	<input type="checkbox"/> Roadside Tree Project Permit
Roof:	<input type="checkbox"/> Yes <input type="checkbox"/> No
<input type="checkbox"/> State Certified Modular	<input type="checkbox"/> Roadside Tree Project Permit #
<input type="checkbox"/> Manufactured Home	

THE UNDERSIGNED HEREBY CERTIFIES AND AGREES AS FOLLOWS: (1) THAT HE/SHE IS AUTHORIZED TO MAKE THIS APPLICATION; (2) THAT THE INFORMATION IS CORRECT; (3) THAT HE/SHE WILL COMPLY WITH ALL REGULATIONS OF HOWARD COUNTY WHICH ARE APPLICABLE THERETO; (4) THAT HE/SHE WILL PERFORM NO WORK ON THE ABOVE REFERENCED PROPERTY NOT SPECIFICALLY DESCRIBED IN THIS APPLICATION; (5) THAT HE/SHE GRANTS COUNTY OFFICIALS THE RIGHT TO ENTER ONTO THIS PROPERTY FOR THE PURPOSE OF INSPECTING THE WORK PERMITTED AND POSTING NOTICES.

Applicant's Signature: FRANK POTEPAN III Print Name: FRANK POTEPAN III

Email Address: F.POTEPAN@CATONSVILLEHOMES.COM Date: 12/4/12

Title/Company: V.D.

Checks Payable to: DIRECTOR OF FINANCE OF HOWARD COUNTY  
 \*\*PLEASE WRITE NEATLY & LEGIBLY\*\*  
 FOR OFFICE USE ONLY

AGENCY	DATE	SIGNATURE OF APPROVAL
State Highways		
Building Officials		
PSZA (Zoning)		
PSZA (Engineering)		
Health	<u>12/12/12</u>	<u>R. Buckner</u>
Fire Protection		

Is Sediment Control approval required for issuance?  Yes  No  
 CONTINGENCY CONSTRUCTION START  
 ONE STOP SHOP

DPZ SETBACK INFORMATION

Front: \_\_\_\_\_

Rear: \_\_\_\_\_

Side: \_\_\_\_\_

Side St.: \_\_\_\_\_

All minimum setbacks met?  Yes  No

Is Entrance Permit Required?  Yes  No

Historic District?  Yes  No

Lot Coverage for New Town Zone: \_\_\_\_\_

SDP/Red-line approval date: \_\_\_\_\_

Filing Fee	\$ <u>100</u>
Permit Fee	\$
Tech Fee	\$
Excise Tax	\$
PSFS	\$
Guaranty Fund	\$ <u>50</u>
Add'l per Fee	\$
Total Fees	\$
Sub-Total Paid	\$
Balance Due	\$

check # 18461

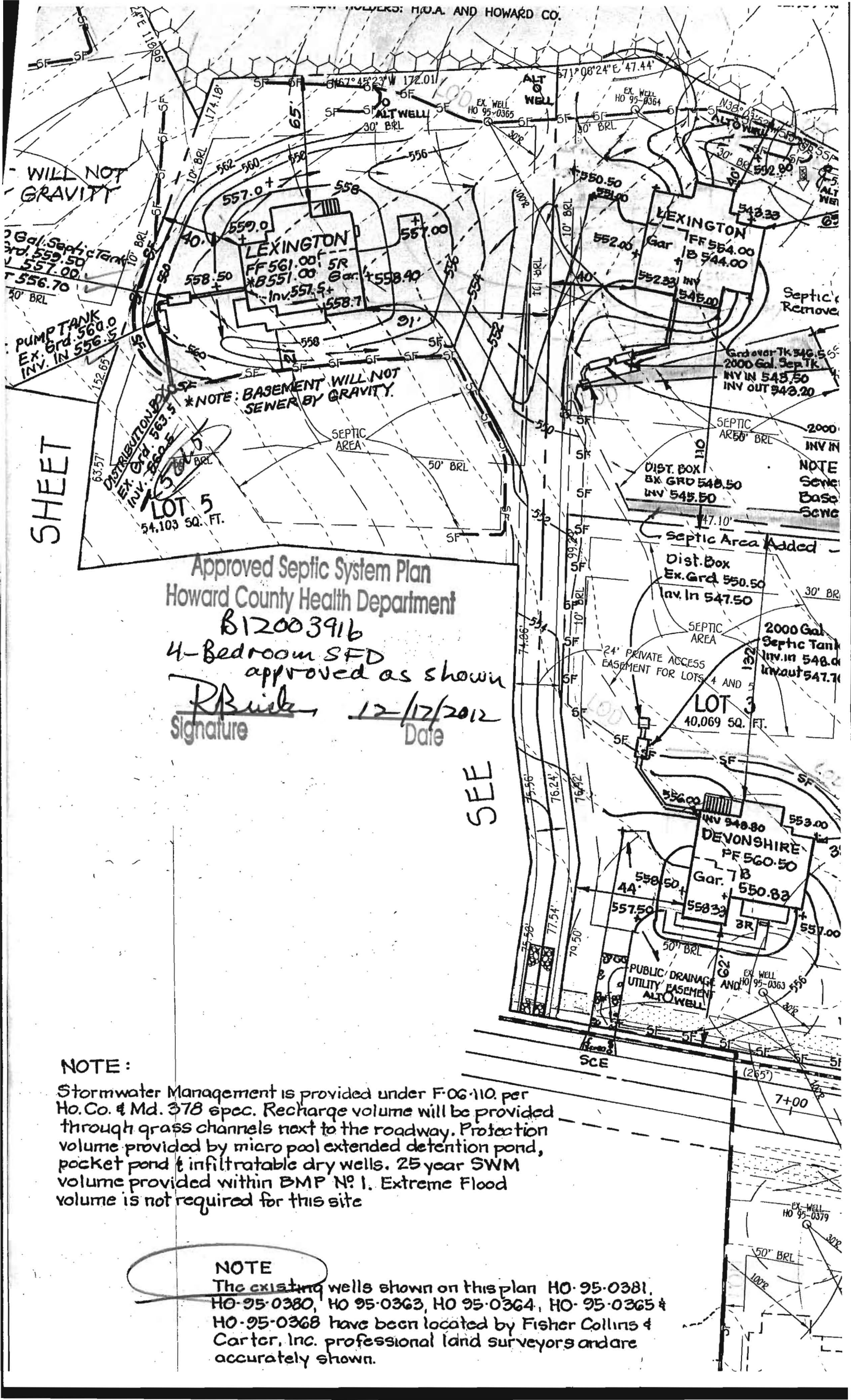

WILL NOT GRAVITY

SHEET

3 Gal. Septic Tank  
Ex. Grd. 559.50  
Inv. 557.00  
556.70

PUMPTANK  
Ex. Grd. 560.0  
Inv. IN 556.50

DISTRIBUTION BOX  
Ex. Grd. 563.5  
Inv. 560.5

LOT 5  
54,103 SQ. FT.

\*NOTE: BASEMENT WILL NOT SENER BY GRAVITY.

SEPTIC AREA

Approved Septic System Plan  
Howard County Health Department

B12003916

4-Bedroom SFD approved as shown

*R. B. Bick* 12/17/2012  
Signature Date

SEE

LEXINGTON  
Gar 7FF 554.00  
B 544.00  
552.00  
552.33  
545.00

SEPTIC AREA  
2000 GAL. SEPTIC TANK  
Inv. IN 545.50  
Inv. OUT 543.20

DIST. BOX  
BK GRD 548.50  
Inv 545.50

Septic Area Added  
Dist. Box  
Ex. Grd 550.50  
Inv. In 547.50

SEPTIC AREA  
2000 Gal. Septic Tank  
Inv. in 548.00  
Inv. out 547.10

LOT 3  
40,069 SQ. FT.

DEVONSHIRE  
PF 560.50  
Gar. 7B 550.83  
558.50  
557.50  
558.33  
557.00

PUBLIC DRAINAGE AND UTILITY EASEMENT  
ALTOWELL

NOTE:

Stormwater Management is provided under F-06-110. per Ho. Co. & Md. 378 spec. Recharge volume will be provided through grass channels next to the roadway. Protection volume provided by micro pool extended detention pond, pocket pond & infiltratable dry wells. 25 year SWM volume provided within BMP No. 1. Extreme Flood volume is not required for this site

NOTE  
The existing wells shown on this plan HO-95-0381, HO-95-0380, HO 95-0363, HO 95-0364, HO-95-0365 & HO-95-0368 have been located by Fisher Collins & Carter, Inc. professional land surveyors and are accurately shown.