

LAYOUT 3/21/2013 INSP 4 _____
INSP 2 3/22/2013 INSP 5 _____
INSP 3 _____ INSP 6 _____

ISSUE DATE: _____

PERMIT

P 544410

APPROVAL DATE: 3/26/2013

A 530342

ON-SITE SEWAGE DISPOSAL SYSTEM HOWARD COUNTY HEALTH DEPARTMENT BUREAU OF ENVIRONMENTAL HEALTH

Cumberland Development IS PERMITTED TO INSTALL ALTER

ADDRESS: _____ PHONE NUMBER: _____

SUBDIVISION: River Farms LOT NUMBER: 17

ADDRESS: 2983 Duvall Rd. PROPERTY OWNER: Curtis Cumberland

SEPTIC TANK CAPACITY (GALLONS): 2000 OUTLET BAFFLE FILTER REQUIRED

PUMP CHAMBER CAPACITY (GALLONS): N/A COMPARTMENTED TANK REQUIRED

NUMBER OF BEDROOMS: 4 Trenches 3' Wide

SQUARE FEET PER BEDROOM: _____

LINEAR FEET OF TRENCH REQUIRED: 115'

Inlet 4.5'
Bottom 7'
50' + 65' Trenches

TRENCHES:	Trench to be _____ feet wide. Inlet _____ feet below original grade. Bottom maximum depth _____ feet below original grade. Effective area begins at _____ feet below original grade. _____ feet of stone below distribution pipe.
LOCATION:	
NOTES:	

PLANS APPROVED: _____ DATE: _____

- NOTE: PERMIT VOID AFTER 2 YEARS
- NOTE: CONTRACTOR RESPONSIBLE FOR SCHEDULING A PRE-CONSTRUCTION INSPECTION FOR ALL INSTALLATIONS
- NOTE: WATERTIGHT SEPTIC TANKS REQUIRED
- NOTE: ALL PARTS OF SEPTIC SYSTEM SHALL BE 100 FEET FROM ANY WATER WELL
- NOTE: MANHOLE RISERS REQUIRED ON ALL SEPTIC TANKS AND PUMP CHAMBERS UNLESS SPECIFICALLY AUTHORIZED

NEITHER THE HOWARD COUNTY COUNCIL NOR THE HEALTH DEPARTMENT IS RESPONSIBLE FOR THE SUCCESSFUL OPERATION OF ANY SYSTEM PERMITTEE RESPONSIBLE FOR OBTAINING FINAL APPROVAL ON THIS PERMIT CALL 410-313-2640 FOR INSPECTION OF SEPTIC SYSTEM

NOT TO SCALE

TRENCH/DRAINFIELD DATA

WIDTH 3' INLET 4.5' BOTTOM 7'

NUMBER OF TRENCHES 2

TOTAL LENGTH 110'

ABSORPTION AREA 330 + Sidewalk

DISTRIBUTION BOX LEVEL Levelers

DISTRIBUTION BOX BAFFLE Yes

DISTRIBUTION BOX PORT Yes

See As-Built Drawing
On Separate Sheet

SEPTIC TANK DATA

SEPTIC TANK I LEVEL Yes

MANUFACTURER Babylon

CAPACITY 2000 GAL

SEAM LOC Top

TANK LID DEPTH 1'-2'

BAFFLES Yes

BAFFLE FILTER No

MANHOLE LOC Front

6" PORT LOC Rear

WATERTIGHT TEST No

SLOTTED Yes

DATE ON LID Dry

~~PUMP/SEPTIC TANK LEVEL N/A~~

~~MANUFACTURER~~

~~CAPACITY GAL~~

~~SEAM LOC~~

~~TANK LID DEPTH~~

~~BAFFLES~~

~~BAFFLE FILTER~~

~~MANHOLE LOC~~

~~6" PORT LOC~~

~~WATERTIGHT TEST~~

~~SLOTTED~~

~~DATE ON LID~~

ROAD NAME

PRE-CONSTRUCTION:

3/21/2013 I install a 50' and 65' trench on contour across the top of the easement. Keep the tank about 3' from the driveway (BB)

INSTALLATION: 3/22/2013 Tankset. Starting on bottom trench, No plumbing installed (BB)

3/26/2013 System finished, O.K. to backfill (BB)

FINAL INSPECTOR

B. Baker

DATE OF APPROVAL

3/26/2013

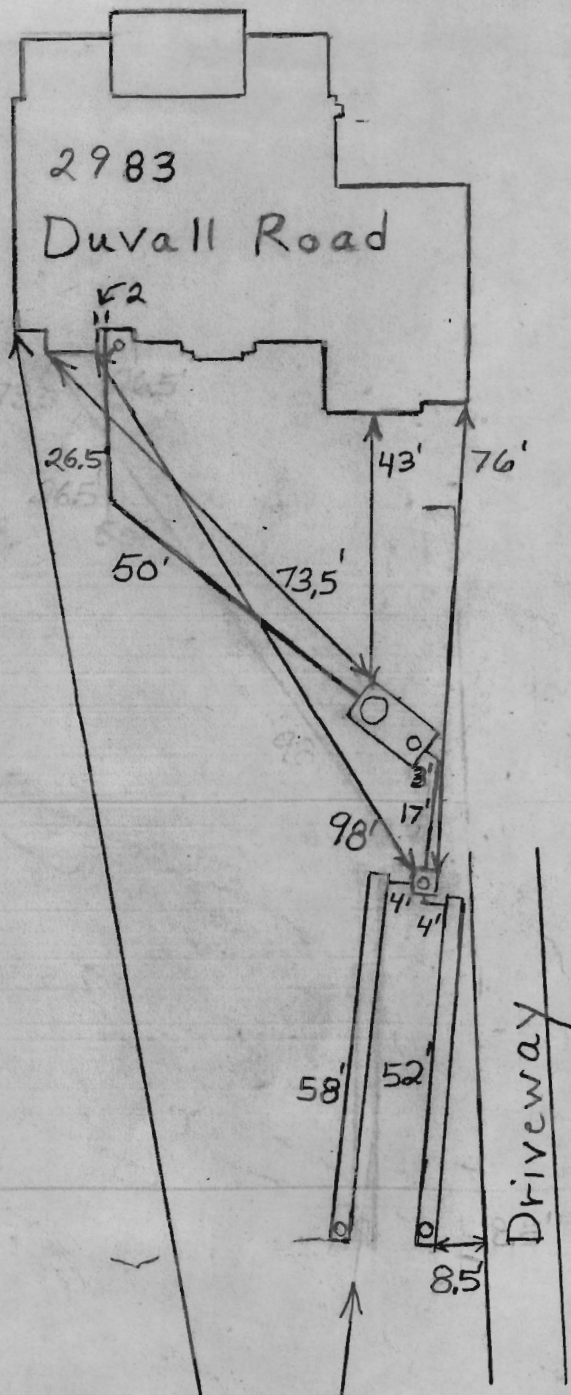

~246'

~229 to Far Corner

H0-95-1864

