

LAYOUT 5/14/09 INSP 4 6/12/09
 INSP 2 6/10/09 INSP 5 6/16/09
 INSP 3 6/11/09 INSP 6 _____

*(logged into
Permit-Track)*

ISSUE DATE: 3/11/09

PERMIT

P 530332

APPROVAL DATE: 6/19/09

A 519698

Tax ID # 04-370007

**ON-SITE SEWAGE DISPOSAL SYSTEM
 HOWARD COUNTY HEALTH DEPARTMENT
 BUREAU OF ENVIRONMENTAL HEALTH**

J C Harris Plumbing IS PERMITTED TO INSTALL ALTER

ADDRESS: 3120-A Old Nat'l Pike, Middletown, MD 21769 PHONE NUMBER: 301-371-7574

SUBDIVISION: _____ LOT NUMBER: _____

ADDRESS: 16484 Frederick Road PROPERTY OWNER: Vilayat Sayeed

SEPTIC TANK CAPACITY (GALLONS): 2000 OUTLET BAFFLE FILTER REQUIRED

PUMP CHAMBER CAPACITY (GALLONS): N/A COMPARTMENTED TANK REQUIRED

NUMBER OF BEDROOMS: 4 $(.50) 4 = \frac{600}{0.6} = 1000 \div 2 = 500 (.50) = 250 LF$

SQUARE FOOTAGE OF HOUSE: 3685 4-8

LINEAR FEET OF TRENCH REQUIRED: 240 250

TRENCHES:	Trenches to be ^{3.0} 3.0 feet wide. Inlet 4.0 feet below original grade. Bottom maximum depth 8.0 8.0 feet below grade. Effective area begins at 5.5 feet below original grade. 3.0 feet of stone below distribution pipe. <i>(140 tan) (25 den)</i>
LOCATION:	1 Set septic tank per plan. 2 Set distribution box at top-center of septic easement. 3 Install four 60 foot trenches on contour, 2 to each side of D-Box.
NOTES:	1 Stake easement corners. 2 Mark all utilities. 3 Call for layout inspection. 4 Gravel tickets must be available for Environmental Sanitarians.

PLANS APPROVED: Robert Bricker DATE: 08/28/2008

- NOTE: PERMIT VOID AFTER 2 YEARS
- NOTE: CONTRACTOR RESPONSIBLE FOR SCHEDULING A PRE-CONSTRUCTION INSPECTION FOR ALL INSTALLATIONS
- NOTE: WATERTIGHT SEPTIC TANKS REQUIRED
- NOTE: ALL PARTS OF SEPTIC SYSTEM SHALL BE 100 FEET FROM ANY WATER WELL
- NOTE: MANHOLE RISERS REQUIRED ON ALL SEPTIC TANKS AND PUMP CHAMBERS

NEITHER THE HOWARD COUNTY COUNCIL OR THE HEALTH DEPARTMENT IS RESPONSIBLE FOR THE SUCCESSFUL OPERATION OF ANY SYSTEM PERMITTEE RESPONSIBLE FOR OBTAINING FINAL APPROVAL ON THIS PERMIT CALL 410-313-1771 FOR INSPECTION OF SEPTIC SYSTEM

NOT TO SCALE

TRENCH/DRAINFIELD DATA

WIDTH	INLET	BOTTOM
2'	3.5'-4'	8'
NUMBER OF TRENCHES 4		
TOTAL LENGTH 250'		
ABSORPTION AREA 510±sqw		
DISTRIBUTION BOX LEVEL Yes		
DISTRIBUTION BOX BAFFLE Yes		
DISTRIBUTION BOX PORT No		

~~See~~ Separate sheet
See As-Built

SEPTIC TANK DATA

SEPTIC TANK 1 LEVEL Yes

MANUFACTURER Babylon

CAPACITY 2000 GAL

SEAM LOC Top

TANK LID DEPTH 2.5'

BAFFLES Yes

BAFFLE FILTER None

MANHOLE LOC Front+Rear

6" PORT LOC None

WATERTIGHT TEST No

SLOTTED Yes

~~PUMP/SEPTIC TANK LEVEL N/A~~

~~MANUFACTURER~~

~~CAPACITY GAL~~

~~SEAM LOC~~

~~TANK LID DEPTH~~

~~BAFFLES~~

~~BAFFLE FILTER~~

~~MANHOLE LOC~~

~~6" PORT LOC~~

~~WATERTIGHT TEST~~

~~SLOTTED~~

PRE-CONSTRUCTION
5/14/09 Spec's changed to gain usable soil profile. Contractor to set tank per plan. Shot chambers

to see if full could be made. Told contractor to make inlet @ 3.5' if possible. 4' to 8' will suffice. Call for follow-up

Inspection (KW) 4 x 62' trenches to be installed.
INSTALLATION 6/10/09 S.T. set. 4" SHC installed as instructed.

Contractor to seal risers to tank w/ either tar or cement. Call for trench inspection (KW) 6/11/09 Distribution box set. One trench done. (BB)

6/12/09 Contractor had most of the trenches completed. Break-hoe broke down, could not finish. (KW)

6/16/09 No one working. Trenches complete. (KW)

6/19/09 Could not make it out there. Called contractor. D box locked. OK to back fill (KW)

FINAL INSPECTOR (KW) K. Welf DATE OF APPROVAL 6/19/09

NOT TO SCALE

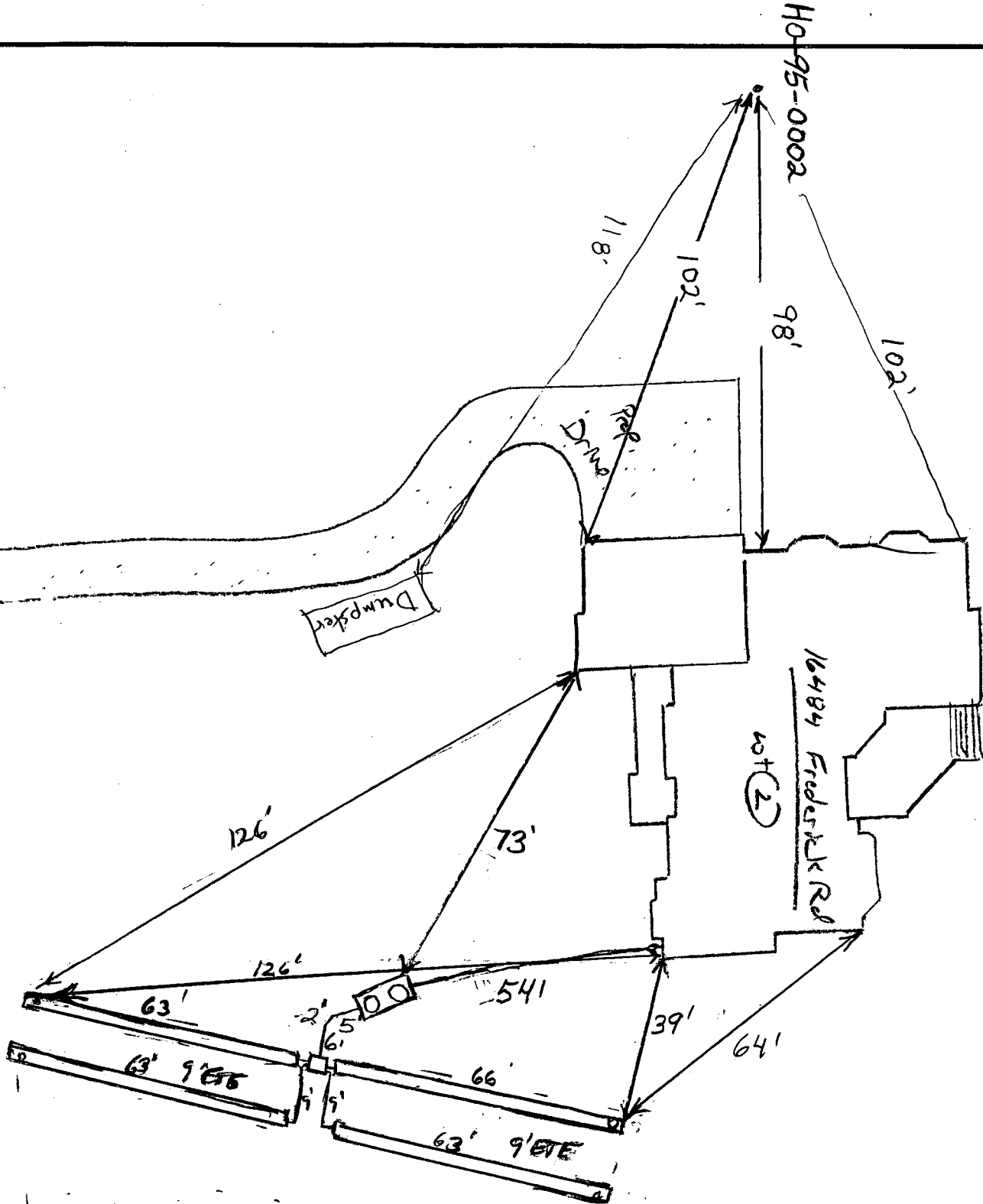

Ab. 144



HOWARD COUNTY HEALTH DEPARTMENT

P5 30332

DATE
3/10/09

Received From A.C. Harris Plumbing & Heating, Inc. PHONE # 301.371.7574

CASH
 CHECK
NO.
18707

For Septic permit - Young Property
110484 Madelon Rd

*DKP Utility
Harris*
Log
Pay Trace

three hundred ninety six dollars Dollars

\$ 396.00

Received By [Signature]