

PUB. SEWER STATUS VERIFIED BY _____

ISSUE DATE: 09/10/07

P 527339

APPROVAL DATE: 9/26/07

PERMIT
Logged Into Permit Manager
Tax ID # 04-319052

A REPAIR

**ON-SITE SEWAGE DISPOSAL SYSTEM
HOWARD COUNTY HEALTH DEPARTMENT
BUREAU OF ENVIRONMENTAL HEALTH**

Fogles Septic Clean, Inc IS PERMITTED TO INSTALL ALTER

ADDRESS: 580 Obrecht Road PHONE NUMBER: 410-795-5670

SUBDIVISION: Lower Trail LOT NUMBER: 2

ADDRESS: 16480 Frederick Road PROPERTY OWNER: Mark McNeill

SEPTIC TANK CAPACITY (GALLONS): _____
PUMP CHAMBER CAPACITY (GALLONS): _____
NUMBER OF BEDROOMS: 4
SQUARE FEET PER BEDROOM: _____
LINEAR FEET OF TRENCH REQUIRED: 214'

*Trenches 2' wide
Inlet 5'
Bottom 9'
Six feet edge to edge
3-7 1/2 Trenches*

TRENCHES:	Trench to be _____ feet wide. Inlet _____ feet below original grade. Bottom maximum depth _____ feet below original grade. Effective area begins at _____ feet below original grade. _____ feet of stone below distribution pipe.
LOCATION:	<i>Install 3 trenches on contour that end near the driveway</i>
PURPOSE:	Existing septic system has failed. Call for inspection when ground is opened so sanitarian can recommend repair.

PLANS APPROVED: B. Baker DATE: 9/24/07

- NOTE: PERMIT VOID AFTER 2 YEARS
- NOTE: CONTRACTOR RESPONSIBLE FOR SCHEDULING A PRE-CONSTRUCTION INSPECTION FOR ALL INSTALLATIONS
- NOTE: WATERTIGHT SEPTIC TANKS REQUIRED
- NOTE: ALL PARTS OF SEPTIC SYSTEM SHALL BE 100 FEET FROM ANY WATER WELL
- NOTE: MANHOLE RISERS REQUIRED ON ALL SEPTIC TANKS AND PUMP CHAMBERS

NEITHER THE HOWARD COUNTY COUNCIL OR THE HEALTH DEPARTMENT IS RESPONSIBLE FOR THE SUCCESSFUL OPERATION OF ANY SYSTEM PERMITTEE RESPONSIBLE FOR OBTAINING FINAL APPROVAL ON THIS PERMIT CALL 410-313-2640 FOR INSPECTION OF SEPTIC SYSTEM

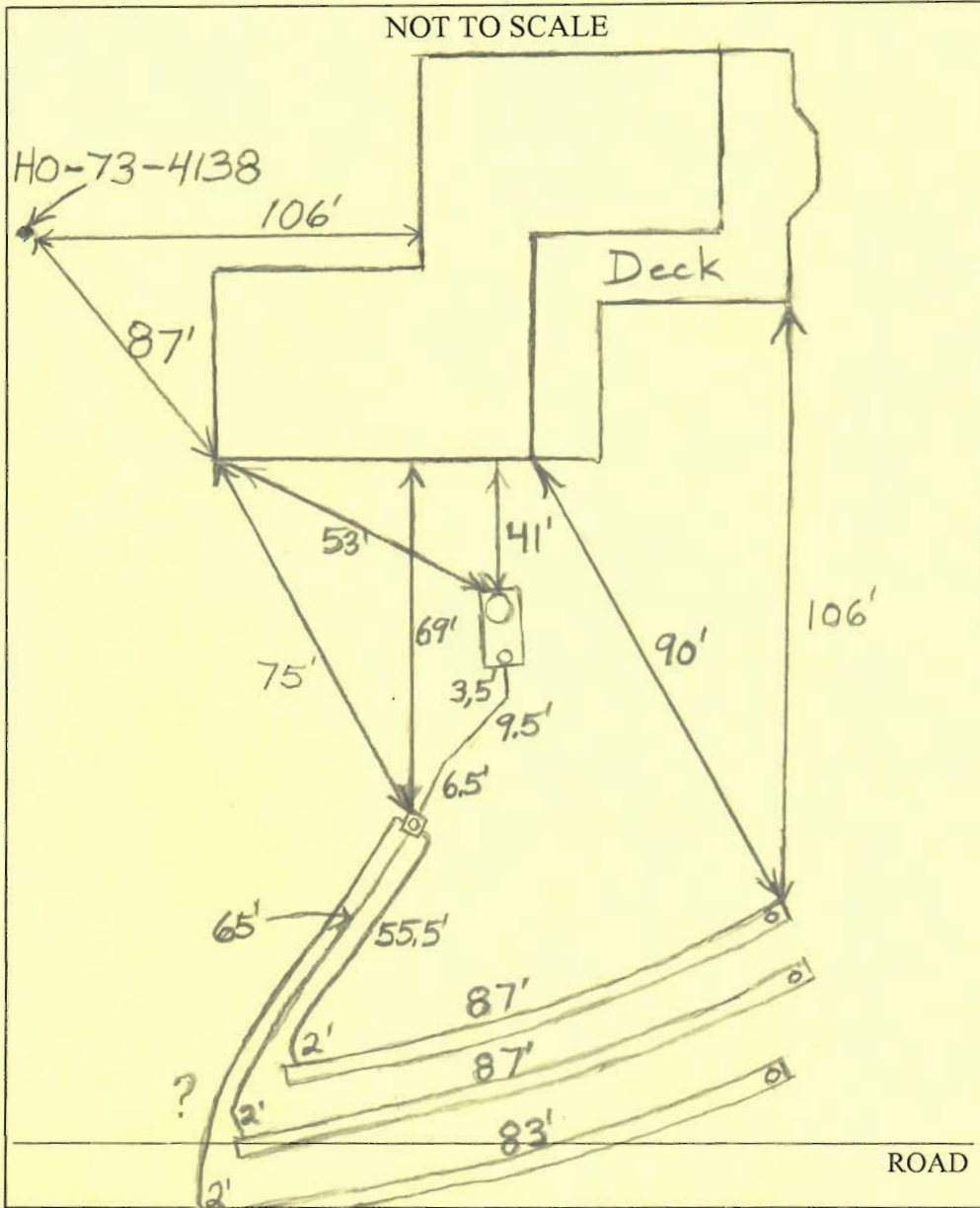

TRENCH/DRAINFIELD DATA		
WIDTH	INLET	BOTTOM
2'	4'-5'	9'
NUMBER OF TRENCHES		3
TOTAL LENGTH		257'
ABSORPTION AREA		514
DISTRIBUTION BOX LEVEL		Levelers
DISTRIBUTION BOX BAFFLE		Yes
DISTRIBUTION BOX PORT		Yes

SEPTIC TANK DATA	
SEPTIC TANK 1 LEVEL	Yes
CAPACITY	1500 GAL
SEAM LOC	Midseam
TANK LID DEPTH	2'-2.5'
BAFFLES	Yes
BAFFLE FILTER	No
MANHOLE LOC	Front
6" PORT LOC	Rear
WATERTIGHT TEST	No
SEPTIC TANK 2 LEVEL	N/A
CAPACITY	GAL
SEAM LOC	
TANK LID DEPTH	
BAFFLES	
BAFFLE FILTER	
MANHOLE LOC	
6" PORT LOC	
WATERTIGHT TEST	

PRE-CONSTRUCTION 9/24/07 I install 3 trenches on contour directly below the existing trench. Trenches should end near the driveway. (BB)

INSTALLATION 9/26/07 Trenches moved farther away from driveway because of electric line. System finished. O.K. to backfill. (BB)

FINAL INSPECTOR B. Baber DATE OF APPROVAL 9/26/07