

5/3/96  
5/6/96

# PERMIT

## SEWAGE DISPOSAL SYSTEM

### DEPARTMENT OF HEALTH AND MENTAL HYGIENE

P 56598

A REPAIR

DISTRICT \_\_\_\_\_

DATE 5-3-96

HOWARD COUNTY HEALTH DEPARTMENT  
BUREAU OF ENVIRONMENTAL HEALTH

~~901-9933~~ 313-2640

DATE SYSTEM APPROVED 5-4-96

INSPECTOR HU

04-1318803

INDEXED

Herman Sirk IS PERMITTED TO INSTALL \_\_\_\_\_ ALTER X

ADDRESS 2555 Jennings Chapel Road, Woodbine, MD 21797 PHONE 489-4724

SUBDIVISION \_\_\_\_\_ LOT \_\_\_\_\_ ROAD 16400 Fredrick Road

PROPERTY OWNER \_\_\_\_\_ Martin Hamilton

ADDRESS \_\_\_\_\_ 16400 Frederick Road  
Woodbine, MD

SEPTIC TANK CAPACITY \_\_\_\_\_ GALLONS

NUMBER OF BEDROOMS 3

180 SQUARE FEET PER BEDROOM

LINEAR FEET OF TRENCH REQUIRED 108

REPAIR - PURPOSE - SEPTIC SYSTEM HAS FAILED.

Call for inspection when ground is opened so sanitarian can recommend repairs.

5/3/96

inlet 4.0, bottom at 9.0 Run trench on contour toward  
the right property line when facing lot from Rt. 144 du

5/3/96

PLANS APPROVED BY \_\_\_\_\_ DATE \_\_\_\_\_

COVER NO WORK UNTIL INSPECTED AND APPROVED

NEITHER THE HOWARD COUNTY COUNCIL NOR THE HEALTH DEPARTMENT IS RESPONSIBLE FOR THE SUCCESSFUL OPERATION OF ANY SYSTEM

NOTE: CLEANOUT REQUIRED EVERY 70 FEET OF SEWER LINE AND/OR AT 90° SWEEPS IN LINES FROM HOUSE TO DRAIN FIELDS, 90° ELBOWS NOT ACCEPTABLE.

NOTE: ALL PARTS OF SEPTIC SYSTEMS (I.E. TANK, DISTRIBUTION BOX TRENCHES) TO BE 100 FEET FROM WELL (UNLESS OTHERWISE SPECIFICALLY AUTHORIZED)

NOTE: IF DEEP TRENCH(ES) ARE USED CALL FOR INSPECTION BEFORE AND AFTER PLACING GRAVEL IN TRENCH(ES)

NOTE: NO DRY WELL SHALL EXCEED 15 FOOT IN DIAMETER NO ABSORPTION TRENCH TO EXCEED 100 FEET IN LENGTH

NOTE: ALL PIPE FROM HOUSE TO SEPTIC TANK MUST BE CAST IRON OR SCHEDULE 35/40 PVC OR ABS

PERMIT VOID AFTER TWO YEARS

NOTE: INSTALL STAND PIPE ON SEPTIC TANK AND DRY WELL STAND PIPES MUST BE 6 INCHES IN DIAMETER CAST IRON, CONCRETE OR TERRA COTTA OR PVA OR ABS ACCEPTED. IF TOP OF SEPTIC TANK IS DEEPER THAN 3 FEET. MANHOLE TO GRADE REQUIRED.

NOTE: DISTRIBUTION BOXES MUST HAVE BAFFLES

**\*INSTALLER IS RESPONSIBLE FOR OBTAINING FINAL APPROVAL ON THIS PERMIT**

**\*CALL 461-9933 FOR INSPECTION OF SEPTIC SYSTEM.**

P 56598

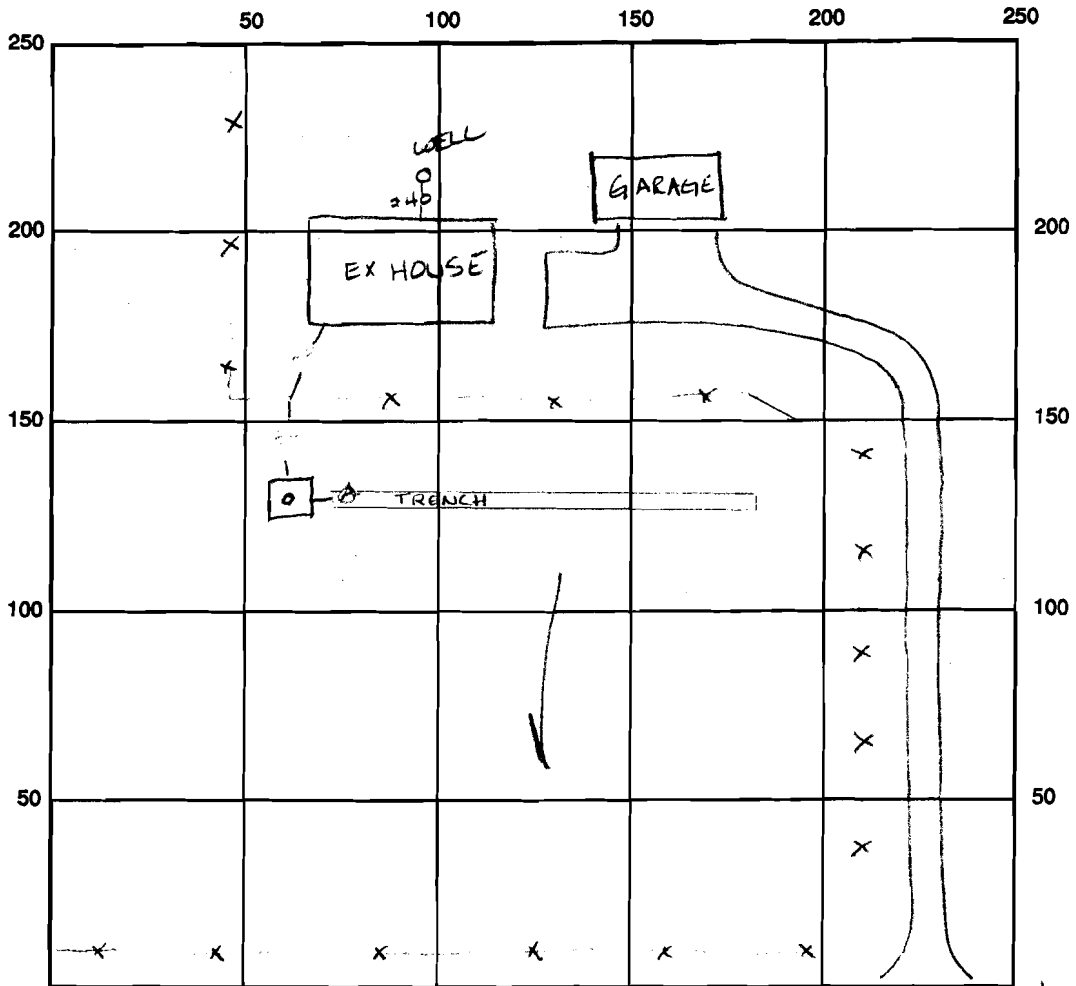

INDICATE NORTH - NAME ADJOINING ROADWAY AS BASE LINE Rt. 144

SEPTIC TANK LEVEL \_\_\_\_\_ CLEANOUTS \_\_\_\_\_

DISTRIBUTION BOX LEVEL \_\_\_\_\_

DRAIN FIELD/TITLE DEPTH 9.0 FT. TRENCH WIDTH 20 FT. INLET DEPTH 4.0 FT.

EFFECTIVE GRAVEL DEPTH 5.0 FT. TOTAL LENGTH 110' FT.

NUMBER OF TRENCHES 1 ONE SIDEWALL/BOTTOM AREA 550 SQ. FT.  $\frac{110}{2} = 55$

DRYWALL INSIDE DIAMETER — FT. EFFECTIVE DEPTH BELOW INLET — FT.

ABSORBENT AREA — SQ. FT.

REMARKS: 5/3/96 Test note dug - see above Am 5/4/96 OK to cover  
all work final Am

\* No tag on well Am

DATE SYSTEM APPROVED 5/4/96 INSPECTOR Amy McMullen