

Prep

APPLICATION

A 29064

SEWAGE DISPOSAL TESTING

P _____

STATE OF MARYLAND - DEPARTMENT OF HEALTH AND MENTAL HYGIENE

HOWARD COUNTY HEALTH DEPARTMENT
ENVIRONMENTAL HEALTH SERVICES

DISTRICT 5

P. O. BOX 476, ELLICOTT CITY, MARYLAND 21043
TELEPHONE: 465-5000, EXT. 356

DATE 10/16/78

SEE ATTACHED SPEC SHEET

BLDG. PERMIT SIGNED
AND RETURNED 7/23/80
Serial No. 43773

TO: THE COUNTY HEALTH OFFICER
ELLICOTT CITY, MARYLAND

I, HEREBY, APPLY FOR THE NECESSARY TEST IN ORDER TO CONSTRUCT (OR RECONSTRUCT) A SEWAGE DISPOSAL SYSTEM.

PROPERTY OWNER Willson Development.
Tridelphia Mill Farms Partnership
@ Richard Hallowell
ADDRESS Sandy Spring, Md. 20860 PHONE 286-2988

PROPERTY LOCATION: _____
SUBDIVISION Tridelphia Mill Farms LOT NO. Final #17
2 - Sheet 2

ROAD AND DESCRIPTION 14014 Tridelphia Mill Road
On N & S sides of Tridelphia Mill Rd 1,500' E of
Greenbridge Rd, Datton, Md. - 5th Dist.

SIZE OF LOT 3.0 acres TYPE BLDG. 3 bedrm, single family dwg.
NUMBER OF BEDROOMS _____

IF NOT SINGLE RESIDENCE DESCRIBE _____

THE SYSTEM INSTALLED UNDER THIS APPLICATION IS ACCEPTABLE ONLY UNTIL PUBLIC FACILITIES BECOME AVAILABLE.

SIGNATURE OF APPLICANT Richard Hallowell

APPROVED BY C. B. Stecker FOR Dry Well DATE 12/14/79
(KIND OF SYSTEM)

REJECTED BY _____ FOR Dry Well + trench DATE _____
(KIND OF SYSTEM)

HOLD PENDING FURTHER TESTS _____ DATE _____

REASONS FOR REJECTION OR HOLDING _____

THIS IS NOT A PERMIT

2 sheet 2
Final #17

cut house

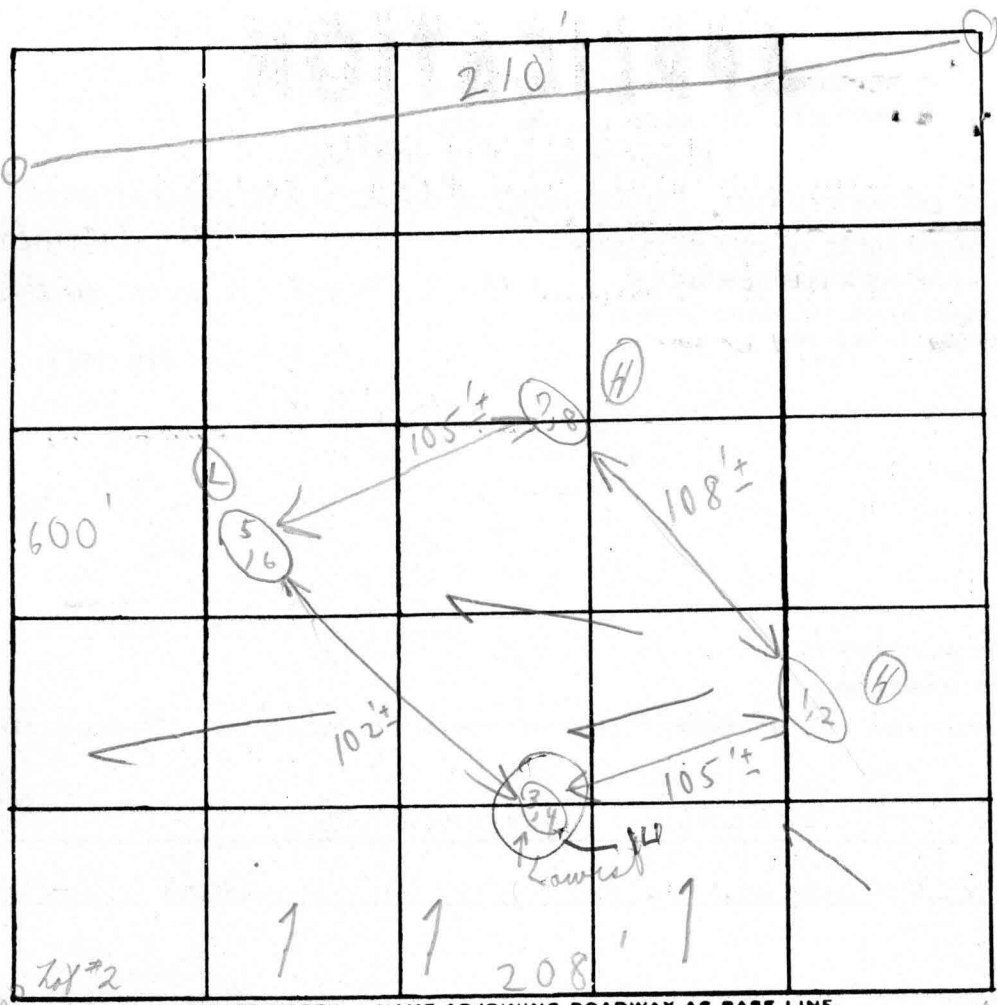

INDICATE NORTH. - NAME ADJOINING ROADWAY AS BASE LINE

Philadelphia Mill Rd

0 1st 1 = Dayton

Sand
Below clay
sand loam
+ some sandstone

DATE	TEST NO.	DEPTH	PRE-WET		TEST - 1" DROP		TIME
			START	STOP	START	STOP	
11/30/78	1	4 ft	2:55	3:04	3:04	3:30	26m
	2	12 1/2'	2:55	2:58	2:58	3:08	10m
	3 A	4'	2:50	None	(3:07)	Pulled key	
	4	12'	2:52	2:54	2:54	2:59	5m
	5	4 1/2'	3:10	3:12	3:12	3:16	4m
	6	12 1/2'	3:10	3:13	3:13	3:21	8m
	7	3'	3:17	3:20	3:26	3:32	6m
	8	12'	3:17	3:20	3:20	3:27	7m
12/1/78	3 B	61'	9:50	9:52	9:52	9:59	5m
CBD						8	71

Unlet 4

9 min avg.

Need note test

REMARKS (Tests in high grass) Use weather (142)(H) 4/07 (2,8)(H)

TYPE OF SOIL _____

TESTED BY C B D ALSO PRESENT: E. M. Schenck & son