

LAYOUT 8/23/02 11am INSP 4 11/12/02 3PM  
 INSP 2 8/24/02 1pm INSP 5 11/15/02 2-3pm  
 INSP 3 8/28/02 10-11 INSP 6 11/18/02 12:30

ISSUE DATE: 8/20/2002  
 APPROVAL DATE: 11/18/02

**PERMIT  
INDEXED**

P 517428  
 A 515032

Tax ID # 04-318013

**ON-SITE SEWAGE DISPOSAL SYSTEM  
 HOWARD COUNTY HEALTH DEPARTMENT  
 BUREAU OF ENVIRONMENTAL HEALTH**

C & C Utility Service, Inc IS PERMITTED TO INSTALL  ALTER

ADDRESS: 7398 Gaither Road, Sykesville PHONE NUMBER: 410-549-4987

SUBDIVISION: Poole Property LOT NUMBER: \_\_\_\_\_

ADDRESS: 15005 Scottswood Court PROPERTY OWNER: ~~Joseph Cutroneo~~ Joseph Cutroneo  
~~Joseph Cutroneo~~ Katie Miles, c/o N Dorsey

SEPTIC TANK CAPACITY (GALLONS): 1250 OUTLET BAFFLE FILTER REQUIRED

PUMP CHAMBER CAPACITY (GALLONS): 1250 COMPARTMENTED TANK REQUIRED

NUMBER OF BEDROOMS: 4

SQUARE FEET PER BEDROOM: 180

LINEAR FEET OF TRENCH REQUIRED: 240

TRENCHES:	Trench to be 3.0 feet wide. Inlet 2.5 feet below original grade. Bottom maximum depth 4.5 feet below original grade. Effective area begins at 2.5 feet below original grade. 2.0 feet of stone below distribution pipe.
LOCATION:	Run trenches on contour placing them as shown per plan
NOTES:	Basement service by gravity is proposed.

PLANS APPROVED: SRK ON SRU 1/8/02 DATE: 1/8/02

- NOTE: PERMIT VOID AFTER 2 YEARS
- NOTE: CONTRACTOR RESPONSIBLE FOR SCHEDULING A PRE-CONSTRUCTION INSPECTION FOR ALL INSTALLATIONS
- NOTE: WATERTIGHT SEPTIC TANKS REQUIRED
- NOTE: ALL PARTS OF SEPTIC SYSTEM SHALL BE 100 FEET FROM ANY WATER WELL
- NOTE: MANHOLE RISERS REQUIRED ON ALL SEPTIC TANKS AND PUMP CHAMBERS UNLESS SPECIFICALLY AUTHORIZED

**NEITHER THE HOWARD COUNTY COUNCIL NOR THE HEALTH DEPARTMENT IS RESPONSIBLE FOR THE SUCCESSFUL OPERATION OF ANY SYSTEM PERMITTEE RESPONSIBLE FOR OBTAINING FINAL APPROVAL ON THIS PERMIT ALL 410-313-2640 FOR INSPECTION OF SEPTIC SYSTEM**

**BUILDING PERMIT SIGNED AND RETURNED**

9/14/2002 B00138251 DECK + PORCH  
 9/30/02 B00138576 - UG PROPRIC TANK  
 12/17/04 B00151276 1 Bdrm Suite added. Kitchen - no garbage disposal

A515032

50/90/100

NOT TO SCALE

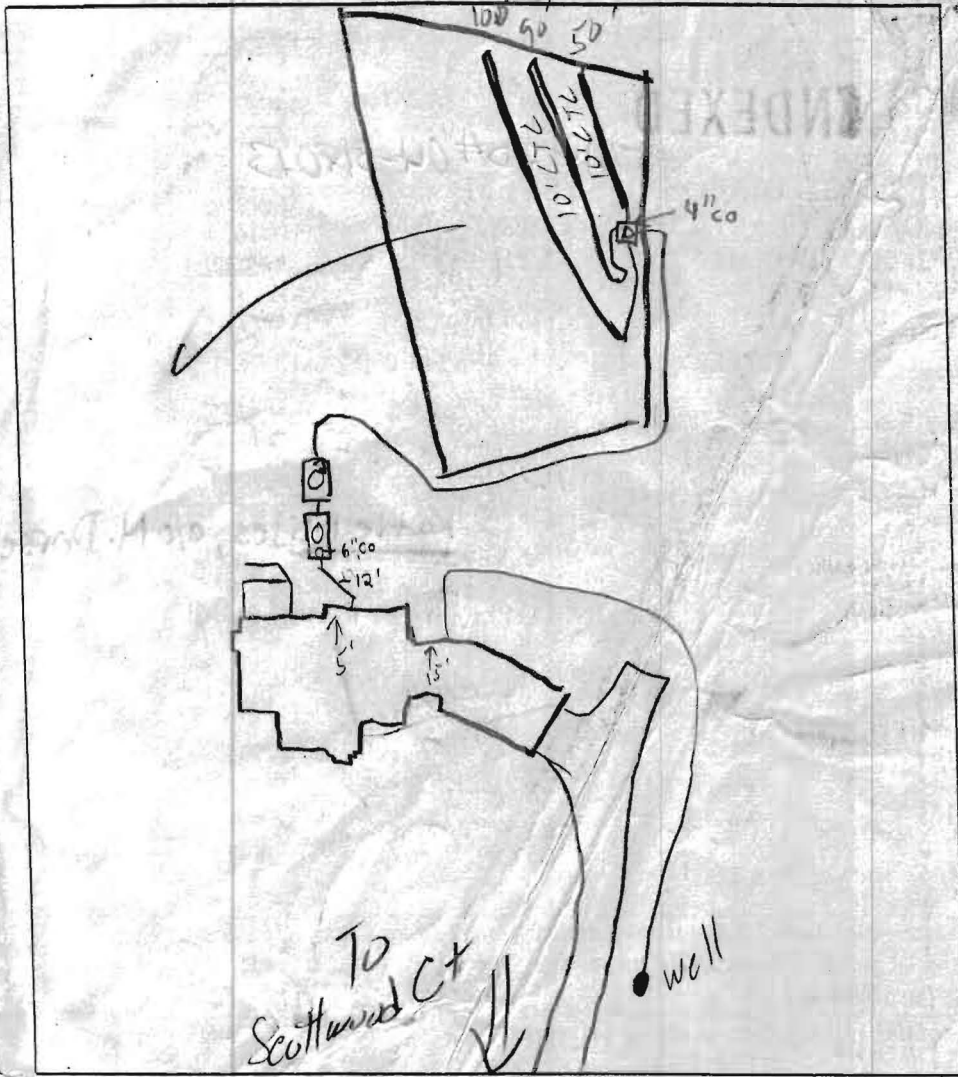

**TRENCH DATA**

TRENCH WIDTH 3'  
 TRENCH INLET DEPTH 2.5'  
 TRENCH BOTTOM DEPTH 4.5'  
 DEPTH OF STONE 2'  
 NUMBER OF TRENCHES 3  
 TOTAL TRENCH LENGTH 240'  
 ABSORBENT AREA 720 ft<sup>2</sup>  
 DISTRIBUTION BOX LEVEL   
 BAFFLE IN DISTRIBUTION BOX

**SEPTIC TANK DATA**

SEPTIC TANK 1250 TB GALLONS  
 MANHOLE RISER Center  
 6 INCH INSPECTION PORT Front

**PUMP CHAMBER DATA**

PUMP CHAMBER GALLONS 1250  
 MANHOLE RISER Center  
 ALARM FUNCTIONAL  
 PUMP PERFORMANCE TEST

PRE-CONSTRUCTION INSPECTION: \_\_\_\_\_

INSPECTION COMMENTS: 8/23/02 Lot staked, contours appear accurate.  
Log of per BP, tanks will be moved for less cover. Hence changed (50)  
8/27/02 OK to cover all work. Pump & Alarm test needed (50)  
11/12/02 Pump functional, Alarm not working. Grade around tanks  
needs to be fixed. Surface water going into P.T (50)  
11/15/02 - ALARM FUNCTIONAL, PUMP NOT WORKING - (50) 12/18/02 Pump OK (50)

BUILDING PERMITTED AND RETURNED

INSPECTOR Steven R. Krieg

DATE SYSTEM APPROVED 11/18/02

