

10/9/89 pm
11/13/89 12:30

PERMIT

SEWAGE DISPOSAL SYSTEM

MARYLAND STATE DEPARTMENT OF HEALTH

P 45131
A 43977

DISTRICT 3rd

HOWARD COUNTY
BUREAU OF ENVIRONMENTAL HEALTH
461-9933

DATE 10/31/89

DATE SYSTEM APPROVED 11/13/89

INSPECTOR M. Rifkin

INDEXED

Donald Parlette IS PERMITTED TO INSTALL ALTER
ADDRESS 6575 Route 32, Clarksville, Maryland 21029 PHONE 531-2140
SUBDIVISION Hudson Property ROAD 12791 Frederick Road LOT 3
PROPERTY OWNER James W. Hudson, Jr. - DENISE ANN CLARK
ADDRESS _____

IF GARBAGE GRINDER IS USED INCREASE SEPTIC TANK CAPACITY BY 50% AND ABSORPTION AREA BY 22%. 5/4/89 99

GARBAGE GRINDER? YES _____ NO

SEPTIC TANK CAPACITY 1000 GALLONS NUMBER OF BEDROOMS 3

TRENCHES - 210 sq. ft. per bedroom. Trench to be 2 feet wide. Inlet 5 feet below original grade. Bottom maximum depth 8 feet below original grade. Effective area begins at 5 feet below original grade. 3 feet of stone below distribution pipe.

LOCATION - Place distribution box 50 feet from the West (215') lot line and 60 feet from the South (203') lot line. Run trenches along contour toward West lot line and toward the East lot line.

NOTE - No trench to exceed 100 feet in length. Provide 6" - 8" diameter cleanout and cap to grade or above on septic tank. ok/cw

PLANS APPROVED BY C. Williams DATE 6/27/89

COVER NO WORK UNTIL INSPECTED AND APPROVED

NEITHER THE HOWARD COUNTY COUNCIL NOR THE HEALTH DEPARTMENT IS RESPONSIBLE FOR THE SUCCESSFUL OPERATION OF ANY SYSTEM.

NOTE: CLEANOUT REQUIRED EVERY 70 FEET OF SEWER LINE AND/OR AT 90° SWEEPS IN LINES FROM HOUSE TO DRAIN FIELDS

NOTE: ALL PARTS OF SEPTIC SYSTEMS (I.E. TANK, DISTRIBUTION BOX, TRENCHES) TO BE 100 FEET FROM WELL (UNLESS OTHERWISE SPECIFICALLY AUTHORIZED)

NOTE: IF DEEP TRENCHES ARE USED CALL FOR INSPECTION BEFORE AND AFTER PLACING GRAVEL IN TRENCHES)

NOTE: NO DRY WELL SHALL EXCEED 15 FOOT IN DIAMETER NO ABSORPTION TRENCH TO EXCEED 100 FEET IN LENGTH.

NOTE: ALL PIPE FROM HOUSE TO SEPTIC TANK MUST BE CAST IRON OR SCHEDULE 40 PVC OR ABS

PERMIT VOID AFTER TWO YEARS

NOTE: INSTALL STAND PIPE ON SEPTIC TANK AND DRY WELL. STAND PIPES MUST BE 6 INCHES IN DIAMETER. CAST IRON, CONCRETE OR TERRA COTTA OR PVC OR ABS ACCEPTED. IF TOP OF SEPTIC TANK IS DEEPER THAN 3 FEET, MANHOLE TO GRADE REQUIRED

NOTE: DISTRIBUTION BOXES MUST HAVE BAFFLES

***INSTALLER IS RESPONSIBLE FOR OBTAINING FINAL APROVAL ON THIS PERMIT**

*CALL 461-9933 FOR INSPECTION OF SEPTIC SYSTEMS.

A
43977

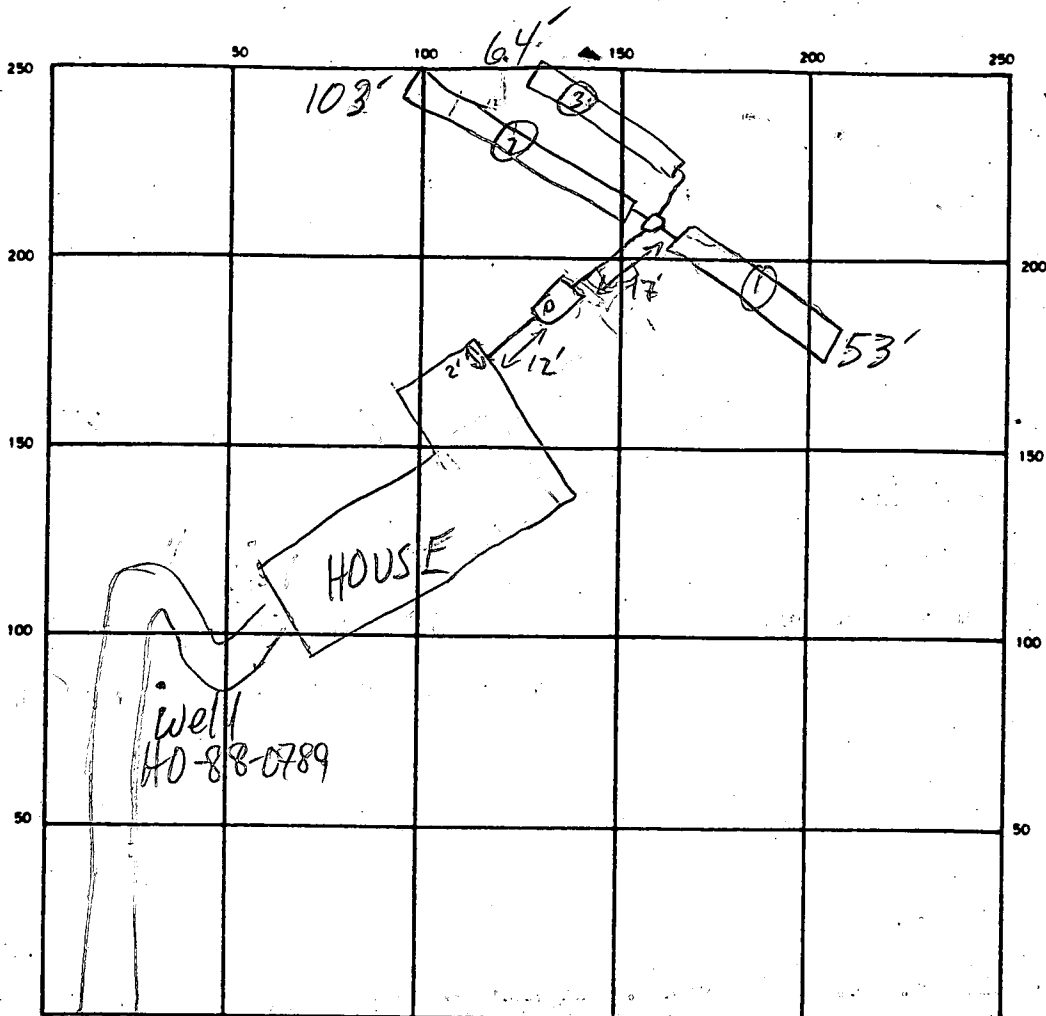

INDICATE NORTH - NAME ADJOINING ROADWAY AS BASE LINE

RT. 144

SEPTIC TANK LEVEL 1500 GAL OK CLEANOUTS OK

DISTRIBUTION BOX LEVEL OK Baffle in

DRAIN FIELD/TILE FIELD. DEPTH 8 FT. TRENCH WIDTH 2 FT. INLET DEPTH 4 FT.

EFFECTIVE GRAVEL DEPTH 4 FT. TOTAL LENGTH ① 53 ② 103 ③ 64 } 220

NUMBER OF TRENCHES 3 ONE SIDEWALL/BOTTOM AREA 840 SQ. FT.

DRYWELL INSIDE DIAMETER — FT. EFFECTIVE DEPTH BELOW INLET — FT.

ABSORBENT AREA — SQ. FT.

REMARKS 11/9/89 EQUIP. FAILURE, WORK STOPPED EARLY; TRENCH ①
DUG TO 37'-8" DEEP & 4' STONE IN TRENCHES
CONTRACTOR INTENDS TO STONE TRENCHES 11/10;
OK TO DO SO W/O INSP, WILL CALL FOR FINAL 11/13 MR
11/13/89 CONTRACTOR AWARE THAT TRENCHES SHOULD HAVE
BEEN OF 'NEARLY' EQUAL LENGTH; OK TO COVER ALL MR

DATE SYSTEM APPROVED 11/13/89 INSPECTOR M. Ripkin