

**DRILLER: REMOVE COPY AND RETAIN FOR YOUR RECORDS. RETURN COUNTY COPY TO COUNTY ENVIRONMENTAL AGENCY. SUBMIT COPY TO OWNER. RETURN ALL OTHER PARTS TO DEPARTMENT OF ENVIRONMENT, 2500 BROENING HIGHWAY, BALTIMORE, MARYLAND 21224.**

<b>C1</b> 3486	SEQUENCE NO. (MDE USE ONLY)	<b>STATE OF MARYLAND WELL COMPLETION REPORT</b> FILL IN THIS FORM COMPLETELY PLEASE TYPE	THIS REPORT MUST BE SUBMITTED WITHIN 45 DAYS AFTER WELL IS COMPLETED.
<small>1 2 3 4 5 6</small> (THIS NUMBER IS TO BE PUNCHED IN COLS. 3-6 ON ALL CARDS)			COUNTY NUMBER <u>439119</u> <u>A44410</u>

ST/CO USE ONLY: DATE RECEIVED MM DD YY 8 13	DATE WELL COMPLETED MM DD YY 6/1/04 15 20	DEPTH OF WELL 22 400 26 (TO NEAREST FOOT)	PERMIT NO. FROM "PERMIT TO DRILL WELL" HO-94-3942 28 29 30 31 32 33 34 35 36 37
--	---	---	--

OWNER: JULIUS (last name) JIM (first name)  
 STREET OR RFD: RTE 144 TOWN: WEST FRIENDSHIP  
 SUBDIVISION: HUDSON FARM SECTION: \_\_\_\_\_ LOT: 2

**WELL LOG**  
Not required for driven wells

STATE THE KIND OF FORMATIONS PENETRATED, THEIR COLOR, DEPTH, THICKNESS AND IF WATER BEARING

DESCRIPTION (Use additional sheets if needed)	FEET		check if water bearing
	FROM	TO	
Top Soil	0	2	
Brown Shale	2	20	
Brown Mica	20	38	
Gray Mica	38	60	
Brown Mica	68	70	
Gray Mica	70	99	
Brown Mica	99	100	
Gray Mica	100	110	
Brown Mica	110	111	
Gray Mica	111	305	
OPENING	305	306	✓
Gray Mica	306	400	

**GROUTING RECORD**

WELL HAS BEEN GROUTED (Circle Appropriate Box)  Y  N

TYPE OF GROUTING MATERIAL (Circle one)  
 CEMENT  CM BENTONITE CLAY  BC

NO. OF BAGS 15 NO. OF POUNDS 1500  
 GALLONS OF WATER 90

DEPTH OF GROUT SEAL (to nearest foot)  
 from 0 TOP to 43 BOTTOM 58 ft.  
 (enter 0 if from surface)

**CASING RECORD**

caseing types, insert appropriate code below

<input checked="" type="checkbox"/> ST STEEL	<input type="checkbox"/> CO CONCRETE
<input type="checkbox"/> PL PLASTIC	<input type="checkbox"/> OT OTHER

MAIN CASING TYPE ST Nominal diameter top (main) casing (nearest inch) 6 Total depth of main casing (nearest foot) 45

**OTHER CASING (if used)**

EACH CASING	diameter inch		depth (feet) from to	
	1	2	1	2

**SCREEN RECORD**

screen type or open hole (insert appropriate code below)

<input checked="" type="checkbox"/> ST STEEL	<input type="checkbox"/> BR BRASS	<input type="checkbox"/> HO OPEN HOLE
<input type="checkbox"/> PL PLASTIC	<input type="checkbox"/> PL BRONZE	<input type="checkbox"/> OT OTHER

NUMBER OF UNSUCCESSFUL WELLS: 0

WELL HYDROFRACTURED  Y  N

CIRCLE APPROPRIATE LETTER:

**A** A WELL WAS ABANDONED AND SEALED WHEN THIS WELL WAS COMPLETED  
**E** ELECTRIC LOG OBTAINED  
**P** TEST WELL CONVERTED TO PRODUCTION WELL

I HEREBY CERTIFY THAT THIS WELL HAS BEEN CONSTRUCTED IN ACCORDANCE WITH COMAR 26.04.04 "WELL CONSTRUCTION" AND IN CONFORMANCE WITH ALL CONDITIONS STATED IN THE ABOVE CAPTIONED PERMIT, AND THAT THE INFORMATION PRESENTED HEREIN IS ACCURATE AND COMPLETE TO THE BEST OF MY KNOWLEDGE.

DRILLERS LIC. NO. 1 M WD 040

Henry F. Robertson  
 DRILLERS SIGNATURE (MUST MATCH SIGNATURE ON APPLICATION)

LIC. NO. 1 JS D 038

Bruce Thompson  
 SITE SUPERVISOR (sign. of drifter or journeyman responsible for sitework if different from permittee)

**C2** DEPTH (nearest ft.)

1	2	3	4	5	6	7	8	9	10	11	12	13	14	15	16	17	18	19	20	21	
22	23	24	25	26	27	28	29	30	31	32	33	34	35	36	37	38	39	40	41	42	43
44	45	46	47	48	49	50	51	52	53	54	55	56	57	58	59	60	61	62	63	64	65
66	67	68	69	70	71	72	73	74	75	76	77	78	79	80	81	82	83	84	85	86	87
88	89	90	91	92	93	94	95	96	97	98	99	100	101	102	103	104	105	106	107	108	109
110	111	112	113	114	115	116	117	118	119	120	121	122	123	124	125	126	127	128	129	130	131

DIAMETER OF SCREEN (NEAREST INCH)  
 from 56 to 60

GRAVEL PACK IF WELL DRILLED WAS FLOWING WELL INSERT F IN BOX 68

MDE USE ONLY (NOT TO BE FILLED IN BY DRILLER)

T (E.R.O.S.) W Q

70 72 74 75 76

TELESCOPE CASING LOG INDICATOR OTHER DATA

**C3**

**PUMPING TEST**

HOURS PUMPED (nearest hour) 3

PUMPING RATE (gal. per min.) 5.4

METHOD USED TO MEASURE PUMPING RATE Bucket

WATER LEVEL (distance from land surface)

BEFORE PUMPING 58 ft.

WHEN PUMPING 185 ft.

TYPE OF PUMP USED (for test)

A air  P piston  T turbine  
 C centrifugal  R rotary  O other (describe below)  
 J jet  S submersible

**PUMP INSTALLED**

DRILLER INSTALLED PUMP (CIRCLE) (YES OR NO) YES  NO

IF DRILLER INSTALLS PUMP, THIS SECTION MUST BE COMPLETED FOR ALL WELLS.

TYPE OF PUMP INSTALLED PLACE (A,C,J,P,R,S,T,O) IN BOX 29

CAPACITY: GALLONS PER MINUTE (to nearest gallon) 31 35

PUMP HORSE POWER 37 41

PUMP COLUMN LENGTH (nearest ft.) 43 47

CASING HEIGHT (circle appropriate box and enter casing height)

+ above } LAND SURFACE

- below } 2 (nearest foot)

**LOCATION OF WELL ON LOT**

SHOW PERMANENT STRUCTURE SUCH AS BUILDING, SEPTIC TANKS, AND /OR LANDMARKS AND INDICATE NOT LESS THAN TWO DISTANCES (MEASUREMENTS TO WELL)

N

plot

B 1 9750

SEQUENCE NO. (MDE USE ONLY)

STATE OF MARYLAND APPLICATION FOR PERMIT TO DRILL WELL please type W520321

STATE PERMIT NUMBER Ho-94-3942 fill in this form completely

DATE RECEIVED (APA) 04-26-04 OWNER INFORMATION 9713 JULIUS JIM 1263 BEGGS RD WESTMINISTER, MD 21157

LOCATION OF WELL B 3 Howard Hudson Farm West Friendship

DRILLER INFORMATION George F. Easterday M WD 040 L. Franklin Easterday, Inc. 9265 Brown Church Rd., MT. Airy, Md. 21771

ROUTE 144 ON WHICH SIDE OF ROAD DISTANCE FROM ROAD 200 TAX MAP: 15 BLK: 10 PARCEL: 258

WELL INFORMATION APPROX. PUMPING RATE 5 AVERAGE DAILY QUANTITY NEEDED 500

NOT TO BE FILLED IN BY DRILLER HEALTH DEPARTMENT APPROVAL 43979 HOWARD COUNTY NAME STATE SIGNATURE DATE ISSUED 5/11/04

USE FOR WATER (CIRCLE APPROPRIATE BOX) DOMESTIC POTABLE SUPPLY & RESIDENTIAL IRRIGATION

APPROXIMATE DEPTH OF WELL 300 FEET APPROXIMATE DIAMETER OF WELL 6 INCH

SHOW MAJOR FEATURES OF BOX & LOCATE WELL WITH AN X SOURCES OF DRILLING WATER wells

METHOD OF DRILLING (Circle one) BORED (or Augered) AIR-ROTARY

REPLACEMENT OR DEEPEMED WELLS (CIRCLE APPROPRIATE BOX) THIS WELL WILL NOT REPLACE AN EXISTING WELL

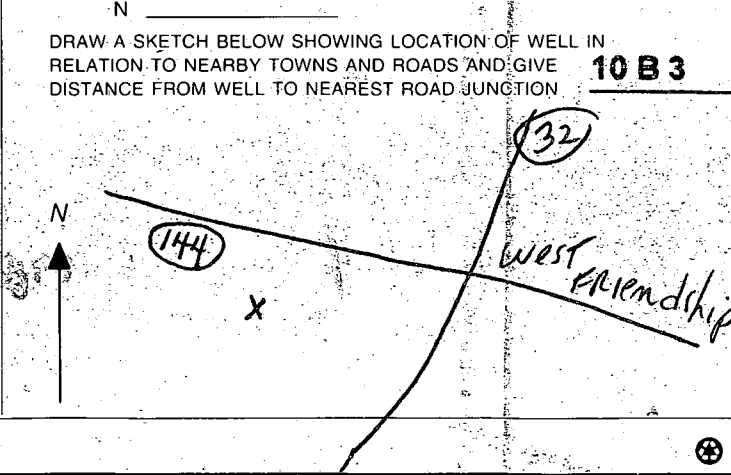

Not to be filled in by driller (MDE OR COUNTY USE ONLY) APPROX. PERMIT NUMBER Ho-94-3942

SPECIAL CONDITIONS NOTE: APPROVING AUTHORITIES SHOULD USE SEPARATE SHEET IF NEEDED





HOWARD COUNTY HEALTH DEPARTMENT  
BUREAU OF ENVIRONMENTAL HEALTH  
WATER AND SEWERAGE PROGRAM  
TEL: (410)313-2640 FAX: (410)313-2648

Information Form for the Installation of the Well Pump, Pitless Adapter, and Supply Piping

NOTE: The installer is responsible for requesting an inspection prior to 9 am on the day of the desired inspection. No work is to be covered until approved by the Health Department. All installations must comply with the National Standard Plumbing Code (NSPC, as amended locally) and COMAR 26.04.04 (MD Well Construction Regulations). Submission of a complete form is required prior to Use and Occupancy approval.

Company Name: TOTAL PLUMBING Telephone #: 301-271-3170  
Address: 15408 ALEXIA CT  
Gummersville Md

(Must circle one) Licensed Plumber Licensed Well Driller Licensed Well Pump Installer  
License # and name of individual responsible for the field installation:

Name (Print): J. DEWALDO License# MPL-19447

\*A licensed individual must perform the actual installation. Apprentices must be under the direct supervision of a licensed journeyman or master plumber, pump installer or well driller. Licenses may be subjected to field verification.

Name of Property Owner: Jay Hudson Telephone #: 410-489-5809  
Subdivision: Hudson Meadows Lot #: 1 Well Tag #: HO-94-3942  
Site Address: 17789 Marshack Rd  
West Friendship Md 21794

<b>Submersible Pump Data</b>	<b>Pitless Adapter</b>	<b>Well Cap and Electric Conduit</b>
Make: <u>Eaton</u>	Make: <u>AMM</u>	Two piece watertight cap: <input checked="" type="checkbox"/>
Model #: <u>FD1112-OS</u>	Model#: _____	Screened, vented well cap: _____
Pump Capacity: <u>3</u> GPM	Depth: <u>42"</u> (36" min)	Cap secured to casing: <input checked="" type="checkbox"/>
Well Yield: <u>7</u> GPM	NSP approved: <input checked="" type="checkbox"/>	Conduit min 1 1/2" B.G.: <input checked="" type="checkbox"/>
Depth of well encountered at time of pump installation: <u>100</u> (feet)		Conduit secured to well cap: <input checked="" type="checkbox"/>
If pump capacity exceeds well yield, a low water cut off switch is required by NSPC 1990 Section 17.8.4		
Torque arrestors or Cable guards are required - Must circle one		
Safety rope, if used, attached to inside of well casing with eye bolt: <input checked="" type="checkbox"/>		

<b>Piping to house</b>	<b>House Connection</b>
Type: <u>1" Black Poly</u>	PVC sleeved to undisturbed soil at wall penetration: <input checked="" type="checkbox"/>
PSI: <u>200</u> (160 psi min)	Approximate length of sleeve: <u>7</u>
Depth of supply line: <u>42"</u> (36" min)	Sleeve caulked and sealed properly: <input checked="" type="checkbox"/>

The water supply line is required to be at least ten feet from the septic tank, pump chamber, sewage piping, distribution box, drainfields, and sewage reserve area. If this cannot be accomplished, contact this office for approval prior to installation.

Signature of company representative responsible for installation: Josh Belano date: 1-30-04

For Health Department Use Only - Not to be completed by Installer

Date Insp. Requested: _____	Date Insp. Approved: <u>1/23/04</u>	(50)
Inspection Data: Pitless adapter and water supply line at least 36" below grade	<input checked="" type="checkbox"/>	
Two piece cap installed and attached to casing securely	<input checked="" type="checkbox"/>	
Elec. conduit extends at least 18" below grade/attached to cap properly	<input checked="" type="checkbox"/>	
Safety rope installed inside of well casing	<input checked="" type="checkbox"/>	
Correct well tag attached properly and casing 8" above finished grade	<input checked="" type="checkbox"/>	
Water supply line sleeved adequately at house connection	<input checked="" type="checkbox"/>	
Adequate grout observed below pitless adapter	<input checked="" type="checkbox"/>	

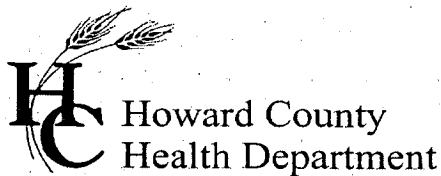

3525 H Ellicott Mills Drive, Ellicott City, MD 21043  
(410) 313-1771 Fax (410) 313-2648  
TDD (410) 313-2323 Toll Free 1-866-313-6300  
website: www.hchealth.org

Penny E. Borenstein, M.D., M.P.H., Health Officer

February 1, 2005

James W. Hudson III  
12555 Frederick Road  
West Friendship, MD 21794

**SENT VIA FACSIMILE 410-840-1601**

RE: 12789 Frederick Road  
West Friendship, MD 21794  
BP #: B00150151  
Well Permit # HO-94-3942

Dear Sirs:

This is to advise you that the septic system for the above referenced property has been installed and inspected. **Final approval of the septic system was granted on 11/12/2004. Final approval of the well line connection to the dwelling was approved on 11/23/2004.**

The water sample results indicate that the water samples submitted for testing were free of coliform and fecal coliform bacteria at the time of sampling and are bacteriologically safe for drinking. The water sample results were found to be in compliance with COMAR water quality standards.

#### **INTERIM CERTIFICATE OF POTABILITY**

This certifies that the initial sampling requirements of COMAR 26.04.04 "Well Regulations" have been met for the water supply system installed under well permit #HO-94-3942. Although the submitted sample results are in compliance with COMAR standards, the Health Department does not guarantee water supplies. Based upon satisfactory investigation and evaluation, the Howard County Health Department as authorized by the Maryland Department of the Environment accepts this well system as required by COMAR 26.04.04.

This certificate may become final upon completion of the second bacteriological test, which is to be taken by the county health department within six months of receipt of this letter. **Please contact (410) 313-1773 to schedule a final water sample appointment. Currently, there is no charge for this final sampling.**

Date of Water Sample(s): 01/17/2005 & 01/19/2005  
Date of Well Completion: 06/01/2004

Approving Authority,

*Brian Baker*  
Brian Baker, R. S.  
Well & Septic Program

cc: Building Inspector's Office  
Community Health Services  
File