

LAYOUT 3/28/02 3:00 INSP 4 _____
 INSP 2 4/3/02 PM INSP 5 _____
 INSP 3 4/29/02 11-12 INSP 6 _____

ISSUE DATE: 3/28/02

P 516891

APPROVAL DATE: 4/29/02

A 515330

**PERMIT
INDEXED
ON-SITE SEWAGE DISPOSAL SYSTEM
HOWARD COUNTY HEALTH DEPARTMENT
BUREAU OF ENVIRONMENTAL HEALTH**

Alan Whitworth IS PERMITTED TO INSTALL ALTER

ADDRESS: _____ PHONE NUMBER: 410-365-6590

SUBDIVISION: Swann Farm LOT NUMBER: _____

~~12913~~ ADDRESS: Route 108 PROPERTY OWNER: William Swann

SEPTIC TANK CAPACITY (GALLONS): 1250 OUTLET BAFFLE FILTER REQUIRED

PUMP CHAMBER CAPACITY (GALLONS): N/A COMPARTMENTED TANK REQUIRED

NUMBER OF BEDROOMS: 4 + 1 = 5 th bedroom added per B00138628)

SQUARE FEET PER BEDROOM: 210 OKSRK

LINEAR FEET OF TRENCH REQUIRED: 280

TRENCHES:	Trench to be 3.0 feet wide. Inlet 5.0 feet below original grade. Bottom maximum depth 7.0 feet below original grade. Effective area begins at 1.5 feet below original grade. 2.0 feet of stone below distribution pipe.
LOCATION:	Place the distribution box 70' from the left lot line and 100' from the front lot line closest to the road. Run trenches on contour.
NOTES:	Basement service by gravity is proposed. WELL LINE TO BE SLEEVED WHERE < THAN 10' TO SDA.

PLANS APPROVED: SRK OKSRK 1/4/02 DATE: 1/4/02

- NOTE: PERMIT VOID AFTER 2 YEARS
- NOTE: CONTRACTOR RESPONSIBLE FOR SCHEDULING A PRE-CONSTRUCTION INSPECTION FOR ALL INSTALLATIONS
- NOTE: WATERTIGHT SEPTIC TANKS REQUIRED
- NOTE: ALL PARTS OF SEPTIC SYSTEM SHALL BE 100 FEET FROM ANY WATER WELL
- NOTE: MANHOLE RISERS REQUIRED ON ALL SEPTIC TANKS AND PUMP CHAMBERS UNLESS SPECIFICALLY AUTHORIZED

NEITHER THE HOWARD COUNTY COUNCIL NOR THE HEALTH DEPARTMENT IS RESPONSIBLE FOR THE SUCCESSFUL OPERATION OF ANY SYSTEM PERMITTEE RESPONSIBLE FOR OBTAINING FINAL APPROVAL ON THIS PERMIT ALL 410-313-2640 FOR INSPECTION OF SEPTIC SYSTEM

BUILDING PERMIT SIGNED AND RETURNED

102 30 0 1386 28 IN-LAW APARTMENT
submitted 9/26/2002

A 515330

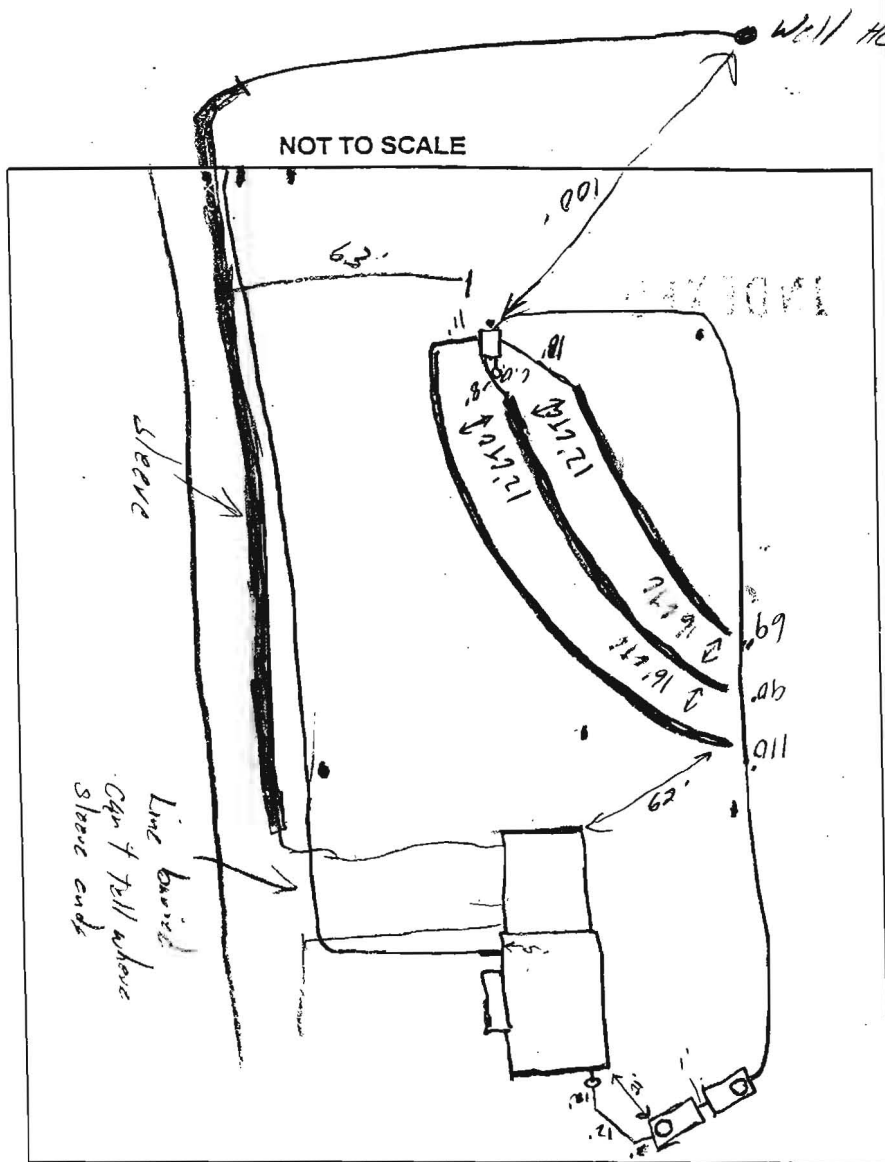

TRENCH DATA

TRENCH WIDTH 3'
 TRENCH INLET DEPTH 5'
 TRENCH BOTTOM DEPTH 7'
 DEPTH OF STONE 2'
 NUMBER OF TRENCHES 3
 TOTAL TRENCH LENGTH 269'
 ABSORBENT AREA 807 #
 DISTRIBUTION BOX LEVEL Y13
 BAFFLE IN DISTRIBUTION BOX L-used

SEPTIC TANK DATA

SEPTIC TANK 1500TS GALLONS
 MANHOLE RISER Front
 6 INCH INSPECTION PORT N/A

PUMP CHAMBER DATA

PUMP CHAMBER GALLONS 1500TS
 MANHOLE RISER Back
 ALARM Functional
 PUMP PERFORMANCE TEST OK

PRE-CONSTRUCTION INSPECTION: 3/28/02 Layout per B.P. Not sure of house Conn. (S)

INSPECTION COMMENTS: 4/3/02 OK to cover all work. Grade over tanks needs to be cut down to approx 3'. Pump & Alarm tests needed (S) 4/4/02 T/C to bldr. for details on grading @ tanks (S) 4/9/02 Can't tell if sleeve runs under drive way (S) 4/28/02 Pump & Alarm test OK (S)

INSPECTOR [Signature] DATE SYSTEM APPROVED 4/28/02

BUILDING PERMIT SIGNED AND RETURNED

HOWARD COUNTY HEALTH DEPARTMENT
Completed Septic System

P 516891 A 515330

DATE 3/28/2002

LOCATION <u>12951 Route 108</u>	APPLICATION
<u>Swann Farm</u>	HOLD ()
	APPROVED ()
	REJECTED ()
LOT _____	
APPLICANT _____	INSTALLATION
OWNER <u>William Swann</u>	HOLD ()
PERMITTEE <u>Alan Whitworth</u>	APPROVED ()
	APPROVED
HD-11	DATE <u>4/29/2002</u>