

LAYOUT _____ INSP 4 _____

INSP 2 _____ INSP 5 _____

INSP 3 _____ INSP 6 _____

ISSUE DATE: 4/17/08

PERMIT

P 528853

APPROVAL DATE: 4/17/08

A 511094

ON-SITE SEWAGE DISPOSAL SYSTEM HOWARD COUNTY HEALTH DEPARTMENT BUREAU OF ENVIRONMENTAL HEALTH

Hatfield's Equipment IS PERMITTED TO INSTALL ALTER

ADDRESS: _____ PHONE NUMBER: _____

SUBDIVISION: _____ LOT NUMBER: _____

ADDRESS: 2714 Route 32 PROPERTY OWNER: Charles Bussing

SEPTIC TANK CAPACITY (GALLONS): 2000 OUTLET BAFFLE FILTER REQUIRED

PUMP CHAMBER CAPACITY (GALLONS): _____ COMPARTMENTED TANK REQUIRED

NUMBER OF BEDROOMS: 6

SQUARE FEET PER BEDROOM: _____

LINEAR FEET OF TRENCH REQUIRED: _____

TRENCHES:	Trench to be _____ feet wide. Inlet _____ feet below original grade. Bottom maximum depth _____ feet below original grade. Effective area begins at _____ feet below original grade. _____ feet of stone below distribution pipe.
LOCATION:	1) Set repl S.T. 20' west of planned addition, and at similar elevation as existing tank. Maintain gravity flow through sys. 2) Abandon lowermost ex. trench at dist. box.
NOTES:	Basement is approved for gravity sewer. Pump and abandon ex. septic tank.

PLANS APPROVED: RB DATE: 2/8/2008

- NOTE: PERMIT VOID AFTER 2 YEARS
- NOTE: CONTRACTOR RESPONSIBLE FOR SCHEDULING A PRE-CONSTRUCTION INSPECTION FOR ALL INSTALLATIONS
- NOTE: WATERTIGHT SEPTIC TANKS REQUIRED
- NOTE: ALL PARTS OF SEPTIC SYSTEM SHALL BE 100 FEET FROM ANY WATER WELL
- NOTE: MANHOLE RISERS REQUIRED ON ALL SEPTIC TANKS AND PUMP CHAMBERS UNLESS SPECIFICALLY AUTHORIZED

NEITHER THE HOWARD COUNTY COUNCIL NOR THE HEALTH DEPARTMENT IS RESPONSIBLE FOR THE SUCCESSFUL OPERATION OF ANY SYSTEM PERMITTEE RESPONSIBLE FOR OBTAINING FINAL APPROVAL ON THIS PERMIT CALL 410-313-2640 FOR INSPECTION OF SEPTIC SYSTEM

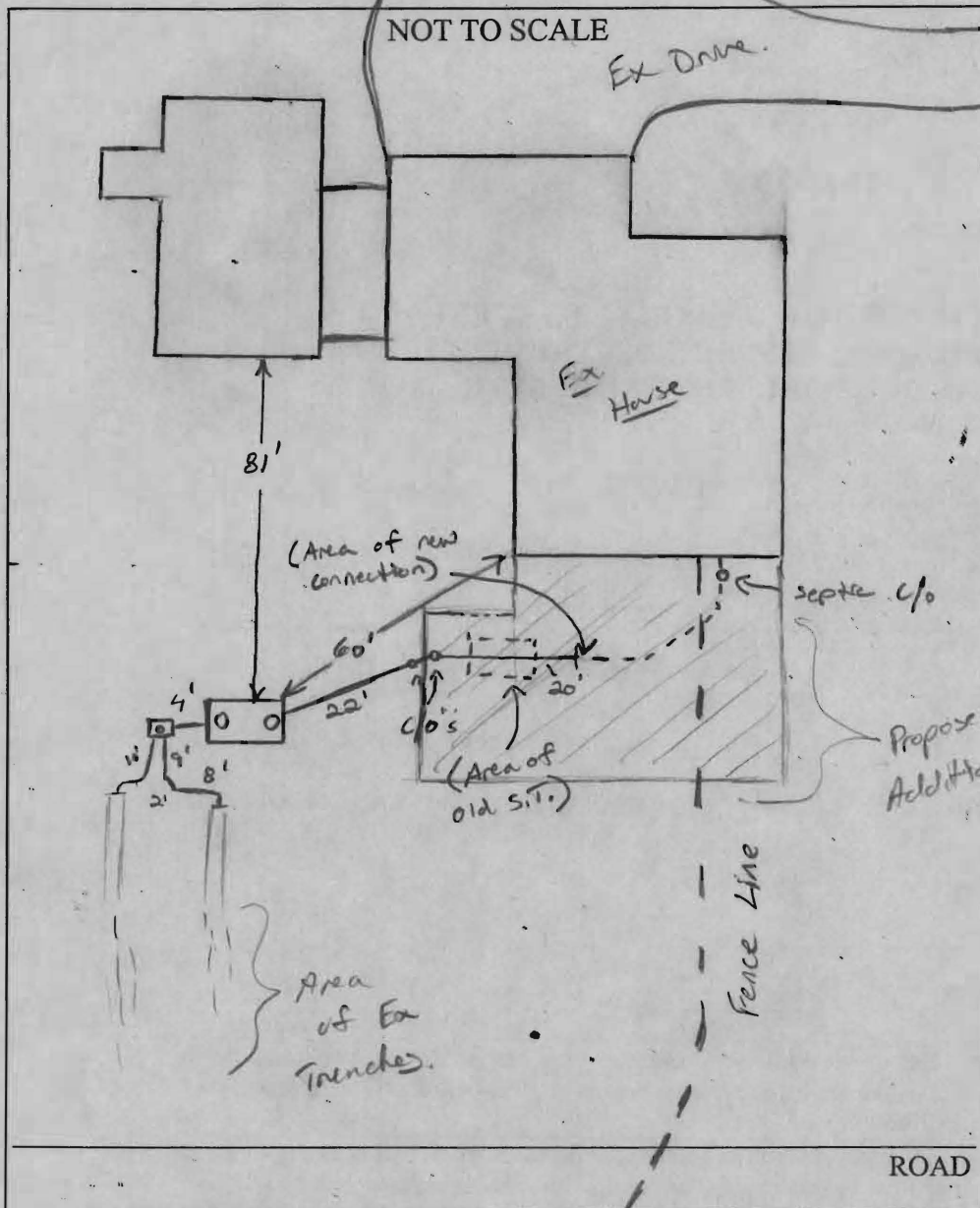

TRENCH/DRAINFIELD DATA		
WIDTH	INLET	BOTTOM
_____	_____	_____
NUMBER OF TRENCHES _____		
TOTAL LENGTH _____		
ABSORPTION AREA _____		
DISTRIBUTION BOX LEVEL <u>Yes</u>		
DISTRIBUTION BOX BAFFLE <u>Yes</u>		
DISTRIBUTION BOX PORT <u>Yes</u>		

SEPTIC TANK DATA	
SEPTIC TANK 1 LEVEL	<u>Yes</u>
CAPACITY	<u>2000</u> GAL
SEAM LOC	<u>Top T.B. lid</u>
TANK LID DEPTH	<u>5'</u>
BAFFLES	<u>Yes</u>
BAFFLE FILTER	<u>—</u>
MANHOLE LOC	<u>Front/Rear</u>
6" PORT LOC	<u>None</u>
WATERTIGHT TEST	<u>—</u>
SEPTIC TANK 2 LEVEL	_____
CAPACITY	_____ GAL
SEAM LOC	_____
TANK LID DEPTH	_____
BAFFLES	_____
BAFFLE FILTER	_____
MANHOLE LOC	_____
6" PORT LOC	_____
WATERTIGHT TEST	_____

Handwritten notes: Babylon slotted T.B.

PRE-CONSTRUCTION _____

INSTALLATION 4/17/08 old S.T. pumped/collapsed, area filled w/ #57 stone. New 2000g S.T. set 21' from prop. addition. New D box set. lower trench abandoned. OK to cover (pin)

FINAL INSPECTOR R. Wall DATE OF APPROVAL 4/17/08

