

LAYOUT _____ INSP 4 _____
INSP 2 _____ INSP 5 _____
INSP 3 _____ INSP 6 _____

ISSUE DATE: 4/14/10

PERMIT - Repair

P 532587

APPROVAL DATE: 4/16/10

A Repair

Tax ID 05351931

ON-SITE SEWAGE DISPOSAL SYSTEM HOWARD COUNTY HEALTH DEPARTMENT BUREAU OF ENVIRONMENTAL HEALTH

Jm Contracting

IS PERMITTED TO INSTALL ALTER

ADDRESS: _____ PHONE NUMBER: 443-277-2526

SUBDIVISION: _____ LOT NUMBER: _____

ADDRESS: 8364 Reservoir Rd PROPERTY OWNER: _____

SEPTIC TANK CAPACITY (GALLONS): Ex. OUTLET BAFFLE FILTER REQUIRED

PUMP CHAMBER CAPACITY (GALLONS): N/A COMPARTMENTED TANK REQUIRED

NUMBER OF BEDROOMS: 6 APPLICATION RATE: _____

SQUARE FOOTAGE OF HOUSE: N/A Inlet ~ 5' 2' wide.
Bottom 11' 11' ETE.

LINEAR FEET OF TRENCH REQUIRED: _____ APPROX. STONE AMT: ~135 ton

TRENCHES:	Trenches to be <u>2x90</u> feet wide. Inlet <u>5'</u> feet below original grade. Bottom maximum depth <u>11'</u> feet below grade. Effective area begins at <u>11'</u> feet below original grade. <u>11' ETE.</u> feet of stone below distribution pipe.
LOCATION:	<u>Add trenches (2x90) on center below Ex. failing trench. D box can be set in middle of trenches to install 4x45'</u>
NOTES:	Manhole access needs to be installed on the tank along with a new outlet baffle. Pump and collapse ex. dry well. Observation pipes required at ends of trenches.

PLANS APPROVED: Kevin Wolf DATE: 4/14/10

- NOTE: PERMIT VOID AFTER 2 YEARS
- NOTE: CONTRACTOR RESPONSIBLE FOR SCHEDULING A PRE-CONSTRUCTION INSPECTION FOR ALL INSTALLATIONS
- NOTE: WATERTIGHT SEPTIC TANKS REQUIRED
- NOTE: ALL PARTS OF SEPTIC SYSTEM SHALL BE 100 FEET FROM ANY WATER WELL
- NOTE: MANHOLE RISERS REQUIRED ON ALL SEPTIC TANKS AND PUMP CHAMBERS

NEITHER THE HOWARD COUNTY COUNCIL OR THE HEALTH DEPARTMENT IS RESPONSIBLE FOR THE SUCCESSFUL OPERATION OF ANY SYSTEM PERMITTEE RESPONSIBLE FOR OBTAINING FINAL APPROVAL ON THIS PERMIT CALL 410-313-1771 FOR INSPECTION OF SEPTIC SYSTEM

NOT TO SCALE

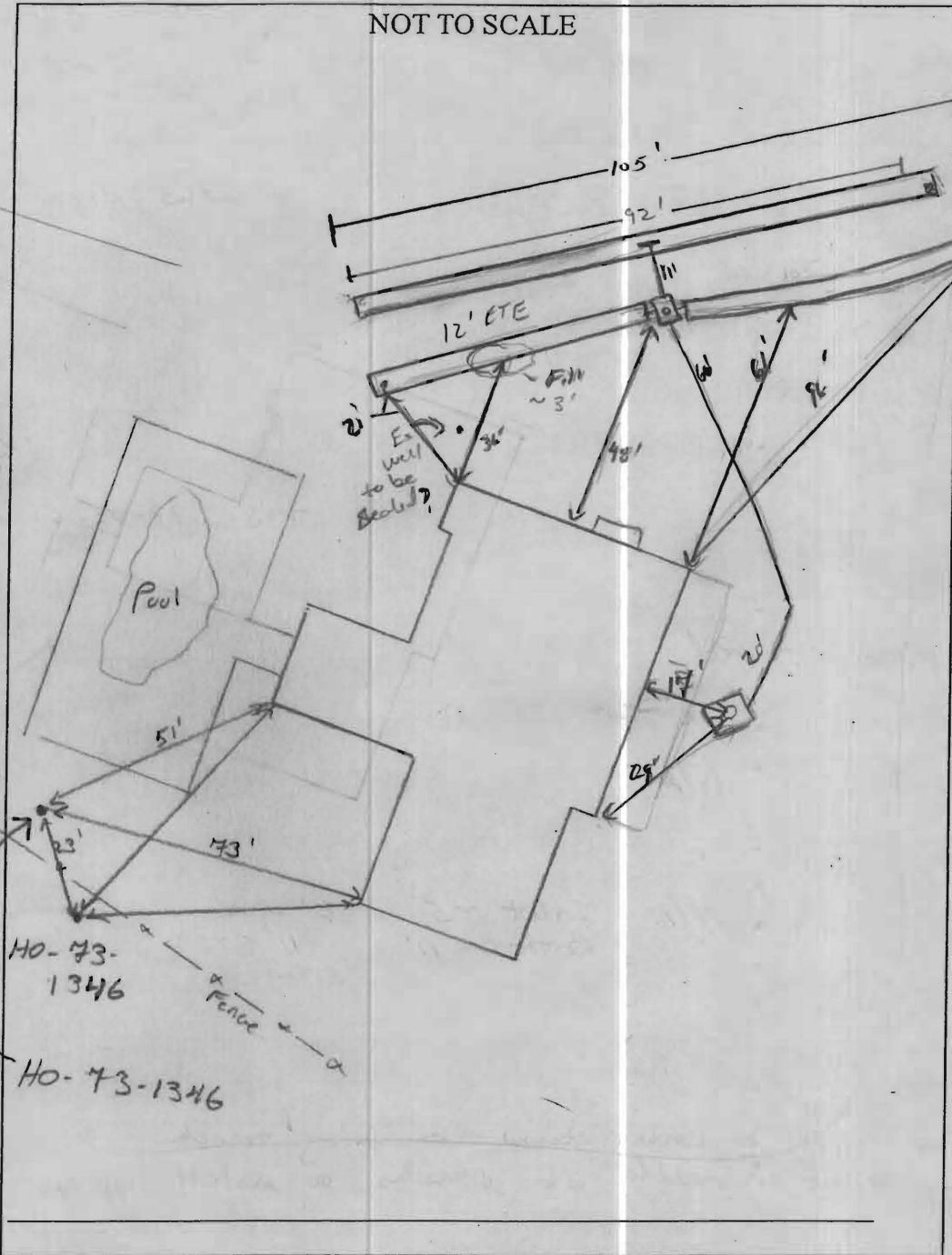

TRENCH/DRAINFIELD DATA

WIDTH	INLET	BOTTOM
2'	4.5-5.5'	11'
NUMBER OF TRENCHES		2
TOTAL LENGTH		197'
ABSORPTION AREA		
DISTRIBUTION BOX LEVEL		Level
DISTRIBUTION BOX BAFFLE		Yes
DISTRIBUTION BOX PORT		Yes

SEPTIC TANK DATA

SEPTIC TANK I LEVEL	?
MANUFACTURER	?
CAPACITY	1250? GAL
SEAM LOC	Mid.
TANK LID DEPTH	3'
BAFFLES	Yes concrete
BAFFLE FILTER	
MANHOLE LOC	center
6" PORT LOC	none
WATERTIGHT TEST	
SLOTTED	no

PUMP/SEPTIC TANK LEVEL

MANUFACTURER	
CAPACITY	
SEAM LOC	
TANK LID DEPTH	
BAFFLES	
BAFFLE FILTER	
MANHOLE LOC	
6" PORT LOC	
WATERTIGHT TEST	
SLOTTED	

PRE-CONSTRUCTION

4/14/10 on high side of lot, just below ex. failing trench. Install 2 x 90' trenches on contour. Trenches pointed out in field.

OK to set D box near middle of lower to split the trenches. Told contractor that he might hit ex. failing trench and needs to cap this off to prevent an open channel. Insp.'s of this must be made by Health Dept. (PA)
 4/16/10 Trenches installed as layout. Everything looks good
 OK to cover all work. (PA)

FINAL INSPECTOR Jh. Wolf DATE OF APPROVAL 4/16/10

SEPTIC SYSTEM REPAIR / UPGRADE / EVALUATION REQUEST

Please fill out this form completely and check off the reason for the request:

Date requested: 4/6/10

Reason for Request

Failing System (includes surface discharge or inadequate treatment zone)

Has the contractor verified through excavation/pumping evaluation, that there are no pipe blockages? Yes

In support of a building permit. Type of building addition: NO

*System relocation for proposed addition for setback compliance _____

*Verification of adequate system capacity per COMAR 26.04.02.02D (4) _____

To replace collapsed septic tank or upgrade tank capacity _____

To replace collapsed drywell

Septic Contractor: J.M. Contracting LLC / Ronnie Neaf5

Contractor's Address: 425 OBracht Rd

Sylkesville Md. 21784

Contractor's Phone #: 443-277-7526

Property Address: 8364 Reservoir Rd.

Property (Subdivision) & Lot # Fulton Md.

Owner's Name: Noon-Hwa Chen

Is public sewer available/nearby: NO

Names of Any Previous Owners: _____

Year House Built: 1974

of Existing Bedrooms: 6

of Bedrooms after completion of addition: _____

Has this request been discussed previously with a Sanitarian, who? NO

If public sewer is close, further research will be performed to verify availability and possible hook up to public sewer.

A Sanitarian will be in contact within three business days depending upon the urgency of the situation to coordinate the scheduling of the repair /upgrade/evaluation. No inspection will be performed without fee collection at the office.

Environmental Sanitarian tentatively assigned _____

410-313-2648