

4/23/01
11:00
4/25/01 - 10 AM
12/20/01 - 10:00 Pump Test
K & K Excavating
9/7/01
CO. outline
WPI Lab # (2100)
9/11/01
House Comm.
10 AM > 6 PM
Pump Test

PERMIT

Needs pump test

P 515202-B

SEWAGE DISPOSAL SYSTEM

A 39898

HOWARD COUNTY HEALTH DEPARTMENT

BUREAU OF ENVIRONMENTAL HEALTH

ISSUE DATE 4/18/2001

410-313-2640

APPROVAL DATE 12/26/01

INDEXED

05-410843

IS PERMITTED TO INSTALL ALTER

ADDRESS 14960 Frederick Road, Woodbine, MD 21797 PHONE 410-442-1336

UBDIVISION Twelve Hills LOT NUMBER 45 ADDRESS 13005 Red Maple Way

PROPERTY OWNER Selfridge Builders PROPERTY OWNER'S ADDRESS 14045 Gared Dr (21738)

SEPTIC TANK CAPACITY 1500 GALLONS (TOPSEAM)

PUMP CHAMBER CAPACITY 1500 GALLONS (TOPSEAM)

NUMBER OF BEDROOMS 5

SQUARE FEET PER BEDROOM 210

LINEAR FEET OF TRENCH REQUIRED 262.5

TRENCHES: Trenches to be 3 feet wide. Inlet 3.5 feet below original grade. Bottom maximum depth 7.5 feet below original grade. 4 feet of stone below distribution box pipe

LOCATION: Beginning from the intersection of the 35.36' and 339.01' lot lines, place distribution box 105 feet down the 339.01' lot line and 35 feet off that same lot line. Run trenches as shown on approved building permit plan. Maintain a minimum of 100 feet from the well to all parts of septic system.

Well line must be 10' from all parts of septic system

PLANS APPROVED Amy McMillen, R.S. OK SRK 2/14/01 DATE 2/2/2001

PERMIT VOID AFTER 2 YEARS

NOTE: CONTRACTOR RESPONSIBLE FOR SCHEDULING A PRE-CONSTRUCTION INSPECTION FOR ALL INSTALLATIONS

NOTE: TOP OF SEPTIC TANKS ARE TO BE NO DEEPER THAN 3.0 FEET BELOW FINISH GRADE

NOTE: WATERTIGHT SEPTIC TANKS REQUIRED

NOTE: CLEANOUT REQUIRED EVERY 70 FEET OF SEWER LINE AND/OR AT 90° SWEEPS IN LINES FROM HOUSE TO DRAIN FIELDS, 90° ELBOWS ARE NOT ACCEPTABLE

NOTE: ALL PARTS OF SEPTIC SYSTEMS (I.E. TANK, DISTRIBUTION BOX, DRAINFIELDS) TO BE 100 FEET FROM ANY WATER WELL UNLESS OTHERWISE SPECIFICALLY AUTHORIZED

BUILDING PERMIT SIGNED

AND RETURNED 11-21-02
800139480-IG POOL

NOTE: NO ABSORPTION TRENCH TO EXCEED 100 FEET IN LENGTH UNLESS SPECIFICALLY AUTHORIZED

NOTE: ALL PIPE FROM HOUSE TO SEPTIC TANK MUST BE CAST IRON OR SCHEDULE 35/40 PVC OR ABS

NOTE: MANHOLE RISERS REQUIRED ON ALL SEPTIC TANKS AND PUMP CHAMBERS

NOTE: DISTRIBUTION BOXES MUST HAVE BAFFLES

NOTE: IF PUMPED SEPTIC SYSTEM REQUIRED, (1) SEPTIC PUMP DETAIL TO BE PROVIDED BY INSTALLER PRIOR TO ISSUANCE OF SEPTIC PERMIT (2) PUMP PERFORMANCE TEST IS NECESSARY PRIOR TO HEALTH DEPARTMENT APPROVAL OF SEPTIC PERMIT

NEITHER THE HOWARD COUNTY COUNCIL NOR THE HEALTH DEPARTMENT IS RESPONSIBLE FOR THE SUCCESSFUL OPERATION OF ANY SYSTEM

PERMITTEE RESPONSIBLE FOR OBTAINING FINAL APPROVAL ON THIS PERMIT
CALL 410-313-2640 FOR INSPECTION OF SEPTIC SYSTEM

101000000

NOT TO SCALE

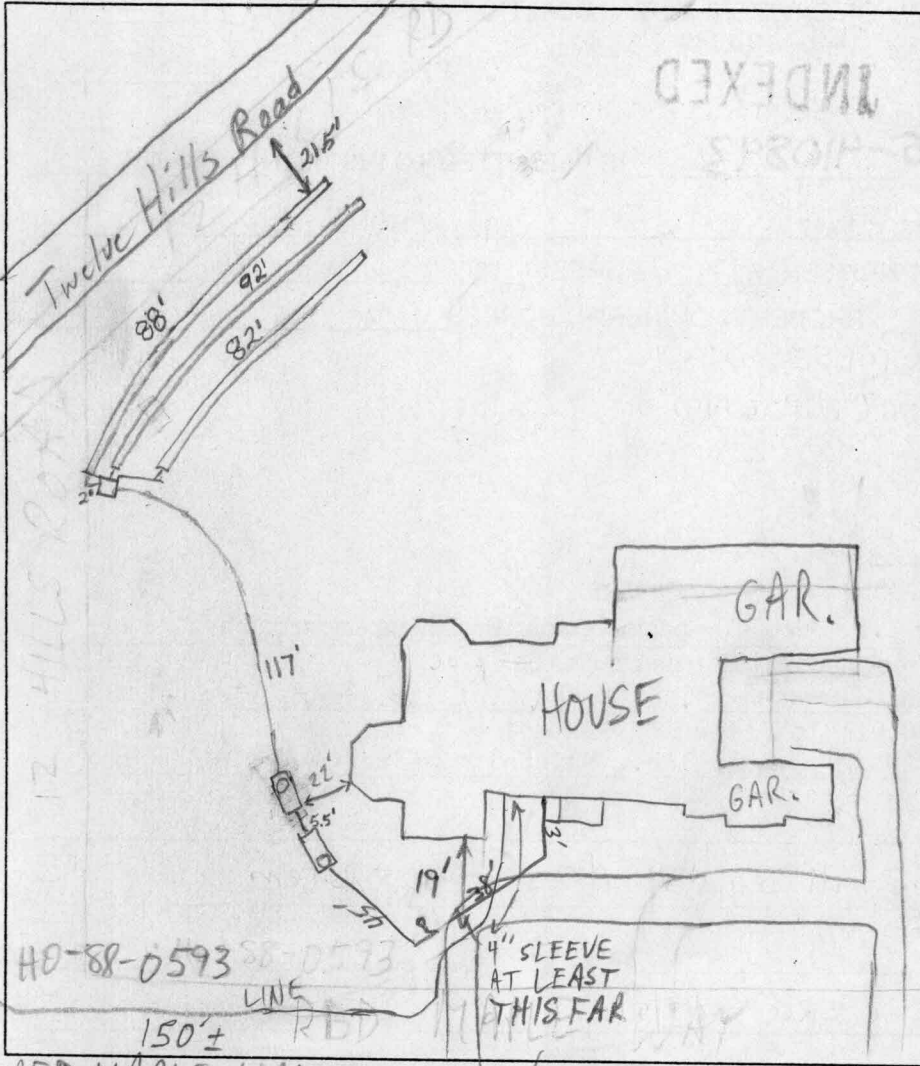

TRENCH DATA

TRENCH WIDTH 2'
 TRENCH INLET DEPTH 3.5'
 TRENCH BOTTOM DEPTH 7.5'
 DEPTH OF STONE 4'
 NUMBER OF TRENCHES 3
 TOTAL TRENCH LENGTH 262'
 ABSORBENT AREA 1,048 sq.ft.
 DISTRIBUTION BOX LEVEL Yes
 BAFFLE IN DISTRIBUTION BOX Yes

SEPTIC TANK DATA

SEPTIC TANK 1500 TS GALLONS
 MANHOLE RISER Yes
 6 INCH INSPECTION PORT No

PUMP CHAMBER DATA

PUMP CHAMBER GALLONS 1500 TS
 MANHOLE RISER Yes
 ALARM _____
 PUMP PERFORMANCE TEST _____

RED MAPLE WAY

PRE-CONSTRUCTION INSPECTION: 4/23/01 11:30 OK TO START (MR)

INSPECTION COMMENTS: 4/23/01 3:00 TANKS, D.B. SET; CONTINUE (MR) 4/25/01

Need house connection, alarm and pump test for final approval (MR) 4/29/01 NO WORK (MR) House connection OK

Bob Herrera (Supervisor) Says water line is jacketed all way, put sewer line by 10ft (water line is buried @ 4' below

sewer line, which needs 1 1/2 ft of fill to cover (only 6" in ground now). RP 9/11/01 12/20/01 No show for test (SO)

12/26/01 Pump & Alarm tests OK (E)

WPT final OK RP 9/14/01

INSPECTOR [Signature]

DATE SYSTEM APPROVED 12/26/01