

4/18/01
CO - anytime
inspection of septic supply
line only, so the man plan
concrete.
5/21/01 - 11:00 layout
5/30/01 - 1:00
05-421713

PERMIT

SEWAGE DISPOSAL SYSTEM
HOWARD COUNTY HEALTH DEPARTMENT
BUREAU OF ENVIRONMENTAL HEALTH
410-313-2640

P 515034-B

A 49399

ISSUE DATE 4/9/2001

APPROVAL DATE 5/30/01

INDEXED

Fogles Septic Clean, Inc

IS PERMITTED TO INSTALL X ALTER

ADDRESS 580 Obrecht Road, Sykesville, MD 21784

PHONE 410-795-5670

SUBDIVISION Paternal Gift Farm

LOT NUMBER 6

ADDRESS 13541 Paternal Gift Drive

PROPERTY OWNER Charles & Hester Butterfield

PROPERTY OWNER'S ADDRESS 9501 Footprint Place

SEPTIC TANK CAPACITY 1250 GALLONS

Columbia, MD 21046

PUMP CHAMBER CAPACITY NA GALLONS

*** TOP SEAMED SEPTIC TANK REQUIRED ***

NUMBER OF BEDROOMS 4

SQUARE FEET PER BEDROOM 240

LINEAR FEET OF TRENCH REQUIRED 320

TRENCHES: Trenches to be 3 feet wide. Inlet 3 feet below original grade. Bottom maximum depth 5 feet below original grade. 2 feet of stone below distribution box.

LOCATION: Place distribution box 80 feet from the left (245.24') lot line 110 feet from the rear (142.40') lot line as viewed from Paternal Gift Drive. Install trenches on contour in both directions from distribution box. 4/25/00 O.K. (RR)

PLANS APPROVED Ronald J. Pinkley

DATE 10-18-1999

PERMIT VOID AFTER 2 YEARS

NOTE: CONTRACTOR RESPONSIBLE FOR SCHEDULING A PRE-CONSTRUCTION INSPECTION FOR ALL INSTALLATIONS

NOTE: TOP OF SEPTIC TANKS ARE TO BE NO DEEPER THAN 3.0 FEET BELOW FINISH GRADE

NOTE: WATERTIGHT SEPTIC TANKS REQUIRED

NOTE: CLEANOUT REQUIRED EVERY 70 FEET OF SEWER LINE AND/OR AT 90° SWEEPS IN LINES FROM HOUSE TO DRAIN FIELDS, 90° ELBOWS ARE NOT ACCEPTABLE

NOTE: ALL PARTS OF SEPTIC SYSTEMS (I.E. TANK, DISTRIBUTION BOX, DRAINFIELDS) TO BE 100 FEET FROM ANY WATER WELL UNLESS OTHERWISE SPECIFICALLY AUTHORIZED

NOTE: NO ABSORPTION TRENCH TO EXCEED 100 FEET IN LENGTH UNLESS SPECIFICALLY AUTHORIZED

NOTE: ALL PIPE FROM HOUSE TO SEPTIC TANK MUST BE CAST IRON OR SCHEDULE 35/40 PVC OR ABS

NOTE: MANHOLE RISERS REQUIRED ON ALL SEPTIC TANKS AND PUMP CHAMBERS

NOTE: DISTRIBUTION BOXES MUST HAVE BAFFLES

NOTE: IF PUMPED SEPTIC SYSTEM REQUIRED, (1) SEPTIC PUMP DETAIL TO BE PROVIDED BY INSTALLER PRIOR TO ISSUANCE OF SEPTIC PERMIT (2) PUMP PERFORMANCE TEST IS NECESSARY PRIOR TO HEALTH DEPARTMENT APPROVAL OF SEPTIC PERMIT

NEITHER THE HOWARD COUNTY COUNCIL NOR THE HEALTH DEPARTMENT IS RESPONSIBLE FOR THE SUCCESSFUL OPERATION OF ANY SYSTEM

PERMITTEE RESPONSIBLE FOR OBTAINING FINAL APPROVAL ON THIS PERMIT

CALL 410-313-2640 FOR INSPECTION OF SEPTIC SYSTEM

P 515034-B

NOT TO SCALE

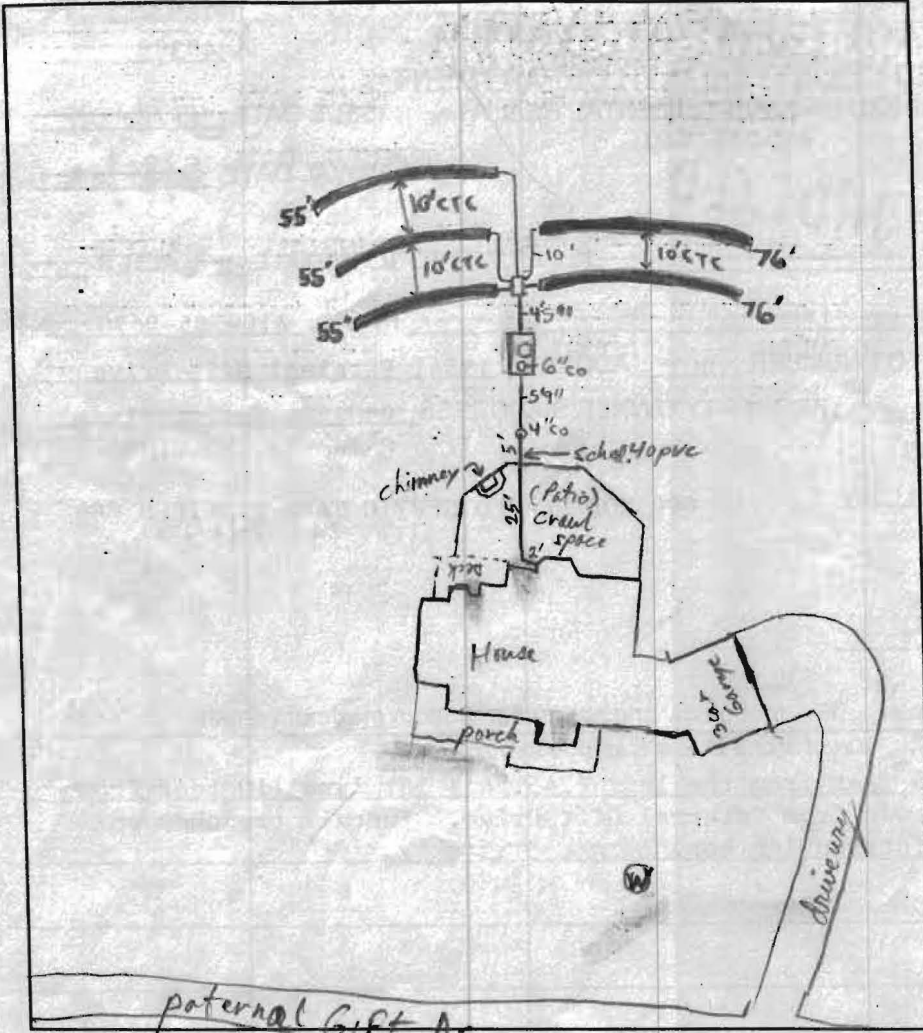

TRENCH DATA

TRENCH WIDTH 3'
 TRENCH INLET DEPTH 3'
 TRENCH BOTTOM DEPTH 5'
 DEPTH OF STONE 2'
 NUMBER OF TRENCHES 5
 TOTAL TRENCH LENGTH 317'
 ABSORBENT AREA 951 ft²
 DISTRIBUTION BOX LEVEL
 BAFFLE IN DISTRIBUTION BOX

SEPTIC TANK DATA

SEPTIC TANK 1250 T.G. GALLONS
 BAFFLES IN on center
 MANHOLE RISER on front
 6 INCH INSPECTION PORT on front

PUMP CHAMBER DATA

PUMP CHAMBER GALLONS NA
 MANHOLE RISER NA
 ALARM NA
 PUMP PERFORMANCE TEST NA

PRE-CONSTRUCTION INSPECTION: 5/21/01 - OK TO START - (5) 60-65' TRENCHES
IN BOTH DIRECTIONS; S.T. 10' FROM PATIO; OK TO REDUCE TOTAL TRENCH (MR)

INSPECTION COMMENTS: House connection under crawl space OK to cover. RYP 4/18/01

5/30/01 - OK TO COVER ALL WORK (SRK)

INSPECTOR

Steven R. Krieg

DATE SYSTEM APPROVED

5/30/01