

C1 07579

SEQUENCE NO. (MDE USE ONLY)

STATE OF MARYLAND WELL COMPLETION REPORT

THIS REPORT MUST BE SUBMITTED AFTER WELL IS COMPLETED.

COUNTY NUMBER A38965

ST/CO USE ONLY DATE Received

DATE WELL COMPLETED 2 3 2000

Depth of Well 2200' (TO NEAREST FOOT)

PERMIT NO. FROM "PERMIT TO DRILL WELL" HO-94-2534

OWNER HACKETT, JAMES last name first name STREET OR RFD OLD ROVER RD TOWN WEST FRIENDSHIP SUBDIVISION TAX MAPS PAR. 54 SECTION LOT

WELL LOG table with columns for DESCRIPTION, FEET (FROM, TO), and check if water bearing. Includes handwritten entries for Sand and Gray Mica Rock.

GROUTING RECORD form with fields for WELLS BEEN GROUTED, TYPE OF GROUTING MATERIAL, CEMENT, BENTONITE CLAY, NO. OF BAGS, NO. OF POUNDS, GALLONS OF WATER, and DEPTH OF GROUT SEAL.

CASING RECORD form with fields for casing types (STEEL, CONCRETE, PLASTIC, OTHER), MAIN CASING TYPE, Nominal diameter, and Total depth.

OTHER CASING (if used) form with fields for diameter and depth.

SCREEN RECORD form with fields for screen type or open hole, and screen diameter/depth.

NUMBER OF UNSUCCESSFUL WELLS: 0

WELL HYDROFRACTURED YES NO Y N

- CIRCLE APPROPRIATE LETTER A WELL WAS ABANDONED AND SEALED WHEN THIS WELL WAS COMPLETED E ELECTRIC LOG OBTAINED P TEST WELL CONVERTED TO PRODUCTION WELL

I HEREBY CERTIFY THAT THIS WELL HAS BEEN CONSTRUCTED IN ACCORDANCE WITH COMAR 26.04.04 "WELL CONSTRUCTION" AND IN CONFORMANCE WITH ALL CONDITIONS STATED IN THE ABOVE CAPTIONED PERMIT...

DRILLERS LIC. NO. 1 MSD024 DRILLERS SIGNATURE

LIC. NO. 1 MSD027

SITE SUPERVISOR (sign. of driller or journeyman responsible for sitework if different from permittee)

DEPTH (nearest ft.) table with columns for depth intervals (1-21, 23-36, 38-51) and slot size/diameter of screen.

GRAVEL PACK IF WELL DRILLED WAS FLOWING WELL INSERT F IN BOX 68

MDE USE ONLY (NOT TO BE FILLED IN BY DRILLER) T (E.R.O.S.) W Q 70 72 74 75 76 TELESCOPE CASING LOG INDICATOR OTHER DATA

PUMPING TEST form with fields for HOURS PUMPED, PUMPING RATE, METHOD USED TO MEASURE PUMPING RATE, WATER LEVEL, and TYPE OF PUMP USED.

PUMP INSTALLED form with fields for DRILLER INSTALLED PUMP, TYPE OF PUMP INSTALLED, CAPACITY, PUMP HORSE POWER, and PUMP COLUMN LENGTH.

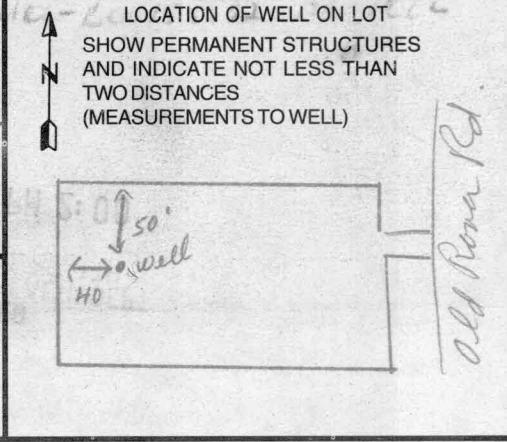

B 1 2 3 6  
14318

SEQUENCE NO.  
(MDE USE ONLY)

STATE OF MARYLAND  
PERMIT TO DRILL WELL  
please print or type

STATE PERMIT NUMBER

Ho - 94 - 2534  
70 fill in this form completely 79

Date Received (APA)

OWNER INFORMATION

8 MM DD YY 13

Hackett W. James  
15 Last Name Owner First Name 34

13749 Old Rover Rd.  
36 Street or RFD 55

West Friendship Md 21794  
57 Town 70 State 72 Zip 76

B 3 LOCATION OF WELL

8 COUNTY 21

Hackett Prop.  
23 SUBDIVISION 42

SECTION 44 46 LOT 48 50

West Friendship  
52 NEAREST TOWN 71

MILES FROM TOWN (enter 0 if in town) 4 1/2 M I  
73 76 77 78

DRILLER INFORMATION

Joseph L. Wayne M 5 D 24  
Driller's Name 76 License No. 81

Joseph L. Wayne Well Drilling  
Firm Name

5512 Ridge Rd. Mt. Airy Md. 21771  
Address

Joseph L. Wayne 1/4/00  
Signature Date

B 4  
1 2  
DIRECTION OF WELL FROM TOWN (CIRCLE BOX)

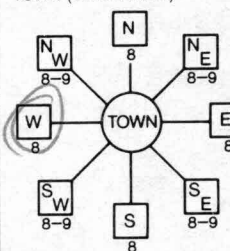

Old Rover Rd.  
11 NEAR WHAT ROAD 30

ON WHICH SIDE OF ROAD (CIRCLE APPROPRIATE BOX)

34 580 37  
DISTANCE FROM ROAD FT  
ENTER FT OR MI 38 39

TAX MAP: 15 BLK: PARCEL 54

B 2 WELL INFORMATION

APPROX. PUMPING RATE (GAL. PER MIN.) 5  
8 500 12

AVERAGE DAILY QUANTITY NEEDED (GAL. PER DAY) 14 20

USE FOR WATER (CIRCLE APPROPRIATE BOX)

- DOMESTIC POTABLE SUPPLY & RESIDENTIAL IRRIGATION
- FARMING (LIVESTOCK WATERING & AGRICULTURAL IRRIGATION)
- INDUSTRIAL, COMMERCIAL, DEWATERING
- PUBLIC WATER SUPPLY WELL
- TEST, OBSERVATION, MONITORING
- GEO-THERMAL

NOT TO BE FILLED IN BY DRILLER  
HEALTH DEPARTMENT APPROVAL

HOWARD A38965  
COUNTY NAME COUNTY NO.

STATE SIGNATURE INSERT S → 41

DATE ISSUED 01 10 00 Ciwill 1/10/01  
43 MM DD YY 48 CO SIGNATURE EXP. DATE

NORTH GRID 530 000 EAST GRID 0800 000  
50 55 57 63

APPROXIMATE DEPTH OF WELL 300 FEET  
24 28

APPROXIMATE DIAMETER OF WELL 6 INCH NEAREST INCH

METHOD OF DRILLING (circle one)

BORED (or Augered) JETTED Jetted & DRIVEN

30 AIR-ROTARY AIR-PERCussion ROTARY (Hydraulic Rotary)

37 CABLE REVERSE-ROTARY DRIVE-POINT

other

REPLACEMENT OR DEEPEMED WELLS  
(CIRCLE APPROPRIATE BOX)

- THIS WELL WILL NOT REPLACE AN EXISTING WELL
- THIS WELL WILL REPLACE A WELL THAT WILL BE ABANDONED AND SEALED
- 39  THIS WELL WILL REPLACE A WELL THAT WILL BE USED AS A STANDBY-CONTACT LOCAL APPROVING AUTHORITY FOR POLICY ON STANDBY WELLS
- THIS WELL WILL DEEPEMED AN EXISTING WELL

PERMIT NUMBER OF WELL TO BE REPLACED OR DEEPEMED (IF AVAILABLE) 41 52

Not to be filled in by driller (MDE OR COUNTY USE ONLY)

APPROX. PERMIT NUMBER 54 G A P 63

PERMIT No. Ho - 94 - 2534  
70 71 72 73 74 75 76 77 78 79

SHOW MAJOR FEATURES OF BOX & LOCATE WELL WITH AN X

- SOURCES OF DRILLING WATER
- 1. well
- 2.
- 3.

WRITE THE BOX NUMBER FROM THE MAP HERE

E 800  
N 530

DRAW A SKETCH BELOW SHOWING LOCATION OF WELL IN RELATION TO NEARBY TOWNS AND ROADS AND GIVE DISTANCE FROM WELL TO NEAREST ROAD JUNCTION

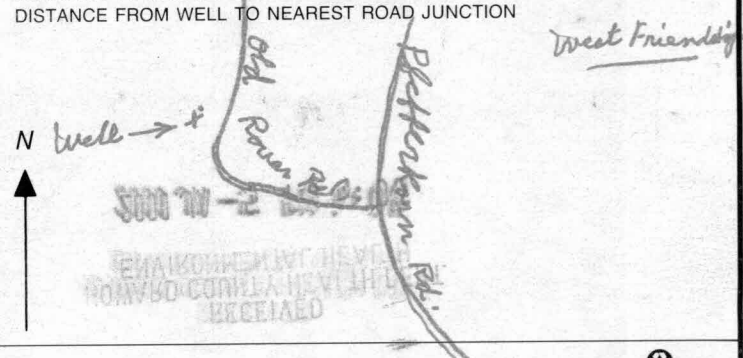

SPECIAL CONDITIONS

NOTE - APPROVING AUTHORITIES SHOULD USE SEPARATE SHEET IF NEEDED -



C.F.J. 4/24/01  
@ 9:35 AM

HOWARD COUNTY HEALTH DEPARTMENT  
BUREAU OF ENVIRONMENTAL HEALTH  
WATER AND SEWERAGE PROGRAM  
TEL: (410)313-2640 FAX: (410)313-2648

Information Form for the Installation of the Well Pump, Pitless Adapter, and Supply Piping

NOTE: The installer is responsible for requesting an inspection prior to 9 am on the day of the desired inspection. No work is to be covered until approved by the Health Department. All installations must comply with the National Standard Plumbing Code (NSPC, as amended locally) and COMAR 26.04.04 (RID Well Construction Regulations). Submission of a complete form is required prior to Use and Occupancy approval.

Company Name: Roberta L. Freezer Co. Telephone #: 410-281-4655  
Address: 6321 BARWELL AVE.  
SYRACUSE, MD. 21784

(Must circle one) Licensed Plumber Licensed Well Driller Licensed Well Pump Installer

License # and name of individual responsible for the field installation:  
Name (Print): ROBERT L. FREEZER License# 2122  
\*A licensed individual must perform the actual installation. Apprentices must be under the direct supervision of a licensed journeyman or master plumber, pump installer or well driller. Licenses may be subjected to field verification.

Name of Property Owner: Mrs. Elizabeth Winkler Telephone #: 301-854-3219  
Subdivision: N/A. MOUNTAIN VIEW Lot #: \_\_\_\_\_ Well Tag #: HO-94-2534  
Site Address: 13753 OLD PINE ROAD

Submersible Pump Data Pitless Adapter Well Cap and Electric Conduit  
Make: STANTEC Make: Campbell Two piece watertight cap:   
Model #: 103002RL Model#: 300 Screened, vented well cap:   
Pump Capacity 10 GPM Depth: 42" (36" min) Cap secured to casing:   
Well Yield: 10 GPM NSF approved: Yes Conduit min 18" B.G.:   
Depth of well encountered at time of pump installation: 250 (feet) Conduit secured to well cap:   
If pump capacity exceeds well yield, a low water cut off switch is required by NSPC 1990 Section 17.8.4  
Torque arrestors or Cable guards are required - Must circle one  
Safety rope, if used, attached to inside of well casing with eye bolt

Piping to house House Connection  
Type: Polyethylene PVC sleeved to an undisturbed soil at wall penetration:   
PSI: 160 (160 psi min) Approximate length of sleeve: 10'  
Depth of supply line: 36" (36" min) Sleeve caulked and sealed properly:

The water supply line is required to be at least ten feet from the septic tank, pump chamber, sewage piping, distribution box, drainfields, and sewage reserve area. If this cannot be accomplished, contact this office for approval prior to installation.

Robert L. Freezer Signature of company representative responsible for installation 4/24/01 date

For Health Department Use Only - Not to be completed by Installer

Date Insp. Requested: 4/24/01 Date Insp. Approved: 4/24/01 SRK

- Inspection Data: Pitless adapter and water supply line at least 36" below grade
- Two piece cap installed and attached to casing; securely
- Elec. conduit extends at least 18" below grade/attached to cap properly
- Safety rope installed inside of well casing
- Correct well tag attached properly and casing 8" above finished grade
- Water supply line sleeved adequately at house connection
- Adequate grout observed below pitless adapter

**FILED**  
**APR 24 2001**

LOT 6  
Plat 4141

EX. SDA

LO  
Plat

570  
EX. SDA

EX. WOODS LINE

501.75'

N 75° 00' 00" W

10' BRL

10' BRL

100' R.

ACTUAL DRAINED LOCATION  
SEE PLAT REVISION  
3/16/00  
w/ MODIFIED  
SEPTIC AREA

PARCEL  
54

4

2

A 38965

PROP  
WELL

PROPOSED  
DWELLING

3

50'  
BRL

Ch B2

10' BRL

S 75° 00' 00" E

427.50'

3' 00" 0' 00" E  
72.25'

10'  
BRL

590

502.30' 00" W

216.00'

30'  
BRL

LOC. TION  
APPROVED INTO 576  
RECENT WALK-OVER WITH  
1/10/02

580  
INSPECTOR



---

HOWARD COUNTY HEALTH DEPARTMENT

---

*Diane L. Matuszak, M.D., M.P.H., County Health Officer*

March 22, 2000

NOT SENT - COMMUNICATED BY TELEPHONE  
REVISION SIGNED 3/27/00

James Hackett  
13789 Old Rover Rd.  
West Friendship, Md. 21794

Re: Well HO-94-2534  
Parcel 54, Tax Map 15  
Old Rover Rd.

Dear Mr. Hackett,

An exhibit recently submitted on your behalf by LDE Engineering, confirms as had been suspected, that the above referenced well was drilled at a location significantly different than where it had been permitted. The drilled location is not compatible with the septic area and house site shown on the Percolation Test Certification Plat approved December 30, 1999.

Submittal of a revised Percolation Certification Plan for signature, showing the actual well location and a modified septic area and house location could resolve the issue, although available choice of house sites would be somewhat restrictive to house site options.

The alternative would be abandoning the well and redrilling at the approved location in order to preserve the currently approved septic area and house site.

Please advise as to how you wish to proceed.

Yours truly, —

Craig Williams, Sanitarian

cc: Wayne Weller  
Joseph Mayne



---

HOWARD COUNTY HEALTH DEPARTMENT

---

Diane L. Matuszak, M.D., M.P.H., County Health Officer

February 11, 2000

James Hackett  
13749 Old Rover Rd.  
West Friendship, Md. 21794

REVISED PLAN  
SIGNED  
3/27/00

Re: Well HO-94-2534  
Parcel 54, Tax Map 15  
Old Rover Rd.

Dear Mr. Hackett,

Please confirm by whatever means appropriate, and advise this office of the actual location of the above referenced well.

The approved site for the well is approximately 70 feet from the back-right corner of the property, but there has been an indication that it may actually be as much as 135 feet from that corner. Not knowing the property boundaries, there is no way I can provide independent confirmation. The well's location of the well must be accurately known in order to make appropriate decisions on the potential location of the house and septic system.

The driller's completion report has recently been received attesting to adequate well construction and quantity of water. Acceptance of that report is contingent upon confirmation that the well is in an appropriate location.

Thank you for your attention to this matter.

Yours truly,

Craig Williams, Sanitarian

cc: Joseph Mayne

✓file

REGION \_\_\_\_\_

AREA \_\_\_\_\_ RATING \_\_\_\_\_

ACKNOWLEDGMENT AND CONTROLS	DATE

Howard County Department of Health  
BUREAU OF ENVIRONMENTAL HEALTH

DISPOSITION	DATE

RECORD OF INVESTIGATION

LOCATION OLD ROVER ~~BEEL~~ ROAD ZIP \_\_\_\_\_

OWNER  OCCUPANT  HACKETT ADDRESS \_\_\_\_\_ PHONE \_\_\_\_\_

COMPLAINANT \_\_\_\_\_ ADDRESS \_\_\_\_\_ PHONE \_\_\_\_\_

REASON FOR INVESTIGATION DETERMINE <sup>EXISTING</sup> CONDITION OF WELL AND ACCEPTABLE SITE LOCATION FOR PERCOLATION TESTING.

RECEIVED BY C. Willson DATE 3/11/87 ASSIGNED TO J.S DATE 3/11/87

DATE OF INVESTIGATION 3/11/87 TIME 2:00 PM WEATHER \_\_\_\_\_

REPORT Small lot not large enough for house & septic field. Mr. Hackett agrees to perc on large 2.4 acre lot. Jack Foyck will do perc tests.

Well on small lot is approx 80 ft deep, drilled with steel casing in well pit. Recommend well be updated to present requirements. Well now being used by Hackett's father next door. Father plans to have new well drilled on his prop. in near future. JS

DATE SUBMITTED 3/11/87 SANITARIAN \_\_\_\_\_

March 3, 1987

Howard County Health Department  
Bureau of Environmental Health  
P.O. Box 476  
Ellicott City, Maryland 21043

Dear Sir:

Attached please find the Application for Percolation Testing and our check in the amount of \$100.00.

Please be advised that we are hoping to buy the two (2) parcels shown on the attached plat from Mr. Louis Hackett. The bank has requested that we obtain a written statement from Howard County that the land is buildable.

Mr. Hackett has advised us that there was a house on the 0.50 acre parcel which burned down in 1972. There is also an existing well on this parcel which was dug in 1950.

Mr. Hackett is very ill and we would like to acquire this land before anything happens to him. Your earliest review of our application is appreciated.

If you require any additional information, please contact me at 992-2400 at work, or 442-2840 at home.

Thank you,

*Ernestine D. Hackett*  
Ernestine D. Hackett

HOWARD COUNTY HEALTH DEPARTMENT  
Completed Septic System

P 49903D A 49571  
DATE 03/01/94

LOCATION <u>13749 Old Rover Road</u>	APPLICATION
<u>Hackett Property</u>	HOLD ( )
LOT _____	APPROVED (✓)
APPLICANT <u>South Carroll Backhoe</u>	REJECTED ( )
OWNER <u>JAMES W. HACKETT</u>	INSTALLATION
PERMITTEE <u>South Carroll Backhoe</u>	HOLD ( )
	APPROVED (✓)
	APPROVED DATE <u>5/2/94</u>

HD-11

JAMES HACKETT INDICATES  
THIS IS PARCEL 59

THAT CONTAINS WELL THAT  
WAS GOING TO BE USED  
FOR PARCEL 58,

BUT NOW HOUSES BUILDING  
MOVED FROM SIMPSON PROPERTY  
NEXT DOOR.

AMES FILE - FURTHER TO RIGHT  
13779 OLD ROVER P49773 IS  
ALSO NOT LOCATED.

MEET J. HACKETT

TO INSURE FOR

POTENTIAL WELL SITE 11/17/97 circa 9:30