

4/15/01 - Layout
5/18/01
10:00

03-317641
PERMIT

JVA Construction
paid 615 P515272

4/26/01
Whitworth

P-515272

SEWAGE DISPOSAL SYSTEM
HOWARD COUNTY HEALTH DEPARTMENT
BUREAU OF ENVIRONMENTAL HEALTH
410-313-2640

A513291

ISSUE DATE 4/26/2001
5/7/2001

INDEXED

APPROVAL DATE 5/18/01
Jason Poe

Installer - J & A Construction Services Inc, PO Box 870 Mt Airy MD 21771 (301) 674-6730 Jason Poe
Keswick Homes, Inc (Ken Carter = Builder)

ADDRESS 8521 Leesburg Pike, Suite 200, Vienna VA 22182 IS PERMITTED TO INSTALL X ALTER
410-988-9437

SUBDIVISION Hawksfield Estates LOT NUMBER 27 ADDRESS 3136 Old Oak Drive
PHONE 703-356-9090

PROPERTY OWNER Keswick Homes PROPERTY OWNER'S ADDRESS 8521 Leesburg Pike, #200
Vienna, VA 22182

SEPTIC TANK CAPACITY 1500 See Note GALLONS
PUMP CHAMBER CAPACITY NA GALLONS

NUMBER OF BEDROOMS 5 amended SRK 5/15/01
SQUARE FEET PER BEDROOM 180

LINEAR FEET OF TRENCH REQUIRED 480 300

~~NOTE: INSTALL ONE 2000 GALLON, TOP SEAMED SEPTIC TANK AND ONE 1000 GALLON TOP SEAMED SEPTIC TANK IN SERIES~~
~~INSTALL TWO 1500 GALLON TOP SEAMED SEPTIC TANKS IN SERIES.~~

TRENCHES: Trenches to be 3 feet wide. Inlet 3 feet below original grade. Bottom maximum depth 5 feet below original grade. 2 feet of stone below distribution box.

LOCATION: Place distribution box 100 feet off front lot line (336.75') and 35 feet off right lot line (273.11') when facing the lot from Old Oak Drive. Run trenches on contour toward the rear of the lot.

If contour allows, trenches should be installed 7' edge to edge (10' center to center) to conserve future septic repair area since ~~480'~~ 300' of trench is a large system.

PLANS APPROVED Ronald J. Pinkley OK SRK 8/13/00 DATE 7/18/00

PERMIT VOID AFTER 2 YEARS

NOTE: CONTRACTOR RESPONSIBLE FOR SCHEDULING A PRE-CONSTRUCTION INSPECTION FOR ALL INSTALLATIONS

BUILDING PERMIT SIGNED AND RETURNED

NOTE: TOP OF SEPTIC TANKS ARE TO BE NO DEEPER THAN 3.0 FEET BELOW FINISH GRADE

NOTE: WATERTIGHT SEPTIC TANKS REQUIRED

NOTE: CLEANOUT REQUIRED EVERY 70 FEET OF SEWER LINE AND/OR AT 90° SWEEPS IN LINES FROM HOUSE TO DRAIN FIELDS, 90° ELBOWS ARE NOT ACCEPTABLE

NOTE: ALL PARTS OF SEPTIC SYSTEMS (I.E. TANK, DISTRIBUTION BOX, DRAINFIELDS) TO BE 100 FEET FROM ANY WATER WELL UNLESS OTHERWISE SPECIFICALLY AUTHORIZED

NOTE: NO ABSORPTION TRENCH TO EXCEED 100 FEET IN LENGTH UNLESS SPECIFICALLY AUTHORIZED

NOTE: ALL PIPE FROM HOUSE TO SEPTIC TANK MUST BE CAST IRON OR SCHEDULE 35/40 PVC OR ABS

NOTE: MANHOLE RISERS REQUIRED ON ALL SEPTIC TANKS AND PUMP CHAMBERS

NOTE: DISTRIBUTION BOXES MUST HAVE BAFFLES

NOTE: IF PUMPED SEPTIC SYSTEM REQUIRED, (1) SEPTIC PUMP DETAIL TO BE PROVIDED BY INSTALLER PRIOR TO ISSUANCE OF SEPTIC PERMIT (2) PUMP PERFORMANCE TEST IS NECESSARY PRIOR TO HEALTH DEPARTMENT APPROVAL OF SEPTIC PERMIT

NEITHER THE HOWARD COUNTY COUNCIL NOR THE HEALTH DEPARTMENT IS RESPONSIBLE FOR THE SUCCESSFUL OPERATION OF ANY SYSTEM
PERMITTEE RESPONSIBLE FOR OBTAINING FINAL APPROVAL ON THIS PERMIT
CALL 410-313-2640 FOR INSPECTION OF SEPTIC SYSTEM

P515272

NOT TO SCALE

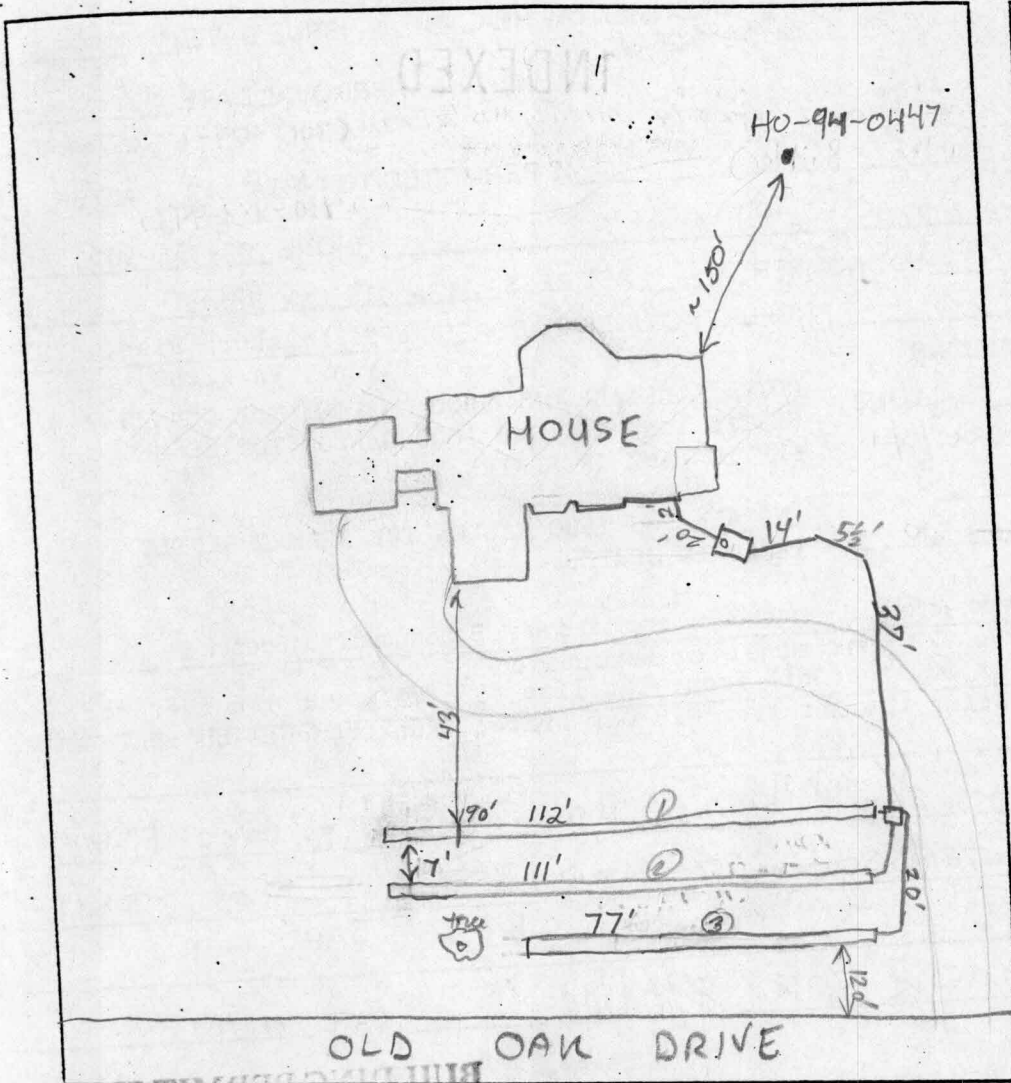

TRENCH DATA

TRENCH WIDTH 3'
 TRENCH INLET DEPTH 3' begin, 2 1/2' ends
 TRENCH BOTTOM DEPTH 5' begin, 4 1/2' end
 DEPTH OF STONE 2'
 NUMBER OF TRENCHES 3
 TOTAL TRENCH LENGTH 300'
 ABSORBENT AREA 900 sq. ft.
 DISTRIBUTION BOX LEVEL ✓ OK
 BAFFLE IN DISTRIBUTION BOX ✓

SEPTIC TANK DATA

SEPTIC TANK 1500 TS GALLONS
 MANHOLE RISER No
 6 INCH INSPECTION PORT Yes

PUMP CHAMBER DATA

PUMP CHAMBER GALLONS NA
 MANHOLE RISER NA
 ALARM NA
 PUMP PERFORMANCE TEST NA

PRE-CONSTRUCTION INSPECTION: 4/25/01 To place distribution box in left upper center of easement. Run trenches in both directions. Make
 INSPECTION COMMENTS: sure tanks aren't where future driveway will be. Stone section of pipe under driveway. (BB) 5/14/01 - BUILDER REPORTS HOUSE IS ONLY 5-BEDROOMS, TOLD HIM TO AMEND IT WITH DILP (SRK) 5/15/01 - AMMENDM RECEIVED, SPECS CHANGED TO 5-BEDROOM HOUSE (SRK) S.T., Home Connection OK, piping & dno OK, First 2 trenches are 100' long, 3rd is partially complete @ 60'. Because tree OK to drop this one @ 77' ft and add 2 (11' + 12') to each of #1 + 2 or make a 25' ft long #4 trench. PIP 5/16/01. 5/18/01 OK to cover ends of three trenches. (BB)

INSPECTOR B. Baker DATE SYSTEM APPROVED 5/18/01