

6/1/01
0 AM - layout
5/2/01 - Trench, 2nd Tank
5/3/01 - Septic Co. PM
5/4/01 - pm final

PERMIT

SEWAGE DISPOSAL SYSTEM
HOWARD COUNTY HEALTH DEPARTMENT
BUREAU OF ENVIRONMENTAL HEALTH
410-313-2640

P 515002
A 45331
ISSUE DATE 3/26/2001
APPROVAL DATE 5/4/01

04-352467

INDEXED

~~Action One Services~~ American P+H IS PERMITTED TO INSTALL X ALTER

ADDRESS 7306 Dogwood Road, Woodlawn, MD 21244 PHONE 443-250-5504

UBDIVISION Stout Property LOT NUMBER .1 ADDRESS 15814 Old Frederick Road

PROPERTY OWNER Joseph M Corona PROPERTY OWNER'S ADDRESS 17419 White Dogwood Ct
Mt Airy, MD 21771

SEPTIC TANK CAPACITY 1250 GALLONS **REQUIRED**

PUMP CHAMBER CAPACITY 1500 GALLONS **← FOR FUTURE pump**

***** TOP SEAMED SEPTIC TANK REQUIRED *****

NUMBER OF BEDROOMS 4

SQUARE FEET PER BEDROOM 210

LINEAR FEET OF TRENCH REQUIRED 280

TRENCHES: Trenches to be 3 feet wide. Inlet 4 feet below original grade. Bottom maximum depth
6 feet below original grade. 2 feet of stone below distribution box.

LOCATION: Beginning from the intersection of the 336.63' and 595.0' lot lines begin
trenches 105 feet down the 336.63' lot line and 120 feet off that same lot line.
Run trenches on contour in both directions. 8/21/00 C.K. (BA)

PLANS APPROVED Amy McMillen DATE 7/26/2000

PERMIT VOID AFTER 2 YEARS

NOTE: CONTRACTOR RESPONSIBLE FOR SCHEDULING A PRE-CONSTRUCTION INSPECTION FOR ALL INSTALLATIONS

NOTE: TOP OF SEPTIC TANKS ARE TO BE NO DEEPER THAN 3.0 FEET BELOW FINISH GRADE

NOTE: WATERTIGHT SEPTIC TANKS REQUIRED

NOTE: CLEANOUT REQUIRED EVERY 70 FEET OF SEWER LINE AND/OR AT 90° SWEEPS IN LINES FROM HOUSE TO DRAIN FIELDS, 90° ELBOWS ARE NOT ACCEPTABLE

NOTE: ALL PARTS OF SEPTIC SYSTEMS (I.E. TANK, DISTRIBUTION BOX, DRAINFIELDS) TO BE 100 FEET FROM ANY WATER WELL UNLESS OTHERWISE SPECIFICALLY AUTHORIZED

NOTE: NO ABSORPTION TRENCH TO EXCEED 100 FEET IN LENGTH UNLESS SPECIFICALLY AUTHORIZED

NOTE: ALL PIPE FROM HOUSE TO SEPTIC TANK MUST BE CAST IRON OR SCHEDULE 35/40 PVC OR ABS

NOTE: MANHOLE RISERS REQUIRED ON ALL SEPTIC TANKS AND PUMP CHAMBERS

NOTE: DISTRIBUTION BOXES MUST HAVE BAFFLES

NOTE: IF PUMPED SEPTIC SYSTEM REQUIRED, (1) SEPTIC PUMP DETAIL TO BE PROVIDED BY INSTALLER PRIOR TO ISSUANCE OF SEPTIC PERMIT (2) PUMP PERFORMANCE TEST IS NECESSARY PRIOR TO HEALTH DEPARTMENT APPROVAL OF SEPTIC PERMIT

NEITHER THE HOWARD COUNTY COUNCIL NOR THE HEALTH DEPARTMENT IS RESPONSIBLE FOR THE
SUCCESSFUL OPERATION OF ANY SYSTEM
PERMITTEE RESPONSIBLE FOR OBTAINING FINAL APPROVAL ON THIS PERMIT
CALL 410-313-2640 FOR INSPECTION OF SEPTIC SYSTEM

515002

NOT TO SCALE

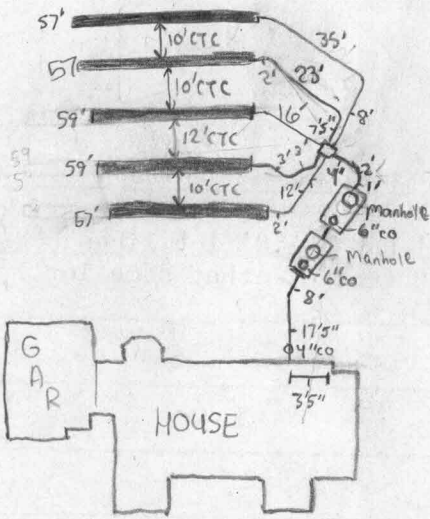

TRENCH DATA

TRENCH WIDTH 3'
 TRENCH INLET DEPTH 4'
 TRENCH BOTTOM DEPTH 6'
 DEPTH OF STONE 2'
 NUMBER OF TRENCHES 5
 TOTAL TRENCH LENGTH 289'
 ABSORBENT AREA 867 ft²
 DISTRIBUTION BOX LEVEL
 BAFFLE IN DISTRIBUTION BOX

SEPTIC TANK DATA

SEPTIC TANK 1250TS GALLONS
 MANHOLE RISER on center
 6 INCH INSPECTION PORT on front

PUMP CHAMBER DATA (Future)

PUMP CHAMBER GALLONS 1500TS
 MANHOLE RISER on rear
 ALARM For future - N/A
 PUMP PERFORMANCE TEST "

H0-94-2618

Old Frederick Road

PRE-CONSTRUCTION INSPECTION: 5/1/01 Unable to use upper part of easement with a gravity system. To install another tank for future pumping. To

INSPECTION COMMENTS: run 5 - 50' to 60' trenches near second septic tank and run them toward left lot line. 7' edge to edge spacing. (B&B)

5/2/01 - OK TO INSTALL A 1250 GALLON ST IN FRONT OF 1500 GALLON PUMP TANK, PLACE BAFFLES IN PUMP TANK BOTH ON INLET & OUTLET W/16" EXT., CHANGE PIPE OUT OF PT TO BE 2-45'S INSTEAD OF A 90 BEND, KEEP DIRT OUT OF STONE! (SRK)

5/3/01 P.M. OK TO COVER FIRST FOUR TRENCHES. 2nd tank not set. DIC

5/4/01 - OK TO COVER ALL WORK (SRK)

INSPECTOR Steven R. Krieg

DATE SYSTEM APPROVED 5/4/01