

APPLICATION

PERCOLATION TESTING

A 516060

P _____

HOWARD COUNTY HEALTH DEPARTMENT
BUREAU OF ENVIRONMENTAL HEALTH
3525-H ELLICOTT MILLS DRIVE/ELLICOTT CITY, MARYLAND 21043
TELEPHONE: 410-313-2640

DISTRICT _____

DATE _____

TO: THE COUNTY HEALTH OFFICER
ELLICOTT CITY, MARYLAND

I HEREBY APPLY FOR THE NECESSARY TEST PRIOR TO APPLICATION FOR PERMIT TO CONSTRUCT (OR RECONSTRUCT) A SEWAGE DISPOSAL SYSTEM.

PROPERTY OWNER Linda Harbin

ADDRESS 15190 Frederick Road, Woodbine, MD 21797 PHONE 410-442-8229

AGENT OR PROSPECTIVE BUYER Heritage Land Development

ADDRESS 3060 Washington Rd., Suite 220, Glenwood, MD 21738 PHONE 410-489-7900

PROPERTY LOCATION:

SUBDIVISION _____ LOT NO. #1 on P.C.

ROAD AND DESCRIPTION _____

Morgan Station Road, Woodbine, MD

TAX MAP NO. 8 PARCEL # 9 (1 of 2 & 2 of 2)

SIZE OF LOT 1 acre TYPE OF BLDG. SFD
(SINGLE FAMILY DWELLING OR COMMERCIAL)

THE SYSTEM INSTALLED UNDER THIS APPLICATION IS ACCEPTABLE ONLY UNTIL PUBLIC FACILITIES BECOME AVAILABLE. I FULLY UNDERSTAND THE FEE CONNECTED WITH THE FILING OF THIS PERC TEST APPLICATION IS NON-REFUNDABLE UNDER ANY CIRCUMSTANCES. I ALSO AGREE TO COMPLY WITH ALL M.O.S.H.A. REQUIREMENTS IN TESTING THIS LOT.

Linda C. Harbin
(SIGNATURE OF APPLICANT)

APPROVED BY _____ FOR _____ DATE _____

DISAPPROVED BY _____ FOR _____ DATE _____

HOLD PENDING FURTHER TESTS _____

REASONS FOR REJECTION OR HOLDING _____

PERCOLATION TEST PLAT/PRELIMINARY PLAT - TITLE OR I.D. # _____ DATE _____

SITE DEVELOPMENT PLAN/FINAL PLAT - TITLE OR I.D. # _____ DATE _____

THIS IS NOT A PERMIT

COUNTY #

SOIL PROFILE

0' (107) (106)
 12" T.S. (107) (106)
 Strong Brn RDBrn SLM w clay skin
 24" powdery fine textured sandy LM micaceous light tan saprolite friable & Rock 15-25%
 14' Bottom (103/104)
 2" Topsoil
 More structured soil same soil type

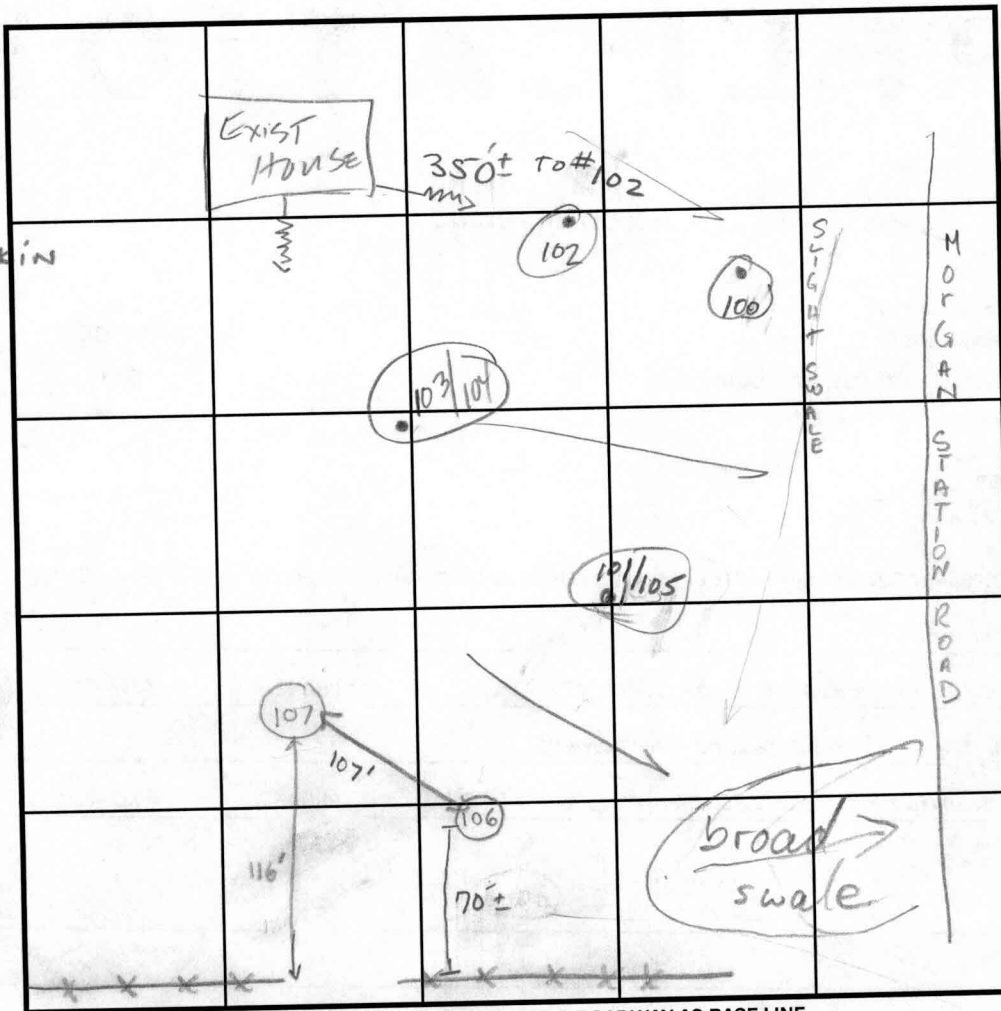

SOIL PROFILE



INDICATE NORTH - NAME ADJOINING ROADWAY AS BASE LINE.

OLD FREDRICK RD (RT 99)

DATE	TEST NO.	DEPTH	PRE-WET		TEST - 1" DROP		TIME
			START	STOP	START	STOP	
11/21/01	107	3'10" S	12:27"	12:28 ⁴⁴	12:28 ⁴⁴	12:30 ⁴⁰	2min
		13'10" D	→				OK
	106	14 1/2' Bottom	SEE SOIL PROFILE 107		Visual		OK
	101/105	3'3" S	1:19 ³⁵	1:20 ¹⁵	1:20 ¹⁵	1:21 ³⁰	
		repour	1:22 ²¹	1:23 ³⁰	1:23 ³⁰	1:25 ³⁰	2min
		12' Bottom	SEE SOIL PROFILE for other holes				
	103/104	Visual	14' Bottom		SEE PROFILE		OK

15-20% mica schist saprolite (structured)
 14' Bottom (101/105)
 Topsoil - 24"
 Structured SLM - SAND
 13' Bottom

REMARKS

TYPE OF SOIL

TESTED BY SRU / KG Bachhoe = Dennis Feaga

ALSO PRESENT Tim Feaga

TRENCH DESIGN DATA: AVG. PERCOLATION TIME

TRENCH WIDTH

INLET DEPTH

MAXIMUM BOTTOM DEPTH

SQ. FT./BEDROOM

APPLICATION

PERCOLATION TESTING

A 516060

P _____

HOWARD COUNTY HEALTH DEPARTMENT
BUREAU OF ENVIRONMENTAL HEALTH
3525-H ELLICOTT MILLS DRIVE/ELLICOTT CITY, MARYLAND 21043
TELEPHONE: 410-313-2640

DISTRICT _____

DATE _____

TO: THE COUNTY HEALTH OFFICER
ELLICOTT CITY, MARYLAND

I HEREBY APPLY FOR THE NECESSARY TEST PRIOR TO APPLICATION FOR PERMIT TO CONSTRUCT (OR RECONSTRUCT) A SEWAGE DISPOSAL SYSTEM.

PROPERTY OWNER Linda Harbin

ADDRESS 15190 Frederick Road, Woodbine, MD 21797 PHONE 410-442-8229

AGENT OR PROSPECTIVE BUYER Heritage Land Development

ADDRESS 3060 Washington Rd., Suite 220, Glenwood, MD 21738 PHONE 410-489-7900

PROPERTY LOCATION:

SUBDIVISION _____ LOT NO. #1 on P.C.

ROAD AND DESCRIPTION _____

Morgan Station Road, Woodbine, MD

TAX MAP NO. 8 PARCEL # 9 (1 of 2 & 2 of 2)

SIZE OF LOT 1 acre TYPE OF BLDG. SFD

(SINGLE FAMILY DWELLING OR COMMERCIAL)

THE SYSTEM INSTALLED UNDER THIS APPLICATION IS ACCEPTABLE ONLY UNTIL PUBLIC FACILITIES BECOME AVAILABLE. I FULLY UNDERSTAND THE FEE CONNECTED WITH THE FILING OF THIS PERC TEST APPLICATION IS NON-REFUNDABLE UNDER ANY CIRCUMSTANCES. I ALSO AGREE TO COMPLY WITH ALL M.O.S.H.A. REQUIREMENTS IN TESTING THIS LOT.

Linda C. Harbin
(SIGNATURE OF APPLICANT)

APPROVED BY _____ FOR _____ DATE _____

DISAPPROVED BY _____ FOR _____ DATE _____

HOLD PENDING FURTHER TESTS _____

REASONS FOR REJECTION OR HOLDING _____

PERCOLATION TEST PLAT/PRELIMINARY PLAT - TITLE OR I.D. # _____ DATE _____

SITE DEVELOPMENT PLAN/FINAL PLAT - TITLE OR I.D. # _____ DATE _____

THIS IS NOT A PERMIT

COUNTY #

SOIL PROFILE

0' (107) (106)
 T.S. Brown
 2" Strong Brn RDBrn
 4" Slnw clay skin
 powdery fine textured sandy tm micaceous light tan
 saprolite friable & Rock 15-25%
 14' Bottom (103/104)
 2" Topsoil
 More structured soil SAME SOIL TYPE
 15-20% mica schist saprolite (structured)
 14' Bottom (103)
 1" Topsoil org brn DENSE SANDY CL Lm
 2 1/2" lt beige lt brn SAND Rock / saprolite ~15%

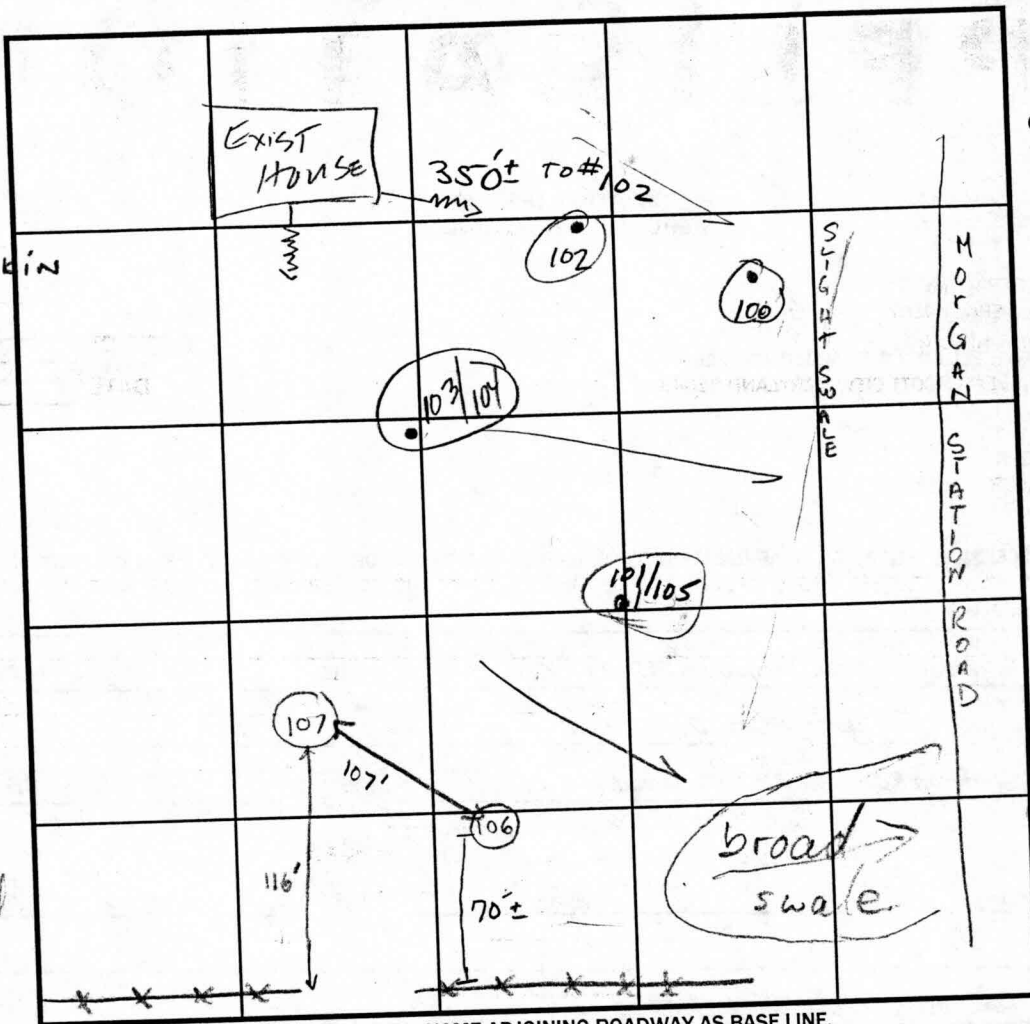

SOIL PROFILE

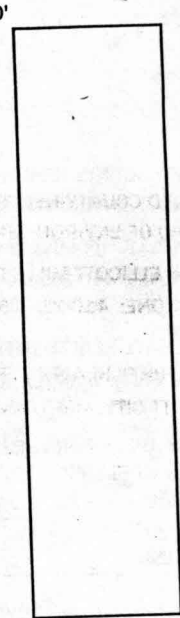

INDICATE NORTH - NAME ADJOINING ROADWAY AS BASE LINE.

OLD FREDRICK RD (RT 99)

DATE	TEST NO.	DEPTH	PRE-WET		TEST - 1" DROP		TIME	
			START	STOP	START	STOP		
11/21/01	107	3'10" S	12:27"	12:28 ⁴⁴	12:28 ⁴⁴	12:30 ⁴⁰	2min	
		13'10" D	—————→					OK
	106	14 1/2' Bottom	SEE SOIL PROFILE #107		Visual		→ OK	
	101/105	3'3" S	1:19 ³⁵	1:20 ¹⁵	1:20 ¹⁵	1:21 ³⁰	2min	
		repour	1:22 ²¹	1:23 ³⁰	1:23 ³⁰	1:25 ³⁰		
		12' Bottom	SEE SOIL PROFILE for other holes					→
	103/104	Visual	14' Bottom		SEE PROFILE		→ OK	

REMARKS

TYPE OF SOIL

TESTED BY SRK/KG

Backhoe = Dennis Feaga

ALSO PRESENT

Tim Feaga

TRENCH DESIGN DATA: AVG. PERCOLATION TIME

TRENCH WIDTH

MAXIMUM BOTTOM DEPTH

SQ. FT./BEDROOM

