

10/21/01
10 A.M. repair

ISSUE DATE: 10/18/2001

PERMIT

P 516075

APPROVAL DATE: 10/23/01

A REPAIR

ON-SITE SEWAGE DISPOSAL SYSTEM HOWARD COUNTY HEALTH DEPARTMENT BUREAU OF ENVIRONMENTAL HEALTH

INDEXED

Charlie's Bobcat Service 02-235617 IS PERMITTED TO INSTALL ALTER

ADDRESS: 2882 Florence Road, Woodbine PHONE NUMBER: 410-442-8290

SUBDIVISION: _____ LOT NUMBER: B

ADDRESS: 8283 Old Frederick Road PROPERTY OWNER: Earl Palmer

SEPTIC TANK CAPACITY (GALLONS): _____
PUMP CHAMBER CAPACITY (GALLONS): N/A
Per Jean Reed public water & sewer is not available

NUMBER OF BEDROOMS: 3
(SRK) 10/17/01

SQUARE FEET PER BEDROOM: 180

LINEAR FEET OF TRENCH REQUIRED: 80 *~ 560 sq ft of absorption area*

TRENCHES:	Trench to be <u>2</u> feet wide. Inlet <u>2</u> feet below original grade. Bottom maximum depth <u>9</u> feet below original grade. Effective area begins at <u>2</u> feet below original grade. <u>7</u> feet of stone below distribution pipe.
LOCATION:	
PURPOSE:	Existing septic system is failing. Call when ground is opened so sanitarian can recommend repair.

PLANS APPROVED: Steven Krieg DATE: 10/17/01

- NOTE: PERMIT VOID AFTER 2 YEARS
- NOTE: CONTRACTOR RESPONSIBLE FOR SCHEDULING A PRE-CONSTRUCTION INSPECTION FOR ALL INSTALLATIONS
- NOTE: WATERTIGHT SEPTIC TANKS REQUIRED
- NOTE: ALL PARTS OF SEPTIC SYSTEM SHALL BE 100 FEET FROM ANY WATER WELL
- NOTE: MANHOLE RISERS REQUIRED ON ALL SEPTIC TANKS AND PUMP CHAMBERS

NEITHER THE HOWARD COUNTY COUNCIL NOR THE HEALTH DEPARTMENT IS RESPONSIBLE FOR THE SUCCESSFUL OPERATION OF ANY SYSTEM PERMITTEE RESPONSIBLE FOR OBTAINING FINAL APPROVAL ON THIS PERMIT CALL 410-313-2640 FOR INSPECTION OF SEPTIC SYSTEM

P 516075

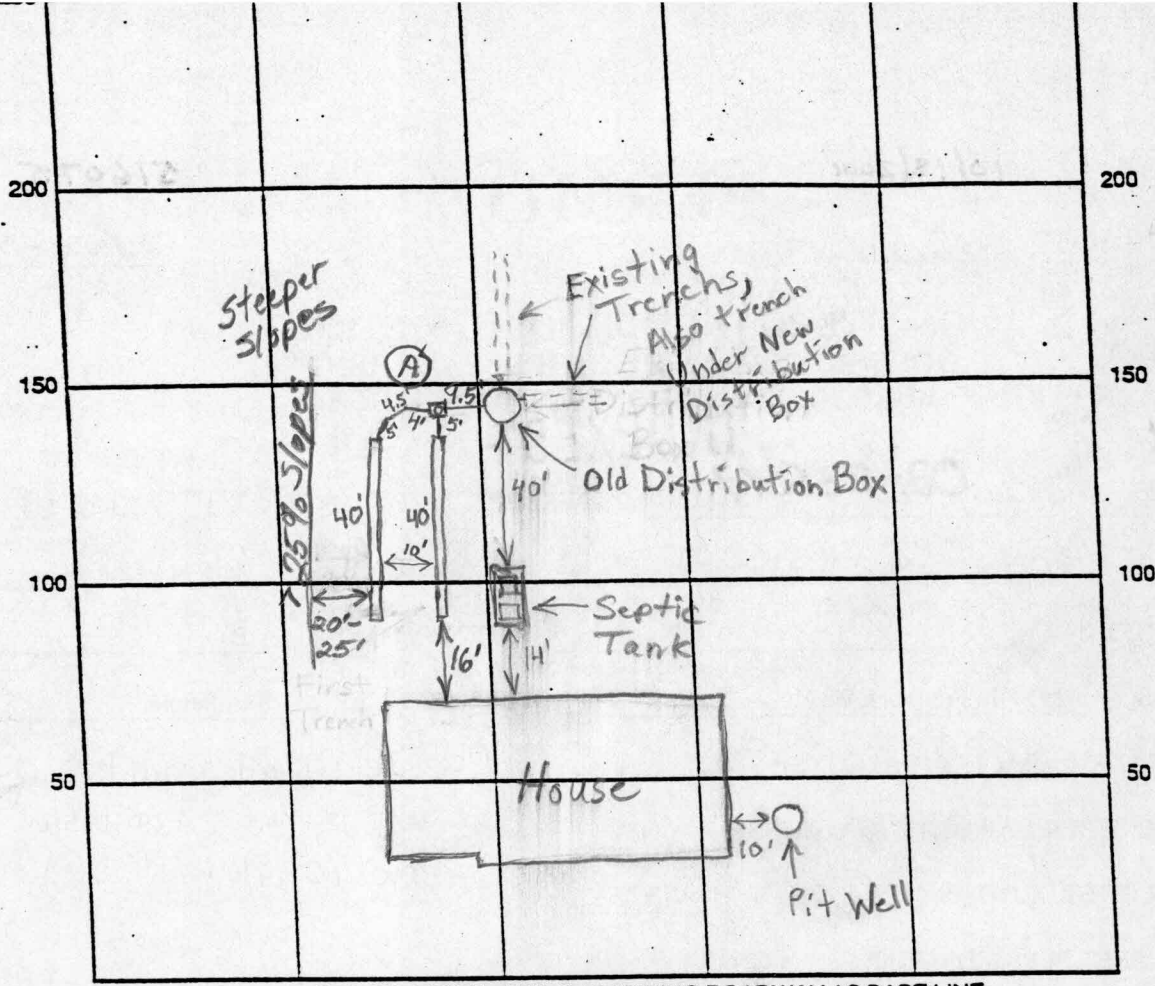

(A)
 4'
 Topsoil and Red Br Sa Cl Loam
 13'
 Med Br Sa Loam w/ 10% Rock

INDICATE NORTH - NAME ADJOINING ROADWAY AS BASE LINE

Old Frederick Road

SEPTIC TANK LEVEL _____ CLEANOUTS _____

REMARKS: 10/22/01 To install 2-40' trenches and distribution box. Trenches to run towards house. (BB) 10/22/01 First trench started (BB) 10/23/01 Contour goes uphill towards house. Trenches 13' deep at closest point to house. Trenches 9' deep near distribution box. Top trench ~ 80' from well at point closest to house. O.K. to cover. (BB)

DATE SYSTEM APPROVED 10/23/01 INSPECTOR B. Baker