

DEPARTMENT OF INSPECTIONS, LICENSES AND PERMITS  
 3430 COURT HOUSE DRIVE  
 ELLICOTT CITY, MD 21043  
 PERMITS (410)313-2455 INSPECTIONS (410)313-1810  
 AUTOMATED INFORMATION (410) 313-3800

# HOWARD COUNTY PERMIT APPLICATION

PERMIT NUMBER  
 B0027096 IX

Building Address 1749 Oakdale DR  
Woodstock, MD 21163

Suite/Apt. #:          SDP/WP/Petition #:         

Census Tract 6050 Subdivision Monticello

Section          Area          Lot 21

Tax Map 8 Parcel 110 Grid 18

Zoning RC Map Coordinates 9E12 Lot size 1,148Ac

Property Owner's Name D. R. Horton Custom Homes  
1370 Piccard Dr., St. 230  
Rockville, MD 20850

Address \_\_\_\_\_  
 City \_\_\_\_\_ State \_\_\_\_\_ Zip Code \_\_\_\_\_

Home Phone \_\_\_\_\_ Work Phone 301-670-6144

Applicant's Name & Mailing Address, (if other than stated hereon):  
Victoria Meyer  
Maryland Bldg. Permits, Inc.

Phone 410-602-8779 Fax \_\_\_\_\_

Existing Use Vacant Lot

Proposed Use Single Fam. Dwell.

Estimated Construction Cost \$ 200,000

Description of Work Custom Martha Wash.  
2 stories w/ Full Fin. Bsmt., 3 Cargar.  
Side Sunrm. FP, and Rear Sunrm (4BR)

Contractor Company D. R. Horton Custom Homes  
1370 Piccard Dr., St. 230  
Rockville, MD 20850

Contact Person \_\_\_\_\_  
 Address \_\_\_\_\_  
 City \_\_\_\_\_ State \_\_\_\_\_ Zip Code \_\_\_\_\_

License No. \_\_\_\_\_  
 Phone 301-670-6144 Fax \_\_\_\_\_

Occupant or Tenant See Prop. DWAGA - W

Contact Name \_\_\_\_\_  
 Address \_\_\_\_\_  
 City \_\_\_\_\_ State \_\_\_\_\_ Zip Code \_\_\_\_\_

Phone \_\_\_\_\_ Fax \_\_\_\_\_

Engineer or Architect Company BERKMAN, Eng

Contact Person John CARNEY

Address 5480 Balto. National Pike  
 City ELLICOTT CITY State MD Zip Code 21043

Phone 410-465-6105 Fax \_\_\_\_\_

**BUILDING DESCRIPTION - COMMERCIAL**

**BUILDING DESCRIPTION - RESIDENTIAL**

Building Characteristics	Utilities
Height: _____	Water Supply: _____ <input type="checkbox"/> Public <input type="checkbox"/> Private
No. of stories: _____	Sewage Disposal: _____ <input type="checkbox"/> Public <input type="checkbox"/> Private
Gross area, sq. ft. per floor: _____	Electric Yes <input type="checkbox"/> No <input type="checkbox"/> Gas Yes <input type="checkbox"/> No <input type="checkbox"/>
Use group: _____	Heating System: _____ <input type="checkbox"/> Electric <input type="checkbox"/> Oil <input type="checkbox"/> <input type="checkbox"/> Natural Gas <input type="checkbox"/> <input type="checkbox"/> Propane Gas <input type="checkbox"/>
Construction type: _____ <input type="checkbox"/> Reinforced Concrete <input type="checkbox"/> Structural Steel <input type="checkbox"/> Masonry <input type="checkbox"/> Wood Frame <input type="checkbox"/> State Certified Modular	Sprinkler system: <u>N/A</u> <input type="checkbox"/> <input type="checkbox"/> Full <input type="checkbox"/> Partial <input type="checkbox"/> Other Suppression <input type="checkbox"/> # of Heads _____

Building Characteristics	Utilities
SF Dwelling <input checked="" type="checkbox"/> SF Townhouse <input type="checkbox"/> <u>Depth</u> <u>Width</u>	Water Supply: _____ <input type="checkbox"/> Public <input checked="" type="checkbox"/> Private
1st floor: _____	Sewage Disposal: _____ <input type="checkbox"/> Public <input checked="" type="checkbox"/> Private
2nd floor: _____	Electric Yes <input type="checkbox"/> No <input type="checkbox"/> Gas Yes <input type="checkbox"/> No <input type="checkbox"/>
Basement: _____	Heating System: _____ <input type="checkbox"/> Electric <input type="checkbox"/> Oil <input type="checkbox"/> <input type="checkbox"/> Natural Gas <input checked="" type="checkbox"/> <input type="checkbox"/> Propane Gas <input type="checkbox"/>
Finished Basement <input checked="" type="checkbox"/> Unfinished Basement <input type="checkbox"/> <input type="checkbox"/> Crawl space <input type="checkbox"/> Slab on Grade <input type="checkbox"/> No. of Bedrooms <u>4</u>	Sprinkler system: <u>N/A</u> <input type="checkbox"/> <input type="checkbox"/> NFPA #13D <input type="checkbox"/> NFPA #13R <input type="checkbox"/> Other: _____
Multi-family dwellings: No. of efficiency units: _____ No. of 1 BR units: _____ No. of 2 BR units: _____ No. of 3 BR units: _____	Other: _____
Other Structure: _____ Dimensions: _____ Footings: _____ Roof: _____ <input type="checkbox"/> State Certified Modular <input type="checkbox"/> Manufactured Home	

THE UNDERSIGNED HEREBY CERTIFIES AND AGREES AS FOLLOWS: (1) THAT HE/SHE IS AUTHORIZED TO MAKE THIS APPLICATION; (2) THAT THE INFORMATION IS CORRECT; (3) THAT HE/SHE WILL COMPLY WITH ALL REGULATIONS OF HOWARD COUNTY WHICH ARE APPLICABLE THEREIN; (4) THAT HE/SHE WILL PERFORM NO WORK ON THE ABOVE REFERENCED PROPERTY NOT SPECIFICALLY DESCRIBED IN THIS APPLICATION; (5) THAT HE/SHE GRANTS COUNTY OFFICIALS THE RIGHT TO ENTER ONTO THIS PROPERTY FOR THE PURPOSE OF INSPECTING THE WORK PERMITTED AND POSTING NOTICES.

Applicant's Signature V. Meyer  
 Title/Company \_\_\_\_\_

Print Name Victoria Meyer  
 Date 10/23/00

Checks payable to: DIRECTOR OF FINANCE OF HOWARD COUNTY  
 \*\* PLEASE WRITE NEATLY AND LEGIBLY. \*\*  
 - FOR OFFICE USE ONLY -

AGENCY	DATE	SIGNATURE APPROVAL
Land Development DPZ		
State Highways		
Building Official		
Dev. Engineering DPZ	<u>11/14/00</u>	<u>M. R. Klein</u>
Health		
Fire Protection		

Is Sediment Control approval required prior to issuance?  
 YES  NO

DPZ SETBACK INFORMATION	PROPERTY ID#:
Front: _____	Filing fee \$ <u>25</u>
Rear: _____	Permit fee \$ _____
Side: _____	Excise tax \$ _____
Side St.: _____	Sub-total paid \$ _____
All minimum setbacks met? YES <input type="checkbox"/> NO <input type="checkbox"/>	Add'l permit fee \$ _____
Is Entrance Permit required? YES <input type="checkbox"/> NO <input type="checkbox"/>	TOTAL FEES \$ _____
Historic District? YES <input type="checkbox"/> NO <input type="checkbox"/>	Balance due \$ _____
Lot Coverage for New Town Zone _____	Check # <u>401096</u>
SDP/Red-line approval date _____	Validation # _____
Accepted by _____	

CONTINGENCY CONSTRUCTION START:   
 ONE STOP SHOP:

Distribution of Copies- White: Building Official Green: LDD, DPZ Yellow: DED, DPZ Pink: Health Gold: SHA

a:\permit.fm Rev. 10/13/98

*Rec'd  
 HCHD  
 10/24/00*

Total linear feet of trench required 240 feet  
 Width of trench(es) 3 feet  
 Depth of trench(es) 5 feet  
 Depth of stone required below distribution pipe 2 feet

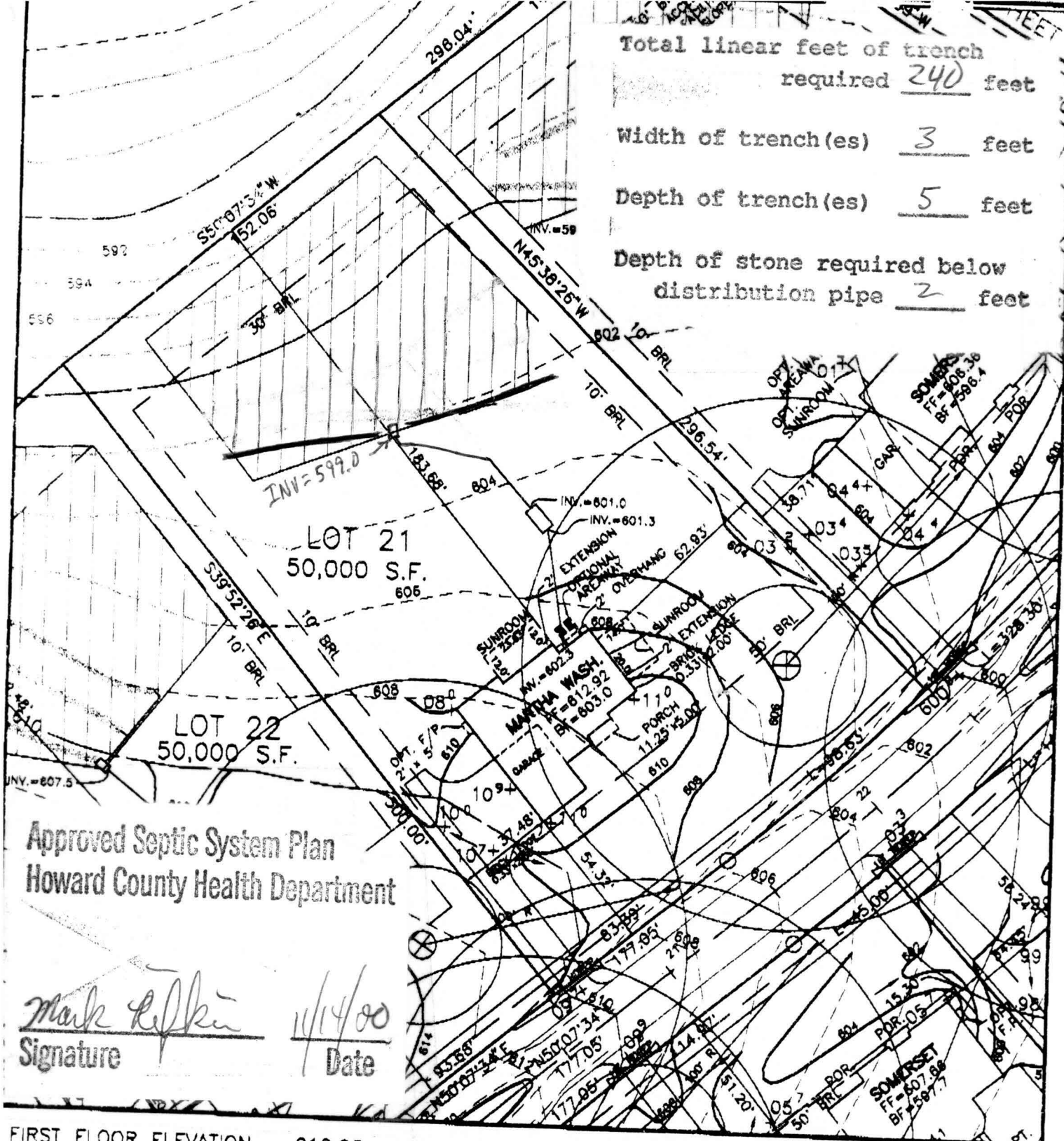

Approved Septic System Plan  
 Howard County Health Department

*Mark Kiffin* 11/14/00  
 Signature Date

FIRST FLOOR ELEVATION = 612.92  
 BASEMENT ELEVATION = 603.0  
 SPOT ELEVATION AT GARAGE = 610.9

**BENCHMARK**  
 ENGINEERS • LAND SURVEYORS • PLANNERS  
**ENGINEERING, INC.**

9480 BALTIMORE NATIONAL PIKE • SUITE 418 • ELLICOTT CITY, MD 21043  
 PHONE: 410-465-6105 FAX: 410-465-6644

SLOPE OF DRIVEWAY = N/A  
 NUMBER OF RISERS IN GAR. = 3  
 NUMBER OF RISERS ON LEAD WALK = 3

**MONTICELLO**  
 LOT 21 - REVISED

FOURTH ELECTION DISTRICT  
 HOWARD COUNTY, MARYLAND  
 SCALE: 1" = 50' DATE: 9/6/00