

TOP OF FOUNDATION WALL ELEV. = 630.3'
 OFFSET DIMENSIONS TO PROPERTY LINES ARE ± 1.0'

SURVEYOR'S CERTIFICATE

I HEREBY CERTIFY TO THE BEST OF MY PROFESSIONAL KNOWLEDGE, INFORMATION AND BELIEF, THAT THE DIMENSIONS OF THE BUILDING WALLS SHOWN HEREON ARE CORRECT; THAT THEY ARE BASED ON A FIELD RUN SURVEY PERFORMED BY BENCHMARK ENGINEERING, INC. ON 7/20/01; AND THAT THE PROPERTY OUTLINE SHOWN HEREON IS BASED ON THE PLAT PREPARED BY BENCHMARK ENGINEERING, INC. ENTITLED "MONTICELLO, LOTS 1-50, PRESERVATION PARCELS A-D AND NN-BUILDABLE PARCEL E", AND RECORDED AMONG THE LAND RECORDS OF HOWARD COUNTY AS PLAT No. 14087.

David M. Harris
 DAVID M. HARRIS
 REGISTERED PROFESSIONAL LAND SURVEYOR
 MD REG No. 10978
 FOR BENCHMARK ENGINEERING, INC.
 MD REG. No. 351
 RECORD PLAT No. 14087
 FEMA FIRM No. 240044 0009 B
 ZONE: C
 DATED: 12/04/86

BENCHMARK

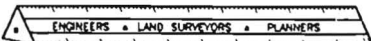

ENGINEERING, INC.

8480 BALTIMORE NATIONAL PIKE ▲ SUITE 418
 ELLICOTT CITY, MD 21043
 PHONE: 410-465-6105 FAX: 410-465-6644

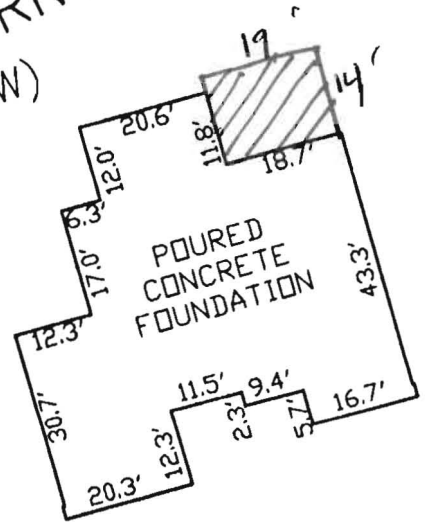

FOUNDATION DETAIL

SCALE: 1" = 30'

**WALL CHECK
 MONTICELLO**

LOT No. 23

1741 OAKDALE DRIVE

4TH ELECTION DISTRICT

HOWARD COUNTY, MARYLAND

SCALE: 1" = 50' DATE: 7/20/01

BENCHMARK

ENGINEERS Δ LAND SURVEYORS Δ PLANNERS

ENGINEERING, INC.

480 BALTIMORE NATIONAL PIKE Δ SUITE 418
 ELLICOTT CITY, MARYLAND 21043

PHONE: 410-485-6105 Δ FAX: 410-485-8644

EMAIL: benchmrk@cais.com

EX. CLEARANCE
 DIVERSION DIKE
 INSTALLED UNDER F-39
 TO BE REMOVED

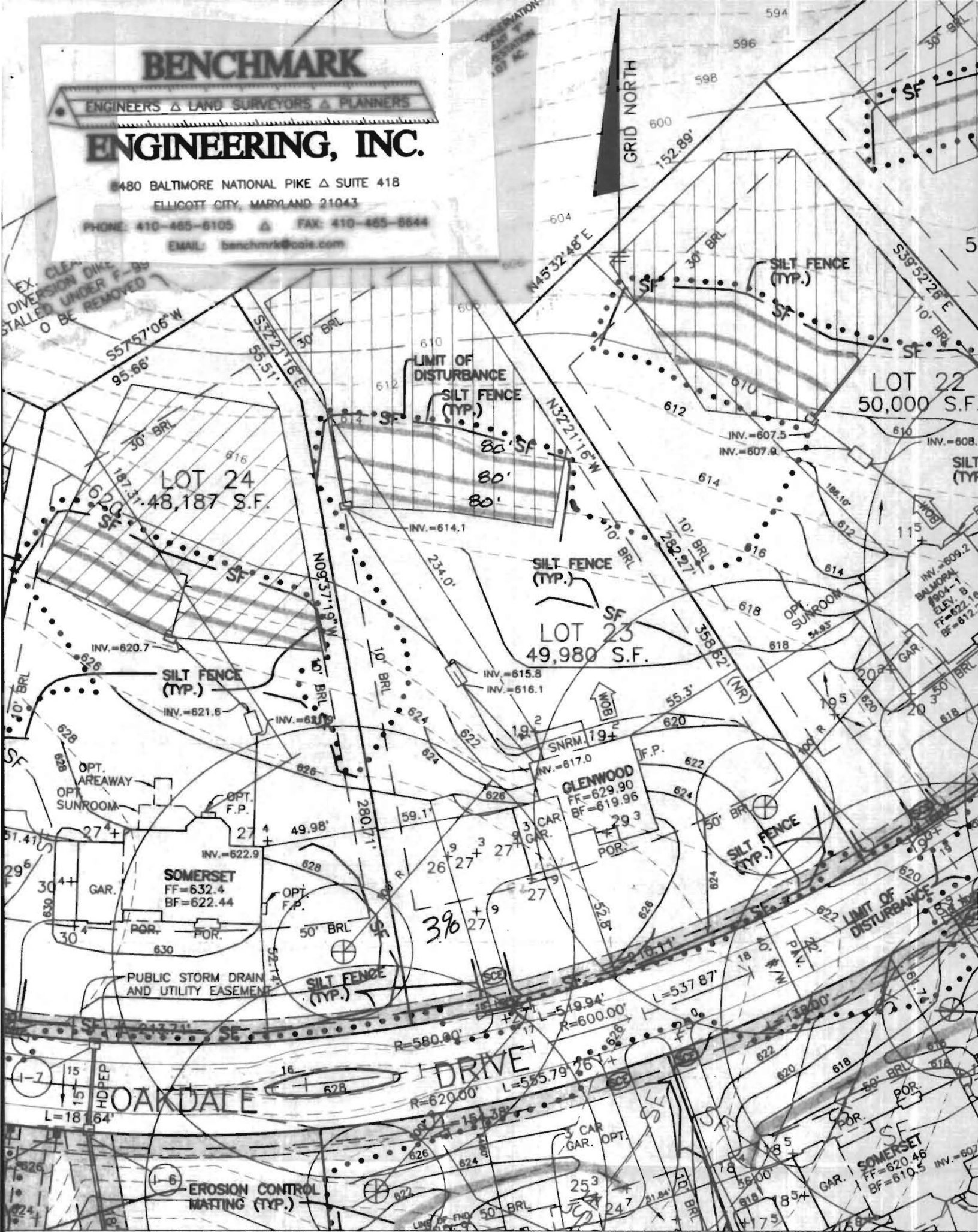

Approved Septic System Plan
 Howard County Health Department

Total linear feet of trench
 required 240 feet

Width of trench(es) 2.0 feet

Depth of trench(es) 6.0 feet

Amy McNeil 6/1/01
 Signature Date

Depth of stone required below
 distribution pipes: 3.0 feet

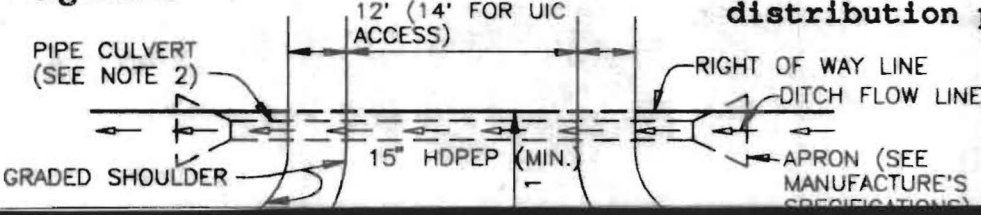

1. DRIVEWAY MUST BE PAVED FROM EDGE OF ROAD TO RIGHT OF WAY LINE USING STANDARD PAVING SECTION P-1 AS SHOWN ON S'D NO. OR ALTERNATIVE SECTION EQUAL TO OR BETTER THAN P-1, AS APPROVED BY D.P.W.
2. DRAINAGE CULVERT SHALL BE SIZED FOR A YEAR FREQUENCY STORM.