

8/8/01
Layout
a.s.m.

ISSUE DATE: 8/6/2001

PERMIT

P 515973-C

APPROVAL DATE: 9/20/01

A 59914-B

ON-SITE SEWAGE DISPOSAL SYSTEM HOWARD COUNTY HEALTH DEPARTMENT BUREAU OF ENVIRONMENTAL HEALTH

04-363701

Fogle's Septic Clean, Inc. IS PERMITTED TO INSTALL ALTER

ADDRESS: 580 Obrecht Road, Sykesville PHONE NUMBER: 410-795-5670

SUBDIVISION: Monticello LOT NUMBER: 26

ADDRESS: 1729 Oakdale Drive PROPERTY OWNER: D.R. Horton Bldrs.

SEPTIC TANK CAPACITY (GALLONS): 1250

PUMP CHAMBER CAPACITY (GALLONS): N/A

NUMBER OF BEDROOMS: 4

SQUARE FEET PER BEDROOM: 180

LINEAR FEET OF TRENCH REQUIRED: 180

TRENCHES:	Trench to be 2.0 feet wide. Inlet 3.5 feet below original grade. Bottom maximum depth 7.5 feet below original grade. Effective area begins at 3.5 feet below original grade. 4.0 feet of stone below distribution pipe.
LOCATION:	Starting from the left rear lot corner, place the distribution box 110 feet down the left lot line and 40 feet off this same lot line. Run (3) 60-foot trenches on contour in either direction.
NOTES:	

PLANS APPROVED: MER OUSRU 7/22/01 DATE: 4/20/01

- NOTE: PERMIT VOID AFTER 2 YEARS
- NOTE: CONTRACTOR RESPONSIBLE FOR SCHEDULING A PRE-CONSTRUCTION INSPECTION FOR ALL INSTALLATIONS
- NOTE: WATERTIGHT SEPTIC TANKS REQUIRED
- NOTE: ALL PARTS OF SEPTIC SYSTEM SHALL BE 100 FEET FROM ANY WATER WELL
- NOTE: MANHOLE RISERS REQUIRED ON ALL SEPTIC TANKS AND PUMP CHAMBERS

NEITHER THE HOWARD COUNTY COUNCIL NOR THE HEALTH DEPARTMENT IS RESPONSIBLE FOR THE SUCCESSFUL OPERATION OF ANY SYSTEM PERMITTEE RESPONSIBLE FOR OBTAINING FINAL APPROVAL ON THIS PERMIT CALL 410-313-2640 FOR INSPECTION OF SEPTIC SYSTEM

515973C

NOT TO SCALE

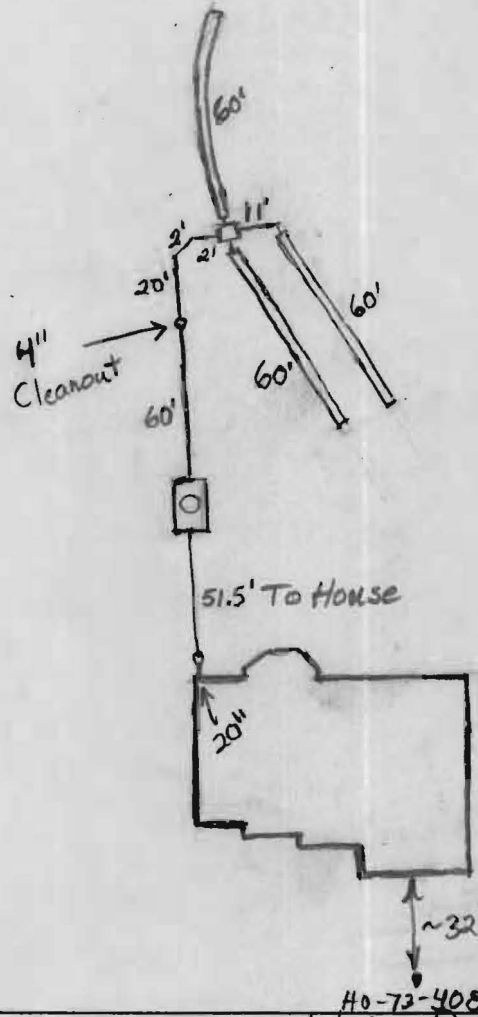

TRENCH DATA

TRENCH WIDTH 2'
 TRENCH INLET DEPTH 3.5'
 TRENCH BOTTOM DEPTH 7.5'
 DEPTH OF STONE 4.0'
 NUMBER OF TRENCHES 3
 TOTAL TRENCH LENGTH 180
 ABSORBENT AREA 720 sq ft
 DISTRIBUTION BOX LEVEL Yes
 BAFFLE IN DISTRIBUTION BOX Yes

SEPTIC TANK DATA

SEPTIC TANK 1250 TS GALLONS
 MANHOLE RISER Yes
 6 INCH INSPECTION PORT ?

PUMP CHAMBER DATA N/A

~~PUMP CHAMBER GALLONS _____~~
~~MANHOLE RISER _____~~
~~ALARM _____~~
~~PUMP PERFORMANCE TEST _____~~

H0-73-4087
Oakdale Drive

PRE-CONSTRUCTION INSPECTION: 8/8/01 System staked. To install as per B.P. plan, although contour slightly different. (BB)

INSPECTION COMMENTS: 8/9/01 System satisfactory. O.K. to cover. Need house connection. (BB) 8/28/01 WPI OK; keeping ex. well (KB)

9/19/01 - HOUSE CONN. VERIFIED TO HAVE BEEN MADE PER FOGLES (SRK)

INSPECTOR B. Baker, SRK DATE SYSTEM APPROVED 9/20/01