

GPA G Health Dept

DEPARTMENT OF INSPECTIONS, LICENSES, AND PERMITS 3430 COURT HOUSE DRIVE ELLICOTT CITY, MD 21043 PERMITS (410) 313-2455 INSPECTIONS (410) 313-1810 AUTOMATED INFORMATION (410) 313-3800	<h2 style="margin: 0;">HOWARD COUNTY PERMIT APPLICATION</h2>	PERMIT NUMBER B1000116
--	--	--

Building Address <u>14334 Musgrove Farm Ct</u> <u>Glenwood, MD 21738</u>	Property Owner's Name <u>Ryan Homes</u> Address <u>6031 University Blvd, Suite 250</u>
Suite/Apt. #: _____ SDP/WP/Petition #: _____ Census Tract <u>605601</u> Subdivision <u>Musgrove Farm (MF)</u> Section _____ Area _____ Lot <u>9</u> Tax Map <u>21</u> Parcel _____ Grid <u>21-12</u>	City <u>Ellicott City</u> State <u>MD</u> Zip Code <u>21043</u> Phone <u>410.796.0980</u> Phone _____ Applicant's Name & Mailing Address, (if other than stated heron): Phone _____ Fax _____
Zoning RR-DEO Map Coordinates _____ Lot size _____	Existing Use <u>Vacant Lot</u> Proposed Use <u>New - Single Family Home</u> Estimated Construction Cost <u>\$250,000</u> Description of Work <u>Model Courtland w/Morn Room</u> <u>2 Story, Full Bsmt, 11R, 2FB, 1HB</u> <u>& Garage (4-BR) w/Opt FP</u>

Occupant or Tenant <u>Ryan Homes</u> Contact Name <u>Kevin Bowser</u> Address <u>6031 University Blvd, Suite 250</u> City <u>Ellicott City</u> State <u>MD</u> Zip Code <u>21043</u> Phone <u>410.796.0980</u> Fax <u>410.796.7094</u>	Contractor Company <u>Ryan Homes</u> Contact Person <u>Kevin Bowser</u> Address <u>6031 University Blvd, Suite 250</u> City <u>Ellicott City</u> State <u>MD</u> Zip Code <u>21043</u> License No. <u>56</u> Phone <u>410.796.0980</u> Fax <u>410.796.7094</u>
--	---

Engineer or Architect Company <u>Gutschick Little & Weber</u> Contact Person _____ Address <u>3909 National Drive, Suite 250</u> City <u>Burtonsville</u> State <u>MD</u> Zip Code <u>20866</u> Phone <u>301.421.4024</u> Fax <u>301.421.4186</u>

BUILDING DESCRIPTION - <u>COMMERICAL</u>	BUILDING DESCRIPTION - <u>RESIDENTIAL</u>
---	--

Building Characteristics	Utilities	Building Characteristics	Utilities												
Height: _____ No. of stories: _____ Gross area, sq. ft. per floor: _____ Use Group: _____ Construction Type: <input type="checkbox"/> Reinforced Concrete <input type="checkbox"/> Structural Steel <input type="checkbox"/> Masonry <input type="checkbox"/> Wood Frame <input type="checkbox"/> State Certified Modular	Water Supply: <input type="checkbox"/> Public <input type="checkbox"/> Private Sewer Disposal: <input type="checkbox"/> Public <input type="checkbox"/> Private Electric Yes <input type="checkbox"/> No <input type="checkbox"/> Gas Yes <input type="checkbox"/> No <input type="checkbox"/> Heating System: Electric <input type="checkbox"/> Oil <input type="checkbox"/> Natural Gas <input type="checkbox"/> Propane Gas <input type="checkbox"/> Sprinkler System: N/A <input type="checkbox"/> <input type="checkbox"/> Full <input type="checkbox"/> Partial <input type="checkbox"/> Other Suppression # of Heads _____	SF Dwelling <input checked="" type="checkbox"/> SF Townhouse <input type="checkbox"/> <table style="width:100%; border-collapse: collapse;"> <tr> <td style="text-align: right;">1st Floor:</td> <td style="text-align: center;">Depth</td> <td style="text-align: center;">Width</td> </tr> <tr> <td style="text-align: right;">2nd Floor:</td> <td style="text-align: center;">52</td> <td style="text-align: center;">56</td> </tr> <tr> <td style="text-align: right;">Basement:</td> <td style="text-align: center;">32</td> <td style="text-align: center;">56</td> </tr> <tr> <td style="text-align: right;">Basement:</td> <td style="text-align: center;">44</td> <td style="text-align: center;">56</td> </tr> </table> Finished Basement <input checked="" type="checkbox"/> Unfinished Basement <input type="checkbox"/> Crawlspace <input type="checkbox"/> Slab on Grade <input type="checkbox"/> No. of Bedrooms: <u>4</u> Height: <u>30</u> Multi-family dwellings: No. of efficiency units: _____ No. of 1 BR units: _____ No. of 2 BR units: _____ No. of 3 BR units: _____ Other Structure: _____ Dimensions: _____ Footings: _____ Roof Height: _____ <input type="checkbox"/> State Certified Modular <input type="checkbox"/> Manufactured Home	1 st Floor:	Depth	Width	2 nd Floor:	52	56	Basement:	32	56	Basement:	44	56	Water Supply: <input type="checkbox"/> Public <input checked="" type="checkbox"/> Private Sewer Disposal: <input type="checkbox"/> Public <input checked="" type="checkbox"/> Private Electric Yes <input checked="" type="checkbox"/> No <input type="checkbox"/> Gas Yes <input checked="" type="checkbox"/> No <input type="checkbox"/> Heating System: Electric <input type="checkbox"/> Oil <input type="checkbox"/> Natural Gas <input checked="" type="checkbox"/> Propane Gas <input type="checkbox"/> Sprinkler System: N/A <input type="checkbox"/> <input type="checkbox"/> NFPA #13D <input type="checkbox"/> NFPA #13R <input type="checkbox"/> Other: _____
1 st Floor:	Depth	Width													
2 nd Floor:	52	56													
Basement:	32	56													
Basement:	44	56													

THE UNDERSIGNED HEREBY CERTIFIES AND AGREES AS FOLLOWS: (1) THAT HE/SHE IS AUTHORIZED TO MAKE THIS APPLICATION; (2) THAT THE INFORMATION IS CORRECT; (3) THAT HE/SHE WILL COMPLY WITH ALL REGULATIONS OF HOWARD COUNTY WHICH ARE APPLICABLE THERETO; (4) THAT HE/SHE WILL PERFORM NO WORK ON THE ABOVE REFERENCED PROPERTY NOT SPECIFICALLY DESCRIBED IN THIS APPLICATION; (5) THAT HE/SHE GRANTS COUNTY OFFICIALS THE RIGHT TO ENTER ONTO THIS PROPERTY FOR THE PURPOSE OF INSPECTING THE WORK PERMITTED AND POSTING NOTICES.

 Applicant's Signature	<u>Ben Mucci</u> Print Name
<u>Project Manager</u> Title/Company	<u>04/15/2010</u> Date

Checks payable: **DIRECTOR OF FINANCE OF HOWARD COUNTY**
 ** PLEASE WRITE NEATLY AND LEGIBLY. **

- FOR OFFICE USE ONLY -

AGENCY	DATE	SIGNATURE	DPZ SETBACK INFORMATION	PROPERTY ID#
APPROVAL			Front: _____	Filing Fee \$ _____
Land Development DPZ			Rear: _____	Permit Fee \$ _____
State/Highways			Side: _____	Excise tax \$ _____
Building Official			Side St. _____	Add'l per fee \$ _____
Dev. Engineering DPZ			All minimum setbacks met?	TOTAL FEES \$ _____
Health	<u>5-17-10</u>	<u>[Signature]</u>	YES <input type="checkbox"/> NO <input type="checkbox"/>	Sub-total paid \$ _____
Fire Protection			Is Entrance Permit required?	Balance due \$ _____
Is Sediment Control Approval required prior to issuance?			YES <input type="checkbox"/> NO <input type="checkbox"/>	Check # _____
			Historic District? YES <input type="checkbox"/> NO <input type="checkbox"/>	Validation # _____
			Lot coverage for New Town Zone _____	
			SDP/Red-line approval date _____	Accepted by _____
CONTINGENCY CONSTRUCTION START: <input type="checkbox"/> ONE STOP SHOP: <input type="checkbox"/>				
Distribution of Copies - White: Building Official Green: LDD DPZ Yellow: DED DPZ Pink: Health Gold: SHA				

SEDIMENT CONTROL NOTES

- A MINIMUM OF 24 HOURS NOTICE MUST BE GIVEN TO THE HOWARD COUNTY OFFICE OF INSPECTION AND PERMITS PRIOR TO THE START OF ANY CONSTRUCTION. (410) 313-1855
- ALL VEGETATIVE AND STRUCTURAL PRACTICES ARE TO BE INSTALLED ACCORDING TO THE PROVISIONS OF THIS PLAN AND ARE TO BE IN CONFORMANCE WITH THE 1994 MARYLAND STANDARDS AND SPECIFICATIONS FOR SOIL EROSION AND SEDIMENT CONTROL, AND REVISIONS THEREOF.
- FOLLOWING INITIAL SOIL DISTURBANCE OR REDISTURBANCE, PERMANENT OR TEMPORARY STABILIZATION SHALL BE COMPLETED WITHIN: A) 7 CALENDAR DAYS FOR ALL PERIMETER SEDIMENT CONTROL STRUCTURES, DIMES AND PERIMETER SLOPES AND ALL SLOPES GREATER THAN 3:1, B) 14 DAYS AS TO ALL OTHER DISTURBED OR GRADED AREAS ON THE PROJECT SITE.
- ALL SEDIMENT TRAPS/BASINS SHOWN MUST BE FENCED AND WARNING SIGNS POSTED AROUND THEIR PERIMETER IN ACCORDANCE WITH VOL. 1, CHAPTER 12, OF THE HOWARD COUNTY DESIGN MANUAL, STORM DRAINAGE.
- ALL DISTURBED AREAS MUST BE STABILIZED WITHIN THE TIME PERIOD SPECIFIED ABOVE IN ACCORDANCE WITH THE 1994 MARYLAND STANDARDS AND SPECIFICATIONS FOR SOIL EROSION AND SEDIMENT CONTROL FOR PERMANENT SEEDINGS, SOD, TEMPORARY SEEDINGS AND MULCHING (SEC. G). TEMPORARY STABILIZATION, WITH MULCH ALONE, CAN ONLY BE DONE WHEN RECOMMENDED SEEDING DATES DO NOT ALLOW FOR PROPER GERMINATION AND ESTABLISHMENT OF GRASSES.
- ALL SEDIMENT CONTROL STRUCTURES ARE TO REMAIN IN PLACE AND ARE TO BE MAINTAINED IN OPERATIVE CONDITION UNTIL PERMITS FOR THEIR REMOVAL HAS BEEN OBTAINED FROM THE HOWARD COUNTY SEDIMENT CONTROL INSPECTOR.

TOTAL AREA OF SITE (LOT 9) : 0.764 ACRES
 AREA DISTURBED : 0.414 ACRES
 AREA TO BE ROOFED OR PAVED : 0.094 ACRES
 AREA TO BE VEGETATIVELY STABILIZED : 0.354 ACRES
 TOTAL CUT : 3204 CU. YDS.
 TOTAL FILL : 3204 CU. YDS.
 OFF-SITE WASTE/BORROW AREA LOCATION : NONE

- ANY SEDIMENT CONTROL PRACTICE WHICH IS DISTURBED BY GRADING ACTIVITY FOR PLACEMENT OF UTILITIES MUST BE REPAIRED ON THE SAME DAY OF DISTURBANCE.
- ADDITIONAL SEDIMENT CONTROL MUST BE PROVIDED, IF DEEMED NECESSARY BY THE HOWARD COUNTY DPW SEDIMENT CONTROL INSPECTOR.
- ON ALL SITES WITH DISTURBED AREAS IN EXCESS OF 2 ACRES, APPROVAL OF THE INSPECTION AGENCY SHALL BE REQUESTED UPON COMPLETION OF INSTALLATION OF PERIMETER EROSION AND SEDIMENT CONTROLS, BUT BEFORE PROCEEDING WITH ANY OTHER EARTH DISTURBANCE OR GRADING. OTHER BUILDING OR GRADING INSPECTION APPROVALS MAY NOT BE AUTHORIZED UNTIL THIS INITIAL APPROVAL BY THE INSPECTION AGENCY IS MADE.
- TRENCHES FOR THE CONSTRUCTION OF UTILITIES IS LIMITED TO 3 PIPE LENGTHS OR THAT WHICH SHALL BE BACKFILLED AND STABILIZED WITHIN 1 WORKING DAY, WHICHEVER IS SHORTER.

PERMANENT SEEDING NOTES

APPLY TO GRADED OR CLEARED AREA NOT SUBJECT TO IMMEDIATE FURTHER DISTURBANCE WHERE A PERMANENT LONG-LIVED VEGETATIVE COVER IS NEEDED.

SEEDING PREPARATION: LOOSEN UPPER THREE INCHES OF SOIL BY RAKING, DISCING OR OTHER ACCEPTABLE MEANS BEFORE SEEDING (UNLESS PREVIOUSLY LOOSENED).

SOIL AMENDMENTS: IN LIEU OF SOIL TEST RECOMMENDATIONS, USE ONE OF THE FOLLOWING SCHEDULES

- PREFERRED - APPLY 2 TONS PER ACRE DOLOMITIC LIMESTONE (92 LBS/1000 SQUARE FEET) AND 600 LBS PER ACRE 10-10-10 FERTILIZER (14 LBS/1000 SQ FT) BEFORE SEEDING. HARROW OR DISC INTO UPPER THREE INCHES OF SOIL AT TIME OF SEEDING. APPLY 400 LBS PER ACRE 30-0-0 UREA-FORM FERTILIZER (9 LBS/1000 SQ FT).
- ACCEPTABLE - APPLY 2 TONS PER ACRE DOLOMITIC LIMESTONE (92 LBS/1000 SQ FT) AND 1000 LBS PER ACRE OF 10-10-10 FERTILIZER (23 LBS/1000 SQ FT) BEFORE SEEDING. HARROW OR DISC INTO UPPER THREE INCHES OF SOIL.

SEEDING: FOR THE PERIODS MARCH 1 THRU APRIL 30, AND AUGUST 1 THRU OCTOBER 15, SEED WITH 60 LBS PER ACRE (1.4 LBS/1000 SQ FT) OF KENTUCKY 31 TALL FESCUE. FOR THE PERIOD MAY 1 THRU JULY 31, SEED WITH 60 LBS KENTUCKY 31 TALL FESCUE PER ACRE AND 2 LBS PER ACRE (0.5 LBS/1000 SQ FT) OF WEEPING LOVEGRASS. DURING THE PERIOD OF OCTOBER 16 THRU FEBRUARY 28, PROTECT SITE BY: OPTION (1) 2 TONS PER ACRE OF WELL ANCHORED STRAW MULCH AND SEED AS SOON AS POSSIBLE IN THE SPRING. OPTION (2) USE SOD. OPTION (3) SEED WITH 60 LBS/ACRE KENTUCKY 31 TALL FESCUE AND MULCH WITH 2 TONS/ACRE WELL ANCHORED STRAW.

MULCHING: APPLY 1-1/2 TO 2 TONS PER ACRE (70 TO 90 LBS/1000 SQ FT) OF UNROTTED SMALL GRAM STRAW IMMEDIATELY AFTER SEEDING. ANCHOR MULCH IMMEDIATELY AFTER APPLICATION USING MULCH ANCHORING TOOL OR 218 GALLONS PER ACRE (5 GAL/1000 SQ FT) OF EMULSIFIED ASPHALT ON FLAT AREAS. ON SLOPES 8 FEET OR HIGHER, USE 348 GALLONS PER ACRE (8 GAL/1000 SQ FT) FOR ANCHORING.

MAINTENANCE: INSPECT ALL SEEDED AREAS AND MAKE NEEDED REPAIRS, REPLACEMENTS AND RESEEDING.

TEMPORARY SEEDING NOTES

APPLY TO GRADED OR CLEARED AREAS LIKELY TO BE REDISTURBED WHERE A SHORT-TERM VEGETATIVE COVER IS NEEDED.

SEEDING PREPARATION: LOOSEN UPPER THREE INCHES OF SOIL BY RAKING, DISCING OR OTHER ACCEPTABLE MEANS BEFORE SEEDING (UNLESS PREVIOUSLY LOOSENED).

SOIL AMENDMENTS: APPLY 600 LBS PER ACRE 10-10-10 FERTILIZER (14 LBS/1000 SQ FT).

SEEDING: FOR PERIODS MARCH 1 THRU APRIL 30 AND FROM AUGUST 15 THRU OCTOBER 15, SEED WITH 2-1/2 BUSHEL PER ACRE OF ANNUAL RYE (3.2 LBS/1000 SQ FT). FOR THE PERIOD MAY 1 THRU AUGUST 14, SEED WITH 3 LBS PER ACRE OF WEEPING LOVEGRASS (0.7 LBS/1000 SQ FT) FOR THE PERIOD NOVEMBER 16 THRU FEBRUARY 28, PROTECT SITE BY APPLYING 2 TONS PER ACRE OF WELL ANCHORED STRAW MULCH AND SEED AS SOON AS POSSIBLE IN THE SPRING, OR USE SOD.

MULCHING: APPLY 1-1/2 TO 2 TONS PER ACRE (70 TO 90 LBS/1000 SQ FT) OF UNROTTED, WEED-FREE, SMALL GRAM STRAW IMMEDIATELY AFTER SEEDING. ANCHOR MULCH IMMEDIATELY AFTER APPLICATION USING MULCH ANCHORING TOOL OR 218 GAL PER ACRE (5 GAL/1000 SQ FT) OF EMULSIFIED ASPHALT ON FLAT AREAS. ON SLOPES, 8 FT OR HIGHER, USE 348 GAL PER ACRE (8 GAL/1000 SQ FT) FOR ANCHORING.

PROFESSIONAL CERTIFICATION

I HEREBY CERTIFY THAT THESE PLANS WERE PREPARED OR APPROVED BY ME, AND THAT I AM A DULY LICENSED PROFESSIONAL ENGINEER UNDER THE LAWS OF THE STATE OF MARYLAND, LICENSE NO. 12975, EXPIRATION DATE: MAY 26, 2010.

DATE: _____

ENGINEER'S CERTIFICATE

I CERTIFY THAT THIS PLAN FOR EROSION AND SEDIMENT CONTROL REPRESENTS A PRACTICAL AND WORKABLE PLAN BASED ON MY PERSONAL KNOWLEDGE OF THE SITE CONDITIONS AND THAT IT WAS PREPARED IN ACCORDANCE WITH THE REQUIREMENTS OF THE HOWARD SOIL CONSERVATION DISTRICT.

DATE: _____

APPROVED: FOR PRIVATE WELL AND SHARED SEPTIC HOWARD COUNTY HEALTH DEPARTMENT

County Health Officer _____ Date _____

SEQUENCE OF CONSTRUCTION FOR HOUSE CONSTRUCTION ON LOT 9

- APPLY FOR A GRADING PERMIT AND A BUILDING PERMIT.
- IF THE HOUSE CONSTRUCTION AND ASSOCIATED GRADING WORK ON THIS LOT OCCURS WHILE THE F-05-070 ROAD CONSTRUCTION WORK IS STILL ACTIVE, COORDINATE THE HOUSE CONSTRUCTION/GRADING WORK WITH THE F-05-070 SEDIMENT CONTROL MEASURES. OTHERWISE, INSTALL THE SILT FENCE (-SF-), SUPER SILT FENCE (-SSF-) AND THE STABILIZED CONSTRUCTION ENTRANCE (SCE) FOR THIS LOT AS SHOWN.
- CONSTRUCT THIS HOME SITE.
- STABILIZE ALL REMAINING DISTURBED AREAS IN ACCORDANCE WITH THE PERMANENT SEEDING NOTES OR WITH MARYLAND CERTIFIED SOD.
- OBTAIN PERMISSION FROM THE INSPECTOR TO REMOVE ANY SEDIMENT CONTROL FEATURES THAT ARE NO LONGER NEEDED.

NOTES:

- THE LOT SHOWN IS 33,180 S.F. AND IT IS RECORDED UNDER PLAT No. 19125 AMONG THE LAND RECORDED OF HOWARD COUNTY, MARYLAND.
- EXISTING TOPOGRAPHY IS FROM F-05-070. CALL G.L.W. IF FIELD CONDITIONS ARE SUBSTANTIALLY DIFFERENT.
- THIS LOT IS SERVED BY A PRIVATE WELL AND BY A COMMUNITY SEPTIC SYSTEM PER SDP-04-136 AND F-05-070.
- ALL WELLS WITHIN 100 FEET OF THE PROPERTY LINE HAVE BEEN LOCATED BY A GLW SURVEY AND ACCURATELY SHOWN ON THIS PLAN.
- STORMWATER MANAGEMENT IS PROVIDED BY THE POND CONSTRUCTED UNDER F-05-070.
- THE EXISTING WELLS SHOWN ON PLAN (IDENTIFIED WITH THE WELL TAG NUMBER HO-95-0025 FOR LOT 9) HAS BEEN FIELD LOCATED BY G.L.W. (PROFESSIONAL LAND SURVEYORS) AND IS ACCURATELY SHOWN ON THIS PLAN.

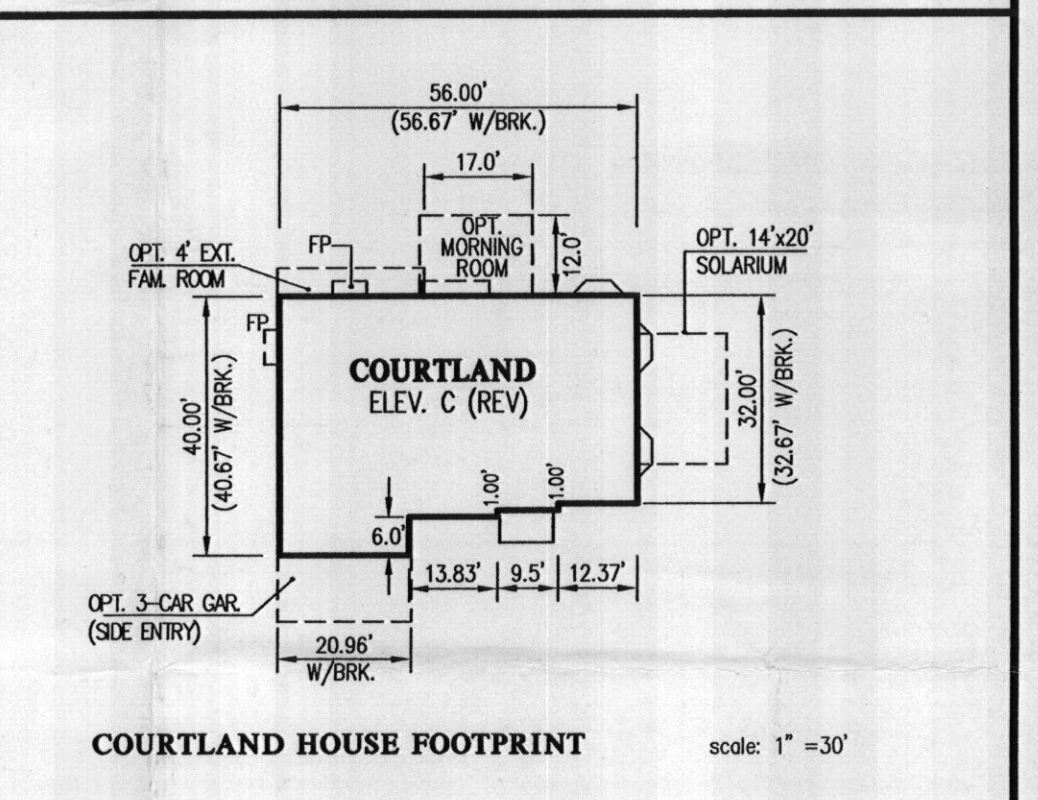

LOT 9 COURTLAND

- ELEVATION C
- 2-CAR GARAGE
- MORNING ROOM

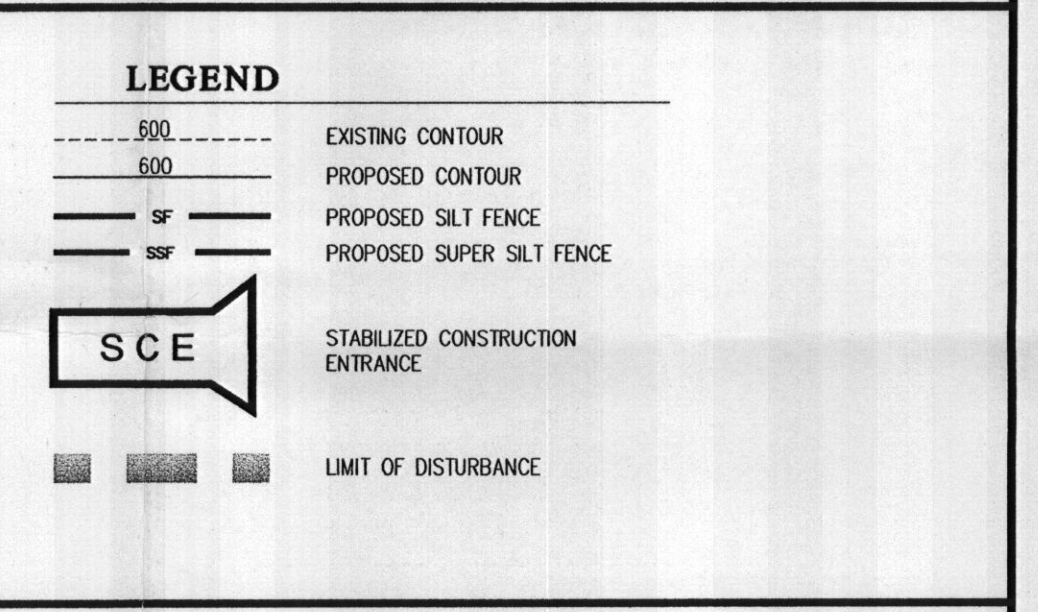

DEVELOPER'S/BUILDER'S CERTIFICATE

I/WE CERTIFY THAT ALL DEVELOPMENT AND/OR CONSTRUCTION WILL BE DONE ACCORDING TO THIS PLAN, AND THAT ANY RESPONSIBLE PERSONNEL INVOLVED IN THE CONSTRUCTION PROJECT WILL HAVE A CERTIFICATE OF ATTENDANCE AT A MARYLAND DEPARTMENT OF THE ENVIRONMENT APPROVED TRAINING PROGRAM FOR THE CONTROL OF SEDIMENT AND EROSION BEFORE BEGINNING THE PROJECT. I ALSO AUTHORIZE PERIODIC ON-SITE INSPECTION BY THE HSCD.

Signature: *B. M. McCoy* DATE: 02/26/10

SIGNATURE OF DEVELOPER/BUILDER DATE

DATE: _____ REVISION: _____ BY: _____ APPR: _____

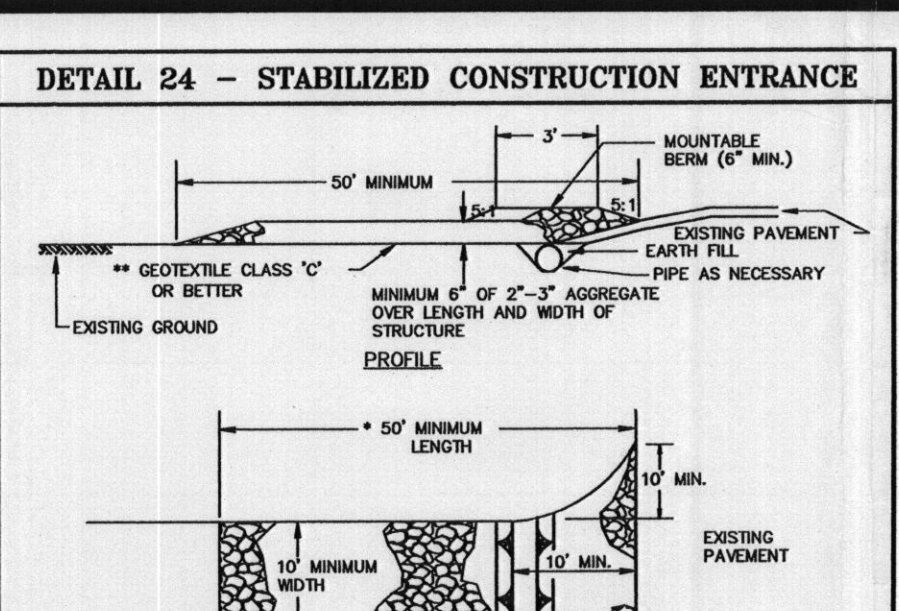

Construction Specifications

- Length - minimum of 50' (30' for single residence lot).
- Width - 10' minimum, should be flared at the existing road to provide a turning radius.
- Geotextile fabric (filter cloth) shall be placed over the existing ground prior to placing stones. **The plan approval authority may not require single family residences to use geotextile.
- Stones - crushed aggregate (2" to 3") or rounded or recycled concrete equivalent shall be placed at least 6" deep over the length and width of the entrance.
- Surface Water - all surface water flowing to or diverted toward construction entrances shall be piped through the entrance, maintaining positive drainage. Pipe installed through the stabilized construction entrance shall be protected with a roundabout berm with 5:1 slope and a minimum of 6" of stone over the pipe. Pipe shall be placed according to the drainage. When the SCE is located at a high spot and has no drainage to convey a pipe will not be necessary. Pipe should be sized according to the amount of runoff to be conveyed. A 6" minimum will be required.
- Location - A stabilized construction entrance shall be located at every spot where construction traffic enters or leaves a construction site. Vehicles leaving the site must travel over the entire length of the stabilized construction entrance.

U.S. DEPARTMENT OF AGRICULTURE SOIL CONSERVATION SERVICE PAGE 7-17-3 MARYLAND DEPARTMENT OF ENVIRONMENT WATER MANAGEMENT ADMINISTRATION

