

Building Address: 13505 Mitchells way

Suite/Apt. # \_\_\_\_\_ SDP/WP/BA #: \_\_\_\_\_

Census Tract: \_\_\_\_\_ Subdivision: Clarefield

Section: \_\_\_\_\_ Area: \_\_\_\_\_ Lot: 21

Tax Map: \_\_\_\_\_ Parcel: \_\_\_\_\_ Grid: \_\_\_\_\_

Zoning: \_\_\_\_\_ Map Coordinates: \_\_\_\_\_ Lot Size: \_\_\_\_\_

Existing Use: Vacant lot

Proposed Use: New SFD

Estimated Construction Cost: \$ 400,000

Description of Work: \_\_\_\_\_

Occupant or Tenant: None

Was tenant space previously occupied?  Yes  No

Contact Name: \_\_\_\_\_

Address: \_\_\_\_\_

City: \_\_\_\_\_ State: \_\_\_\_\_ Zip Code: \_\_\_\_\_

Phone: \_\_\_\_\_ Fax: \_\_\_\_\_

Email: \_\_\_\_\_

Property Owner's Name: Clarefield Pfefferkorn

Address: 1175 Stratfield Court

City: Marriottsville State: MD Zip Code: 21104

Home Phone: \_\_\_\_\_ Work Phone: \_\_\_\_\_

Applicant's Name & Mailing Address, (If other than stated herein): \_\_\_\_\_

Phone: \_\_\_\_\_ Fax: \_\_\_\_\_

Email: \_\_\_\_\_

Contractor Company: \_\_\_\_\_

Contact Person: \_\_\_\_\_

Address: \_\_\_\_\_

City: \_\_\_\_\_ State: \_\_\_\_\_ Zip Code: \_\_\_\_\_

License No. : \_\_\_\_\_

Phone: \_\_\_\_\_ Fax: \_\_\_\_\_

Email: \_\_\_\_\_

Engineer/Architect Company: \_\_\_\_\_

Responsible Design Prof.: \_\_\_\_\_

Address: \_\_\_\_\_

City: \_\_\_\_\_ State: \_\_\_\_\_ Zip Code: \_\_\_\_\_

Phone: \_\_\_\_\_ Fax: \_\_\_\_\_

Email: \_\_\_\_\_

BUILDING DESCRIPTION - COMMERCIAL	
Building Characteristics	Utilities
Height:	<u>Water Supply</u>
No. of stories:	<input type="checkbox"/> Public
Gross area, sq. ft./floor:	<input type="checkbox"/> Private
	<u>Sewage Disposal</u>
Area of construction (sq. ft.):	<input type="checkbox"/> Public
	<input type="checkbox"/> Private
Use group:	Electric: <input type="checkbox"/> Yes <input type="checkbox"/> No
	Gas: <input type="checkbox"/> Yes <input type="checkbox"/> No
<u>Construction type:</u>	<u>Heating System</u>
<input type="checkbox"/> Reinforced Concrete	<input type="checkbox"/> Electric <input type="checkbox"/> Oil
<input type="checkbox"/> Structural Steel	<input type="checkbox"/> Natural Gas <input type="checkbox"/> Propane Gas
<input type="checkbox"/> Masonry	<u>Sprinkler System:</u>
<input type="checkbox"/> Wood Frame	<input type="checkbox"/> N/A
<input type="checkbox"/> State Certified Modular	<input type="checkbox"/> Full
<input checked="" type="checkbox"/> Roadside Tree Project Permit	<input type="checkbox"/> Partial
<input type="checkbox"/> Yes <input type="checkbox"/> No	<input type="checkbox"/> Other Suppression
Roadside Tree Project Permit #	No. of Heads:

BUILDING DESCRIPTION - RESIDENTIAL	
Building Characteristics	Utilities
<input type="checkbox"/> SF Dwelling <input type="checkbox"/> SF Townhouse	<u>Water Supply</u>
<u>Depth</u> <u>Width</u>	<input type="checkbox"/> Public
1 <sup>st</sup> floor:	<input type="checkbox"/> Private
2 <sup>nd</sup> floor:	<u>Sewage Disposal</u>
Basement:	<input type="checkbox"/> Public
<input type="checkbox"/> Finished Basement	<input type="checkbox"/> Private
<input type="checkbox"/> Unfinished Basement	Electric: <input type="checkbox"/> Yes <input type="checkbox"/> No
<input type="checkbox"/> Crawl Space	Gas: <input type="checkbox"/> Yes <input type="checkbox"/> No
<input type="checkbox"/> Slab on Grade	<u>Heating System</u>
No. of Bedrooms: <u>11</u>	<input type="checkbox"/> Electric
<u>Multi-family Dwelling</u>	<input type="checkbox"/> Oil
No. of efficiency units:	<input type="checkbox"/> Natural Gas
No. of 1 BR units:	<input type="checkbox"/> Propane Gas
No. of 2 BR units:	
No. of 3 BR units:	
Other Structure:	
Dimensions:	
Footings:	<input checked="" type="checkbox"/> Roadside Tree Project Permit
Roof:	<input type="checkbox"/> Yes <input type="checkbox"/> No
<input type="checkbox"/> State Certified Modular	<u>Roadside Tree Project Permit #</u>
<input type="checkbox"/> Manufactured Home	

THE UNDERSIGNED HEREBY CERTIFIES AND AGREES AS FOLLOWS: (1) THAT HE/SHE IS AUTHORIZED TO MAKE THIS APPLICATION; (2) THAT THE INFORMATION IS CORRECT; (3) THAT HE/SHE WILL COMPLY WITH ALL REGULATIONS OF HOWARD COUNTY WHICH ARE APPLICABLE THERETO; (4) THAT HE/SHE WILL PERFORM NO WORK ON THE ABOVE REFERENCED PROPERTY NOT SPECIFICALLY DESCRIBED IN THIS APPLICATION; (5) THAT HE/SHE GRANTS COUNTY OFFICIALS THE RIGHT TO ENTER ONTO THIS PROPERTY FOR THE PURPOSE OF INSPECTING THE WORK PERMITTED AND POSTING NOTICES.

Applicant's Signature \_\_\_\_\_ Print Name \_\_\_\_\_

Email Address \_\_\_\_\_ Date \_\_\_\_\_

Title/Company \_\_\_\_\_

Checks Payable to: DIRECTOR OF FINANCE OF HOWARD COUNTY  
 \*\*PLEASE WRITE NEATLY & LEGIBLY\*\*  
 -FOR OFFICE USE ONLY-

AGENCY	DATE	SIGNATURE OF APPROVAL
State Highways		
Building Officials		
PSZA ( Zoning )		
PSZA ( Engineering )		
Health		<u>4-27-11 D Bernard</u>
Fire Protection		

Is Sediment Control approval required for issuance?  Yes  No  
 CONTINGENCY CONSTRUCTION START  
 ONE STOP SHOP

DPZ SETBACK INFORMATION
Front:
Rear:
Side:
Side St.:
All minimum setbacks met? <input type="checkbox"/> Yes <input type="checkbox"/> No
Is Entrance Permit Required? <input type="checkbox"/> Yes <input type="checkbox"/> No
Historic District? <input type="checkbox"/> Yes <input type="checkbox"/> No
Lot Coverage for New Town Zone:
SDP/Red-line approval date:

Filing Fee	\$ <u>142.00</u>
Permit Fee	\$
Tech Fee	\$
Excise Tax	\$
PSFS	\$
Guaranty Fund	\$
Add'l per Fee	\$
Total Fees	\$
Sub- Total Paid	\$
Balance Due	\$

1 OF 3

SHEET

LOT 8  
57,506 SQ. FT.

LOT 5  
54,103 SQ. FT.

**BUILDABLE PRESERVATION PARCEL 'A'**  
PRIVATELY OWNED  
EASEMENT HOLDERS: H.O.A. AND HOWARD CO.

FOREST CONSERVATION EASEMENT NO. 1  
12.939 AC.

100Yr. WSEL = 534.44  
25Yr. WSEL = 533.56  
CPV EL. = 532.04  
WQV EL. = 531.56

**BMP #1 MICRO-POOL (P-1)**  
EXTENDED DETENTION POND  
HAZARD CLASS 'A'  
H.O.A. OWNED AND JOINTLY MAINTAINED BY H.O.A. AND HO. CO.  
25 YR. S.W.M. IS PROVIDED DUE TO PFEFFERKORN ROAD CULVERT  
15' NO WOODY VEGETATION ZONE

**NON-BUILDABLE PRESERVATION PARCEL 'E'**  
OWNER: H.O.A.  
EASEMENT HOLDER: HOWARD COUNTY

**BUILDABLE PRESERVATION PARCEL 'A'**  
PRIVATELY OWNED  
EASEMENT HOLDERS: H.O.A. AND HOWARD COUNTY

**BUILDABLE PRESERVATION PARCEL 'A'**  
PRIVATELY OWNED  
EASEMENT HOLDERS: H.O.A. AND HOWARD COUNTY

FOREST CONSERVATION EASEMENT NO. 1  
12.939 AC.

**NON-BUILDABLE PRESERVATION PARCEL 'D'**  
PRIVATELY OWNED  
EASEMENT HOLDERS: H.O.A. AND HOWARD COUNTY

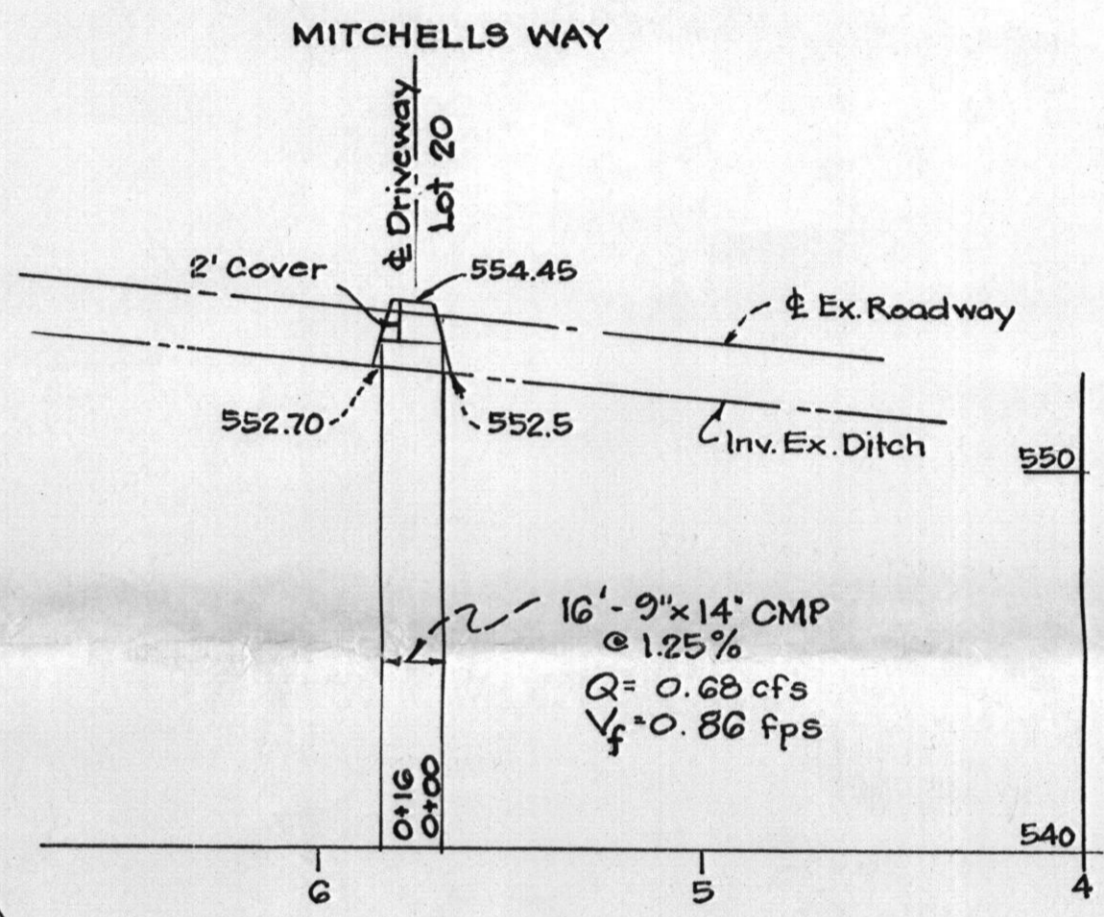

**NOTE:**  
Stormwater Management is provided under FOG-110 per Ho. Co. 4 Md. 378 spec. Recharge volume will be provided through grass channels next to the roadway. Protection volume provided by micro pool extended detention pond, pocket pond & infiltratable dry wells. 25 year SWM volume provided within BMP #1. Extreme Flood volume is not required for this site

**NOTE:**  
The existing wells shown on this plan HO-95-0381, HO-95-0382, HO-95-0363, HO-95-0364, HO-95-0365 & HO-95-0368 have been located by Fisher Collins & Carter, Inc. professional land surveyors and are accurately shown.

**BUILDER/DEVELOPER'S CERTIFICATE**

"I/we certify that all development and construction will be done according to this plan, for sediment and erosion control and that any responsible personnel involved in the construction project will have a Certificate of Attendance at a Department of the Environment Approved Training Program for the Control of Sediment and Erosion before beginning the project. I also authorize periodic on-site inspection by the Howard Soil Conservation District."

Signature of Developer: *[Signature]* Date: 3/19/10

**ENGINEER'S CERTIFICATE**

"I certify that this plan for erosion and sediment control represents a practical and workable plan based on my personal knowledge of the site conditions and that it was prepared in accordance with the requirements of the Howard Soil Conservation District."

Signature of Engineer: *[Signature]* Date: 3/19/10

- 5 Rev. hsc. 4 qrd., Lot 21 3-2-11
- 4 Add alternate well loc. for Lots 4 & 5 1-24-11
- 3 Rev. hsc 4 qrd Lot 4, add sep. invert information 12-9-10
- 2 Moved hsc Lot 20 forward and added alt. well locations 5-27-10
- 1 Rev. Lot 20 hsc type 4 qrd., show sep. tk. & inv. elev. for bldg. permit 4-1-10

**FISHER, COLLINS & CARTER, INC.**  
CIVIL ENGINEERING CONSULTANTS & LAND SURVEYORS  
NATIONAL SQUARE OFFICE PARK - 10772 BALTIMORE NATIONAL PIKE  
BALDWIN CITY, MARYLAND 21104  
(410) 461-2200

This development plan is approved for soil erosion and sediment control by the HOWARD SOIL CONSERVATION DISTRICT.  
*[Signature]* Date: 3/23/10  
Howard SCD

**OWNER/BUILDER/DEVELOPER**  
CATONVILLE BUILDERS  
11175 STRATFIELD COURT  
MARGROTTVILLE, MARYLAND 21104  
410-442-2211

**SITE DEVELOPMENT, SEDIMENT/EROSION CONTROL PLAN**  
SINGLE FAMILY DETACHED  
**CLOVERFIELD**  
LOTS 3-8, 11,13,16,18, 20 & 21  
PLAT NO'S. 18953-18959  
MAP NO.: 15 GRID NO.: 8 PARCEL NO.: 4  
ELECTION DISTRICT HOWARD COUNTY, MARYLAND  
SCALE: 1" = 50' DATE: MARCH, 2010  
SHEET 2 OF 3



GP-10-72