

LAYOUT 3/15/06 INSP 4 _____
 INSP 2 3/16/06 INSP 5 _____
 INSP 3 3/17/06 INSP 6 _____

ISSUE DATE: 3/6/2006 **PERMIT-PEAT BIOFILTER** P ~~522862~~ 524177

APPROVAL DATE: ~~3/3/2006~~ 3/21/06 **SEPTIC SYSTEM** A REPAIR
TAX ID # 05-348269

**ON-SITE SEWAGE DISPOSAL SYSTEM
 HOWARD COUNTY HEALTH DEPARTMENT
 BUREAU OF ENVIRONMENTAL HEALTH**

J & M Contracting IS PERMITTED TO INSTALL ALTER

ADDRESS: 425 Obrecht Rd PHONE NUMBER: 443-277-7526

SUBDIVISION _____ LOT _____

ADDRESS: 6820 Mink Hollow Road PROPERTY OWNER: Sean Green

SEPTIC TANK CAPACITY (GALLONS): 1000 **W/Effluent Filter & Top Seamed Single Compartment Tank**

PUMP CHAMBER CAPACITY (GALLONS): 1500 **Top seamed two compartment tank using the 500 gals. second chamber as the pump chamber.**

Install and maintain a water meter on the incoming side of the water system or an event counter on the sewage pumping system. High water alarm on a separate circuit & located in the house.

Install Peat system over 36 ft 4 in by 13 ft gravel bed. Gravel bed depth 5 ft - 94.6. Top of gravel - 98.25. Top of filters - 100.75.

Install three 40 ft drain fields, 5 ft deep, 3 ft wide, pipe as high as possible, 8 ft separation, and connect in a spill & fill arrangement. Connect the existing gravel with a gate valve for future use. Note: Elevations are based on a benchmark of 100.00 (patio brick in front of four seasons room door).

| | |
|-----------|---|
| LOCATION: | Approved layout staked in field with Sean Green, Richard Grambling, and Ronnie Heaps (J&M Contracting). |
| NOTES: | A test of the pump system & distribution piping is required prior to covering the system. Water tightness test must include the risers. System is sized for a max. of 3 bedrooms. |

Note: This repair is a conventional system with pretreatment to allow for a variance to the 100 ft well setback.

PLANS APPROVED: _____ DATE: 3/3/06

NOTES: PERMIT VOID AFTER 2 YEARS
 CONTRACTOR IS RESPONSIBLE FOR SCHEDULING A PRE-CONSTRUCTION INSPECTION FOR ALL INSTALLATIONS
 WATERTIGHT SEPTIC TANKS REQUIRED
 ALL PARTS OF SEPTIC SYSTEM SHALL BE 100 FEET FROM ANY WATER WELL UNLESS SPECIFICALLY AUTHORIZED
 MANHOLE RISERS REQUIRED ON ALL SEPTIC TANKS AND PUMP CHAMBERS UNLESS SPECIFICALLY AUTHORIZED
 CONTRACTOR RESPONSIBLE FOR COMPLIANCE WITH APPLICABLE REGULATIONS, GUIDELINES AND THE TERMS OF THIS PERMIT

NEITHER THE HOWARD COUNTY COUNCIL NOR THE HEALTH DEPARTMENT IS RESPONSIBLE FOR THE SUCCESSFUL OPERATION OF ANY SYSTEM PERMITTEE RESPONSIBLE FOR OBTAINING FINAL APPROVAL ON THIS PERMIT ALL 410-313-2640 FOR INSPECTION OF SEPTIC SYSTEM

NOT TO SCALE

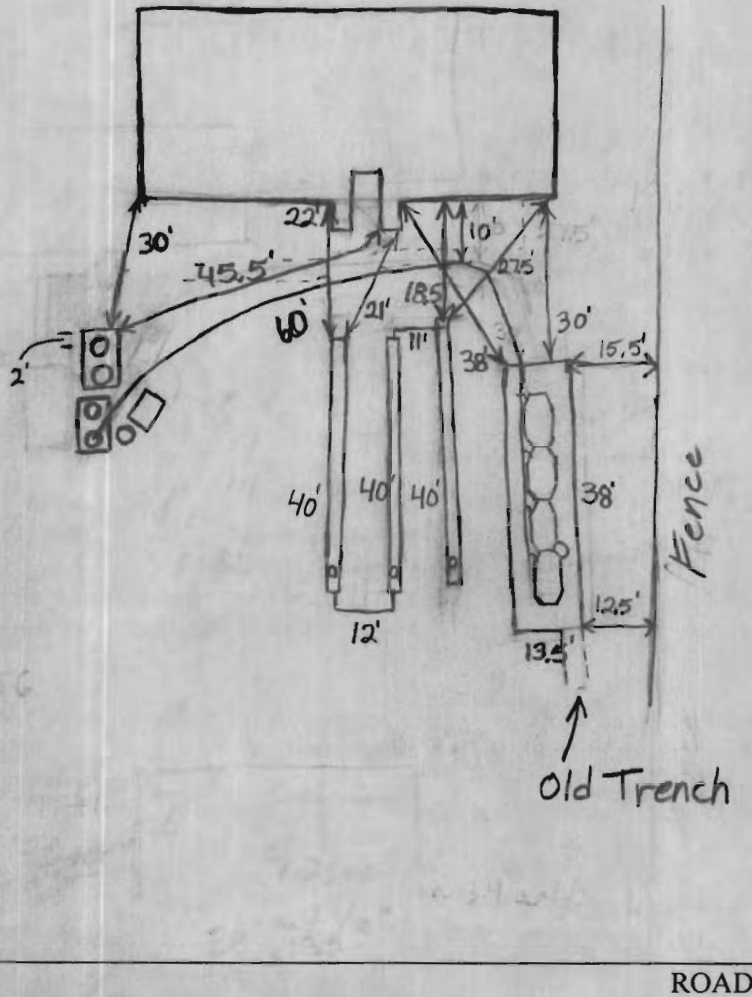

| TRENCH/DRAINFIELD DATA | | |
|-------------------------|-------|----------------|
| WIDTH | INLET | BOTTOM |
| 3' | 2.5' | 5' |
| NUMBER OF TRENCHES | | 3 |
| TOTAL LENGTH | | 120' |
| ABSORPTION AREA | | 360 + Sidewalk |
| DISTRIBUTION BOX LEVEL | | N/A |
| DISTRIBUTION BOX BAFFLE | | N/A |
| DISTRIBUTION BOX PORT | | N/A |

| SEPTIC TANK DATA | |
|---|----------------------|
| SEPTIC TANK 1 LEVEL <input checked="" type="checkbox"/> | |
| Comp | CAPACITY 1500 TS GAL |
| | SEAM LOC Top |
| | TANK LID DEPTH 36" |
| | BAFFLES |
| | BAFFLE FILTER |
| | MANHOLE LOC |
| | 6" PORT LOC |
| | WATERTIGHT TEST |
| SEPTIC TANK 2 LEVEL <input checked="" type="checkbox"/> | |
| | CAPACITY 1500 TS GAL |
| | SEAM LOC Top |
| | TANK LID DEPTH 36" |
| | BAFFLES |
| | BAFFLE FILTER |
| | MANHOLE LOC |
| | 6" PORT LOC |
| | WATERTIGHT TEST |

PRE-CONSTRUCTION

INSTALLATION

3/15/06 - Tanks set, noted no water in tank holes at this time? (E) 3/16/06 Water tightness testing of Manholes & S tanks. (GAC) Water not filled entirely into Manhole on both tanks. sealant around MH's not dry yet. (GAC) 3/17/06 Trenches installed. Manholes on tanks sealed. 3/21/06 Everything working, O.K. to backfill (BB)

FINAL INSPECTOR

B. Baker

DATE OF APPROVAL

3/21/06

Tanks must be leakproof and cannot float (E)