



APPLICATION

FOR PERCOLATION TESTING AND SITE EVALUATION

TEST DATE(S) _____ TEST TIME _____ A/P 519022
 AGENCY REVIEW: _____ DATE 6/19/2003

DO NOT WRITE ABOVE THIS LINE

I HEREBY APPLY FOR THE NECESSARY TESTING/EVALUATION PRIOR TO ISSUANCE OF SEWAGE DISPOSAL SYSTEM PERMIT(S) TO:

CHECK AS NEEDED:

- CONSTRUCT NEW SEPTIC SYSTEM(S)
- REPAIR/ADD TO AN EXISTING SEPTIC SYSTEM
- REPLACE AN EXISTING SEPTIC SYSTEM

CHECK AS NEEDED:

- NEW STRUCTURE(S)
- ADDITION TO AN EXISTING STRUCTURE
- REPLACE AN EXISTING STRUCTURE

CHECK ONE:

- CREATE NEW LOT(S)
- BUILD ON AN EXISTING LOT IN A SUBDIVISION
- BUILD ON AN EXISTING PARCEL OF RECORD

IS THE PROPERTY WITHIN 2500' OF ANY RESERVOIR?

- YES
- NO

THE TYPE OF STRUCTURE IS:

- RESIDENTIAL WITH UNK PROPOSED BEDROOMS IN THE COMPLETED STRUCTURE (NOTE **UNKNOWN** IF APPROPRIATE)
- COMMERCIAL (PROVIDE DETAIL OF NUMBERS AND TYPES OF EMPLOYEES/ CUSTOMERS ON ACCOMPANYING PLAN)
- INSTITUTIONAL/GOVERNMENT (PROVIDE DETAIL OF NUMBERS AND TYPES OF EMPLOYEES/USERS ON ACCOMPANYING PLAN)

PROPERTY OWNER(S) PATRIC WELMOUTH

DAYTIME PHONE 410-480-0288 CELL 410-977-3352 FAX 410-480-0171

MAILING ADDRESS 8000 MAIN STREET R.C MD 21043
STREET CITY/TOWN STATE ZIP

APPLICANT MULDENBERG BENDER & ASSOC INC

DAYTIME PHONE 410-997-0294 CELL _____ FAX _____

MAILING ADDRESS 5072 DORSEY HALL MD 21042
STREET CITY/TOWN STATE ZIP

APPLICANT'S ROLE: DEVELOPER BUILDER BUYER RELATIVE/FRIEND REALTOR CONSULTANT

PROPERTY LOCATION
SUBDIVISION/PROPERTY NAME WELMOUTH LOT NO. 2

PROPERTY ADDRESS MILLERS MILL ROAD COOKSVILLE
STREET TOWN/POST OFFICE

TAX MAP PAGE(S) 14 GRID _____ PARCEL(S) 144 PROPOSED LOT SIZE 4.86

AS APPLICANT, I UNDERSTAND THE FOLLOWING: THE SYSTEM INSTALLED SUBSEQUENT TO THIS APPLICATION IS ACCEPTABLE ONLY UNTIL PUBLIC SEWERAGE IS AVAILABLE. THIS APPLICATION IS COMPLETE WHEN ALL APPLICABLE FEES AND A SUITABLE SITE PLAN HAVE BEEN RECEIVED. I ACCEPT THE RESPONSIBILITY FOR COMPLIANCE WITH ALL M.O.S.H.A. AND "MISS UTILITY" REQUIREMENTS. APPROVAL IS BASED UPON SATISFACTORY REVIEW OF A PERC CERTIFICATION PLAN.

TEST RESULTS WILL BE MAILED TO APPLICANT.

SIGNATURE OF APPLICANT

HOWARD COUNTY HEALTH DEPARTMENT, BUREAU OF ENVIRONMENTAL HEALTH, WELL AND SEPTIC PROGRAM
 3525-H ELLICOTT MILLS DRIVE, ELLICOTT CITY, MARYLAND 21043-4544 (410) 313-1771 FAX (410) 313-2648
 TDD (410) 313-2323 TOLL FREE 1-877-4MD-DHMH

AIP (4)

Brown
Loam
~50%
Rock
Rock-HB: 17"

(6)
tan/Brown
Orange
Scl
~50%
Stony
Rock
Rock-HB: 2 1/2"

(8)
Brown Loam
Red orange
tan Scl
tan/orange
Brown
SI
10% Cobble
Rock

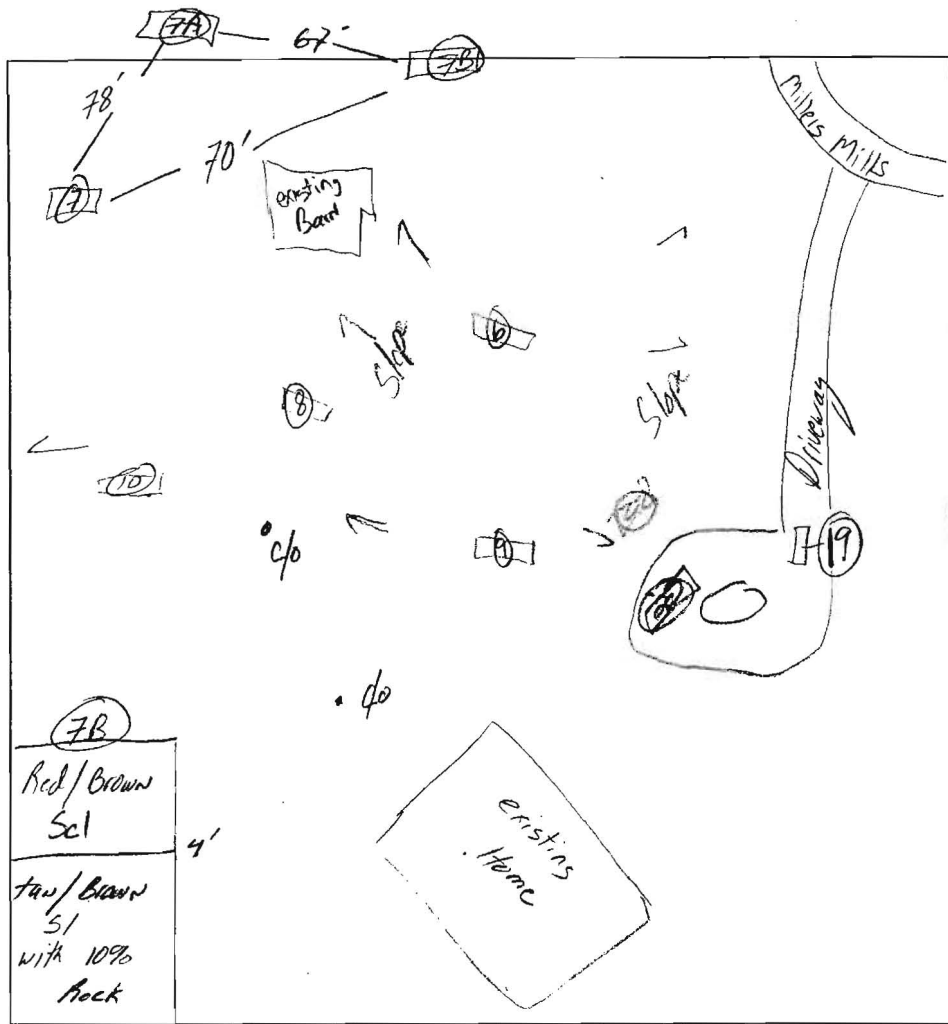

DATE	TEST #	DEPTH	START	BREAK 1" DROP	STOP 2" DROP	TIME OF 2nd INCH	P/F/H
4/28/04	(8)	6' / 13'	9:09	9:14	9:24	10min	P
	(10)	6' / 12 1/2'	9:27	9:37	9:59	22min	P
	(7)	6' / 12 1/2'	9:58	10:00	10:06	6min	P
	(7A)	6 1/2' / 12'	10:19	10:30	10:54	24min	P
	(7B)	- / 12'	- Visual -	- OK -	-	-	P
	(9)	- / 17"	- Visual -	- Rock	-	-	F
	(6)	- / 2 1/2'	- Visual -	- Rock	-	-	F

(12)
Brown/tan
Orange
Loam
tan/Brown
Orange
SI
Brown/orange
weak
Combed
Sand

(7)
tan/Brown
cl
Red/Orange
Brown
Scl
tan/Brown
Rock
ck
w/30%
Cobble
Rock

(7A)
Brown/tan
Loam
Orange/Brown
Scl
Brown/tan
Orange
SI
w/20%
Rock

REMARKS (7B) - Buried trash at base of hill
 SANITARIAN KJB BACKHOE Willie OTHERS _____
 TEST HOLES USED IN SDA _____ AVG. PERC TIME _____ SQ. FT/BR _____
 TRENCH WIDTH _____ INLET DEPTH _____ MAX. BOT DEPTH _____ EFFECTIVE SW _____

Approved
per cert
12-5-07

N 598800

E 1304000

BRIAN & KAREN WYNNE
15017 KENWOOD COURT
TAX MAP 14, PARCEL 25
LIBER 6254, FOLIO 471
ZONED: RC-DES

EXISTING VEGETATION
476 LF CREDIT

WETLAND BUFFER

STORMWATER
MANAGEMENT
CREDIT EASEMENT
LEVEL
SPREADER

28' PRIVATE
USE-IN-COMMON
ACCESS
EASEMENT

SEPTIC SYSTEM
EASEMENT AREA
EX-TO BE
RELOCATED

75'
STREAM BUFFER

100 YEAR
FLOODPLAIN DRAINAGE & UTILITY
EASEMENT

2006 HULLS HILL ROAD
TAX MAP 14, PARCEL 24
LIBER 4206, FOLIO 582

LOCATION
OF EXISTING
SEPTIC TANK
& PROPOSED
SEPTIC TANK

LOT 2

