

3/25/94
C/O 10:00
6/9/94 Anytime

3/25/94 Needs house connection
DKS

PERMIT

SEWAGE DISPOSAL SYSTEM

DEPARTMENT OF HEALTH AND MENTAL HYGIENE

HOWARD COUNTY HEALTH DEPARTMENT

BUREAU OF ENVIRONMENTAL HEALTH

~~461-9133~~ 313-2640

349954

INDEXED

P 49830

A 40874

DISTRICT 4th

DATE 4/10/94

DATE SYSTEM APPROVED 4/9/94

INSPECTOR CLW

Francis Bollinger

IS PERMITTED TO INSTALL ALTER

ADDRESS Bollinger Road, Westminster, Maryland PHONE 848-6527

SUBDIVISION Foxmoor LOT 11 ROAD 17740 Foxmoor Drive Way

PROPERTY OWNER Long Meadow Venturers/ Jon and Connie Casamonto

ADDRESS 7050 Oakland Mills Rd., Suite 100, Columbia, MD 21046

SEPTIC TANK CAPACITY 1250 GALLONS TOP SEAMED SEPTIC TANK REQUIRED

NUMBER OF BEDROOMS 4

210 SQUARE FEET PER BEDROOM

210
4
840
280
3) 840

LINEAR FEET OF TRENCH REQUIRED 280

TRENCHES - Trench to be 3 ft. wide. Inlet 2 ft. below original grade. Bottom maximum depth 4 ft. below original grade. Effective area begins at 2 ft. below original grade. 2 ft. of stone below distribution pipe.

LOCATION - Start the first trench 180 ft. down the far-left (335') lot line and 60 ft. off the same lot line as seen when facing the lot from Foxmoor Dr. Run trenches on contour toward the left lot line.

NOTES - No trench to exceed 100 ft. in length. Provide 6"-8" diameter cleanout and cap to grade or above on septic tank. *OK MR 4/6/94*

PLANS APPROVED BY Ron Pinkley/Craig Williams DATE 6-23-92

COVER NO WORK UNTIL INSPECTED AND APPROVED

NEITHER THE HOWARD COUNTY COUNCIL NOR THE HEALTH DEPARTMENT IS RESPONSIBLE FOR THE SUCCESSFUL OPERATION OF ANY SYSTEM

NOTE: CLEANOUT REQUIRED EVERY 70 FEET OF SEWER LINE AND/OR AT 90° SWEEPS IN LINES FROM HOUSE TO DRAIN FIELDS, 90° ELBOWS NOT ACCEPTABLE.

NOTE: ALL PARTS OF SEPTIC SYSTEMS (I.E. TANK, DISTRIBUTION BOX TRENCHES) TO BE 100 FEET FROM WELL (UNLESS OTHERWISE SPECIFICALLY AUTHORIZED)

NOTE: IF DEEP TRENCH(ES) ARE USED CALL FOR INSPECTION BEFORE AND AFTER PLACING GRAVEL IN TRENCH(ES)

NOTE: NO DRY WELL SHALL EXCEED 15 FOOT IN DIAMETER NO ABSORPTION TRENCH TO EXCEED 100 FEET IN LENGTH

NOTE: ALL PIPE FROM HOUSE TO SEPTIC TANK MUST BE CAST IRON OR SCHEDULE 35/40 PVC OR ABS

PERMIT VOID AFTER TWO YEARS

NOTE: INSTALL STAND PIPE ON SEPTIC TANK AND DRY WELL STAND PIPES MUST BE 6 INCHES IN DIAMETER CAST IRON, CONCRETE OR TERRA COTTA OR PVA OR ABS ACCEPTED. IF TOP OF SEPTIC TANK IS DEEPER THAN 3 FEET. MANHOLE TO GRADE REQUIRED.

NOTE: DISTRIBUTION BOXES MUST HAVE BAFFLES

***INSTALLER IS RESPONSIBLE FOR OBTAINING FINAL APPROVAL ON THIS PERMIT**

A
40874

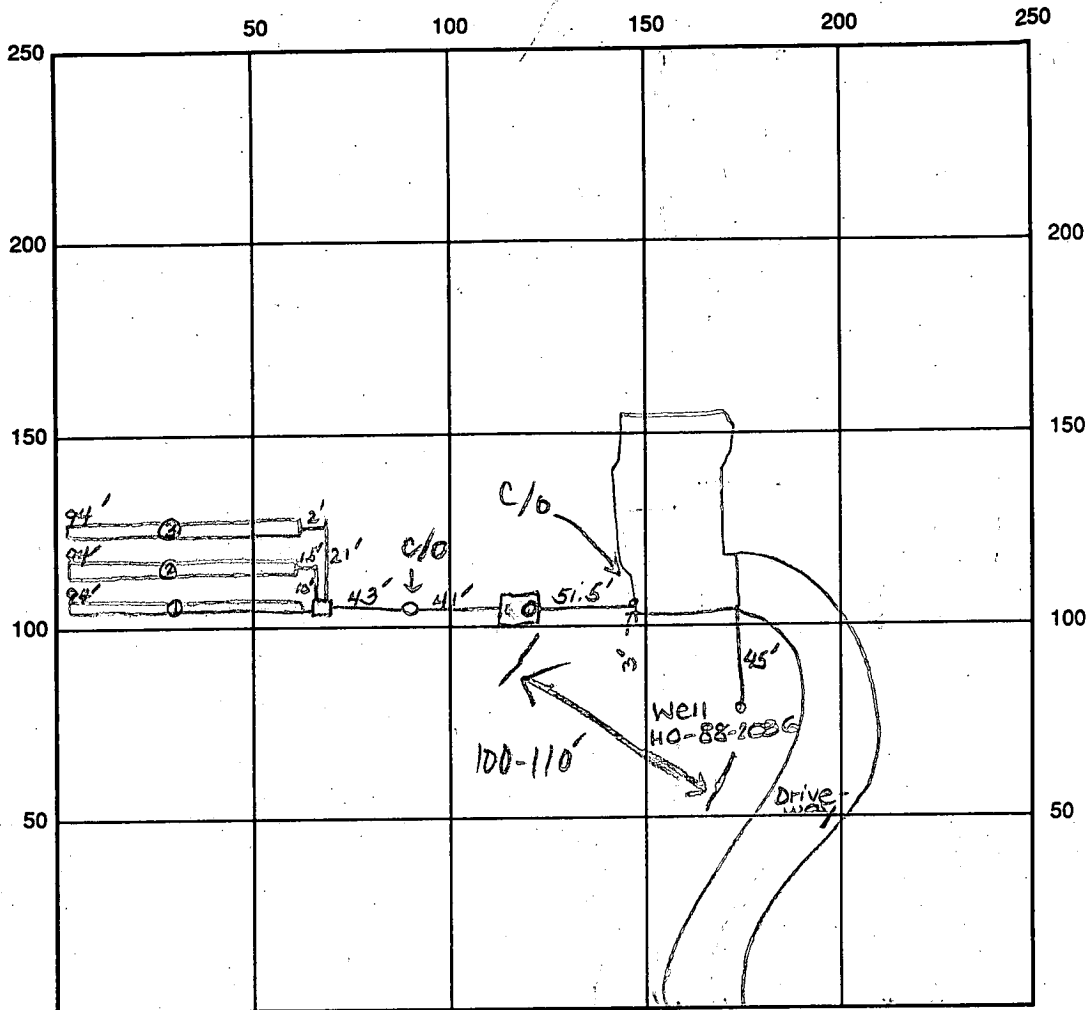

INDICATE NORTH - NAME ADJOINING ROADWAY AS BASE LINE

Foxmoor Dr.

MANHOLE

SEPTIC TANK LEVEL OK - 1500 gal

CLEANOUTS one on tank, one inline

DISTRIBUTION BOX LEVEL OK

DRAIN FIELD/TITLE DEPTH 4 FT.

TRENCH WIDTH 3 FT.

INLET DEPTH 2 FT.

EFFECTIVE GRAVEL DEPTH 2 FT.

TOTAL LENGTH 282' total

NUMBER OF TRENCHES 3

ONE SIDEWALL/BOTTOM AREA 846 SQ. FT.

DRYWALL INSIDE DIAMETER FT.

EFFECTIVE DEPTH BELOW INLET FT.

ABSORBENT AREA SQ. FT.

REMARKS: 3/25/94 OK to cover all work. Needs house connection. DKS

5/26/94 HOUSE CONNECTION COMPLETE. (CW)

6/9/94 HOUSE CONN. VERIFIED IN FIELD MR

DATE SYSTEM APPROVED

5/26/94

INSPECTOR

C. Williams

100 Year Floodplain
Drainage and Utility Easement

MATCH LINE
see this sheet

Information was taken from
record by Jodee
Verify which of the two
before making
house.

Location and location of the
as indicated on this

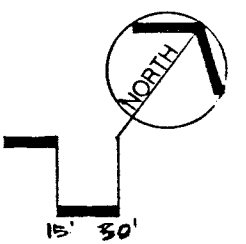

| REVISIONS | DATE | CHKD. |
|-----------|----------|-------|
| 10/25/93 | 09/25/93 | SSW |
| | | |
| | | |
| | | |



PROJECT:
FOXMOOR
LOT 11
Plat 9053
4th Election District Howard County, Maryland

TITLE:
SITE AND GRADING PLAN
for
The Casamento Residence

PHR&A
Patton Harris Rust & Associates, P.C.
Engineers, Surveyors, Planners, Landscape Architects
3908 Fox Ridge Drive, P.O. Box 901
Fairfax, Virginia 22030
703-273-8700

Offices:
Fairfax, Va.
Bridgewater, Va.
Leesburg, Va.
Rockville, Md.
Virginia Beach, Va.
Chantilly, Va.
Winchester, Va.

| SURVEY | DATE |
|--------------|------------------------|
| PHR&A/OTHERS | AUGUST 1993 |
| DESIGN | DRAWN |
| SSW | SSW |
| CHKD. | SCALE |
| RET | 1"=50' 2' C.I. ± Scale |
| SHEET 1 OF 1 | FILE NO. |
| | 2242-6-0 |

