

2/24/90
3:00 pm
anytime

PERMIT

P 45136

SEWAGE DISPOSAL SYSTEM

A REPAIR

MARYLAND STATE DEPARTMENT OF HEALTH DISTRICT _____

HOWARD COUNTY
BUREAU OF ENVIRONMENTAL HEALTH
461-9933

DATE 10/31/89

INDEXED

DATE SYSTEM APPROVED 2/26/90

INSPECTOR M. Ripstein

Fogle's Refuse and Septic Service, Inc. IS PERMITTED TO INSTALL _____ ALTER

ADDRESS 558 Obrecht Road, Sykesville, Maryland 21784 PHONE 795-5670

SUBDIVISION _____ ROAD 13701 Forsythe Road LOT _____

PROPERTY OWNER Mrs. Cleo F. Mack Whitehouse

ADDRESS 13701 Forsythe Road Sykesville, Maryland 21784

IF GARBAGE GRINDER IS USED INCREASE SEPTIC TANK CAPACITY BY 50% AND ABSORPTION AREA BY 22%.

GARBAGE GRINDER? YES _____ NO PROBLEM IS OVERFLOW AND RUSTED STEEL TANK
SEPTIC TANK CAPACITY 1000 GALLONS NUMBER OF BEDROOMS 2 HOUSE BUILT 1959

REPAIR - CALL FOR INSPECTION WHEN GROUND IS OPENED SO SANITARIAN CAN RECOMMEND REPAIR.

TRENCH - 360 SQ FT 7 FT LONG 10 FT DEEP 5 FT OF STONE 2 FT WIDE
RUN TRENCH OFF NEW TANK TOWARD BACK - OK TO HAVE HOME OWNER MEASURE DEPTH

PLANS APPROVED BY C. Williams DATE 10/16/89

COVER NO WORK UNTIL INSPECTED AND APPROVED

NEITHER THE HOWARD COUNTY COUNCIL NOR THE HEALTH DEPARTMENT IS RESPONSIBLE FOR THE SUCCESSFUL OPERATION OF ANY SYSTEM.

NOTE: CLEANOUT REQUIRED EVERY 70 FEET OF SEWER LINE AND/OR AT 90° SWEEPS IN LINES FROM HOUSE TO DRAIN FIELDS

NOTE: ALL PARTS OF SEPTIC SYSTEMS (I.E. TANK, DISTRIBUTION BOX, TRENCHES) TO BE 100 FEET FROM WELL (UNLESS OTHERWISE SPECIFICALLY AUTHORIZED)

NOTE: IF DEEP TRENCHES ARE USED CALL FOR INSPECTION BEFORE AND AFTER PLACING GRAVEL IN TRENCHES

NOTE: NO DRY WELL SHALL EXCEED 15 FOOT IN DIAMETER NO ABSORPTION TRENCH TO EXCEED 100 FEET IN LENGTH.

NOTE: ALL PIPE FROM HOUSE TO SEPTIC TANK MUST BE CAST IRON OR SCHEDULE 40 PVC OR ABS

PERMIT VOID AFTER TWO YEARS

NOTE: INSTALL STAND PIPE ON SEPTIC TANK AND DRY WELL. STAND PIPES MUST BE 6 INCHES IN DIAMETER. CAST IRON, CONCRETE OR TERRA COTTA OR PVC OR ABS ACCEPTED. IF TOP OF SEPTIC TANK IS DEEPER THAN 3 FEET, MANHOLE TO GRADE REQUIRED

NOTE: DISTRIBUTION BOXES MUST HAVE BAFFLES

***INSTALLER IS RESPONSIBLE FOR OBTAINING FINAL APROVAL ON THIS PERMIT**

*CALL 461-9933 FOR INSPECTION OF SEPTIC SYSTEMS.

A 45136

①
 BROWN CLAY
 BROWN SAND
 LOAM
 POW
 ROCKS

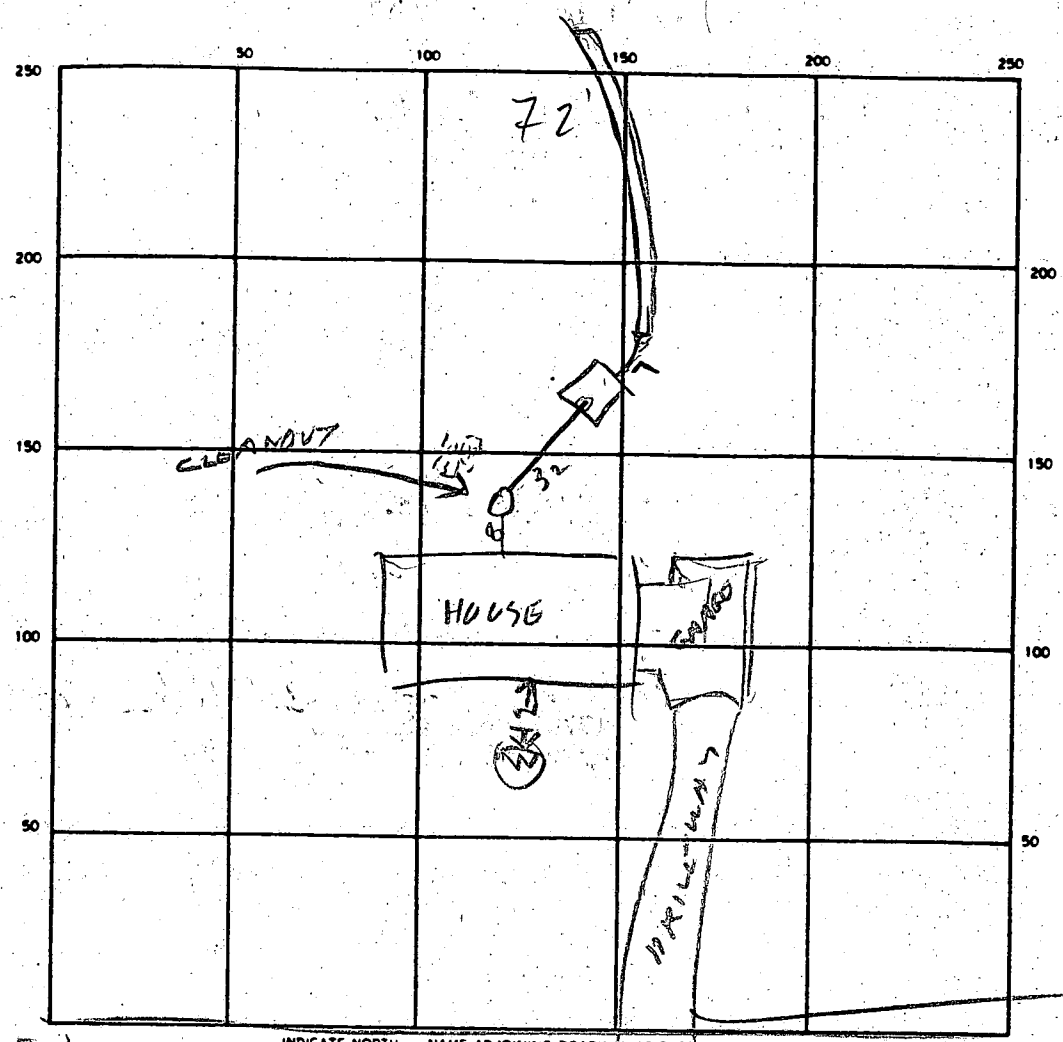

125
 3
 540
 5120
 125

180

70032

INDICATE NORTH NAME ADJOINING ROADWAY AS BASE LINE FOR SITE PLAN

SEPTIC TANK LEVEL 1000 CONCRETE CLEANOUTS OK

DISTRIBUTION BOX LEVEL _____

DRAIN FIELD/TILE FIELD DEPTH 10.5 FT. TRENCH WIDTH 2 FT. INLET DEPTH 5 FT.

EFFECTIVE GRAVEL DEPTH 5.5 FT. TOTAL LENGTH 72 FT.

NUMBER OF TRENCHES 1 ONE SIDEWALL/BOTTOM AREA 396 SQ. FT.

DRYWELL INSIDE DIAMETER _____ FT. EFFECTIVE DEPTH BELOW INLET _____ FT.

ABSORBENT AREA 396 SQ. FT.

REMARKS 2/26/90^{AM} - TANK OK VISUAL HOLE OK DECIDED

TO MAKE DEEP TRENCH, OLD STEEL TANK REPAIRED

2/26/90^{PM} TRENCH DUG ADD STONE BIT

2/26/90^{#3} OK TO COVER ALL MR

DATE SYSTEM APPROVED 2/26/90

INSPECTOR M. R. Klein